

Addendum 01

To: Bidding Contractors

From: Sashie Misner

Re: Coastal Ridge Elementary School

Subject: Addendum 01

Bid Documents

1. Wood fiber safety surfacing to be supplied by J.P. Larue. Contractor responsible for coordinating delivery, spreading mulch and compacting per specifications.
2. Geotextile fabric to be supplied by J.P. Larue. Contractor responsible for installation.
3. Handicap ramp installation by others. No crushed stone is required under the ramp.
4. Swing installation shall not require crushed stone base or drainage. Geotextile fabric shall be installed on prepared soil base. If the safety zone extends over the existing drain, contractor shall wrap crushed stone with geotextile fabric to cover existing drain. Install safety surface over top.
5. Equipment specifications included.

DRAIN

ACCESS RAMP
RHS
SITE

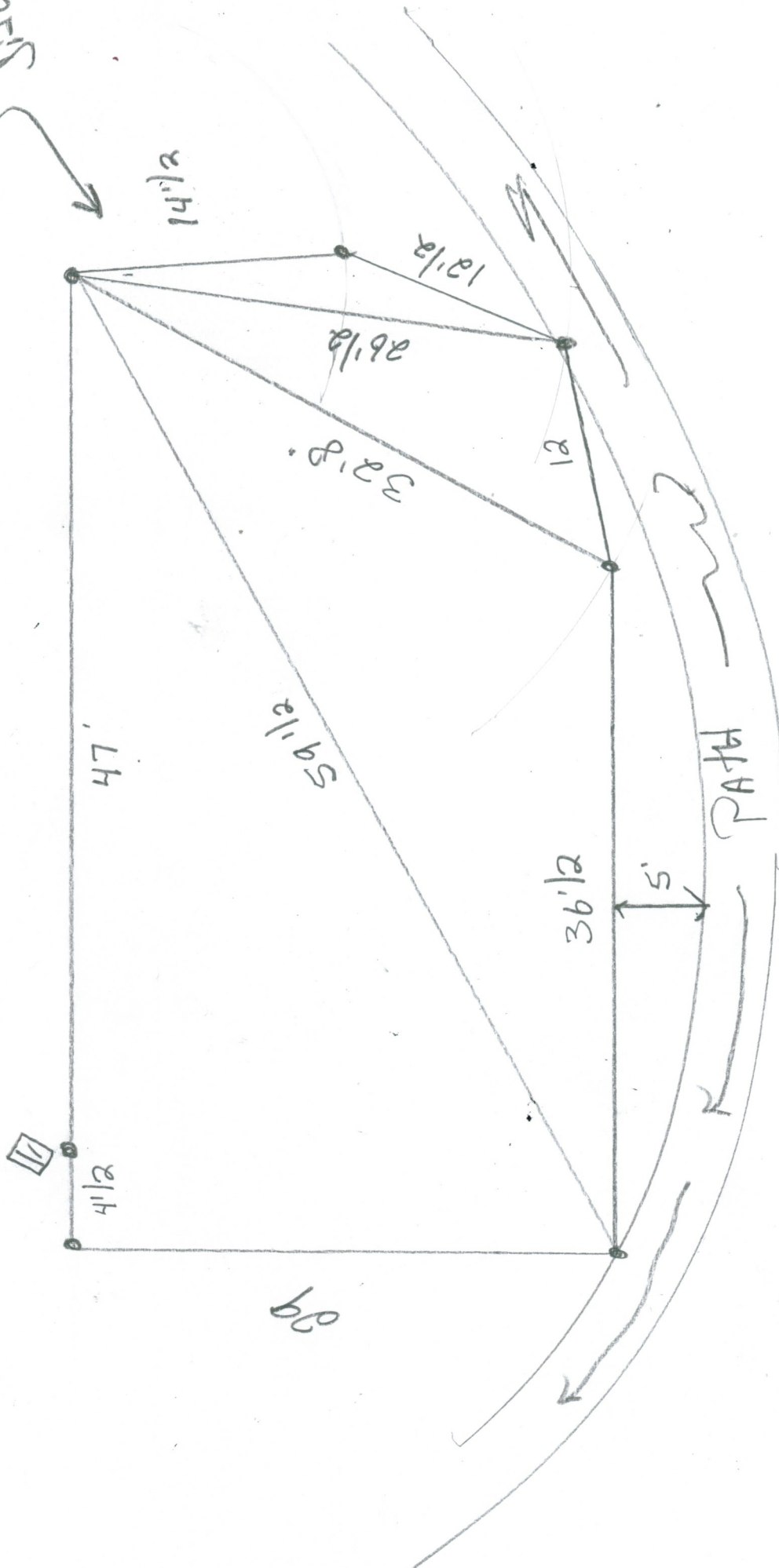

CORRAL Ridge. MA
4-25-19
SWINGS AS GULL
1/8"

* MEASURES ARE OUTSIDE
OF EXISTING TIMBER



PLAYFUL

COASTAL RIDGE ELEMENTARY
YORK, ME 03903

773-92056



BigToys

544 Chestnut Street
Chattanooga, TN 37402
866.814.8697
bigtoys.com



PLAYFUL

COASTAL RIDGE ELEMENTARY
YORK, ME 03903

773-92056



BigToys

544 Chestnut Street
Chattanooga, TN 37402

866.814.8697
bigtoys.com