



LOCUS MAP

N.T.S. 

LIST OF DRAWINGS

EX-1	EXISTING CONDITIONS PLAN
SP1.1	SITE PREPARATION PLAN
SP2.1	SECONDARY SUBGRADE PLAN
SP3.1	EARTHWORK NOTES
L1.1	LAYOUT AND MATERIALS PLAN
L2.1	GRADING PLAN
C1.1	DRAINAGE PLAN
C2.1	DRAINAGE DETAILS
L3.1	ALTERNATE 1 & 2
L3.2	ALTERNATE 1 & 2 - ENLARGEMENTS
L4.1	DETAIL SHEET I
L4.2	DETAIL SHEET II
L4.3	DETAIL SHEET III
L4.4	DETAIL SHEET IV
E0.0	ELECTRICAL LEGEND, DETAILS & ONE-LINE
E0.1	ELECTRICAL SPECIFICATIONS
E1.1	ELECTRICAL SITE PLAN
FLL1.1	FIELD LINE LAYOUT PLAN

BID DOCUMENTS

YARMOUTH HIGH SCHOOL  
SYNTHETIC TURF CARPET REPLACEMENT

YARMOUTH, MAINE

OWNER

Town of Yarmouth  
200 Main Street  
Yarmouth, Maine 04096 - 6317  
(207) 846-9036

LANDSCAPE ARCHITECT

Activitas Inc.  
16 School Street  
Dedham, Massachusetts 02026 - 4310  
(781) 326-2600

CIVIL ENGINEER

Samiotes Consultants, Inc.  
20 A Street  
Framingham, Massachusetts 01701 - 4102  
(508) 877-6688

GEOTECHNICAL ENGINEER

Haley & Aldrich, Inc.  
465 Medford Street, Suite 2200  
Boston, Massachusetts 02129 - 1454  
(617) 886-7400

ELECTRICAL ENGINEER

Richard D. Kimball Company, Inc.  
200 Brickstone Square  
Andover, Massachusetts 01810 - 1488  
(978) 296-6232

SURVEY

LandTech Consultants  
515 Groton Road  
Westford, Massachusetts 01886 - 6321  
(978) 692-6100

YARMOUTH HIGH SCHOOL  
SYNTHETIC TURF CARPET REPLACEMENT

BID DOCUMENTS  
FEBRUARY 15, 2013

OWNER

Town of Yarmouth  
200 Main Street  
Yarmouth, Maine 04096 - 6317

*activitas*  
Planning | Landscape | Athletic Facilities



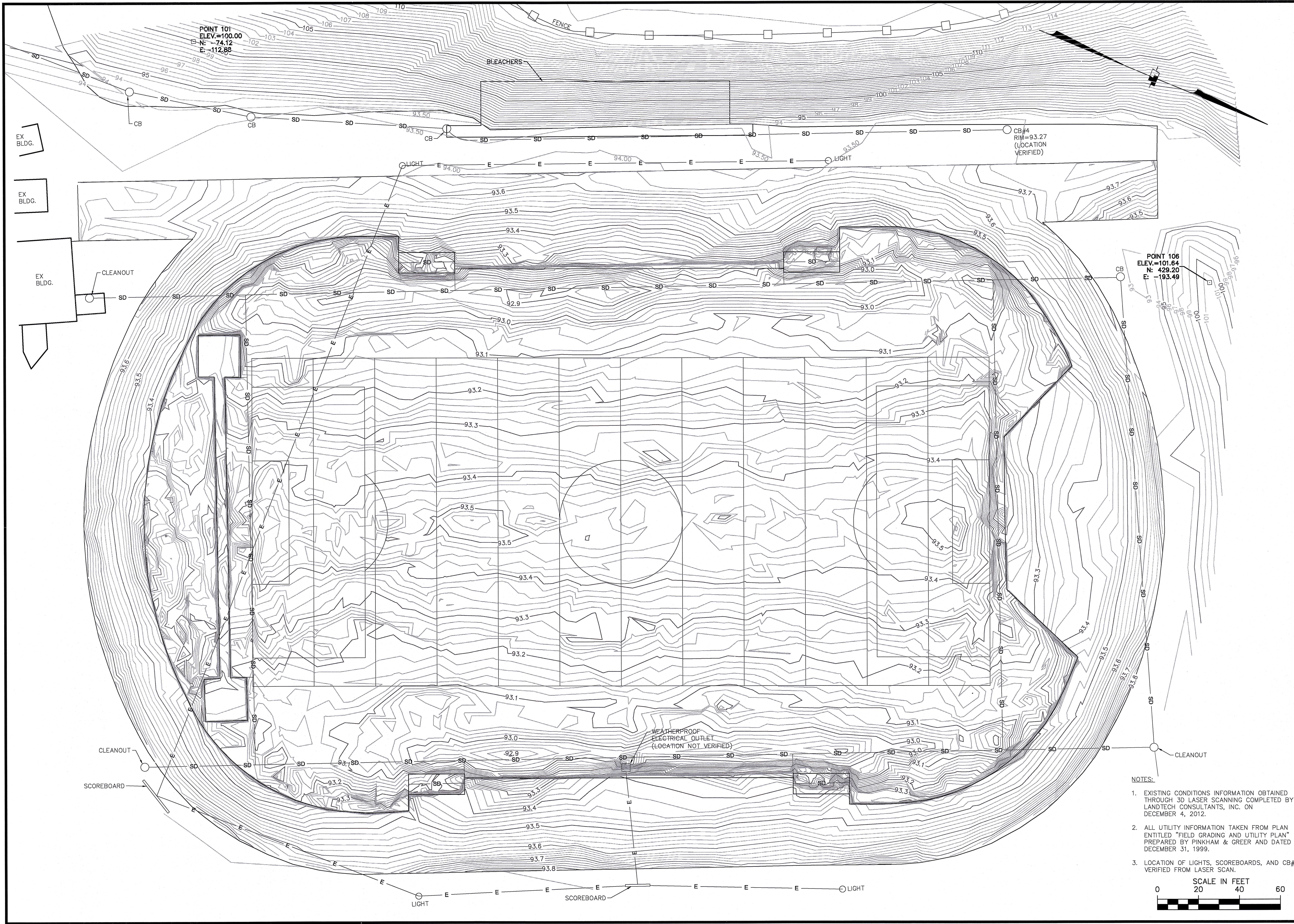

NOTES:

1. EXISTING CONDITIONS INFORMATION OBTAINED THROUGH 3D LASER SCANNING COMPLETED BY LANDTECH CONSULTANTS, INC. ON DECEMBER 4, 2012.
2. ALL UTILITY INFORMATION TAKEN FROM PLAN ENTITLED "FIELD GRADING AND UTILITY PLAN" PREPARED BY PINKHAM & GREER AND DATED DECEMBER 31, 1999.
3. LOCATION OF LIGHTS, SCOREBOARDS, AND CB#4 VERIFIED FROM LASER SCAN.

SCALE IN FEET

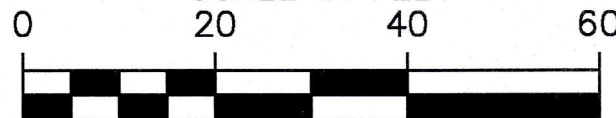

Job. No. 12-138	Dwg. No. 9619	Sheet EX-1	Prepared for: ACTIVITAS INC. 16 SCHOOL STREET DEDHAM, MA 02026	Scan CML	Draft ART	Check CML	DATE JANUARY 7, 2013	REVISION BY
EXISTING CONDITIONS PLAN YARMOUTH FOOTBALL FIELD YARMOUTH HIGH SCHOOL, YARMOUTH, MAINE Scale: 1" = 20'								

**Landtech**  
Consultants  
Engineering/Design/Surveying/Permitting  
515 Graven Road - Westford, MA 01886  
Ph: (978) 692-6100 - landtechinc.com

Copyright © 2010



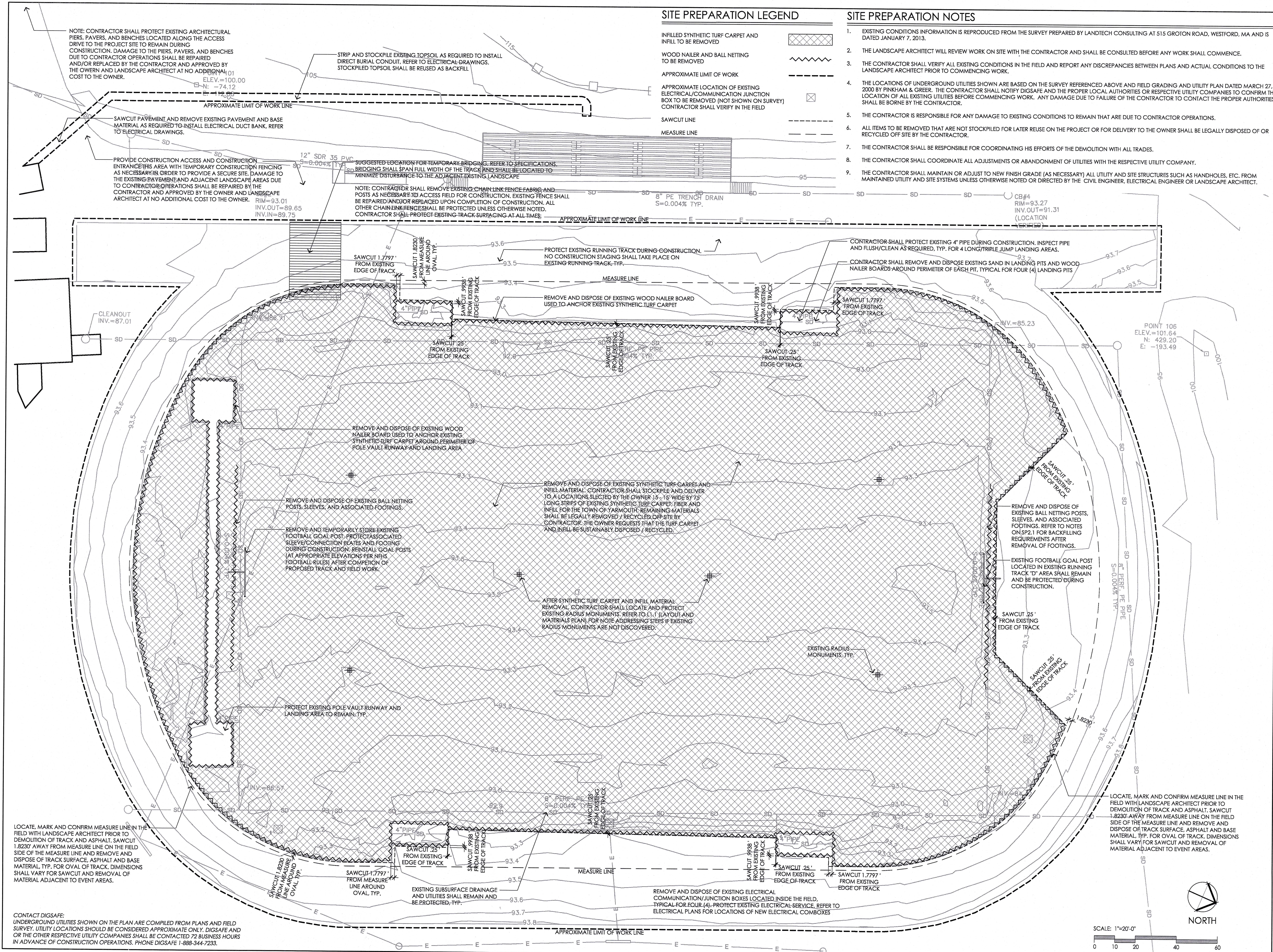

**activitas**  
Planning / Landscape / Architecture  
1600 School Street  
Dedham, Massachusetts 02026-4310  
Telephone: (781) 326-2600  
www.activitas.com

**CONSULTANTS**  
CIVIL ENGINEER -  
SAMIOES CONSULTANTS, INC.  
GEOTECHNICAL ENGINEER  
HALEY & ALDRICH, INC.  
ELECTRICAL ENGINEER -  
RICHARD D. KIMBALL COMPANY  
SURVEY -  
LANDTECH CONSULTANTS

**YARMOUTH HIGH SCHOOL**  
Yarmouth, Maine  
**SYNTHETIC TURF CARPET REPLACEMENT**

REV:	
SCALE:	
Bid Documents - February 15, 2013	<b>SITE PREPARATION PLAN</b>
SCALE: 1"=20'-0"	
JOB NO: 12002.00	
FILE: 12002.SP1.1_SP_PLAN.dwg	
DRAWN: JJC	
CHECKED: MJN, EPM	
SHEET NO:	<b>SP1.1</b>



# SECONDARY SUBGRADE LEGEND

LIMIT OF WORK LINE  
 PROPOSED SECONDARY SUBGRADE CONTOUR LINE  
 PROPOSED RIDGE LINE

POINT 101  
 ELEV.=100.00  
 N: -74.12  
 E: -13.92

APPROXIMATE LIMIT OF WORK LINE

CB#1  
 RIM=92.71  
 INV.OUT=89.31  
 INV.IN=89.41

CB#2  
 RIM=93.01  
 INV.OUT=89.65  
 INV.IN=89.75

CB#3  
 RIM=93.01  
 INV.OUT=90.13  
 INV.IN=90.23

CB#4  
 RIM=93.27  
 INV.OUT=91.31  
 (LOCATION  
 VERIFIED)

CLEANOUT  
 INV.=87.01

POINT 106  
 ELEV.=101.64  
 N: 429.20  
 E: -193.49

NEW SAWCUT EDGE ALONG INSIDE OF TRACK, REFER TO SP1.1

SOCCER FIELD SIDELINE ELEV=92.80

SECONDARY SUBGRADE RIDGE LINE=93.63

SOCCER FIELD SIDELINE ELEV=92.90  
 S=0.004% TYP.

NEW SAWCUT EDGE ALONG INSIDE OF TRACK, REFER TO SP1.1

APPROXIMATE LIMIT OF WORK LINE

# SECONDARY SUBGRADE PREPARATION NOTES

- EXISTING CONDITIONS INFORMATION IS REPRODUCED FROM THE SURVEY PREPARED BY LANDTECH CONSULTING AT 515 GROTON ROAD, WESTFORD, MA AND IS DATED JANUARY 7, 2013.
- AFTER REMOVAL AND DISPOSAL OF SYNTHETIC TURF CARPET AND INFILL MATERIAL, CONTRACTOR SHALL ASSUME COSTS FOR ONE (1) DAY OF TEST PIT OPERATIONS (UP TO 10-FT DEEP) INCLUDING AN EXCAVATOR AND ROLLER INCLUDING APPROPRIATE LABOR AND OPERATORS. LANDSCAPE ARCHITECT AND GEOTECHNICAL ENGINEER SHALL SELECT TEST PIT LOCATIONS AND BE PRESENT FOR ALL TEST PIT OPERATIONS. CONTRACTOR SHALL BACKFILL TO GRADE AND COMPACT ALL TEST PITS UPON COMPLETION. CONTRACTOR SHALL NOTIFY LANDSCAPE ARCHITECT AND GEOTECHNICAL ENGINEER FORTY- EIGHT (48) HOURS PRIOR TO TEST PIT OPERATIONS.
- UPON THE GEOTECHNICAL ENGINEER'S REVIEW OF TEST PITS, CONTRACTOR SHALL PROCEED WITH RE-GRADING THE EXISTING DRAINAGE BASE STONE (SECONDARY SUBGRADE) TO THE NEW SECONDARY SUBGRADE ELEVATIONS PROVIDED ON THIS DRAWING. SUBSEQUENT TO GRADING OPERATIONS CONTRACTOR SHALL PROOF ROLL SURFACE IN THE PRESENCE OF THE LANDSCAPE ARCHITECT AND GEOTECHNICAL ENGINEER. CONTRACTOR SHALL INSPECT THE RE-GRADED BASE BY MEANS OF A LASER LEVEL ON A 25-FOOT GRID PATTERN AND SHALL GENERATE AN ELECTRONIC SURVEY OF THE SURFACE TO BE SUBMITTED TO THE LANDSCAPE ARCHITECT FOR REVIEW. CONTRACTOR SHALL GRADE THE SECONDARY SUBGRADE SURFACE TO ACHIEVE A TOLERANCE OF 1/4" IN 25'.
- CONTRACTOR SHALL INCLUDE AN ALLOWANCE FOR 125 CUBIC YARDS OF 3/4" DOUBLE WASHED STONE (SPECIFIED AS FREE DRAINING TRENCH STONE) TO BE PLACED IN AREAS OF THE RE-GRADED SUBBASE (SECONDARY SUBGRADE) AS SELECTED BY THE GEOTECHNICAL ENGINEER. CONTRACTOR SHALL PLACE AND STATIC ROLL WITH DOUBLE DRUM HEAVY COMPACTION EQUIPMENT. ONCE COMPLETE, CONTRACTOR SHALL GENERATE A SECOND ELECTRONIC SURVEY OF THE SURFACE TO BE SUBMITTED TO THE LANDSCAPE ARCHITECT FOR REVIEW. CONTRACTOR SHALL GRADE THE SURFACE TO ACHIEVE A TOLERANCE OF 1/4" IN 25'. CONTRACTOR SHALL NOT BEGIN DRAINAGE PIPE EXCAVATIONS PRIOR TO LANDSCAPE ARCHITECT'S WRITTEN APPROVAL OF THE SURVEY.
- PROPOSED SECONDARY SUBGRADE GRADES ARE SHOWN FOR INTENT AND MAY BE ADJUSTED TO ELIMINATE THE NEED FOR EXPORT OF THE EXISTING FIELD'S DRAINAGE STONE. THE CONTRACTOR MUST REVIEW WITH THE LANDSCAPE ARCHITECT AND GEOTECHNICAL ENGINEER IF HE PROPOSES TO ADJUST THE GRADES OF THE SECONDARY SUBGRADE. SLOPES WITHIN THE PLAYING FIELD AREA (SOCCER SIDELINES AND FOOTBALL ENDLINES) SHALL BE MAINTAINED FROM THE PROPOSED RIDGE LINE AT THE CENTER OF THE FIELD.

## CONSULTANTS

CIVIL ENGINEER -  
 SAMIOTES CONSULTANTS, INC.  
 GEOTECHNICAL ENGINEER -  
 HALEY & ALDRICH, INC.  
 ELECTRICAL ENGINEER -  
 RICHARD D. KIMBALL COMPANY  
 SURVEY -  
 LANDTECH CONSULTANTS

YARMOUTH HIGH SCHOOL  
 Yarmouth, Maine

SYNTHETIC TURF CARPET REPLACEMENT

REV:

SEAL:

Bid Documents-  
 February 15, 2013

SECONDARY  
 SUBGRADE PLAN

SCALE: 1"=20'-0"  
 JOB NO: 12002.00  
 FILE: 12002-SP2.1\_SG\_PLAN.dwg  
 DRAWN: JUC  
 CHECKED: MJN, EPM

SHEET NO:

SP2.1

CONTACT DIGSAFE:  
 UNDERGROUND UTILITIES SHOWN ON THE PLAN ARE COMPILED FROM PLANS AND FIELD SURVEY. UTILITY LOCATIONS SHOULD BE CONSIDERED APPROXIMATE ONLY. DIGSAFE AND/OR THE OTHER RESPECTIVE UTILITY COMPANIES SHALL BE CONTACTED 72 BUSINESS HOURS IN ADVANCE OF CONSTRUCTION OPERATIONS. PHONE DIGSAFE 1-888-344-7233.

SCALE: 1"=20'-0"

0 10 20 40 60



NORTH



## EXCAVATION SUPPORT

EXCAVATIONS AND THE EVALUATION OF THE NEED FOR EARTH SUPPORT SHALL BE PERFORMED BY A REGISTERED CIVIL ENGINEER IN THE STATE OF MAINE, RETAINED BY THE CONTRACTOR. THE DESIGN AND CONSTRUCTION OF ALL OPEN-CUT AND RETAINED EXCAVATIONS SHALL BE IN ACCORDANCE WITH ALL APPLICABLE LOCAL, STATE, AND OSHA REGULATIONS AND PRUDENT ENGINEERING JUDGEMENT BASED ON SITE CONDITIONS.

## DEWATERING

SHOULD SURFACE, RAIN OR GROUND WATER BE ENCOUNTERED DURING THE OPERATIONS, THE CONTRACTOR SHALL FURNISH AND OPERATE PUMPS OR OTHER EQUIPMENT, AND PROVIDE ALL NECESSARY PIPING TO KEEP ALL EXCAVATIONS CLEAR OF WATER. AT ALL TIMES AND SHALL BE RESPONSIBLE FOR ANY DAMAGE TO WORK OR ADJACENT PROPERTIES FOR SUCH WATER. ALL PIPING EXPOSED ABOVE SURFACE FOR THIS USE, SHALL BE PROPERLY COVERED TO ALLOW FOOT TRAFFIC AND VEHICLES TO PASS WITHOUT OBSTRUCTION.

## EXCAVATION

ALL EXCAVATION AND BACKFILLING FOR STRUCTURES, UTILITIES, AND SITE IMPROVEMENTS SHALL BE PERFORMED IN-THE-DRY

THE CONTRACTOR SHALL CONTROL THE GRADING TO PREVENT WATER FROM RUNNING TO EXCAVATED AREAS OR DAMAGING SUBGRADES, SECONDARY SUBGRADES OR SITE IMPROVEMENTS.

EXERCISE CARE TO PRESERVE THE MATERIAL BELOW AND BEYOND THE LINES OF EXCAVATION. WHERE EXCAVATION IS CARRIED OUT THROUGH ERROR BELOW INDICATED GRADE OR BEYOND THE LINES OF EXCAVATION, BACKFILL TO THE INDICATED GRADE WITH A PRF-APPROVED AND SUITABLE MATERIAL (AS DETERMINED BY THE LANDSCAPE ARCHITECT AND GEOTECHNICAL ENGINEER) AT NO ADDITIONAL COST TO THE OWNER.

## TRENCH EXCAVATION

DEFINITIONS:

THE WORDS "INVERT" OR "INVERT ELEVATION" AS USED HEREIN MEAN THE ELEVATION AT THE INSIDE BOTTOM OF PIPE OR CHANNEL.

THE WORDS "BOTTOM OF THE PIPE" AS USED HEREIN MEAN THE ELEVATION AT THE BASE OF THE PIPE AT ITS OUTER SURFACE.

TRENCH EXCAVATIONS SHALL BE OF SUFFICIENT WIDTH AND DEPTH AT ALL POINTS TO ALLOW PIPES TO BE LAID AND APPURTENANT WORK TO BE BUILT IN A WORKMANLIKE MANNER AND, WHEN NEEDED, TO ALLOW FOR SHEETING AND SHORING, PUMPING AND DRAINING, AND REMOVING AND REPLACING ANY UNSUITABLE MATERIALS.

THE CONTRACTOR SHALL SHORE ALL TRENCHES, AS REQUIRED TO PROTECT SITE IMPROVEMENTS (EXISTING AND PROPOSED).

COORDINATE ALL WORK WITH THE UTILITY COMPANIES AND COMPLY WITH UTILITY COMPANY BACKFILL REQUIREMENTS

REMOVE AND DISPOSE OF SOILS EXCAVATED FROM UTILITY TRENCHES, UNLESS OTHERWISE NOTED OR DIRECTED BY THE LANDSCAPE ARCHITECT OR GEOTECHNICAL ENGINEER.

REMOVE ALL HARD SPOTS (COBBLES, BOULDERS, CONCRETE, BRICK, ETC.) AT BOTTOM OF UTILITY TRENCHES. OVER-EXCAVATE AT LEAST 12 IN. BELOW ALL UTILITIES TO EXPOSE AND REMOVE HARD SPOTS.

BACKFILL TRENCHES AS SOON AS POSSIBLE AFTER TRENCH EXCAVATION.

IF SOFT OR UNSTABLE MATERIALS, AS DETERMINED BY THE GEOTECHNICAL ENGINEER, ARE ENCOUNTERED AT THE BOTTOM OF THE UTILITY BEDDING MATERIALS, THE UNSTABLE SOILS SHALL BE OVER-EXCAVATED 2 FT BELOW THE BOTTOM OF THE UTILITY BEDDING MATERIAL. PLACE A SUB-BEDDING MATERIAL CONSISTING OF GRANULAR FILL OR APPROVED EQUAL TO THE BOTTOM OF THE UTILITY BEDDING MATERIALS. IN ALL CASES, THE CONTRACTOR SHALL CONDUCT ALL WORK NECESSARY TO PROVIDE A STABLE SUBGRADE TO PLACE THE BEDDING AND CONSTRUCT THE UTILITY.

## UNAUTHORIZED EXCAVATIONS

UNAUTHORIZED EXCAVATION CONSISTS OF REMOVAL OF MATERIALS BEYOND REQUIRED DESIGN SUBGRADE OR SECONDARY SUBGRADE ELEVATIONS OR DIMENSIONS WITHOUT SPECIFIC DIRECTION FROM THE LANDSCAPE ARCHITECT. UNAUTHORIZED EXCAVATION, AS WELL AS REMEDIAL WORK DIRECTED BY THE OWNER, SHALL BE AT THE CONTRACTOR'S EXPENSE.

BACKFILL AND COMPACT UNAUTHORIZED EXCAVATIONS WITH MATERIALS AS SPECIFIED BY THE LANDSCAPE ARCHITECT OR GEOTECHNICAL ENGINEER AT NO ADDITIONAL COST TO THE OWNER

## SHORING AND BRACING

PROVIDE SHORING AND BRACING AT EXCAVATIONS, AS REQUIRED, TO ASSURE COMPLETE SAFETY AGAINST COLLAPSE OF EARTH AT SIDES OF EXCAVATIONS OR EARTHEN SLOPES

SHORING AND BRACING OF TRENCHES AND OTHER EXCAVATIONS SHALL, AT A MINIMUM, BE IN ACCORDANCE WITH THE LATEST REQUIREMENTS OF THE OCCUPATIONAL SAFETY AND HEALTH ADMINISTRATION (OSHA) REGULATIONS.

EXCAVATION SUPPORT SYSTEMS SHALL BE DESIGNED TO SUPPORT EARTH PRESSURES, HYDROSTATIC PRESSURES, SURCHARGE LOADS AND OTHER FORCES FROM EXISTING SITE CONDITIONS, STORED MATERIAL, AND CONSTRUCTION EQUIPMENT.

ALL SHORING AND BRACING NOT ORDERED LEFT IN-PLACE SHALL BE CAREFULLY REMOVED IN SUCH A MANNER AS NOT TO ENDANGER THE CONSTRUCTION OF OTHER STRUCTURES, UTILITIES, OR PROPERTY WHETHER PUBLIC OR PRIVATE. ALL VOIDS LEFT AFTER WITHDRAWAL OF SHORING SHALL BE IMMEDIATELY REFILLED WITH SAND AND RAMMED WITH TOOLS ESPECIALLY ADAPTED TO THAT PURPOSE OR OTHERWISE COMPACTED AS DIRECTED TO ACHIEVE THE REQUIRED SOIL DENSITY.

SHORING AND BRACING SHALL NOT CONSTITUTE A CONDITION FOR WHICH AN INCREASE MAY BE MADE IN THE CONTRACT PRICE WITH THE EXCEPTION THAT IF THE OWNER DIRECTS IN WRITING THAT CERTAIN SHORING SHALL BE LEFT IN-PLACE, THE CONTRACT WILL BE ADJUSTED IN ACCORDANCE WITH GENERAL CONDITIONS.

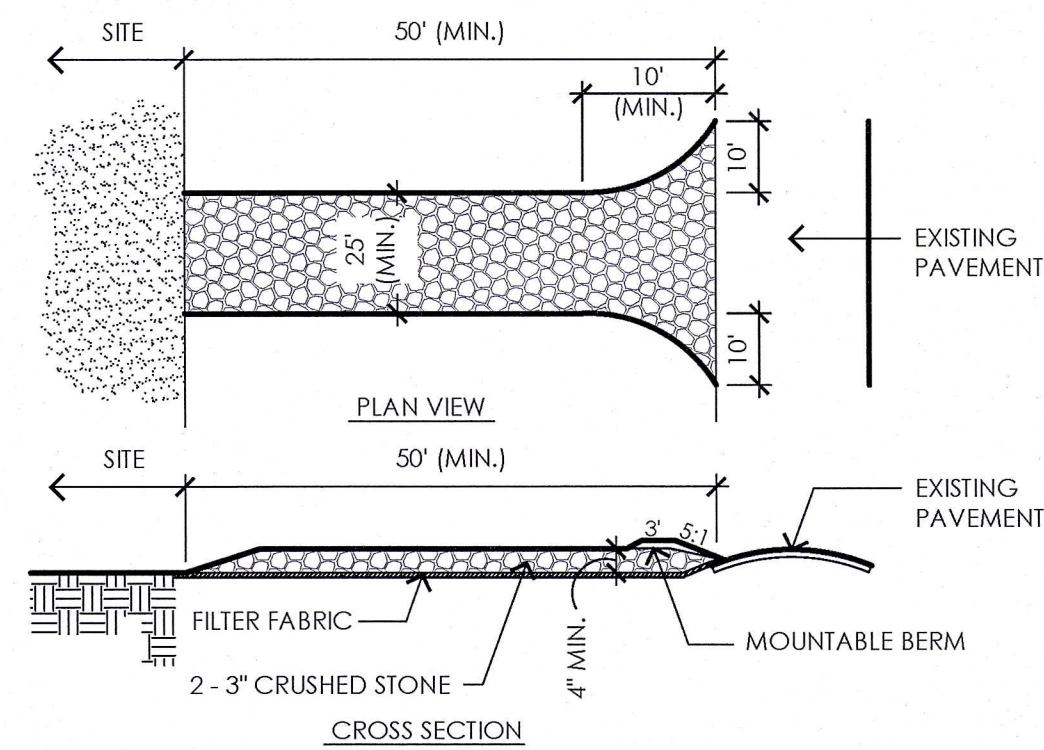

NOTES:

1. ENTRANCE WIDTH SHALL BE TWENTY-FIVE (25) FOOT MINIMUM, BUT NOT LESS THAN THE FULL WIDTH AT POINTS WHERE INGRESS OR EGRESS OCCURS.
2. THE ENTRANCE SHALL BE MAINTAINED IN A CONDITION WHICH SHALL PREVENT TRACKING OR FLOWING OF SEDIMENT ONTO PUBLIC RIGHTS-OF-WAY. THIS MAY REQUIRE PERIODIC TOP DRESSING WITH ADDITIONAL STONE AS CONDITIONS DEMAND AND REPAIR OR CLEANOUT OF ANY MEASURES USED TO TRAP SEDIMENT. ALL SEDIMENT SPILLED, DROPPED, WASHED OR TRACKED ONTO PUBLIC RIGHTS-OF-WAY MUST BE REMOVED IMMEDIATELY. BERM SHALL BE PERMITTED. PERIODIC INSPECTION AND MAINTENANCE SHALL BE PROVIDED AS NEEDED.

1 CONSTRUCTION ENTRANCE  
SCALE: N.T.S.

SCALE: N.T.S.

## CONSULTANTS

CIVIL ENGINEER -  
SAMIOTES CONSULTANTS, INC.

GEOTECHNICAL ENGINEER -  
HALEY & ALDRICH, INC.

ELECTRICAL ENGINEER -  
RICHARD D. KIMBALL COMPANY

SURVEY -  
LANDTECH CONSULTANTS

YARMOUTH HIGH SCHOOL

Yarmouth, Maine

## SYNTHETIC TURF CARPET REPLACEMENT

SEAL:

Bid Documents-  
February 15, 2013

# EARTHWORK NOTES

SCALE:	AS NOTED
JOB NO:	12002
FILE:	2002-SP3.1_EARTH_NOTES.dwg
DRAWN:	
CHECKED:	MJN, E

SHEET NO:

*SP3.*



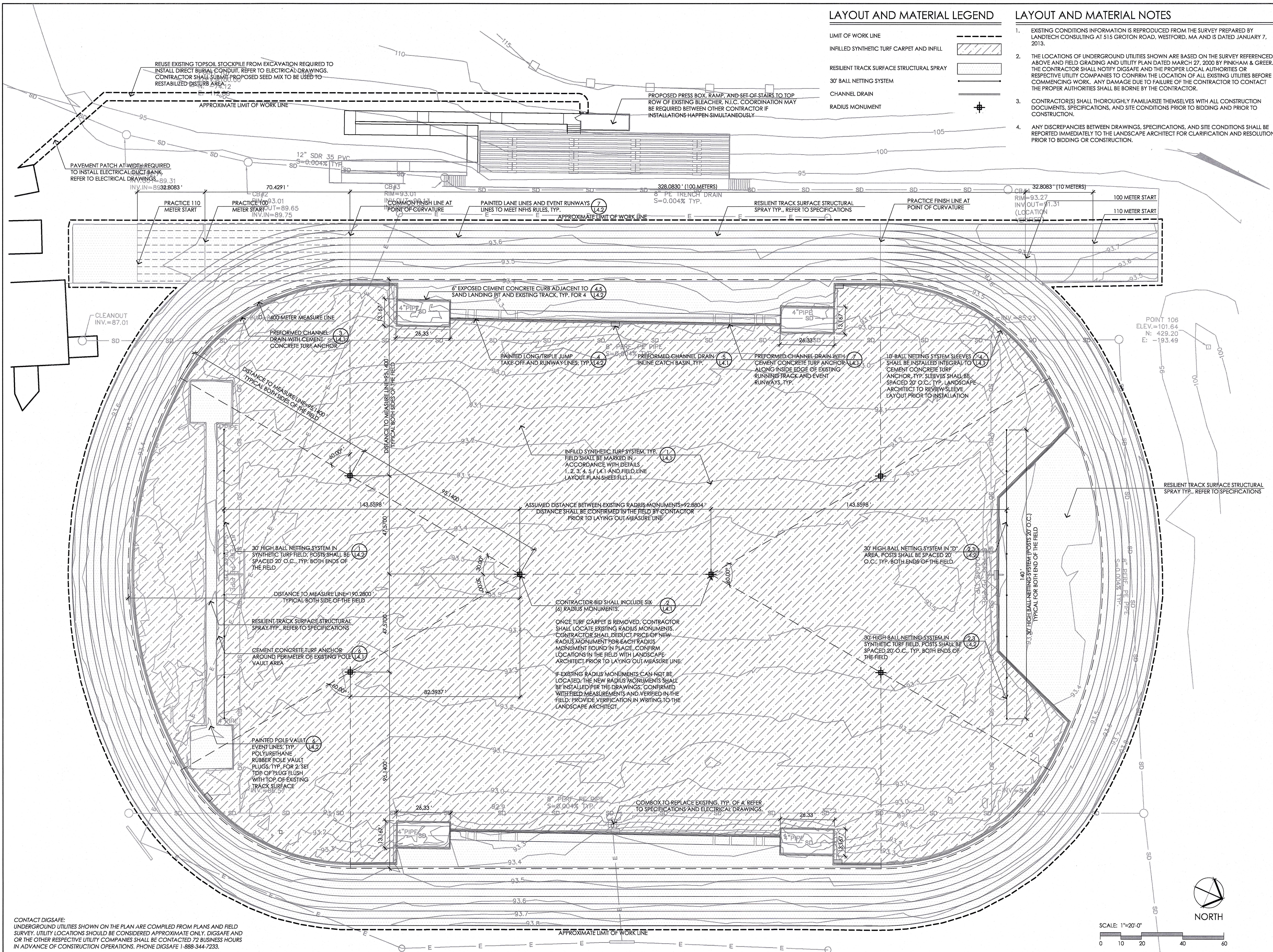

LAYOUT AND MATERIAL LEGEND

- LIMIT OF WORK LINE
- INFILLED SYNTHETIC TURF CARPET AND INFILL
- RESILIENT TRACK SURFACE STRUCTURAL SPRAY
- 30' BALL NETTING SYSTEM
- CHANNEL DRAIN
- RADIUS MONUMENT

LAYOUT AND MATERIAL NOTES

- EXISTING CONDITIONS INFORMATION IS REPRODUCED FROM THE SURVEY PREPARED BY LANDTECH CONSULTING AT 515 GROTON ROAD, WESTFORD, MA AND IS DATED JANUARY 7, 2013.
- THE LOCATIONS OF UNDERGROUND UTILITIES SHOWN ARE BASED ON THE SURVEY REFERENCED ABOVE AND FIELD GRADING AND UTILITY PLAN DATED MARCH 27, 2000 BY PINKHAM & GREER. THE CONTRACTOR SHALL NOTIFY DIGSAFE AND THE PROPER LOCAL AUTHORITIES OR RESPECTIVE UTILITY COMPANIES TO CONFIRM THE LOCATION OF ALL EXISTING UTILITIES BEFORE COMMENCING WORK. ANY DAMAGE DUE TO FAILURE OF THE CONTRACTOR TO CONTACT THE PROPER AUTHORITIES SHALL BE BORNE BY THE CONTRACTOR.
- CONTRACTOR(S) SHALL THOROUGHLY FAMILIARIZE THEMSELVES WITH ALL CONSTRUCTION DOCUMENTS, SPECIFICATIONS, AND SITE CONDITIONS PRIOR TO BIDDING AND PRIOR TO CONSTRUCTION.
- ANY DISCREPANCIES BETWEEN DRAWINGS, SPECIFICATIONS, AND SITE CONDITIONS SHALL BE REPORTED IMMEDIATELY TO THE LANDSCAPE ARCHITECT FOR CLARIFICATION AND RESOLUTION PRIOR TO BIDDING OR CONSTRUCTION.

activities

Planning | Landscape | Athletic Facilities

sixteen school street  
dedham: massachusetts 02026-4310  
telephone: (781) 326-2600  
www.activitas.com

CONSULTANTS

CIVIL ENGINEER -  
SAMOITES CONSULTANTS, INC.

GEOTECHNICAL ENGINEER -  
HALEY & ALDRICH, INC.

ELECTRICAL ENGINEER -  
RICHARD D. KIMBALL COMPANY

SURVEY -  
LANDTECH CONSULTANTS

YARMOUTH HIGH SCHOOL  
Yarmouth, Maine

SYNTHETIC TURF CARPET REPLACEMENT

REV: 1 2 3 4 5 6 7 8 9 10 11 12 13 14 15 16 17 18 19 20 21 22 23 24 25 26 27 28 29 30 31 32 33 34 35 36 37 38 39 40 41 42 43 44 45 46 47 48 49 50 51 52 53 54 55 56 57 58 59 60 61 62 63 64 65 66 67 68 69 70 71 72 73 74 75 76 77 78 79 80 81 82 83 84 85 86 87 88 89 90 91 92 93 94 95 96 97 98 99 100

SEAL: [ ]

Bid Documents-  
February 15, 2013

LAYOUT AND  
MATERIALS PLAN

SCALE: 1"=20'-0"  
JOB NO: 12002.00  
FILE: 12002-L1.1\_LM\_PLAN.dwg  
DRAWN: JJC  
CHECKED: M.JN, EPM  
SHEET NO: L1.1



GRADING LEGEND

LIMIT OF WORK LINE  
PROPOSED CONTOUR LINE  
PROPOSED RIDGE LINE  
SLOPE DIRECTION ARROW

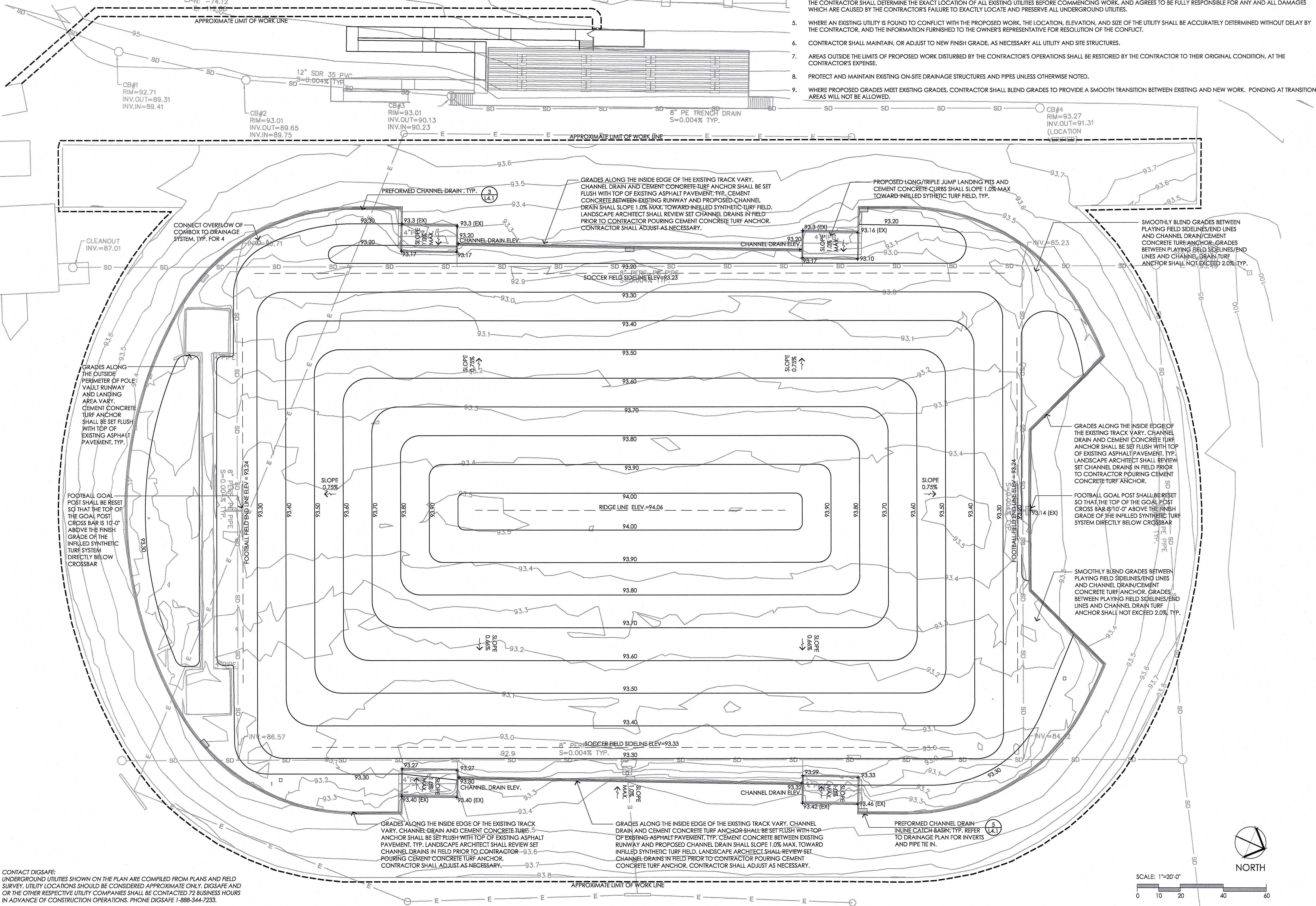

GRADING NOTES

- EXISTING CONDITIONS INFORMATION IS REPRODUCED FROM THE SURVEY PREPARED BY LANDTECH CONSULTING AT 515 GROTON ROAD, WESTFORD, MA AND IS DATED JANUARY 7, 2013.
- PRIOR TO THE START OF ANY EXCAVATION FOR THE PROJECT, THE CONTRACTOR SHALL NOTIFY DIGSAFE AND THE PROPER LOCAL AUTHORITIES OR RESPECTIVE UTILITY COMPANIES TO CONFIRM THE LOCATION OF ALL EXISTING UTILITIES BEFORE COMMENCING WORK. ANY DAMAGE DUE TO FAILURE OF THE CONTRACTOR TO CONTACT THE PROPER AUTHORITIES SHALL BE BORNE BY THE CONTRACTOR.
- ALL CONSTRUCTION TO BE DONE IN ACCORDANCE WITH TOWN OF YARMOUTH DEPARTMENT OF PUBLIC WORKS STANDARDS.
- THE LOCATIONS OF EXISTING UNDERGROUND UTILITIES ARE SHOWN IN AN APPROXIMATE WAY ONLY AND HAVE NOT BEEN INDEPENDENTLY VERIFIED BY THE OWNER OR ITS REPRESENTATIVE. THE CONTRACTOR SHALL DETERMINE THE EXACT LOCATION OF ALL EXISTING UTILITIES BEFORE COMMENCING WORK, AND AGREES TO BE FULLY RESPONSIBLE FOR ANY AND ALL DAMAGES WHICH ARE CAUSED BY THE CONTRACTOR'S FAILURE TO EXACTLY LOCATE AND PRESERVE ALL UNDERGROUND UTILITIES.
- WHERE AN EXISTING UTILITY IS FOUND TO CONFLICT WITH THE PROPOSED WORK, THE LOCATION, ELEVATION, AND SIZE OF THE UTILITY SHALL BE ACCURATELY DETERMINED WITHOUT DELAY BY THE CONTRACTOR, AND THE INFORMATION FURNISHED TO THE OWNER'S REPRESENTATIVE FOR RESOLUTION OF THE CONFLICT.
- CONTRACTOR SHALL MAINTAIN, OR ADJUST TO NEW FINISH GRADE, AS NECESSARY ALL UTILITY AND SITE STRUCTURES.
- AREAS OUTSIDE THE LIMITS OF PROPOSED WORK DISTURBED BY THE CONTRACTOR'S OPERATIONS SHALL BE RESTORED BY THE CONTRACTOR TO THEIR ORIGINAL CONDITION, AT THE CONTRACTOR'S EXPENSE.
- PROTECT AND MAINTAIN EXISTING ON-SITE DRAINAGE STRUCTURES AND PIPES UNLESS OTHERWISE NOTED.
- WHERE PROPOSED GRADES MEET EXISTING GRADES, CONTRACTOR SHALL BLEND GRADES TO PROVIDE A SMOOTH TRANSITION BETWEEN EXISTING AND NEW WORK. PONDING AT TRANSITION AREAS WILL NOT BE ALLOWED.

**activitas**  
Planning / Landscape / Architectural Facilities  
1600 School Street  
Dedham, Massachusetts 02026-4310  
Telephone: (781) 326-2600  
www.activitas.com

- CONSULTANTS**
- CIVIL ENGINEER -  
SAMOITES CONSULTANTS, INC.
- GEOTECHNICAL ENGINEER -  
HALEY & ALDRICH, INC.
- ELECTRICAL ENGINEER -  
RICHARD D. KIMBALL COMPANY
- SURVEY -  
LANDTECH CONSULTANTS

**YARMOUTH HIGH SCHOOL**  
Yarmouth, Maine

**SYNTHETIC TURF CARPET REPLACEMENT**

REV: \_\_\_\_\_

SCALE: 1"=20'-0"

JOB NO: 12002.00

FILE: 12002-12.1\_G\_PLAN.dwg

DRAWN: JJC

CHECKED: MJN, EFM

SHEET NO: **L2.1**

Bid Documents:  
February 15, 2013

**GRADING PLAN**



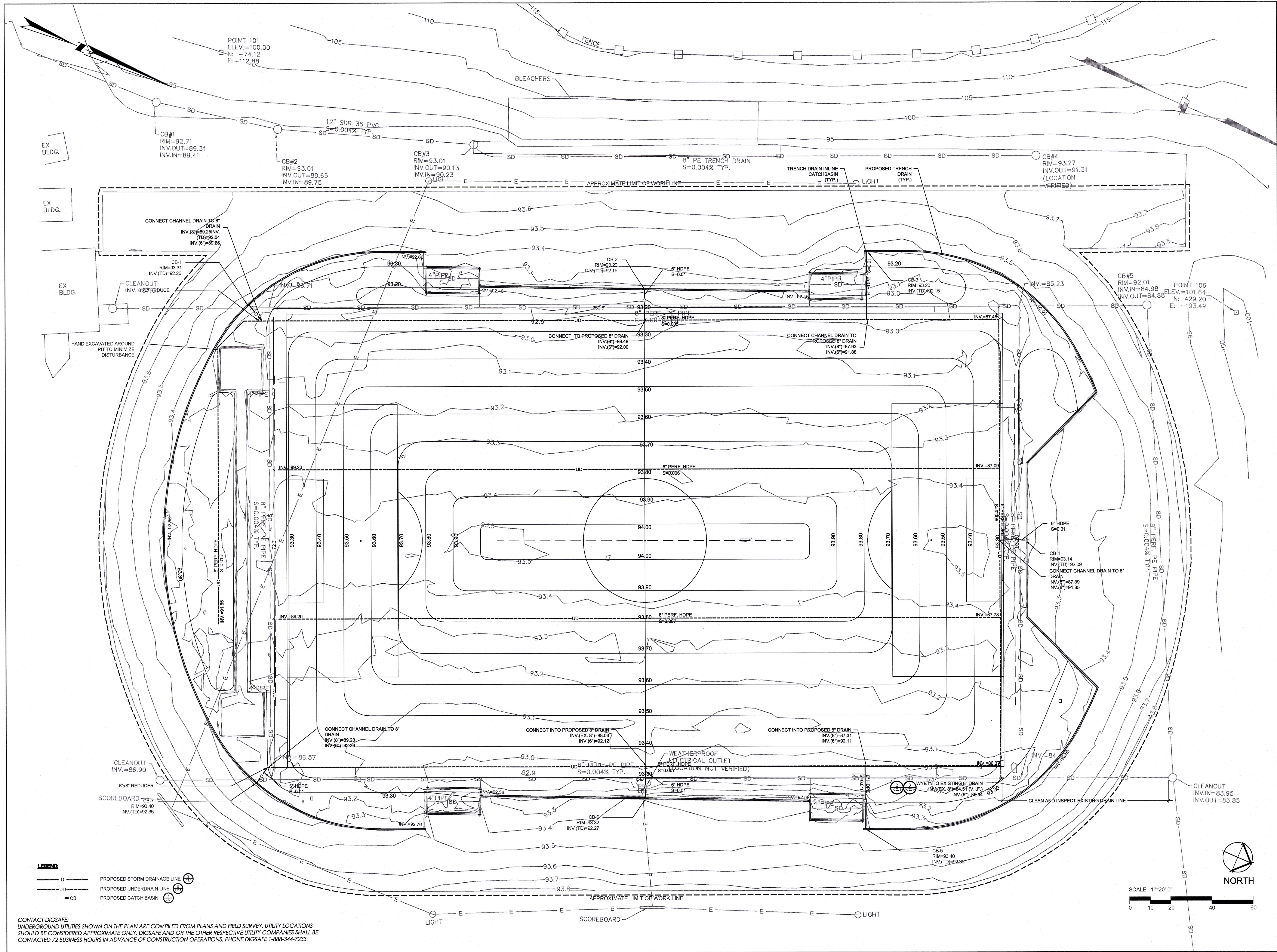

**CONSULTANTS**  
CIVIL ENGINEER -  
SAMOITES CONSULTANTS, INC.  
GEOTECHNICAL ENGINEER -  
HALEY & ALDRICH, INC.  
ELECTRICAL ENGINEER -  
RICHARD D. KIMBALL COMPANY  
SURVEY -  
LANDTECH CONSULTANTS

**YARMOUTH HIGH SCHOOL**  
Yarmouth, Maine  
**SYNTHETIC TURF CARPET REPLACEMENT**

REV.	

SEAL:

100% Bid Documents -  
February 15, 2013  
**Drainage Plan**

SCALE: 1"=20'-0"  
JOB NO: 13001.00  
FILE: 13001.00cd.dwg  
DRAWN: amt  
CHECKED: srg

SHEET NO:  
**C1.1**



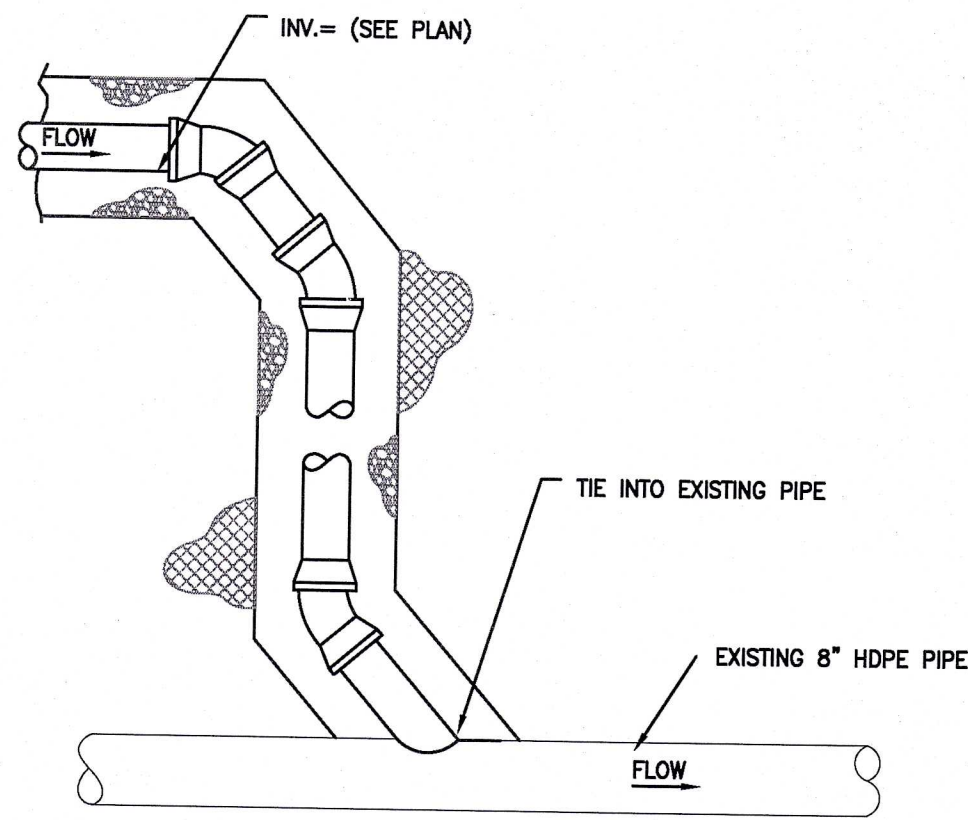

1 CONNECTION TO EXISTING STORMDRAIN  
NTS

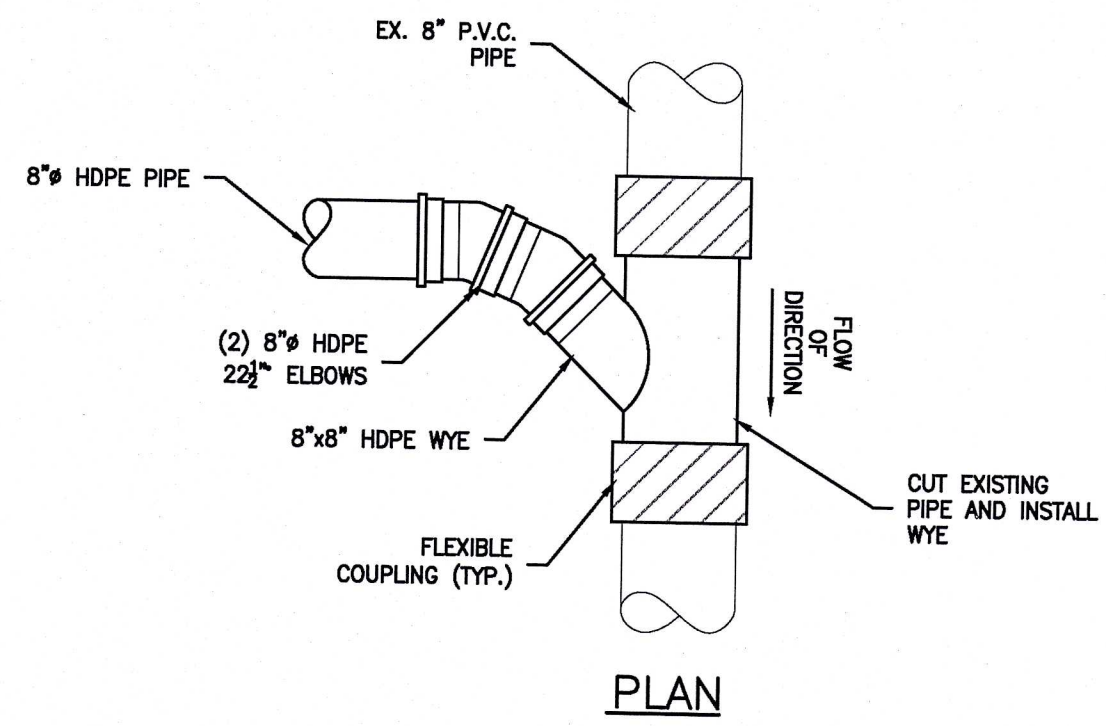

2 STORM DRAIN CONNECTION  
NTS

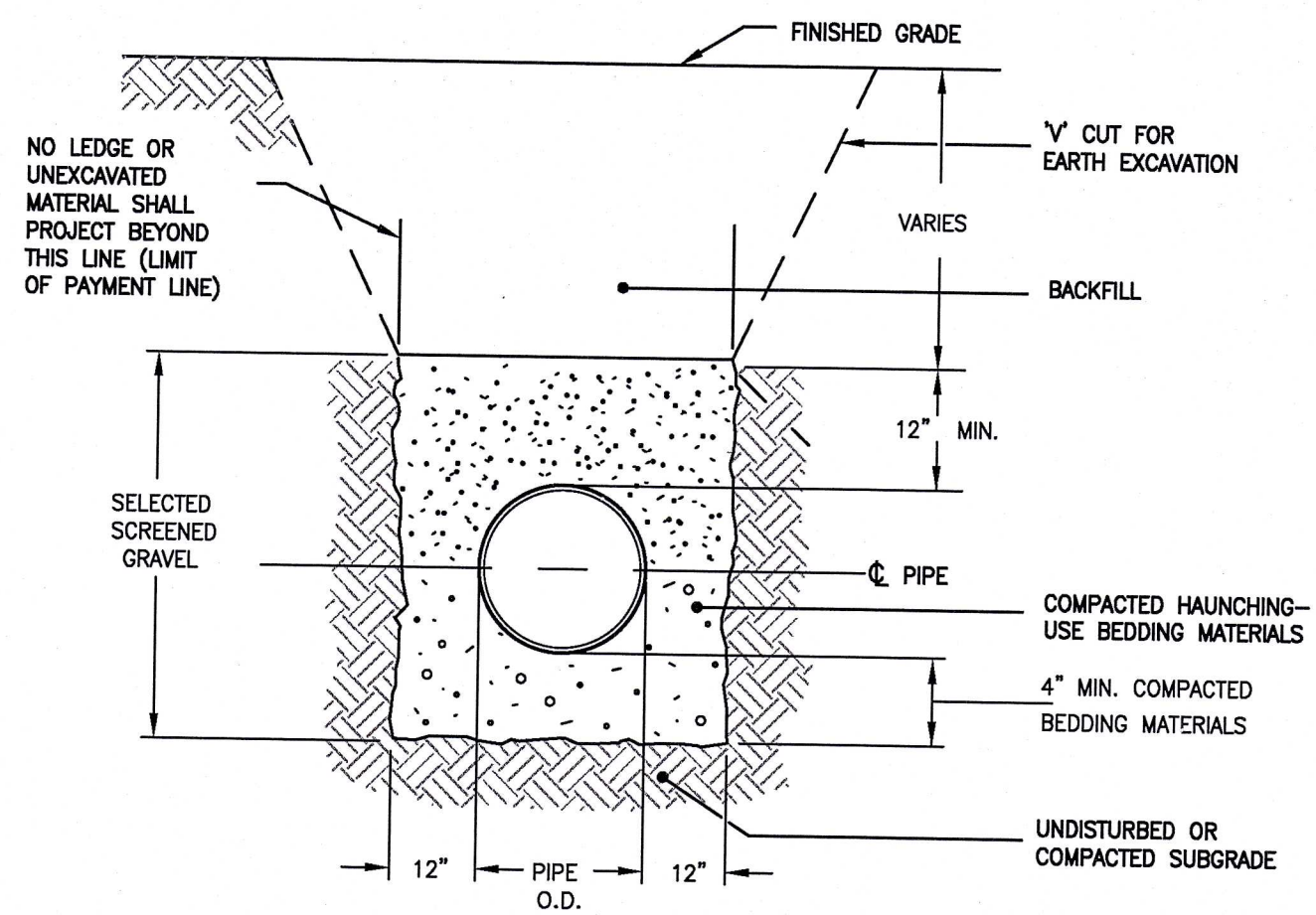

3 TRENCH SECTION- HDPE GRAVITY PIPE  
NTS

# YARMOUTH HIGH SCHOOL

Yarmouth, Maine

SYNTHETIC TURF CARPET REPLACEMENT

**activitas**  
Planning | Landscape | Athletic Facilities  
Sixteen school street  
dedham, massachusetts 02026-4310  
telephone: (781) 326-2600  
www.activitas.com

- CONSULTANTS**
- CIVIL ENGINEER** - SAMIOTES CONSULTANTS, INC.
  - GEOTECHNICAL ENGINEER** - HALEY & ALDRICH, INC.
  - ELECTRICAL ENGINEER** - RICHARD D. KIMBALL COMPANY
  - SURVEY** - LANDTECH CONSULTANTS

REV:	
SEAL:	
100% Bid Documents - February 15, 2013	
Drainage Details	

SCALE:	1"=20'-0"
JOB NO:	13001.00
FILE:	13001.00cd.dwg
DRAWN:	amt
CHECKED:	erg

SHEET NO:  
**C2.1**



## LAYOUT AND MATERIAL NOTES

- EXISTING CONDITIONS INFORMATION IS REPRODUCED FROM THE SURVEY PREPARED BY LANDTECH CONSULTING AT 515 GROTON ROAD, WESTFORD, MA AND IS DATED JANUARY 7, 2011.
- THE LOCATIONS OF UNDERGROUND UTILITIES SHOWN ARE BASED ON THE SURVEY REFERENCED ABOVE AND FIELD GRADING AND UTILITY PLAN DATED MARCH 27, 2000 BY PINKHAM & GREER. THE CONTRACTOR SHALL NOTIFY DIGSAFE AND THE PROPER LOCAL AUTHORITIES OR RESPECTIVE UTILITY COMPANIES TO CONFIRM THE LOCATION OF ALL EXISTING UTILITIES BEFORE COMMENCING WORK. ANY DAMAGE DUE TO FAILURE OF THE CONTRACTOR TO CONTACT THE PROPER AUTHORITIES SHALL BE BORNE BY THE CONTRACTOR.
- CONTRACTOR(S) SHALL THOROUGHLY FAMILIARIZE THEMSELVES WITH ALL CONSTRUCTION DOCUMENTS, SPECIFICATIONS, AND SITE CONDITIONS PRIOR TO BIDDING AND PRIOR TO CONSTRUCTION.
- ANY DISCREPANCIES BETWEEN DRAWINGS, SPECIFICATIONS, AND SITE CONDITIONS SHALL BE REPORTED IMMEDIATELY TO THE LANDSCAPE ARCHITECT FOR CLARIFICATION AND RESOLUTION PRIOR TO BIDDING OR CONSTRUCTION.

## LAYOUT AND MATERIAL LEGEND

ENLARGEMENT LIMIT OF WORK LINE

RESILIENT TRACK SURFACE SYSTEM -  
STRUCTURAL SPRAY ONLY

RESILIENT TRACK SURFACING SYSTEM -  
RUBBER PAVEMAT AND STRUCTURAL SPRAY

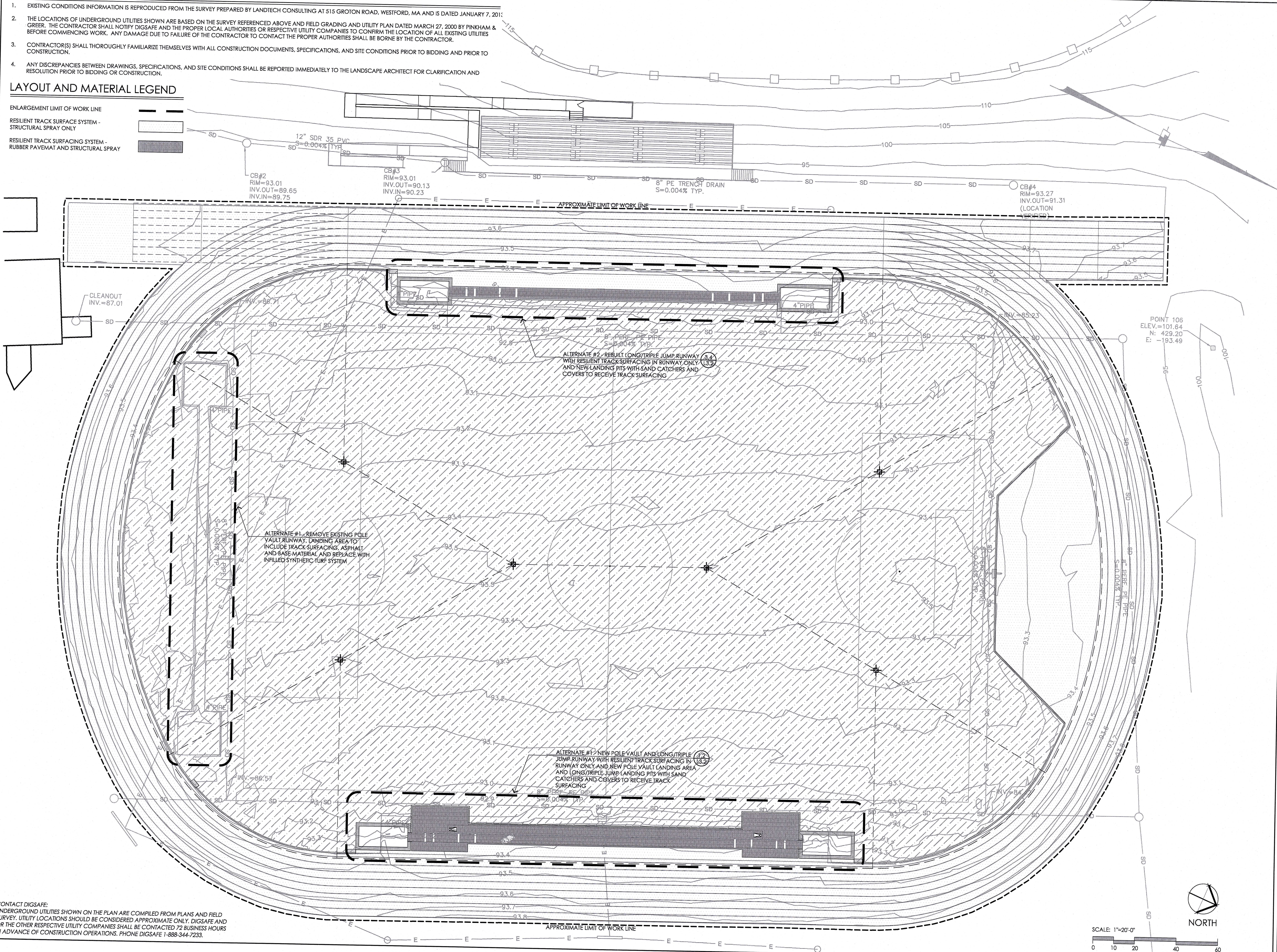
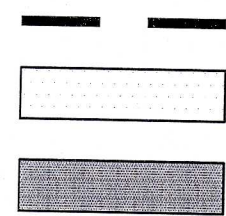

CONTACT DIGSAFE:  
UNDERGROUND UTILITIES SHOWN ON THE PLAN ARE COMPILED FROM PLANS AND FIELD  
SURVEY. UTILITY LOCATIONS SHOULD BE CONSIDERED APPROXIMATE ONLY. DIGSAFE AND  
OR THE OTHER RESPECTIVE UTILITY COMPANIES SHALL BE CONTACTED 72 BUSINESS HOURS  
IN ADVANCE OF CONSTRUCTION OPERATIONS. PHONE DIGSAFE 1-888-344-7233.

**activitas**  
Planning | Landscape | Athletic Facilities  
sixteen school street  
dedham, massachusetts 02026-4310  
telephone: (781) 326-2600  
www.activitas.com

**CONSULTANTS**  
CIVIL ENGINEER -  
SAMIOTES CONSULTANTS, INC.  
GEOTECHNICAL ENGINEER -  
HALEY & ALDRICH, INC.  
ELECTRICAL ENGINEER -  
RICHARD D. KIMBALL COMPANY  
SURVEY -  
LANDTECH CONSULTANTS

**YARMOUTH HIGH SCHOOL**  
Yarmouth, Maine  
**SYNTHETIC TURF CARPET REPLACEMENT**

REV.	

**SEAL:**  
Bid Documents-  
February 15, 2013  
**ALTERNATES 1 & 2**

SCALE: 1"=20'-0"  
JOB NO: 12002.00  
FILE: 12002.00-L3.1\_ALT\_PLAN.dwg  
DRAWN: JJC  
CHECKED: M.J.N. EPM  
SHEET NO:

**L3.1**