

ADDENDUM #1



Date: May 23, 2024

Re: Maine Department of Agriculture, Conservation, and Forestry
Bureau of Parks and Lands
Camden Hills State Park Water System Upgrades
Camden, Maine

From: Haley Ward, Inc.
One Merchants Plaza, Suite 701
Bangor, ME 04401

Owner Project No:
BGS Project No: 3464
Project No: 14641.001

To: Prospective Bidders

This Addendum forms a part of the Contract Documents and modifies the original bidding documents dated May 2024. Contractor is responsible for carefully examining Addenda. Failure to do so may subject the Bidder to disqualification. The original conditions shall govern for all work unless specifically exempted or modified herein.

This Addendum consists of 25 pages (With Attachments: 21 Pages) and is being issued to meet the requirements of the Project Manual.

GENERAL

Included with this Addendum are the Pre-Bid Meeting Minutes from May 14, 2024.

Answers to Questions that have been asked:

Q: Do you anticipate any ledge?

A: Yes, it is anticipated that ledge may be encountered during construction. An allowance has been added to the Contractor Bid Form under "Rock Removal."

Q: What are the flow and pressure requirements for the proposed Chlorine pump?

A: The Chlorine pump listed on Drawing Sheet P-501, Detail 9 assumes a flow rate of 0.25 gph and a pressure of 60 psi.

Q: Regarding the 1" DuraLine Pinpoint conduit, it looks like there is an optional thickness or "wall ratio" as well as color. Is the intent to use the 1" pipe with the 0.12" wall thickness or the 0.097" wall thickness? Also, what color should be used?

A: The Contractor shall use SDR 11 (0.12") wall thickness and color option 1 (standard orange).

Q: For the water connection between Sites 96 and 64, is the design intent to reconnect the spigot to the new distribution near where it intersects with the existing spigot or will a new line need to be installed over to the spigot?

A: It is the design intent to reconnect the existing spigot to the new system near where it intersects the existing spigot.

Q: Will the proposed propane tank by the well building be supplied by and paid for by the propane company or will the Contractor need to carry the setup and install cost?

A: The Contractor shall carry the setup and installation costs for the propane tank.

Q: Can water service to the maintenance shop be completed in Phase 2 or does it have to be completed in Phase 1?

A: Yes, water service to the maintenance shop can be completed in either Phase 1 or Phase 2 as long as progress is being made toward completion of the work within the project timeline.

Q: Have any materials (e.g., tanks) been pre-purchased?

A: No materials have been pre-purchased.

Q: What is the anticipated lead time on the water tanks?

A: Previous correspondence by Engineer with The National Tank Outlet anticipated a lead time of 2 days for 10,000-gallon tanks that ship from Ohio. Contractor is responsible for confirming lead times.

Q: When does Phase 1 need to be completed?

A: Phase 1 must commence to run upon receipt of a Notice to Proceed. The proposed water tanks shall be constructed and tied into the existing water system within 60 days of Contract commencement.

Q: Has an Engineer's opinion of cost been provided?

A: Per Specification Section 00 11 13 Notice to Contractors, the cost of work is anticipated to be approximately \$1,200,000.

Q: Will the proposed tanks be set on a concrete slab? Can you provide a detail for the concrete slab underneath the proposed tanks?

A: Yes. Please see Drawing Sheet S-102, which has been added to the Contract Documents per this Addendum.

Q: What is the material and size of existing water pipe that new water pipe will be joined to?

A: The existing water pipe to the existing storage cistern is 3-inch butt-fused IPS polyethylene (PE) pipe.

Q: Will new HDPE water mains be IPS or CTS?

A: New HDPE water mains shall be IPS per the Contract Documents.

Q: How is the presence of ledge being quantified?

A: An allowance has been added to the Contractor Bid Form under "Rock Removal."

Q: Has a staging area been identified?

A: The Owner prefers that staging be located near to the existing maintenance shop. For Work on the proposed water tanks and associated water lines, staging can be located near to the water tanks as long as roadway accesses are not obstructed.

Q: When is it anticipated that the campground will close for the regular season?

A: It is anticipated that the campground will close for regular use on or about October 1st.

Q: Can you provide a detail for the typical water and conduit trench to/from the proposed water tanks?

A: Yes. Please see the Water and Electrical Lines to Tank Trench Detail on Drawing Sheet C502 per this Addendum.

Q: Can the final completion date be extended to allow for pavement?

A: Yes. The final completion date has been extended to June 6, 2025, per this Addendum.

Q: How should the existing 60,000-gallon steel tank and existing 5,000-gallon cistern be demolished?

A: Remove the steel tank materials to grade. Material below grade may be left in place. Remove the top structure over the cistern. Material below grade may be left in place. Fill in open excavations and the existing cistern with gravel.

Q: Will the proposed building be insulated?

A: Yes, see Architectural Sections.

Q: Will fill be required for placement of the proposed water tanks?

A: Fill is not anticipated to be required. See Drawing Sheets C502 and S-102 for details and proposed elevations.

Q: Can the water main be directionally bored for installation instead of trenching?

A: No, HDPE water main must be installed within sand bedding per Typical Trench Detail – HDPE Water Main on Drawing Sheet C501.

Q: What should be done with incidentally removed trees?

A: Fallen trees and newly felled trees along the path from the well house to the storage tanks can be pushed off to the side of the path and left on site. Do not pile trees in large piles. Trees felled within the park shall be brought to the yard near the existing maintenance building and piled there for the park to remove.

CHANGES TO DRAWINGS:

Cover Sheet:

The Cover Sheet has been updated to show the revised and new drawing sheets within the set.

Sheet C100

Drawing Sheet C100 has been updated to show the revised layout of the proposed water distribution piping around the existing maintenance shop building. The proposed water spigot adjacent to the existing parking lot has also been removed from the Drawing Sheet.

Sheet C102

Drawing Sheet C102 has been updated to show the revised layout of the proposed water distribution piping around the existing maintenance shop building. The proposed water spigot adjacent to the existing parking lot has also been removed from the Drawing Sheet.

Sheet C502

Remove “Unistrut Bracing Detail” from Drawing Sheet C502.

Revise Note on “Tank Piping Schematic” as shown on C502.

Add Detail “Water and Electrical Lines to Tank Trench Detail.

Sheet S-102

Drawing Sheet S-102 has been added to the Contract Documents.

CHANGES TO BID DOCUMENTS:

Specification Section 00 11 13 – Notice to Contractors

The Final Completion Date has been extended to June 6, 2025.

Specification Section 00 41 13 – Contractor Bid Form

An allowance for ledge removal, which is listed as “Rock Removal” has been added to the Contractor Bid Form.

Specification Section 01 10 26 – Measurement & Payment

Section 1.2.B.5 has been updated to read:

Measurement for Rock Removal shall be by the in-place cubic yard prior to disturbance as required for construction of the proposed water line improvements, accepted in accordance with the Contract Documents.

An allowance for Rock Removal has been determined for this project. The contract cubic yardage price shall be full compensation for all labor, equipment, blasting, material, notification, survey and other incidentals required to complete the work, including removal and disposal of waste from the site, in the areas necessary to complete the project as shown on the Contract Drawings and in accordance with Contract Specifications. Pay width and depth for open rock removal shall be determined prior to disturbance and shall be coordinated with the Engineer. The pay width for trench rock removal for mains shall be 24 inches wider than the pipe diameter and the depth to 6 inches below pipes, and structures shall be width of structure plus 2 feet and the depth to 12 inches below structure. Costs associated with over blasting, removal beyond pre-determined volume, or fill requirement to replace over excavation will be considered incidental to the pay item and will be the responsibility of the Contractor to correct. Coordinate Rock Removal quantities with the Engineer.

PRE-BID MEETING MINUTES
CAMDEN HILLS STATE PARK WATER SYSTEM UPGRADES (BGS 3464)
Camden Hills State Park, Camden, Maine | May 14, 2024 | 10:00AM

A. INTRODUCTIONS

OWNERS

Maine Department of Agriculture, Conservation, and Forestry, Bureau of Parks and Lands
Ryan Kerr – Senior Planner
Ron Shaw – Assistant State Park Regional Manager

ENGINEERS

Sienna Roberge, P.E. – Haley Ward
Jeremy Beaulieu, P.E. – Haley Ward

B. SIGN-IN SHEET

This is a non-mandatory pre-bid meeting for the Camden Hills State Park Water System Upgrades project.

C. PROJECT DESCRIPTION & SCOPE OF WORK

The Work shall generally consist of water system upgrades at Camden Hills State Park in Camden, Maine, including installation of new water storage tanks, demolition of existing storage cistern, installation of new water distribution mains with related valves and appurtenances, installation of new conduits for Data and Telecommunications, selective demolition of the existing wellhouse, and construction of a new wellhouse with associated MEP systems. The Work shall be completed in two (2) phases.

The Owner is exempt from the State of Maine sales and use taxes on materials and equipment to be incorporated in the Work.

Owner reserves the right to reject any or all bids.

D. COMPLETION TIME & PROJECT SCHEDULE

The project shall designate the Substantial Completion Date on or before April 3, 2025 and the Contract Final Completion Date on or before May 1, 2025.

E. OBTAINING PLANS AND SPECIFICATIONS

Digital copies of the Project Manual may be obtained by contacting Haley Ward, Inc. at sroberge@haleyward.com. Prospective bidders must register with Haley Ward for their bid to be considered.

All questions must be submitted to the Engineer by **5:00 PM on Friday, May 17, 2024**, to allow for sufficient time to issue an addendum.

F. QUESTIONS DURING BID

Questions can be directed to Chip Haskell, P.E. at chaskell@haleyward.com.

G. BID ADDENDUM

Contractor is responsible for carefully examining any Addenda.

H. BID OPENING

Bids are due as an email addressed to BGS.Architect@Maine.gov no later than **2:00 PM on Thursday, May 30, 2024**. The email subject line shall be marked "Bid for Camden Hills State Park Water System Upgrades."

PRE-BID MEETING MINUTES

Project Name: Camden Hills State Park Water System Upgrades

Page 2

I. REQUIRED BID SUBMITTALS

1. Completed Contractor Bid Form
2. Bid Security

J. SAFETY

Contractor is responsible for safety.

K. SPECIAL CONSIDERATIONS

This project is being funded by the Bureau of General Services (BGS). Contractor must use BGS forms for payment applications and for any project changes.

L. STAGING, ACCESS, PARKING, USE OF FACILITIES

Contractor to coordinate with Owner for staging, access, parking, and use of facilities. Contractor is responsible for Traffic Control, as required.

M. WAGE RATES

See Specification Section 00 73 46 Wage Determination Schedule.

N. WORK OR SERVICES BY OTHERS

At this time, there is no other known work by others in this area.

O. MISCELLANEOUS

N/A

P. QUESTIONS

Questions received during the pre-bid meeting are answered herein and are also provided in Addendum 1.

Q: Can water service to the maintenance shop be completed in Phase 2 or does it have to be completed in Phase 1?

A: Yes, water service to the maintenance shop can be completed in either Phase 1 or Phase 2 as long as progress is being made toward completion of the work within the project timeline.

Q: Have any materials (e.g., tanks) been pre-purchased?

A: No materials have been pre-purchased.

Q: What is the anticipated lead time on the water tanks?

A: Previous correspondence by Engineer with The National Tank Outlet anticipated a lead time of 2 days for 10,000-gallon tanks that ship from Ohio. Contractor is responsible for confirming lead times.

Q: When does Phase 1 need to be completed?

A: Phase 1 must commence to run upon receipt of a Notice to Proceed. The proposed water tanks shall be constructed and tied into the existing water system within 60 days of Contract commencement.

Q: Has an Engineer's opinion of cost been provided?

A: Per Specification Section 00 11 13 Notice to Contractors, the cost of work is anticipated to be approximately \$1,200,000.

Q: Will the proposed tanks be set on a concrete slab? Can you provide a detail for the concrete slab underneath the proposed tanks?

A: Yes. Please see Drawing Sheet S-102, which has been added to the Contract Documents per Addendum 1.

Q: What is the material and size of existing water pipe that new water pipe will be joined to?

A: The existing water pipe to the existing storage cistern is 3-inch butt-fused IPS polyethylene (PE) pipe.

Q: Will new HDPE water mains be IPS or CTS?

A: New HDPE water mains shall be IPS per the Contract Documents.

PRE-BID MEETING MINUTES

Project Name: Camden Hills State Park Water System Upgrades

Page 3

Q: How is the presence of ledge being quantified?

A: An allowance has been added to the Contractor Bid Form per Addendum 1.

Q: Has a staging area been identified?

A: The Owner prefers that staging be located near to the existing maintenance shop. For Work on the proposed water tanks and associated water lines, staging can be located near to the water tanks as long as roadway accesses are not obstructed.

Q: When is it anticipated that the campground will close for the regular season?

A: It is anticipated that the campground will close for regular use on or about October 1st.

Q: Can you provide a detail for the typical water and conduit trench to/from the proposed water tanks?

A: Yes. Please see the Water and Electrical Lines to Tank Trench Detail on Drawing Sheet C502 per Addendum 1.

Q: Can the final completion date be extended to allow for pavement?

A: Yes. The final completion date has been extended to June 6, 2025, per Addendum 1.

Q: How should the existing 60,000-gallon steel tank and existing 5,000-gallon cistern be demolished?

A: Remove the steel tank materials to grade. Material below grade may be left in place. Remove the top structure over the cistern. Material below grade may be left in place. Fill in open excavations and the existing cistern with gravel.

Q: Will the proposed building be insulated?

A: Yes, see Architectural Sections.

Q: Will fill be required for placement of the proposed water tanks?

A: Fill is not anticipated to be required. See Drawing Sheets C502 and S-102 for details and proposed elevations.

Q: Can the water main be directionally bored for installation instead of trenching?

A: No, HDPE water main must be installed within sand bedding per Typical Trench Detail – HDPE Water Main on Drawing Sheet C501.

Q: What should be done with incidentally removed trees?

A: Fallen trees and newly felled trees along the path from the well house to the storage tanks can be pushed off to the side of the path and left on site. Do not pile trees in large piles. Trees felled within the park shall be brought to the yard near the existing maintenance building and piled there for the park to remove.

CAMDEN HILLS STATE PARK WATER SYSTEM UPGRADES

CAMDEN, MAINE

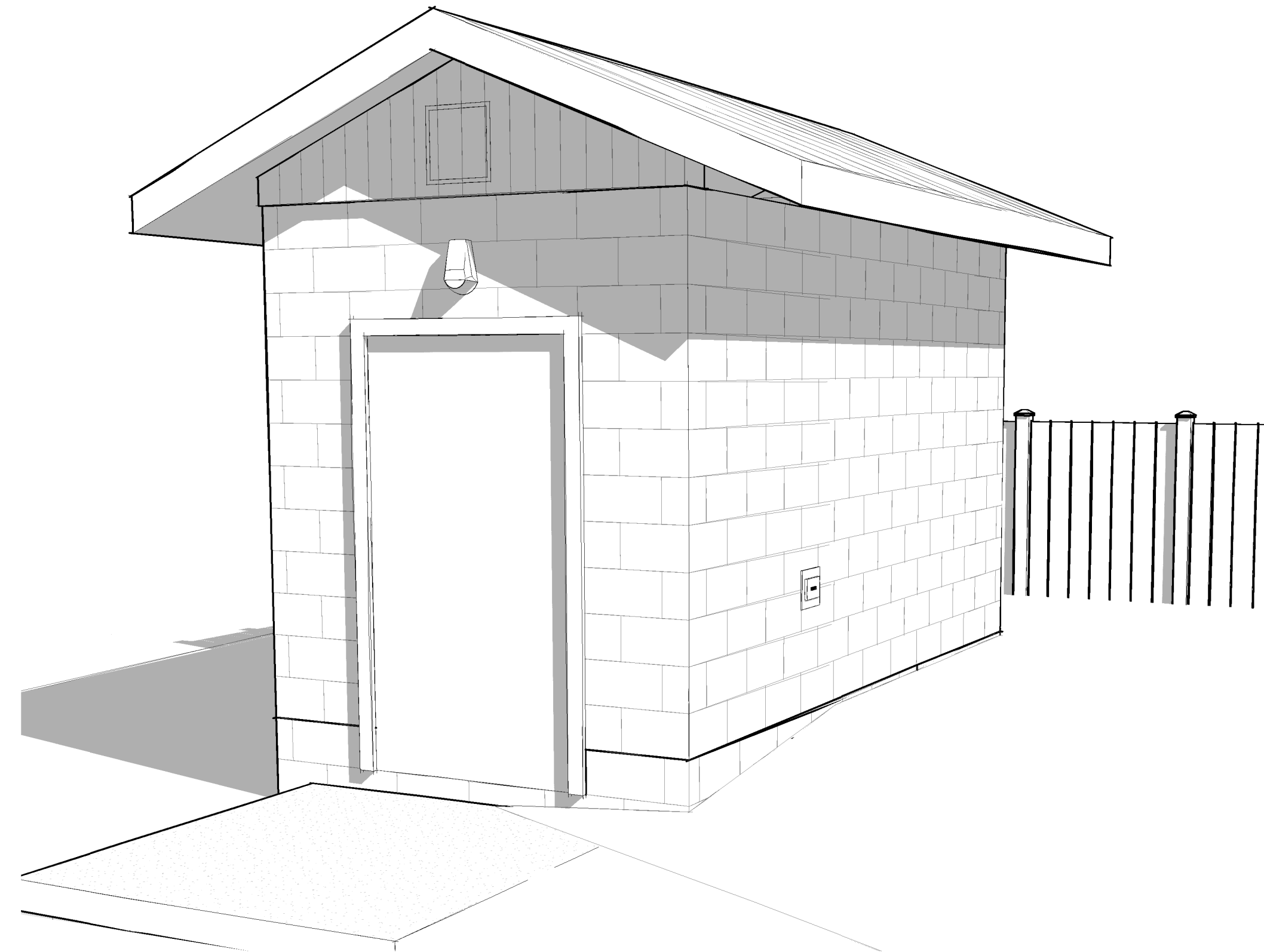

ISSUED FOR BID

2024.04.08

HALEY WARD PROJECT NUMBER: 14641.001

BGS PROJECT NUMBER: 3464



HALEY WARD

ENGINEERING | ENVIRONMENTAL | SURVEYING

SHEET LIST

Sheet Number	Sheet Name	Current Revision
G0	COVER	A
C001	GENERAL NOTES & LEGEND	
C100	SITE OVERALL PLAN	A
C101	SITE UTILITY PLAN	
C102	SITE UTILITY PLAN	A
C501	SITE DETAILS	
C502	SITE DETAILS	A
S-001	STRUCTURAL NOTES, SYMBOLS & ABBREVIATIONS	
S-101	STRUCTURAL FOUNDATION & FRAMING PLANS	
S-102	EQUIPMENT SLAB PLAN, SECTION, DETAILS AND NOTES	A
S-501	STRUCTURAL SECTIONS, ELEVATIONS AND DETAILS	
A-001	ARCHITECTURAL NOTES, SYMBOLS, ABBREVIATIONS & DETAILS	
AD101	EXISTING & DEMOLITION PLANS	
A-101	FLOOR PLANS & ISOMETRICS	
A-201	BUILDING ELEVATIONS	
A-301	BUILDING SECTIONS	
P-001	PLUMBING NOTES, SYMBOLS & ABBREVIATIONS	
P-101	PLUMBING PLANS	
P-501	PLUMBING DETAILS	
M-001	MECHANICAL NOTES, SYMBOLS & ABBREVIATIONS	
M-101	MECHANICAL PLANS & SCHEDULES	
M-501	MECHANICAL DETAILS	
E-001	ELECTRICAL ABBREVIATIONS, NOTES & SYMBOLS	
E-101	ELECTRICAL POWER & LIGHTING PLANS	
E-501	ELECTRICAL DETAILS & SCHEDULES	

7 6 5 4 3 2 1

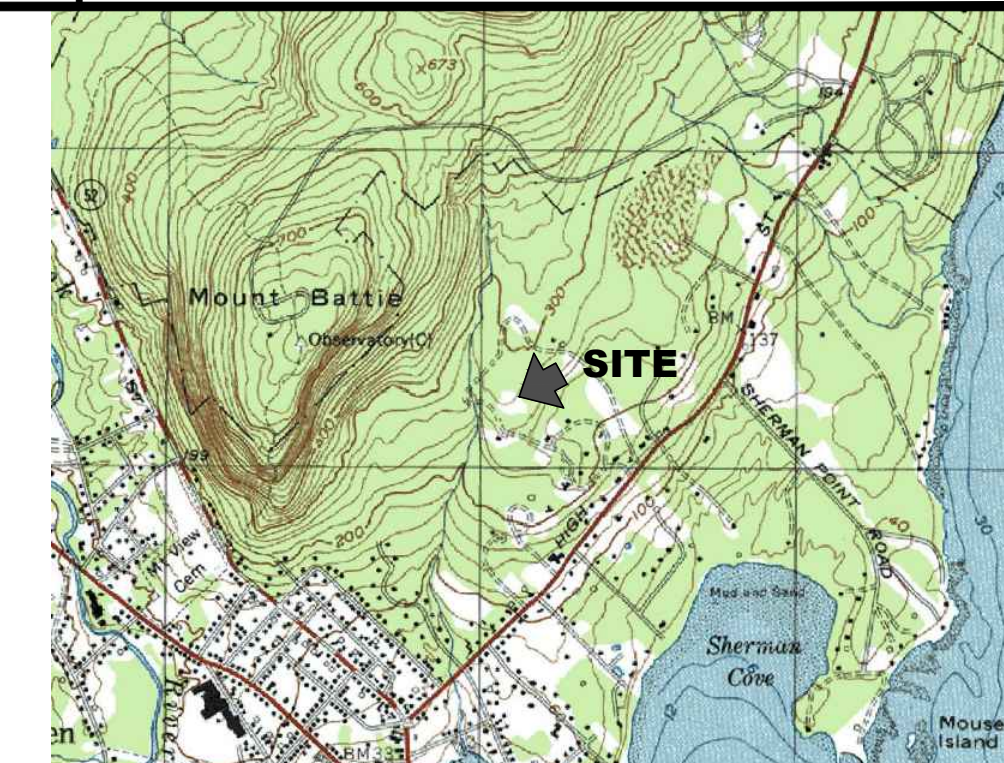
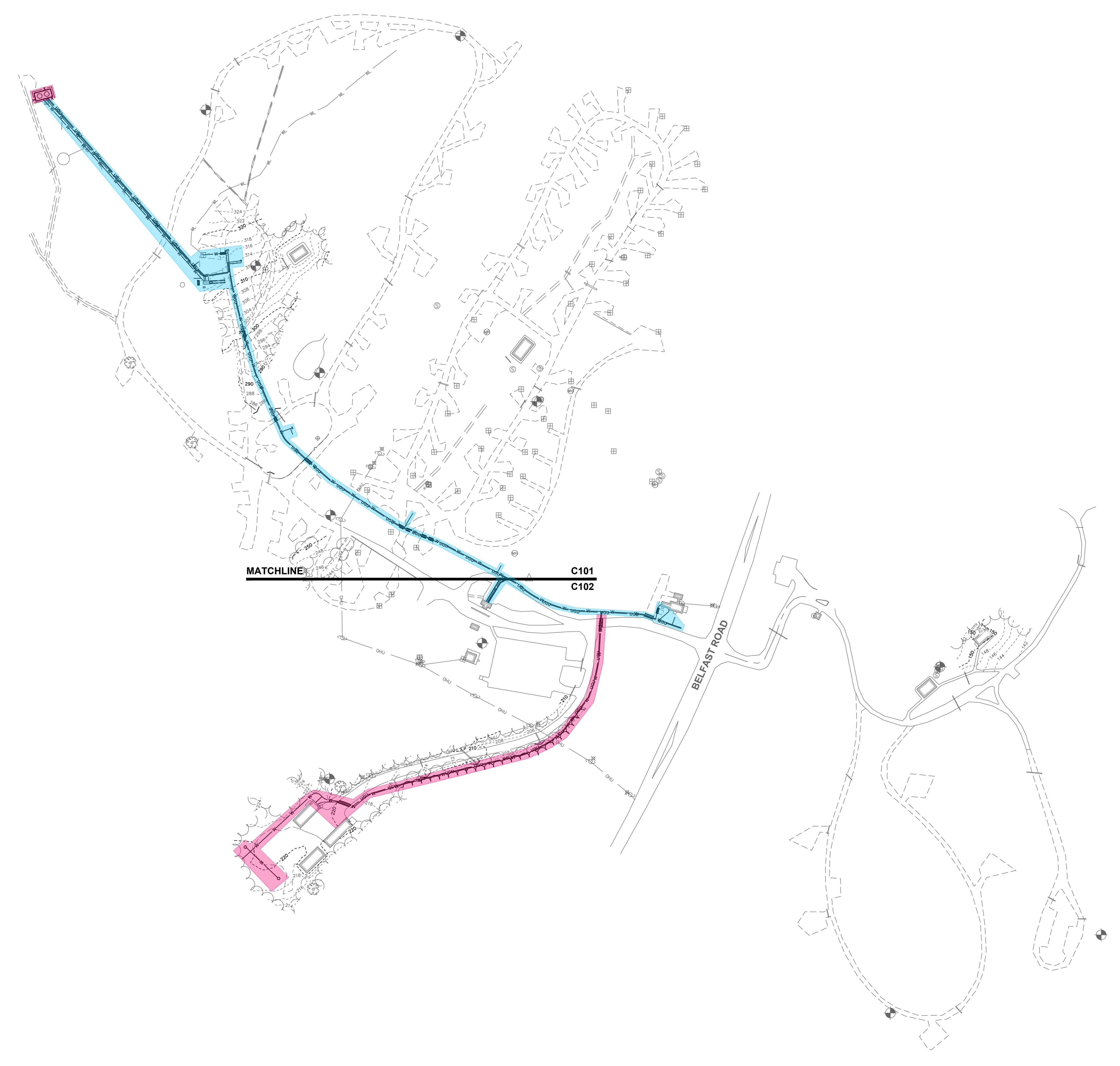

LOCATION MAP: USGS QUADRANGLE: CAMDEN
 MAPTECH® USGS TOPOGRAPHIC SERIES™
 ©MAPTECH®, INC. 978-933-3000
 WWW.MAPTECH.COM/TOPO

- BID PHASE I
- BID PHASE II

PLAN REFERENCE:
 INFORMATION BASED ON CONDITIONS AS FOUND AND
 SURVEYED BY HALEY WARD, INC ON JANUARY 25, 2024.

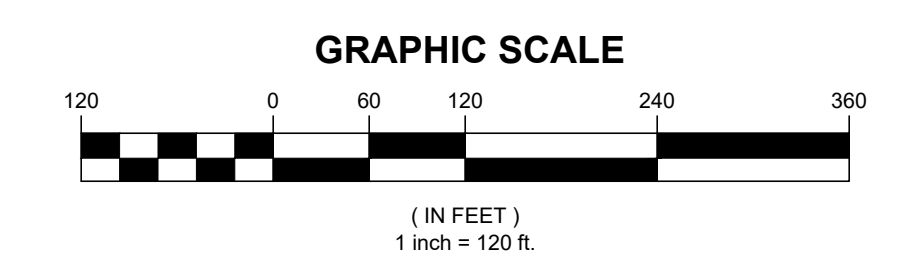

A	2024.05.22	ADDENDUM #1	WAB	ALF
REV.	DATE	DESCRIPTION	BY	CHK.

DRAWING ISSUE STATUS
ISSUED FOR BID

PROJECT
**CAMDEN HILLS STATE PARK WATER SYSTEM
 UPGRADES
 CAMDEN, MAINE**

TITLE
SITE OVERALL PLAN

	DATE	2024.04.08	SCALE	1"=120'
	DRAWN BY	WAB	DESIGNED BY	ALF
	CHECKED BY	ACH	PROJECT No.	HW# 14641.001 - BGS# 3464
	DRAWING No.	C100	REV.	A

FILE LOCATION: P:\MET1641\BUREAU OF PARKS AND LANDS\BUREAU\CAMDEN HILLS STATE PARK\ACR\DCAD_FILES\DWG\164101\CS-01.DWG, 2024.05.22, 11:59 AM

7 6 5 4 3 2 1

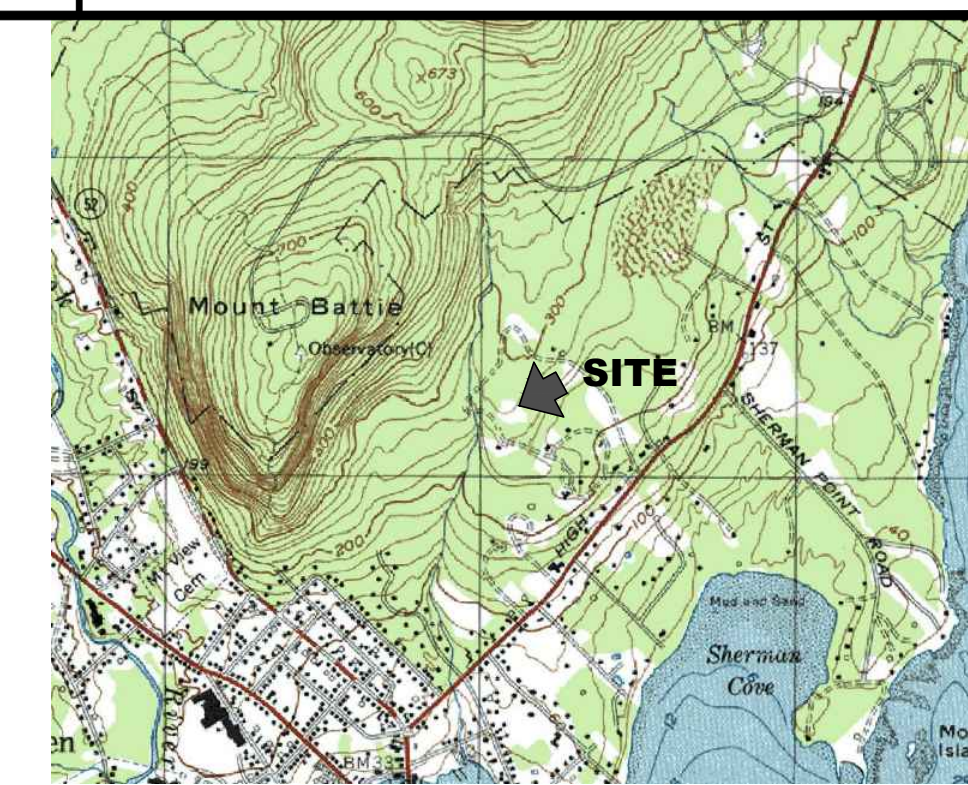

LOCATION MAP: USGS QUADRANGLE: CAMDEN MAPTECH® USGS TOPOGRAPHIC SERIES™, ©MAPTECH®, INC. 978-933-3000 WWW.MAPTECH.COM/TOPO

SHEET C102 GENERAL NOTES:

1. ALL DATA CONDUIT SHALL BE 1" DURALINE PINPOINT (TRACEABLE) WITH PRE-INSTALLED PULL TAPE UNLESS NOTED OTHERWISE.
2. ALL DATA PULLBOXES SHALL BE 14"x19" OLDCASTLE INFRASTRUCTURE 14191011 GREEN ELECTRIC ENCLOSURES.
3. ALL DATA CONDUITS CROSSING ROADWAYS SHALL BE SLEEVED WITH 2-1/2" SCHEDULE 80 PVC CONDUIT.
4. COORDINATE ALL BUILDING DATA ENTRANCE LOCATIONS WITH OWNER PRIOR TO TRENCHING.
5. ALL DATA CONDUITS SHALL BE ROUTED WITHIN THE SAME TRENCH AS THE NEW WATER LINES. MAINTAIN AN MINIMUM OF 2'-6" HORIZONTAL CLEARANCE BETWEEN DATA AND WATER.
6. CONTRACTOR TO ABANDONED AND CAP EXISTING WATERLINES THAT CAUSE A CONFLICT WITH THE PLACEMENT OF THE PROPOSED WATERLINES SHALL BE REMOVED AND DISPOSED OF BY THE CONTRACTOR.

PLAN REFERENCE: INFORMATION BASED ON CONDITIONS AS FOUND AND SURVEYED BY HALEY WARD, INC ON JANUARY 25, 2024.

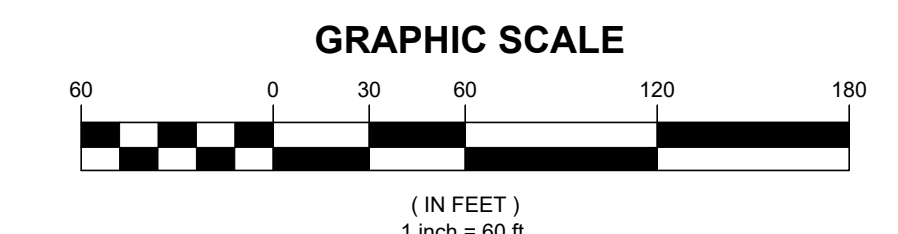

REV.	DATE	DESCRIPTION	BY	CHK.
A	2024.05.22	ADDENDUM #1	WAB	ALF

ISSUED FOR BID



PROJECT: CAMDEN HILLS STATE PARK WATER SYSTEM UPGRADES CAMDEN, MAINE

TITLE: SITE UTILITY PLAN

DATE	2024.04.08	SCALE	1"=60'
DRAWN BY	WAB	DESIGNED BY	ALF
CHECKED BY	ACH		
PROJECT No.	HW# 14641.001 - BGS# 3464		
DRAWING No.	C102		
REV.	A		

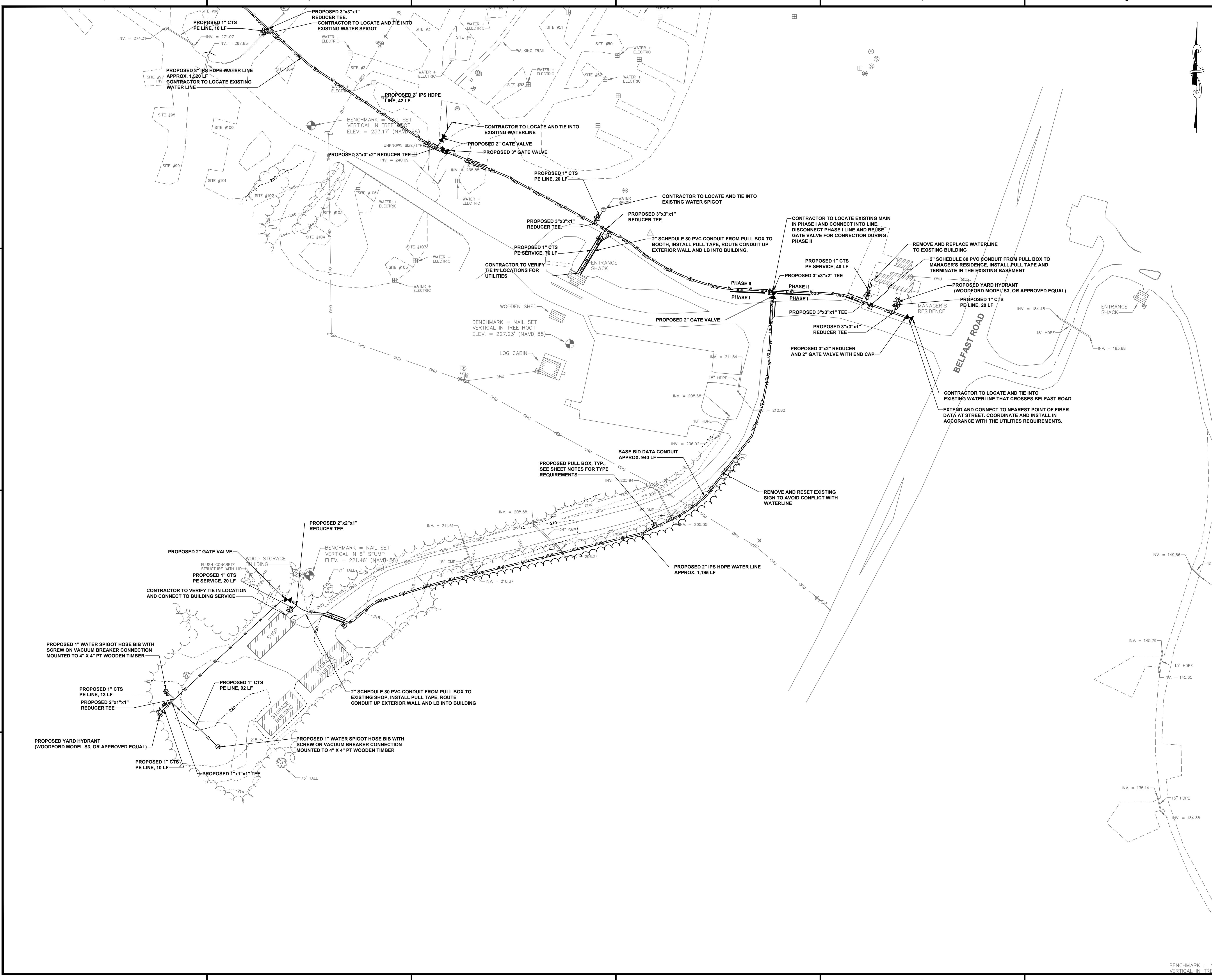
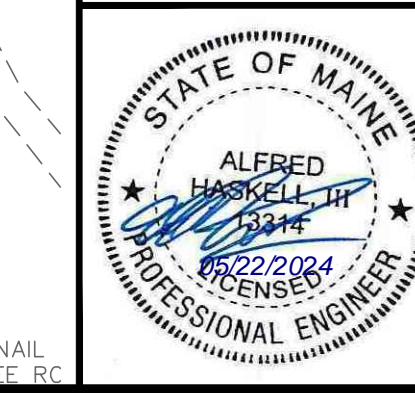

FILE LOCATION: P:\MET1641-BUREAU OF PARKS AND LANDS\BUREAU\CAMDEN HILLS STATE PARK-ACRIS\CAD_FILES\CAD\1641.01-C-01-DWG_2024.05.21_150.PLM

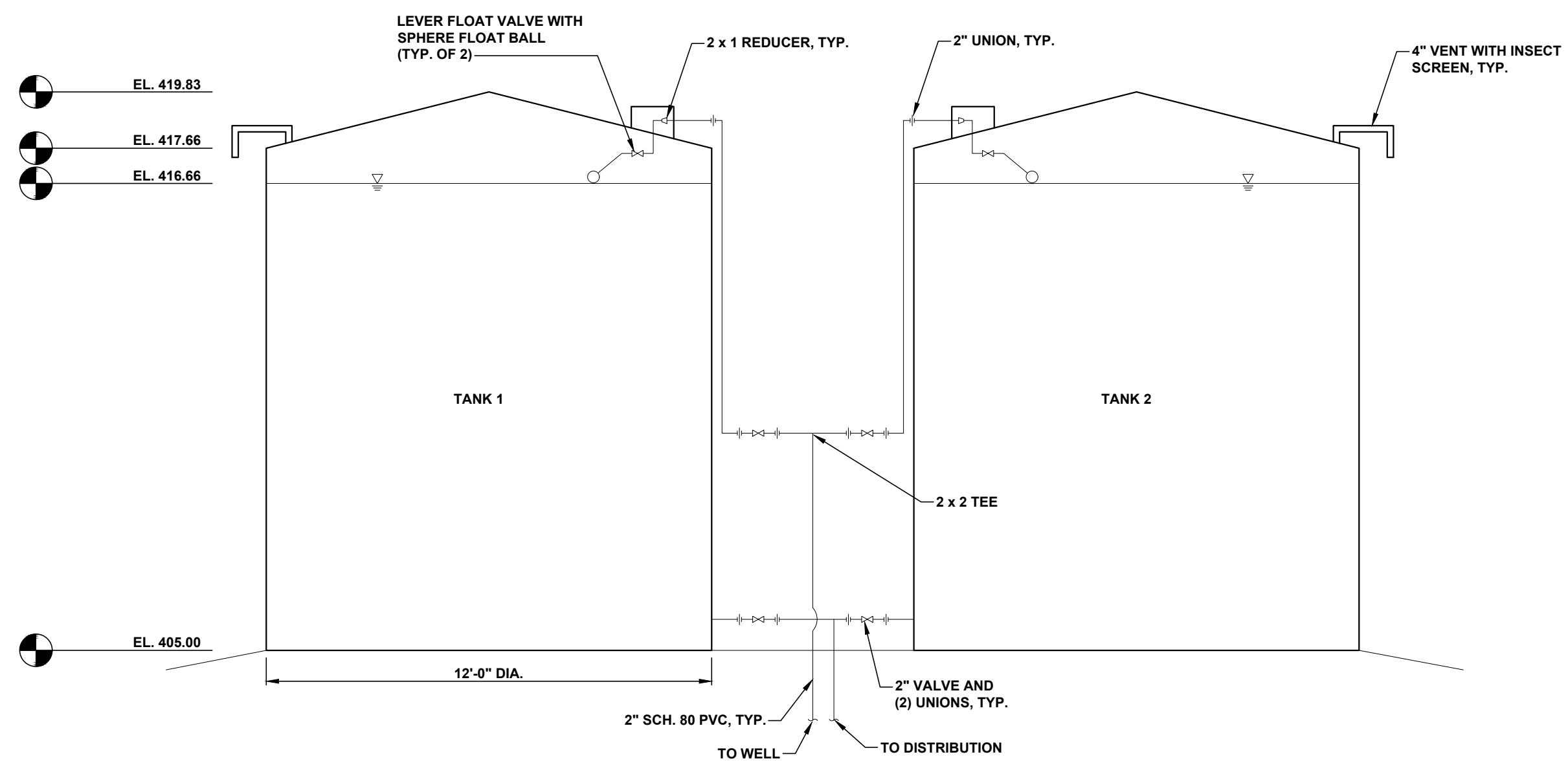

NOTE: SEE SHEET S-102 FOR CONCRETE PAD AND UNISTRUT BRACING DETAILS.
TANK PIPING SCHEMATIC
N.T.S.

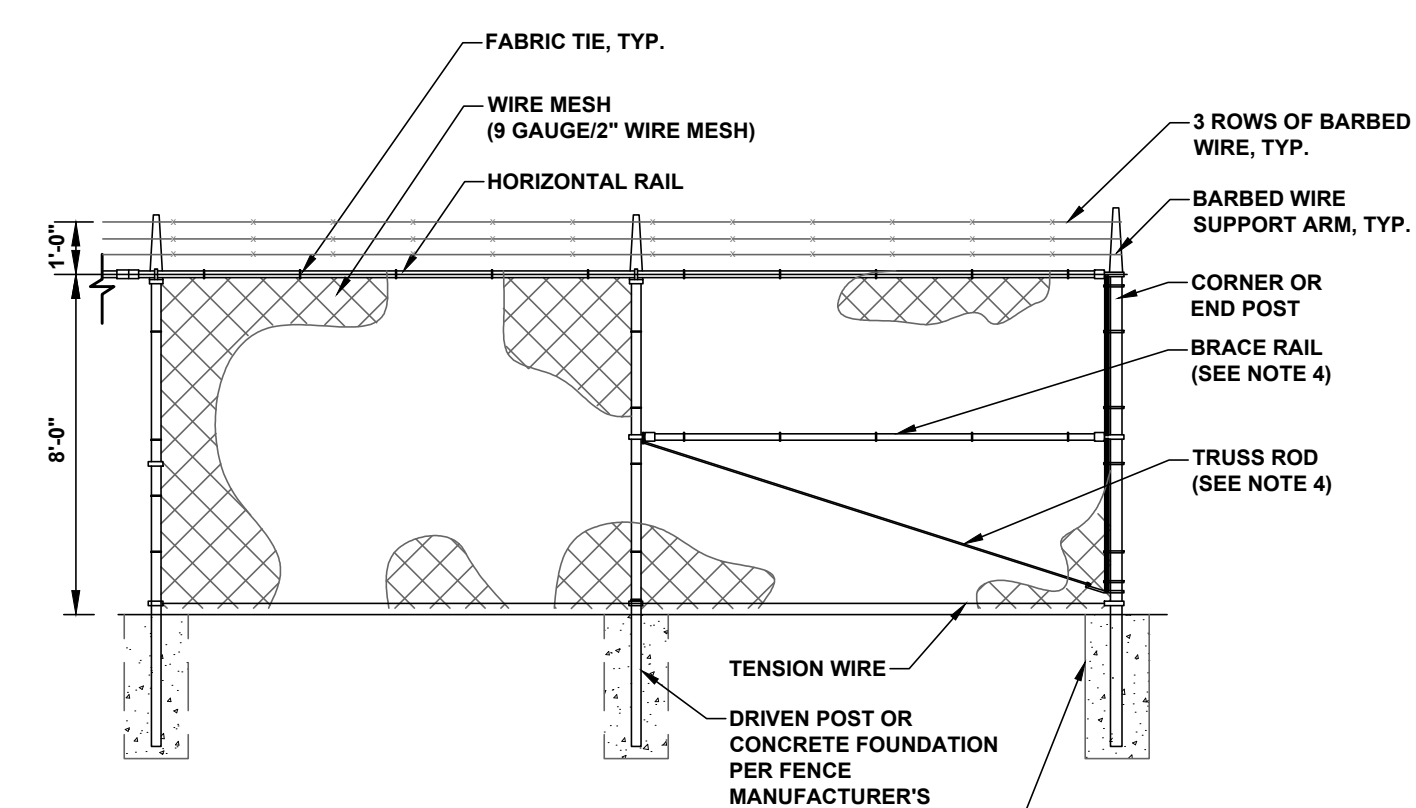

- NOTES:
1. THE FENCE SHALL MEET OR EXCEED THE CHAIN LINK FENCE MANUFACTURER INSTITUTE (ICFMI) GUIDELINES AND RELATED FEDERAL SPECIFICATIONS FOR SECURITY CHAIN LINK FENCE MATERIALS AND INSTALLATION.
 2. ALL FENCE MATERIAL AND COMPONENTS SHALL BE GALVANIZED, UNLESS OTHERWISE NOTED.
 3. THIS DETAIL NOT APPLICABLE FOR PRIVACY FENCE OR FENCE WITH SLATS.
 4. ADJUSTABLE TRUSS ROD AND BRACE RAIL AT CORNER OR END POSTS ONLY, IF REQUIRED PER MANUFACTURER RECOMMENDATION.

CHAIN LINK FENCE WITH BARBED WIRE DETAIL
N.T.S.

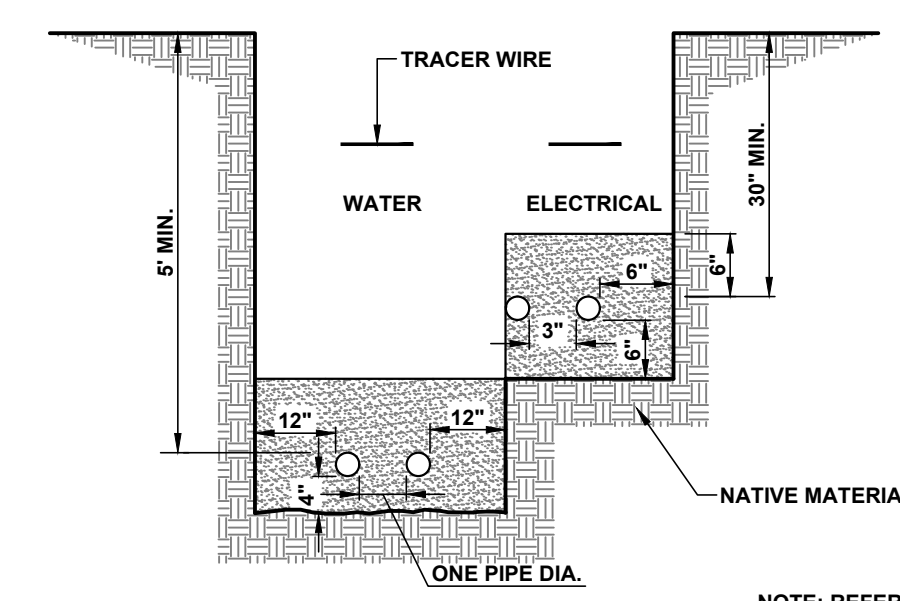

NOTE: REFER TO TYPICAL WATER TRENCH AND TYPICAL ELECTRICAL TRENCH DETAILS FOR ADDITIONAL INFORMATION.

WATER AND ELECTRICAL LINES TO TANK TRENCH DETAIL
N.T.S.

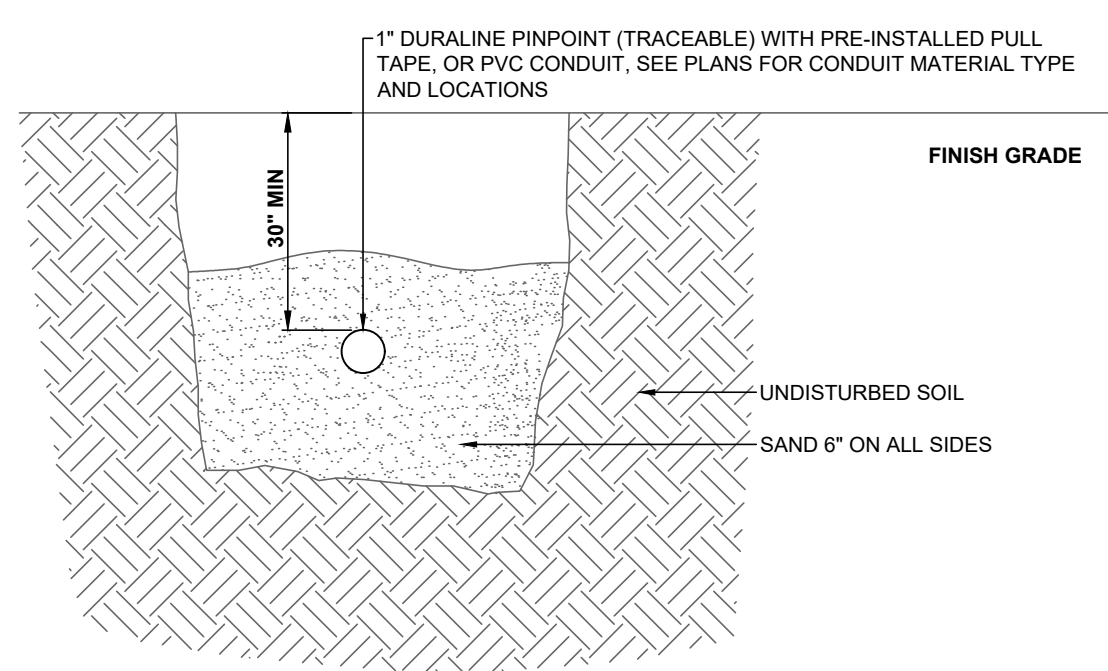

- NOTES:
1. MAINTAIN A MINIMUM OF 3" DEPTH UNDER ROADWAYS AND SLEEVE DURALINE CONDUIT WITHIN 2-1/2" SCHEDULE 80 PVC CONDUIT.
 2. MAINTAIN A MINIMUM OF 2'-6" HORIZONTALLY BETWEEN WATER LINE AND TELECOMMUNICATIONS CONDUIT.
 3. ALL MAIN COMM CONDUIT RUNS SHALL BE DURALINE PINPOINT (TRACEABLE). PVC CONDUIT SHALL ONLY BE USED FROM PULLBOX TO BUILDING TERMINATIONS. SEE PLANS FOR ADDITIONAL INFORMATION.

TYPICAL TELECOMMUNICATIONS TRENCH DETAIL
N.T.S.

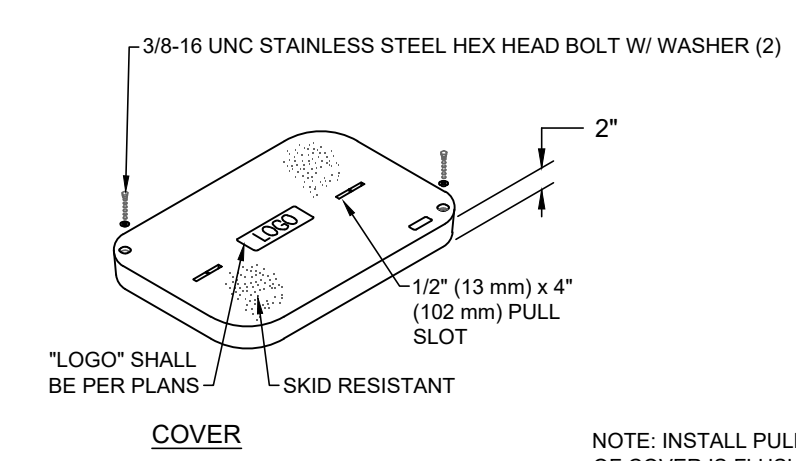

NOTE: INSTALL PULL BOX SO THAT TOP OF COVER IS FLUSH WITH FINISH GRADE.

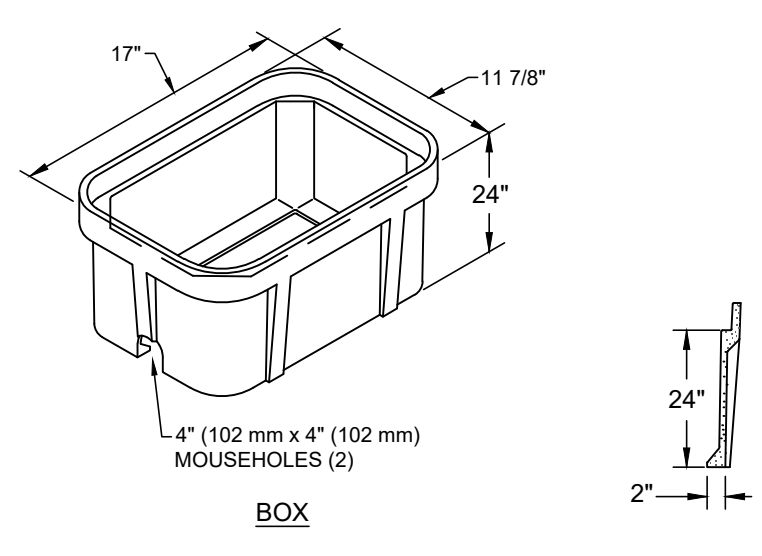

14x19 IN-GRADE COMM PULL BOX DETAIL
N.T.S.

FILE LOCATION: P:\MET\1641-BUREAU OF PARKS AND LANDS\1641-CAMDEN HILLS STATE PARK-ADRIAN\1641-01-10-2024\DWG_20240622_1159.PLT

A	2024.05.22	ADDENDUM #1	WAB	ALF
REV	DATE	DESCRIPTION	BY	CHK

DRAWING ISSUE STATUS
ISSUED FOR BID

HALEY WARD
ENGINEERING | ENVIRONMENTAL | SURVEYING
www.haleyward.com
One Merchants Plaza, Suite 701
Bangor, Maine 04401
207.989.4824

PROJECT
CAMDEN HILLS STATE PARK WATER SYSTEM UPGRADES
CAMDEN, MAINE

TITLE
SITE DETAILS

DATE	2024.04.08	SCALE	NTS
DRAWN BY	WAB	DESIGNED BY	ALF
CHECKED BY	ACH		
PROJECT No.	HW# 14641.001 - BGS# 3464		
DRAWING No.	C502		
REV	A		

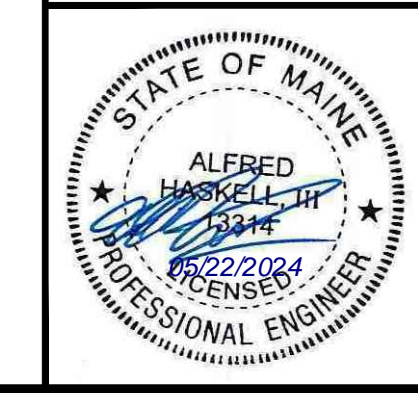

FILE LOCATION: P:\ME14641-BUREAU OF PARKS AND LANDS\001-CAMDEN HILL STATE PARK\ACH02-CAD_FILES\STRUCTURAL\WATER TANK CONCRETE PAD - STRUCTURAL DRAWING SET - 14641.001 - 3.22.2024.DWG, 2024.05.22, 9:04 AM

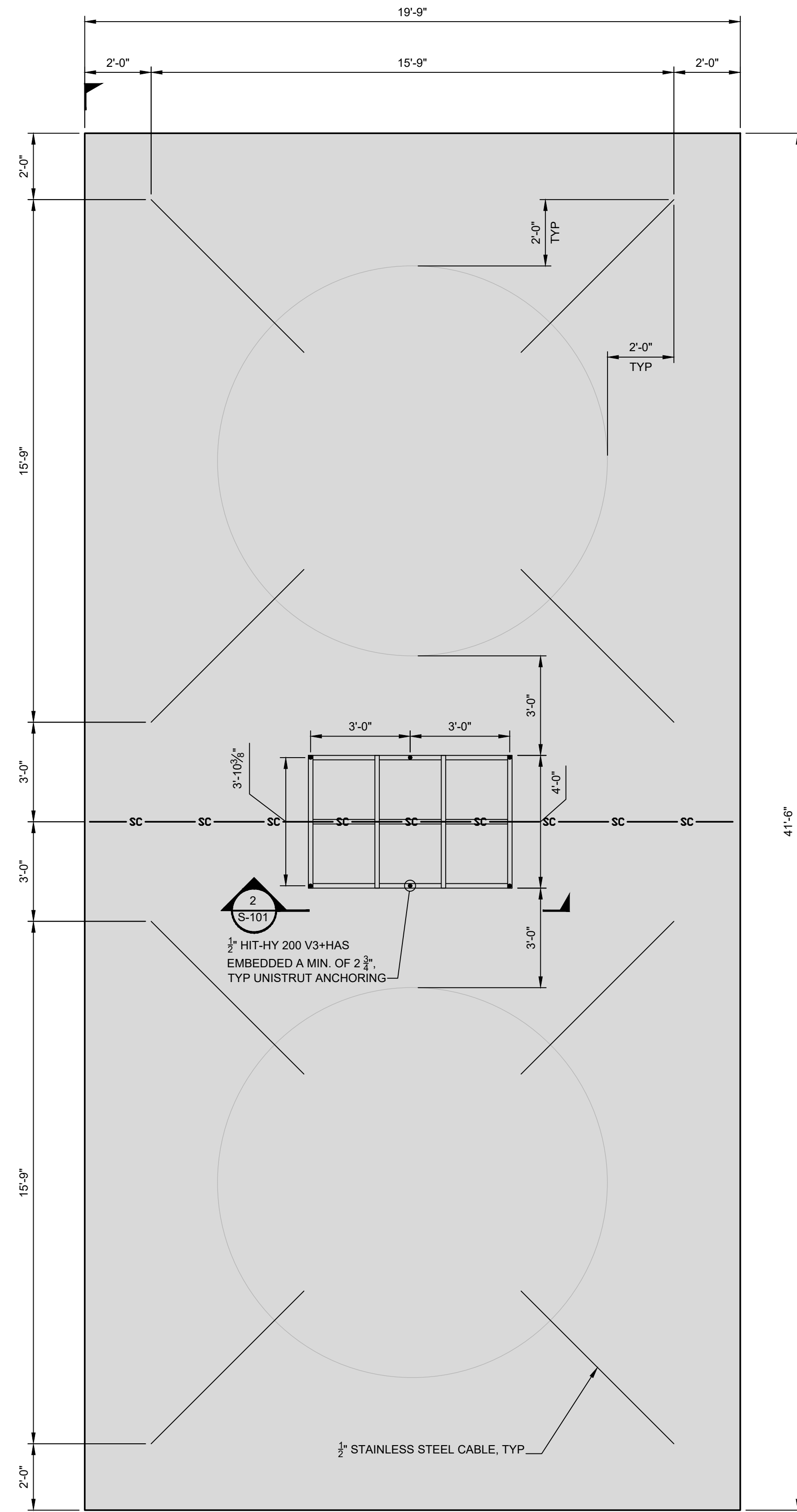

WATER TANK CONCRETE PAD
SCALE: 3/8" = 1'-0"

INDICATES EARLY ENTRY SAW CUT. SEE DETAIL THIS DRAWING

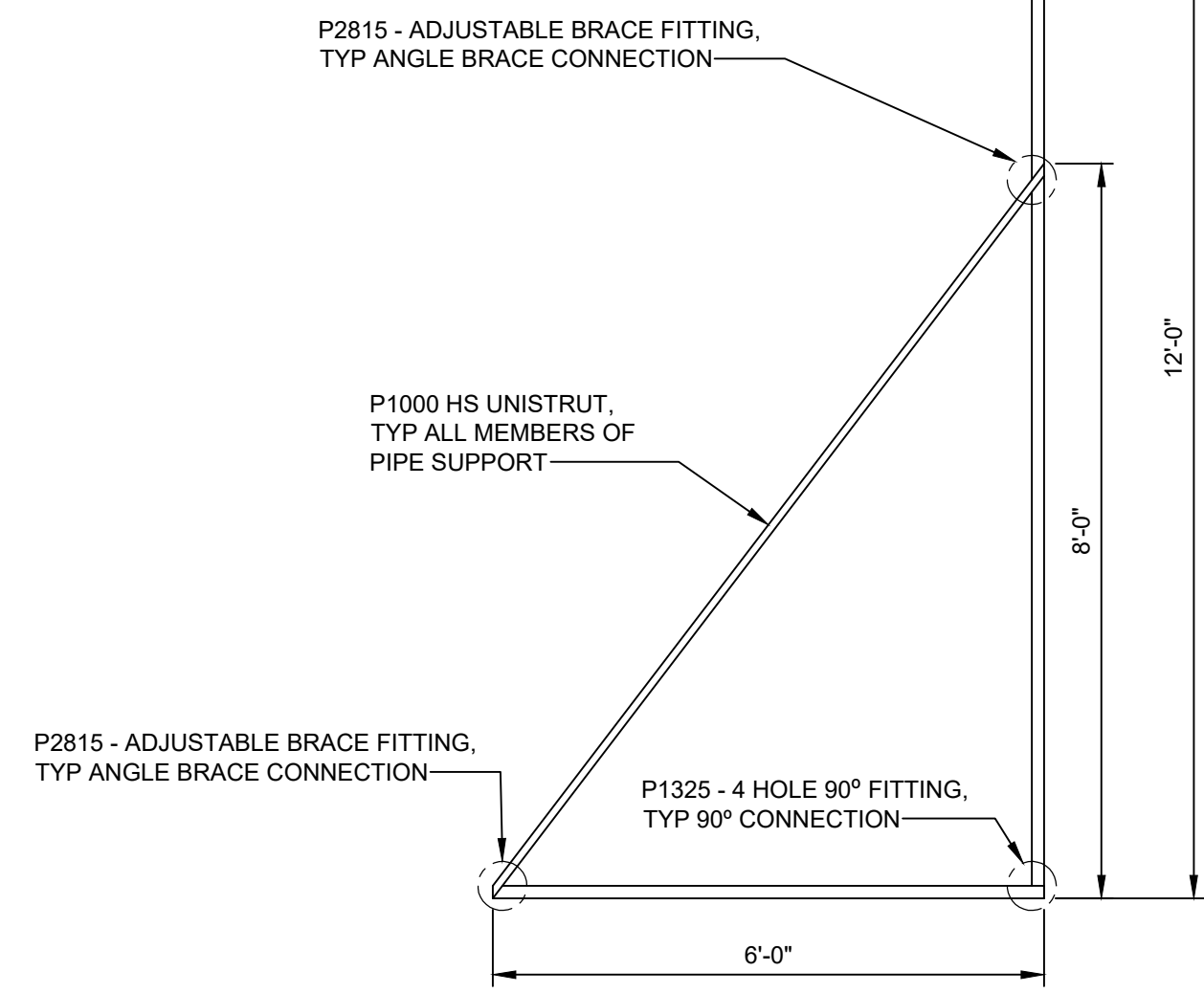

SECTION 2
SCALE: 1/2" = 1'-0"

NOTE: ALL CONNECTIONS FOR UNISTRUT ON PIPE SUPPORT SHOULD CONSIST OF 1/2" BOLTS

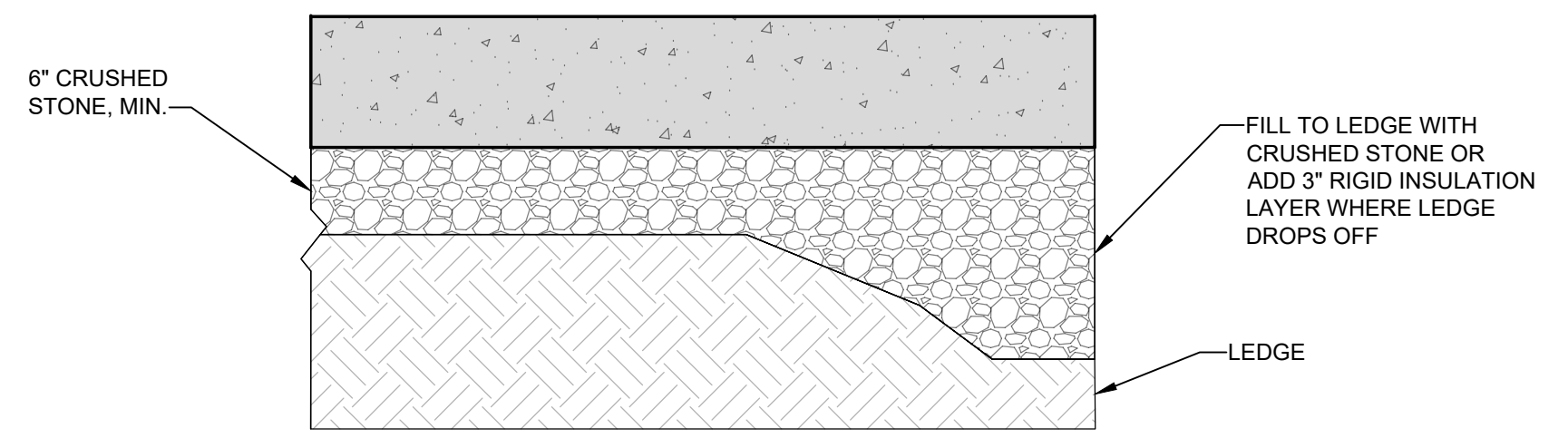

TYPICAL DETAIL FOR CONCRETE PAD AT LEDGE
SCALE: 3/4" = 1'-0"

FOUNDATION NOTES:

- DESIGN OF FOUNDATIONS IS BASED ON AN ALLOWABLE SOIL BEARING PRESSURE OF 2000 POUNDS PER SQUARE FOOT.
- ALL DELETERIOUS MATERIALS FOUND WITHIN THE LIMITS OF THE STRUCTURE, AS DETERMINED BY THE TESTING AGENCY, SHALL BE REMOVED AND REPLACED WITH COMPACTED SELECT FILL.
- NO FOUNDATIONS SHALL BE PLACED ON FROZEN GROUND OR IN WATER.
- SELECT FILL AND BACKFILL MATERIAL SHALL BE SCREENED OR CRUSHED GRAVEL OF HARD DURABLE PARTICLES FREE FROM VEGETABLE MATTER, LUMPS, BALLS OF CLAY AND OTHER DELETERIOUS SUBSTANCES. SELECT FILL SHALL CONFORM TO THE FOLLOWING GRADATION REQUIREMENTS:

SELECT FILL - GRADATION REQUIREMENTS	
SIEVE SIZE	PERCENT FINER BY WEIGHT
4 INCH	100
3 INCH	90 - 100
1/4 INCH	25 - 90
No. 40	0 - 30
No. 200	0 - 5

- ON SITE MATERIALS GENERATED DURING EXCAVATION MAY BE USED AS BACKFILL MATERIAL PLACED ADJACENT TO FOUNDATION WALLS PROVIDED IT MEETS THE GRADATION REQUIREMENTS FOR SELECT FILL.
- CONCRETE FOR FOUNDATIONS SHALL COMPLY WITH THE CONCRETE NOTES:

STAINLESS STEEL NOTES:

- ALL STRUCTURAL STEEL MATERIALS AND WORKMANSHIP SHALL CONFORM TO THE AMERICAN INSTITUTE OF STEEL CONSTRUCTION'S "SPECIFICATION FOR STRUCTURAL STEEL BUILDINGS" AND THE "AISC CODE OF STANDARD PRACTICE."
- EXISTING STEEL SHALL BE CLEANED OF ALL PAINT, DIRT, GREASE, ETC. PRIOR TO WELDING ATTACHMENTS.
- ALL STRUCTURAL STEEL SHAPES AND PLATES SHALL CONFORM TO THE FOLLOWING:

A. STAINLESS STEEL:	304 STAINLESS STEEL
UNISTRUTS	
- BOLTED CONNECTIONS SHALL BE MADE WITH MINIMUM 1/2" DIAMETER GRADE 18.8 HIGH STRENGTH STAINLESS STEEL BOLTS COMPLETE WITH NUTS AND WASHERS.
- STEEL BEAMS AND COLUMNS SHALL BE CUT FROM FULL LENGTH STOCK. UNAUTHORIZED SPLICES WILL BE CAUSE FOR REJECTION.

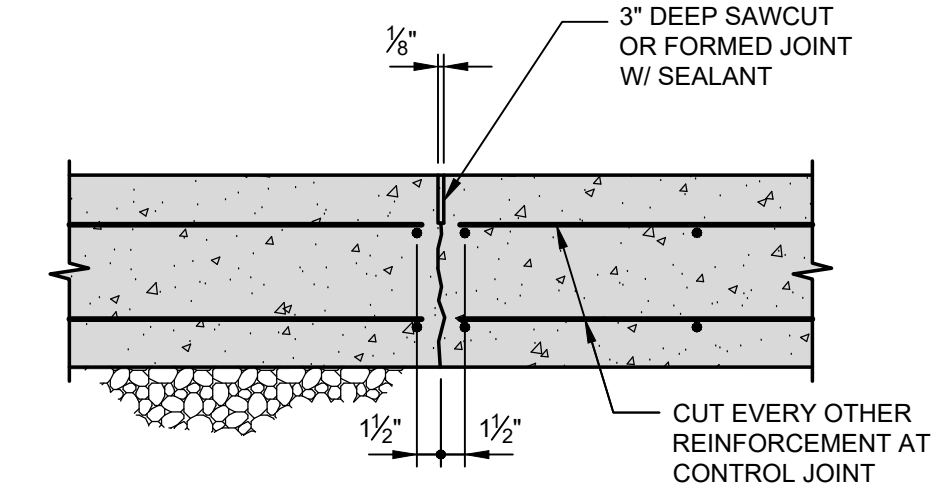

TYPICAL EARLY ENTRY SAW CUT JOINT DETAIL
SCALE: 1" = 1'-0"

NOTE: SAW CUT CONTROL JOINTS SHALL BE CUT WITH AN EARLY ENTRY DRY-CUT SAW AS SOON AS THE CONCRETE IS SUFFICIENTLY HARD TO RESIST TEARING AND RAVELING (1 TO 4 HOURS AFTER FINISHING).

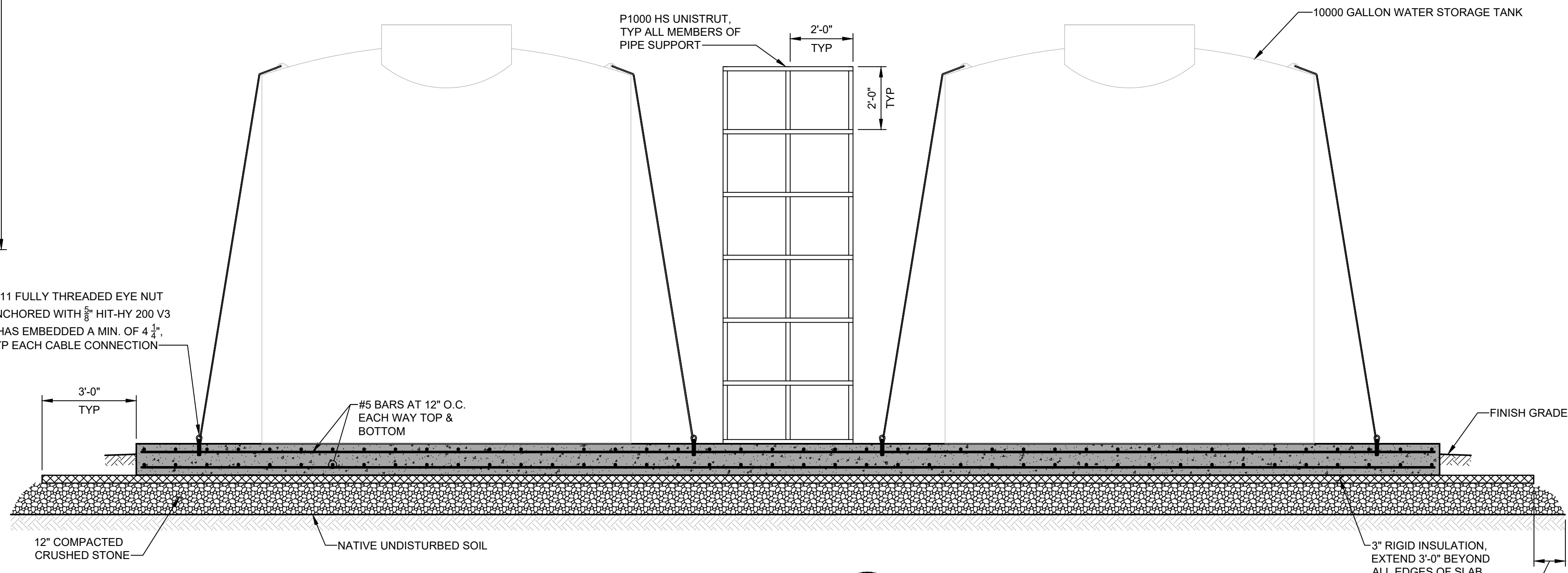

SECTION 1
SCALE: 3/8" = 1'-0"

NOTE: WATER PIPE TO BE INSTALLED FOR WATER TANKS MUST BE INSTALLED OUTSIDE OF THE RIGID INSTALLATION AND COMPACTED FILL AREAS.

CONCRETE NOTES:

- ALL CONCRETE MATERIALS AND WORKMANSHIP SHALL CONFORM TO THE LATEST EDITIONS OF ACI 318 AND ACI 301.
- ALL 5000 PSI CONCRETE SHALL BE AS FOLLOWS UNLESS NOTED OTHERWISE:

A. MINIMUM COMPRESSIVE STRENGTH:	5000 PSI @ 28 DAYS
B. CEMENT:	ASTM C150 TYPE II
C. AGGREGATE:	ASTM C33 OR C330
D. MAXIMUM AGGREGATE SIZE:	1 INCH
E. MAXIMUM WATER-CEMENT RATIO:	0.40
F. SLUMP:	2 TO 4 INCHES
G. AIR ENTRAINMENT:	ASTM C260, 6 PERCENT ±1.5
H. WATER REDUCING ADMIXTURE:	ASTM C494

 - ADMIXTURES SHALL BE USED IN ACCORDANCE WITH ACI AND THE MANUFACTURERS RECOMMENDATIONS.
 - USE OF CALCIUM CHLORIDE, CHLORIDE IONS OR OTHER SALTS IS NOT PERMITTED.
- REINFORCING BARS SHALL CONFORM TO ASTM A615, GRADE 60, DEFORMED BARS. REINFORCING BARS TO BE WELDED SHALL BE ASTM A706, GRADE 60, DEFORMED BARS.
- PROVIDE ALL NECESSARY CHAIRS, CHAIR BARS, SPACERS, ETC. WIRED SECURELY TO HOLD REINFORCEMENT IN POSITION. THESE ACCESSORIES SHALL BE PLASTIC BOOTED WHERE CONCRETE IS TO BE EXPOSED TO WEATHER OR MOISTURE.
- CONCRETE COVER TO REINFORCING STEEL SHALL CONFORM TO ACI 318 AS FOLLOWS:

A. CONCRETE CAST AGAINST EARTH:	3"
B. CONCRETE EXPOSED TO EARTH OR WEATHER:	#3 THRU #5: 1 1/2" #6 THRU #11: 2"
C. CONCRETE NOT EXPOSED TO WEATHER OR PLACED IN CONTACT WITH GROUND:	SLABS/WALLS: 3/4" BEAMS/COLUMNS: 1 1/2"
- REINFORCING BARS SHALL BE PLACED IN ACCORDANCE WITH THE LATEST EDITION OF THE CRSI "RECOMMENDED PRACTICE FOR PLACING REINFORCING BARS".
- ALL LAP SPLICES SHALL BE ACI CLASS B SPLICES. THE FOLLOWING TABLES ARE BASED ON NORMAL WEIGHT CONCRETE WITH BARS 4 BAR DIAMETERS OR MORE APART AND CONCRETE COVER EQUAL TO 2 BAR DIAMETERS OR MORE. TOP BARS ARE DEFINED AS HORIZONTAL BARS WITH MORE THAN 12 INCHES OF CONCRETE PLACED BELOW THE REINFORCEMENT.

5000 PSI CONCRETE	GRADE 60 REINFORCING STEEL fy = 60,000 PSI										
	BAR SIZE	#3	#4	#5	#6	#7	#8	#9	#10	#11	
LAP (IN)	12	14	17	20	24	27	30	34	37		
- NO WELDING OF REINFORCING STEEL WILL BE ALLOWED EXCEPT AS INDICATED ON THE DRAWINGS.
- ALL OUTSIDE CONCRETE WEARING SURFACES SHALL RECEIVE A STEEL TROWEL AND A MEDIUM BROOM FINISH PERPENDICULAR TO THE TRAFFIC FLOW.
- PROVIDE A 1/4" CHAMFER TO ALL EXPOSED CONCRETE EDGES.
- WET CURE ALL CONCRETE SLABS FOR A MINIMUM OF 3 DAYS.
- CONTRACTOR SHALL COORDINATE LOCATIONS OF ALL FLOOR DRAINS, CONDUITS, PIPING, SLEEVES, INSERTS, GROUNDS, ETC WITH CONCRETE CONSTRUCTION.
- THE CONTRACTOR SHALL PROVIDE THE FOLLOWING INFORMATION TO THE STRUCTURAL ENGINEER OF RECORD FOR REVIEW:
 - SHOP DRAWINGS SHOWING ALL REINFORCEMENT AND EMBEDMENT LOCATIONS AND DETAILS.

A	5-22-2024	ISSUED FOR BID - ADDENDUM 1	HSC	CDL
No.	DATE	DESCRIPTION	BY	CHK.
DRAWING ISSUE STATUS				
ISSUED FOR BID				
HALEY WARD ENGINEERING ENVIRONMENTAL SURVEYING				
One Merchants Plaza, Suite 701 Bangor, Maine 04401 207.989.4832				
PROJECT				
CAMDEN HILL STATE PARK CAMDEN, ME				
TITLE				
EQUIPMENT SLAB PLAN, SECTION, DETAILS AND NOTES				
DATE		SCALE		
5-22-2024		AS NOTED		
DRAWN BY	DESIGNED BY	CHECKED BY		
HSC	HSC			
PROJECT No.		14641.001		
DRAWING No.		S-102		
REV.		A		

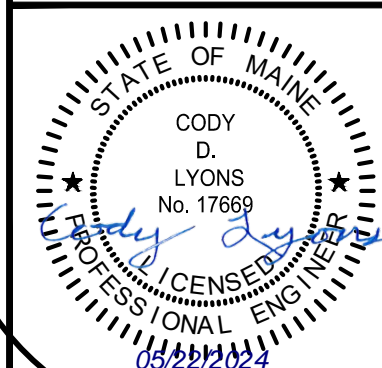

00 11 13
Notice to Contractors

Camden Hills State Park Water System Upgrades BGS Project No. 3464

The Work shall generally consist of water system upgrades at Camden Hills State Park in Camden, Maine, including installation of new water storage tanks, demolition of existing storage cistern, installation of new water distribution mains with related valves and appurtenances, installation of new conduits for Data and Telecommunications, selective demolition of the existing wellhouse, and construction of a new wellhouse with associated MEP systems. The Work shall be completed in two (2) phases.

The cost of the work is approximately \$ 1,200,000. The contract shall designate the Substantial Completion Date on or before *April 3, 2025*, and the Contract Final Completion Date on or before ~~May 1~~ June 6, 2025.

1. Submit bids on a completed Contractor Bid Form (section 00 41 13) provided in the Bid Documents, include bid security when required, and scan each item as an attachment to an email addressed to: BGS.Architect@Maine.gov, so as to be received no later than **2:00:00 p.m. on May 30, 2024**. The email subject line shall be marked "**Bid for Camden Hills State Park Water System Upgrades**".

Bid submissions will be opened and read aloud at the time and date noted above at the Bureau of General Services office, accessible as a video conference call. Those who wish to participate in the call must submit a request for access to BGS.Architect@Maine.gov.

Any bid received after the noted time will not be considered a valid bid and will remain unopened. Any bid submitted by any other means will not be considered a valid bid. In certain circumstances, the Bureau of General Services may require the Bidder to surrender a valid paper copy of the bid form or the bid security document. The Owner reserves the right to accept or reject any or all bids as may best serve the interest of the Owner.

2. Questions and comments on the *bid opening process* shall be addressed to: Joseph H. Ostwald, Director, Division of Planning, Design & Construction, Bureau of General Services, 77 State House Station, Augusta, Maine 04333-0077, BGS.Architect@Maine.gov.
3. Questions and comments regarding the *project* design specifications or drawings shall be directed in writing to the Consultant during the bid period prior to the question and comment deadline of 5:00 p.m. on *May 17, 2024*.

Haley Ward, Inc.
Chip Haskell, P.E.
chaskell@haleyward.com

00 11 13
Notice to Contractors

4. Bid security is required on this project.
The Bidder shall include a satisfactory Bid Bond (section 00 43 13) or a certified or cashier's check for 5% of the bid amount with the completed bid form submitted to the Owner. The Bid Bond form is available on the BGS website.
or
 Bid security is not required on this project.
5. Performance and Payment Bonds are required on this project.
If noted above as required, or if any combination of Base Bid and Alternate Bids amounts selected in the award of the contract exceeds \$125,000.00, the selected Contractor shall furnish a 100% contract Performance Bond (section 00 61 13.13) and a 100% contract Payment Bond (section 00 61 13.16) in the contract amount to cover the execution of the Work. Bond forms are available on the BGS website.
or
 Performance and Payment Bonds are not required on this project.
6. Filed Sub-bids *are not required* on this project.
7. Pre-qualified General Contractors are utilized on this project.
or
 Pre-qualified General Contractors are not utilized on this project.
8. An on-site pre-bid conference (*mandatory* or *optional*) will be conducted for this project. The pre-bid conference is intended for General Contractors. Subcontractors and suppliers are welcome to attend. Contractors who arrive late or leave early for a mandatory meeting may be prohibited from participating in this meeting and bidding.
The pre-bid conference will be held on-site on May 14, 2024 at 10:00 AM.
or
 An on-site pre-bid conference will not be conducted for this project.
9. Bid Documents - full sets only - will be available on or about *May 6, 2024* and may be obtained *at no cost electronically* from:
Haley Ward, Inc.
One Merchants Plaza, Suite 701
Bangor, ME 04401
sroberge@haleyward.com

00 11 13
Notice to Contractors

10. Bid Documents may be examined at:

AGC Maine
188 Whitten Road
Augusta, ME 04330
Phone 207-622-4741 Fax 207-622-1625

Construction Summary
734 Chestnut Street
Manchester, NH 03104
Phone 603-627-8856 Fax 603-627-4524

**00 41 13
Contractor Bid Form**

Camden Hills State Park Water System Upgrades BGS Project No. 3464

Bid Form submitted by: *email only to email address below*

Bid Administrator:

Joseph H. Ostwald
Bureau of General Services
111 Sewall Street, Cross State Office Building, 4th floor
77 State House Station
Augusta, Maine 04333-0077

BGS.Architect@Maine.gov

Bidder:

Signature: _____

Printed name and title: _____

Company name: _____

Mailing address: _____

City, state, zip code: _____

Phone number: _____

Email address: _____

State of incorporation, if a corporation: _____

List of all partners, if a partnership: _____

The Bidder agrees, if the Owner offers to award the contract, to provide any and all bonds and certificates of insurance, as well as Schedule of Values, Project Schedule, and List of Subcontractors and Suppliers if required by the Owner, and to sign the designated Construction Contract within twelve calendar days after the date of notification of such acceptance, except if the twelfth day falls on a State of Maine government holiday or other closure day, or a Saturday, or a Sunday, in which case the aforementioned documents must be received before 12:00 noon on the first available business day following the holiday, other closure day, Saturday, or Sunday.

As a guarantee thereof, the Bidder submits, together with this bid, a bid bond or other acceptable instrument as and if required by the Bid Documents.

**00 41 13
Contractor Bid Form**

1. The Bidder, having carefully examined the *Camden Hills State Park Water System Upgrades Project Manual* dated *April 2024*, prepared by *Haley Ward, Inc.*, as well as Specifications, Drawings, and any Addenda, the form of contract, and the premises and conditions relating to the work, proposes to furnish all labor, equipment and materials necessary for and reasonably incidental to the construction and completion of this project for the **Base Bid** amount of:

\$ _____.00

2. Allowances *are included* on this project.
Bid amount above includes the following Allowances
Quality Assurance/Quality Control
Rock Removal

\$ 5,000.00

\$ 40,000.00

3. Alternate Bids *are not included* on this project.
No Alternate Bids

Any dollar amount line below that is left blank by the Bidder shall be read as a bid of **\$0.00**.

1 Not used \$ _____.00

2 Not used \$ _____.00

3 Not used \$ _____.00

4 Not used \$ _____.00

4. Bid security *is required* on this project.
 If noted above as required, or if the Base Bid amount exceeds \$125,000.00, the Bidder shall include with this bid form a satisfactory Bid Bond (section 00 43 13) or a certified or cashier's check for 5% of the bid amount with this completed bid form submitted to the Owner.

5. Filed Sub-bids *are not required* on this project.
 If noted above as required, the Bidder shall include with this bid form a list of each Filed Sub-bidder selected by the Bidder on the form provided (section 00 41 13F).



SECTION 01 10 26

MEASUREMENT & PAYMENT

PART 1 - GENERAL

1.1 SCOPE

- A. Payment for items included in the lump sum bid, as further specified herein shall include all compensation to be received by the Contractor for furnishing all tools, equipment, supplies, materials and manufactured articles, and for all labor, operations, and incidentals appurtenant to the items of work being described, as necessary to complete the various items of the work all in accordance with the requirements of the Project Manual, including all appurtenances thereto, and including all costs of compliance with the regulations of public agencies having jurisdiction. No separate payment will be made for any item that is not specifically set forth in this section, and all costs, therefore, shall be included in the overall bid price for this project.

1.2 METHOD OF MEASUREMENT AND PAYMENT

A. Incidental Items

1. Traffic Control

Traffic Control shall be considered incidental to the project. This shall include all equipment, and materials to satisfactorily provide traffic control as required for the project. Providing a traffic control plan for approval by Owner and Engineer prior to construction shall also be considered incidental.

2. Site Preparation

Site Preparation shall be considered an incidental item to the project. Site Preparation shall include the removal and disposal of brush, tree and stump, grubbing, stripping of topsoil, pavement, curbing, structures, pipes, culverts, other site features and all other items necessary to prepare for the utility improvements or as directed by the Engineer. It shall include the removal and delivery of all items to remain property of the Owner including, but not limited to hydrants, valves, and valve boxes, generator, propane tank, and building construction materials. Items to remain the property of the Owner shall be delivered to location as indicated by the Owner. Site Preparation shall include the adjustment of all valve boxes for the removal/installation of the gravel. Site Preparation shall include the furnishing and installation of flowable fill in all abandoned pipes. his shall include all labor, materials, and equipment as required to satisfactorily complete the site preparation.



3. Test Pits:

All test pits associated with the project shall be considered incidental to the project. Test pits shall be determined by the Engineer to locate utilities, confirm elevations or any other operation as necessary for the construction of the project. This shall include all labor equipment, and materials to satisfactorily complete the excavation and backfilling of the test pits as required for the project.

4. All other items indicated in the Contract Documents.

B. Measurement and payment for items included in the bid will be made in the manner presented below for each bid item.

1. Mobilization

Mobilization costs are costs of initiating and executing the contract, general contract administration costs, insurance and bonds, the providing of facilities and controls not a part of the project but necessary to administer and construct the project (refer to Section 01 50 00). Costs for Mobilization shall not exceed five (5%) percent of the total amount of the Bid.

Payment for Mobilization shall be included in the lump sum bid price and shall be payable at a maximum rate of 50% when required facilities have been provided and the Contractor has substantially commenced work on site, with the remaining 50% to be paid once work is substantially complete and the Contractor has demobilized from the site.

2. Temporary Erosion Control

Temporary Erosion Control shall be considered a lump sum item for providing all labor, equipment, and materials to establish proper erosion control protection during any and all construction associated with the project, and to remove the temporary erosion controls once the project has been completed and stabilization has occurred.

Payment for the Temporary Erosion Control shall be included in the lump sum bid price. Temporary erosion control shall include stone check dams, sediment control barriers, silt fence, and other control measures as indicated on the Contract Documents or as required by the MDEP Bureau of Land and Water Quality, "Maine Erosion and Sedimentation Control BMP's" latest edition to ensure erosion protection during and after project completion.

3. QA/QC Testing

Quality Assurance/Quality Control testing shall be measured and paid for by invoices furnished by the testing laboratory. An allowance has been determined for this project. The cost for the Contractor to collect and transport samples for testing will be incidental to the work being tested. No payment will be made for tests not called for and no payment will be made for retests. Should the final cost, as determined through furnished invoices, vary upward or downward from the stated allowance, an adjustment will be made accordingly.



4. 3/4-Inch Crushed Stone

Measurement for 3/4-Inch Crushed Stone which shall include the excavation of existing material within and associated with the water line improvements shall be made by the in-place cubic yard as accepted in accordance with the Contract Documents. Crushed stone shall only be used as replacement material related to items No. 5 and 6. Compensation for crushed stone shall be approved by the Engineer as related to Rock Removal and Unsuitable Material quantities.

Payment for the 3/4-Inch Crushed Stone shall be included in the bid price. The contract cubic yardage price shall be full compensation for excavating, rough grading, transporting, stockpiling material, placing, compacting and disposal as required to complete the project. This will include all labor, equipment, material, and incidentals required to satisfactorily complete this item as shown on the Contract Drawings and in accordance with Contract Specifications.

5. Rock Removal

Measurement for Rock Removal shall be by the in-place cubic yard prior to disturbance as required for construction of the proposed water line improvements, accepted in accordance with the Contract Documents.

An allowance for Rock Removal has been determined for this project. The contract cubic yardage price shall be full compensation for all labor, equipment, blasting, material, notification, survey and other incidentals required to complete the work, including removal and disposal of waste from the site, in the areas necessary to complete the project as shown on the Contract Drawings and in accordance with Contract Specifications. Pay width and depth for open rock removal shall be determined prior to disturbance and shall be coordinated with the Engineer. The pay width for trench rock removal for mains shall be 24 inches wider than the pipe diameter and the depth to 6 inches below pipes, and structures shall be width of structure plus 2 feet and the depth to 12 inches below structure. Costs associated with over blasting, removal beyond pre-determined volume, or fill requirement to replace over excavation will be considered incidental to the pay item and will be the responsibility of the Contractor to correct. Coordinate Rock Removal quantities with the Engineer.

6. Unsuitable Material

Measurement of the Unsuitable Material shall be made by the in-place cubic yard as accepted in accordance with the Contract Documents.

Payment for Unsuitable Material shall be included in the bid price. The cubic yardage price shall be full compensation for excavating, transporting, stockpiling as necessary, disposal costs, and replacement of materials, and will include all labor, material, equipment and incidentals required to satisfactorily complete this item as indicated within the contract documents. Unsuitable Material is any fill which cannot be re-installed on project as backfill.



7. 10,000-Gallon Water Tank

Each 10,000-Gallon Water Tank shall be measured for payment, installed, and accepted in accordance with the Contract Documents.

Payment for 10,000-Gallon Water Tanks shall be included in the lump sum bid price. The contract price shall be full compensation for all labor, materials (concrete pad, Unistrut pipe support, PVC piping, fittings, anchors, supports, water level control valve), removal of the existing tank, and equipment required to satisfactorily complete the installation of the tanks. Satisfactory completion shall include all excavation, sheeting and bracing, installing valves, tank supports/anchors, piping system, piping support system, providing and compaction of the specified bedding for the concrete pad, backfilling the pad, compacting the material, disposal of surplus materials, concrete pad, fence enclosure, all other operations as may be required to complete the bid item as shown on the Contract Drawings and in accordance with Contract Specifications. Connecting valve to the existing or proposed water main shall be incidental to this Bid item. Restoration of disturbed area surrounding the 10,000-Gallon Water Tank shall be incidental to this bid item.

8/9. 2 and 3-Inch HDPE Water Line

Pipe measured for payment shall be the number of linear feet of the 2 and 3-inch HDPE Water Line as measured by the Engineer horizontally along the centerline of the pipe including fittings, installed and accepted in accordance with the Contract Documents.

Payment for 2 and 3-Inch HDPE Water Line shall be included in the lump sum bid price. The contract price per linear foot of pipe shall be full compensation for installing the pipe including all labor, materials, and equipment required to satisfactorily complete the water line. Satisfactory completion shall include removing gravel and or topsoil as required, excavating the trench, cutting and capping existing lines as needed and/or removing and disposing of existing line if in conflict with new line placement, sheeting and bracing, removal and disposal of the existing main as required, providing necessary bedding material, installing the pipe, placing board insulation, as required, furnishing and installing thrust blocks, furnishing and installing marker tape and tracer wire, backfilling the trench, compacting the trench, maintaining the trench, disposal of surplus materials, handling surface and groundwater, ditching, testing, chlorination/de-chlorination, and all other operations as may be necessary, including installing all fittings, replacement of gravel buildups in areas that are in the gravel road, camping sites, or driveways, and any other items that may be required, to complete the bid item as shown on the Contract Drawings and in accordance with Contract Specifications. Connection of the proposed water main to the existing water main shall be incidental to this item. All chlorination, de-chlorination and testing required shall be considered incidental to this bid item.



Maintaining and repairing damage to any public or private utility encountered including, but not limited to, water, drainage, sanitary, electric, cable, services, and other pipes shall be considered incidental to the item, regardless if pipes are shown on the Contract Drawings with the exception of direct on-grade conflicts.

Payment for this work on interim requisitions shall be according to the following percentages:

- a. Pipe acceptably set in place and backfilled - 80 percent.
- b. Pipe successfully cleaned and tested - 10 percent.
- c. As-builts provided and accepted – 10 percent.
- d. All payments shall be subject to pertinent retainage.

10/11. 2 and 3-Inch Gate Valve

Each 2 and 3-inch Gate Valve shall be measured for payment, installed, and accepted in accordance with the Contract Documents.

Payment for 2 and 3-Inch Gate Valves shall be included in the lump sum bid price. The contract price shall be full compensation for all labor, materials, and equipment required to satisfactorily complete the installation of the valve. Satisfactory completion shall include all excavation, sheeting and bracing, installing valve, installing mechanical joint fasteners, providing and compaction of the specified bedding, backfilling the trench, compacting the trench, maintaining the trench, disposal of surplus materials, installing valve box, testing and chlorination/dechlorination of the valve and all other operations as may be required to complete the bid item as shown on the Contract Drawings and in accordance with Contract Specifications. Connecting valve to the existing or proposed water main shall be incidental to this Bid item.

Payment for this item on interim requisitions shall be according to the following percentages.

- a. Valve acceptably set in place and backfilled - 80 percent.
- b. Valve successfully cleaned and tested - 10 percent.
- c. As-builts provided and accepted – 10 percent.
- d. All payments shall be subject to pertinent retainage.

12. 1-Inch CTS PE Service Assembly

Each 1-Inch CTS PE Service Assembly shall be measured for payment, installed, and accepted in accordance with the Construction Documents.

Payment for 1-Inch CTS PE Service Assembly shall be included in the lump sum bid price. The contract price shall be full compensation for installing the assembly including all labor, materials, and equipment required to satisfactorily complete the assembly. Satisfactory completion shall include removing pavement, gravel, and or topsoil as required, excavation, cutting and capping existing lines as needed and/or removing and disposing of existing line if in conflict with new line placement, sheeting and bracing, installing curb stop and service box, installing



corporation, providing and compaction of the specified bedding, backfilling the trench, compacting the trench, maintaining the trench, disposal of surplus materials, testing and chlorination/de-chlorination, restore landscape as prior to disturbance and all labor, materials, and equipment required to satisfactorily complete the bid item as shown on the Contract Drawings and in accordance with Contract Specifications. Connection of the water service to the main and the existing water service at the property line shall be incidental to this bid item.

Maintaining and repairing damage to any public or private utility encountered including water, drainage, sanitary, services and pipes shall be considered incidental to the item, regardless if pipes are shown on the Contract Drawings with the exception of direct on-grade conflicts.

13. 1-Inch CTS PE Water Service

Water services measured for payment shall be the number of linear feet of 1-Inch CTS PE Water Service as measured by the Engineer horizontally along the centerline of the pipe including fittings, necessary connections to existing lines to be installed and accepted in accordance with the Contract Documents. 1-Inch CTS PE Water Service shall be used for services to buildings and service lines to hydrant assemblies and water spigots.

Payment for 1-Inch CTS PE Water Services shall be included in the lump sum bid price. The contract price per linear foot of pipe shall be full compensation for installing the pipe including all labor, materials, and equipment required to satisfactorily complete the water service. Satisfactory completion shall include removing pavement, gravel, and or topsoil as required, excavation, sheeting and bracing, installing water service pipe and fittings (including necessary fittings to connect to the existing water infrastructure), furnishing and installing marker tape and tracer wire, providing and compaction of the specified bedding, backfilling the trench, placing board insulation (as needed), compacting the trench, maintaining the trench, disposal of surplus materials, testing and chlorination/de-chlorination, restore landscape and/or pavement surface as prior to disturbance and all labor, materials, and equipment required to satisfactorily complete the bid item as shown on the Contract Drawings and in accordance with Contract Specifications. Connection of the water service to the main and the existing water service at the property line shall be incidental to this bid item.

Maintaining and repairing damage to any public or private utility encountered including water, drainage, sanitary, services and pipes shall be considered incidental to the item, regardless if pipes are shown on the drawings with the exception of direct on-grade conflicts.

Payment for this work on interim requisitions shall be according to the following percentages:

- a. Water service acceptably set in place and backfilled - 80 percent.
- b. Water service successfully cleaned and tested - 10 percent.
- c. As-builts provided and accepted – 10 percent.
- d. All payments shall be subject to pertinent retainage.



14. Water Spigot Assembly

Each Water Spigot Assembly shall be measured for payment, installed, and accepted in accordance with the Contract Documents.

Payment for Water Spigot Assembly shall be included in the lump sum bid price. The contract price per Water Spigot Assembly shall be full compensation for all labor, materials, and equipment required to satisfactorily complete the installation of the water spigot assembly. Satisfactory completion shall include all excavation, sheeting and bracing, installing spigot on wooden timber, installing necessary fittings, providing and compaction of the specified bedding, backfilling the trench, compacting the trench, maintaining the trench, disposal of surplus materials, testing and chlorination/de-chlorination of the water spigot assembly and all other operations as may be required to complete the bid item as shown on the Contract Drawings and in accordance with Contract Specifications. Connecting water spigot assembly to the water main and all labor, materials, and equipment required shall be incidental to this bid item.

15. Yard Hydrant Assembly

Each Yard Hydrant Assembly shall be measured for payment, installed, and accepted in accordance with the Contract Documents.

Payment for Yard Hydrant Assembly shall be included in the lump sum bid price. The contract price per fire hydrant assembly shall be full compensation for all labor, materials, and equipment required to satisfactorily complete the installation of the fire hydrant assembly. Satisfactory completion shall include all excavation, sheeting and bracing, removal and disposal of existing fire hydrant assembly, as needed, installing fire hydrant, installing curb stop and service box, installing hydrant arm, furnishing and installing concrete thrust block, providing and compaction of the specified bedding, backfilling the trench, compacting the trench, maintaining the trench, disposal of surplus materials, testing and chlorination/de-chlorination of the fire hydrant assembly and all other operations as may be required to complete the bid item as shown on the Contract Drawings and in accordance with Contract Specifications. Connecting yard hydrant assembly to the water main and all labor, materials, and equipment required shall be incidental to this bid item.

16. Well Building, Associated MEP Systems, and Gravel Path

Measurement for Well Building and Electrical Components shall be considered a lump sum item for providing all labor, equipment, materials to complete updates to the wellhouse and accepted in accordance with the Contract Documents.

Payment for Well Building, associated MEP Systems, and Gravel Path shall be included in the lump sum bid price. The contract price shall be full compensation for all labor, materials, equipment, and incidentals required to satisfactorily complete the bid item as shown on the Contract Drawings and in accordance with Contract Specifications. Restoration of the disturbed area surrounding the Well Building shall be incidental to this bid item. Selective demolition of the existing well



building shall be incidental to this bid item.

17. 4-Inches Loam

Measurement for 4-Inches Loam shall be made by the in-place cubic yard as measured by Engineer, installed, compacted, and accepted in accordance with the Contract Documents.

Payment for 4-Inches Loam shall be included in the lump sum bid price. The contract price shall be full compensation for all labor, materials, equipment, erosion protection, testing, and incidentals required to satisfactory complete the bid item as shown on the Contract Drawings and in accordance with Contract Specifications.

18. Seed and Mulch

Seed and Mulch shall be measured by the unit, installed, and accepted in accordance with the Contract Documents. A unit shall be 1,000 square feet.

Payment for Seed and Mulch shall be included in the lump sum bid price. The contract price shall be full compensation for all labor, materials, equipment, erosion protection, and incidentals required to satisfactory complete the bid item as shown on the Contract Drawings and in accordance with Contract Specifications. A 50% payment will be made when seed and mulch is applied and the other 50% will be paid when a suitable grass growth has been established.

19. Park Data and Telecommunications Conduits

Measurement for Park Data and Telecommunications Conduits shall be considered a lump sum item for providing all labor, equipment, materials to complete new park data and telecommunications conduit runs accepted in accordance with the Contract Documents.

Payment for the Park Data and Telecommunications Conduits shall be included in the lump sum bid price. The contract price shall be full compensation for all labor, materials, equipment, and incidentals required to satisfactory complete the bid item as shown on the Contract Drawings and in accordance with Contract Specifications.

END OF SECTION