

CRIME LABORATORY REROOFING

MAINE STATE POLICE

26 HOSPITAL STREET, AUGUSTA, MAINE

ALLIED PROJECT #20038
BGS PROJECT # PT 3167

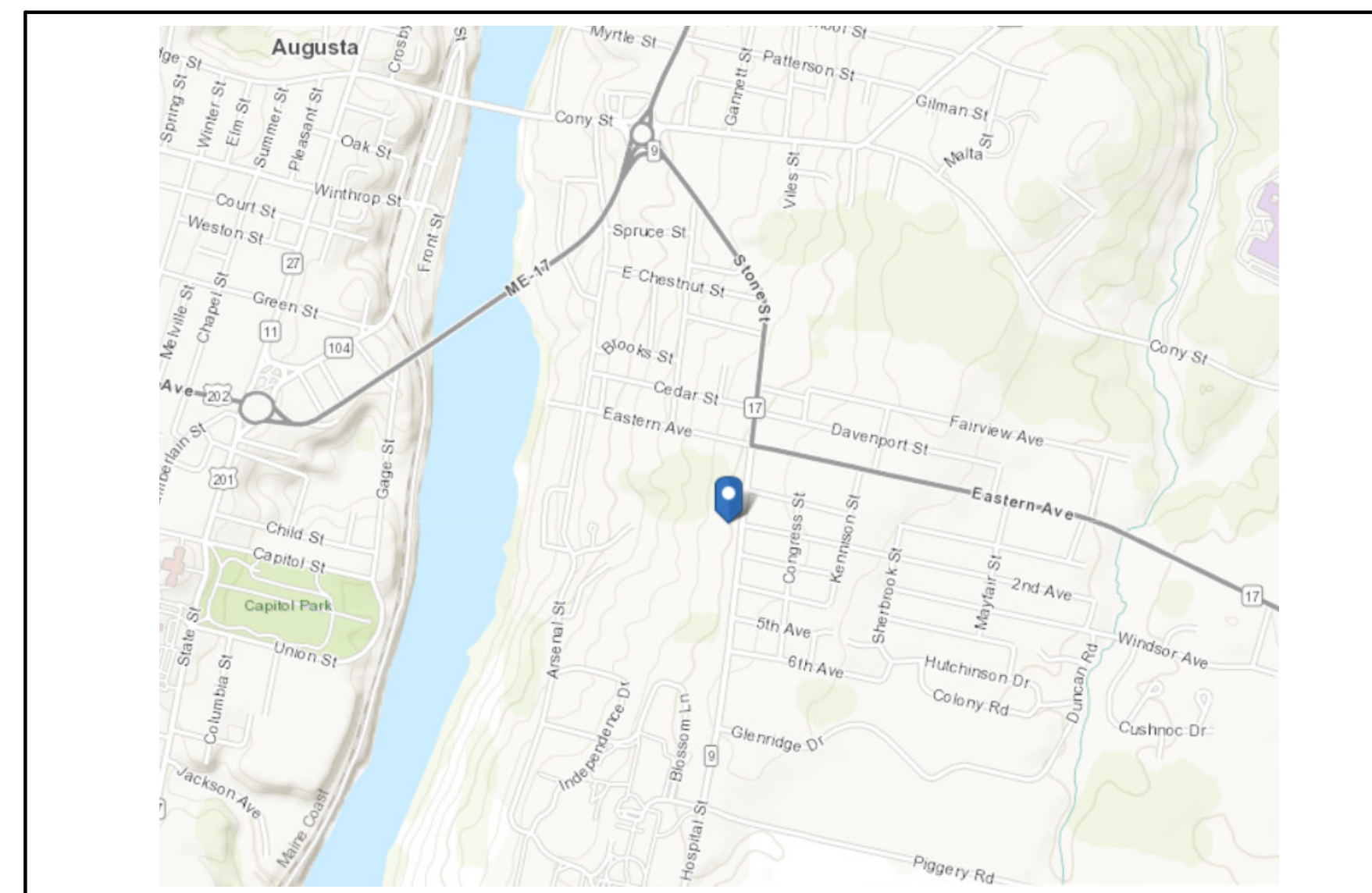

LOCATION MAP

ISSUED FOR BID ~ 17 AUGUST 2020
~ NOT FOR CONSTRUCTION

DRAWING STATUS LIST		ISSUE	DATE
SHEET No.	SHEET TITLE		
DRAWINGS			
G-000	COVER SHEET	75% CONTRACT DOCUMENTS	07/29/2020
R-000	NOTES	ISSUED FOR BID	08/17/2020
RD-100	ROOF DEMOLITION PLAN		
R-100	PROPOSED ROOF PLAN		
R-500	ROOF DETAILS		

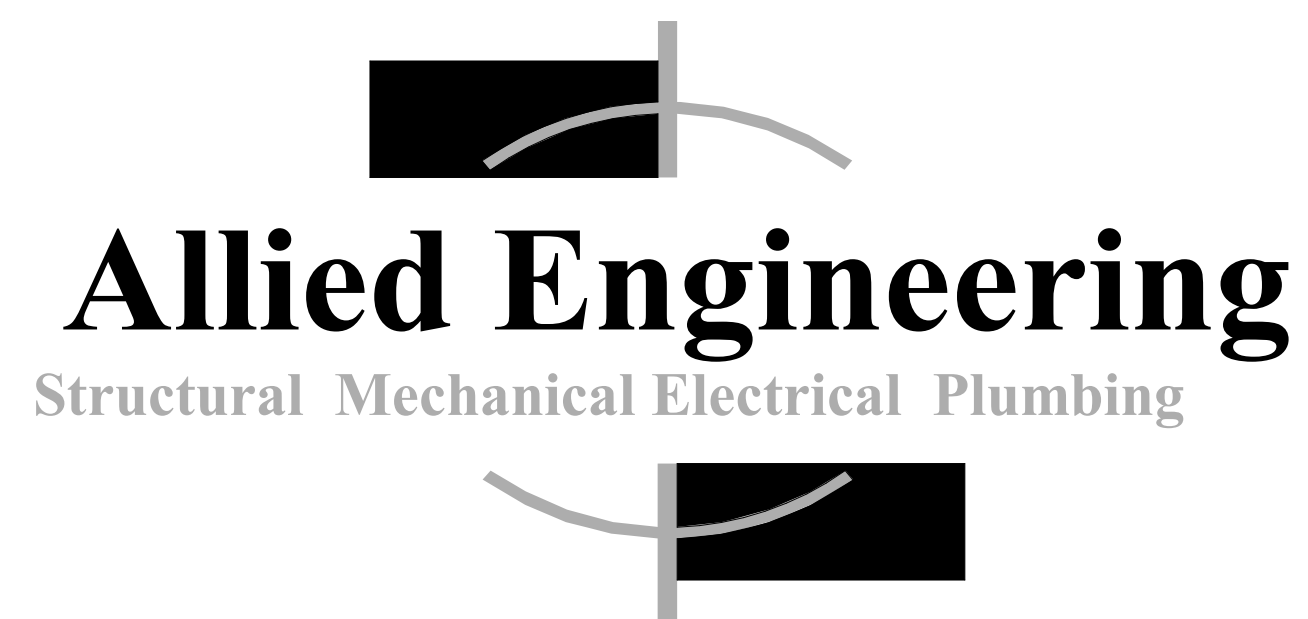

160 Veranda Street
Portland, Maine 04103
T: 207.221.2260
F: 207.221.2266
Web: www.allied-eng.com

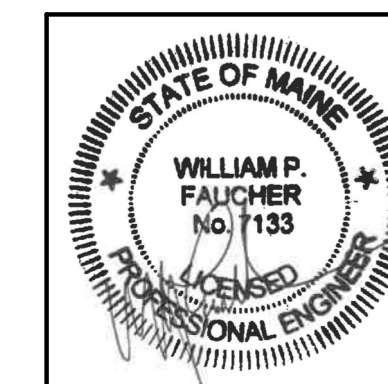

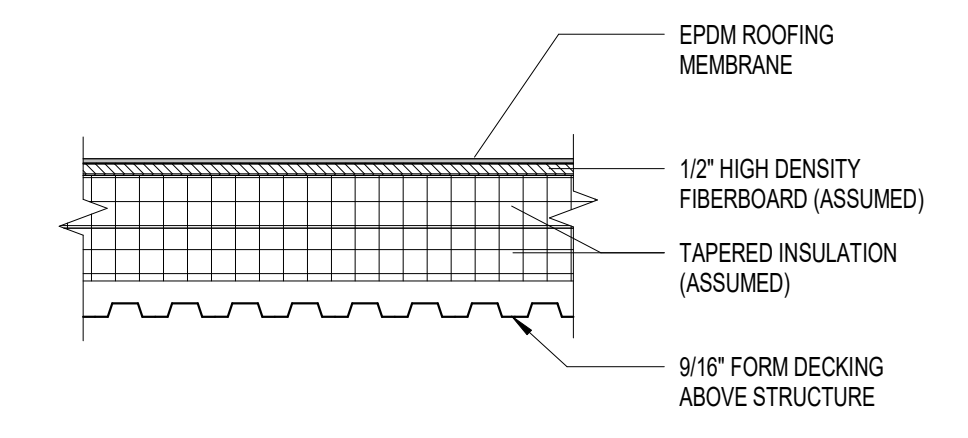
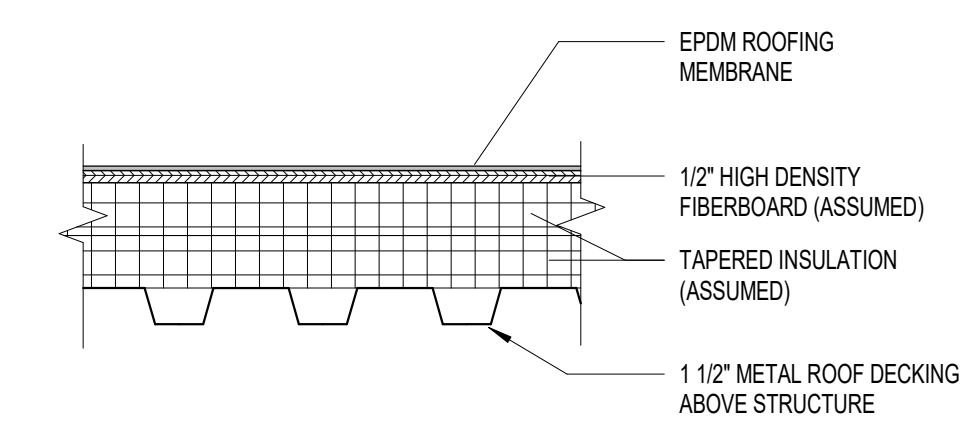
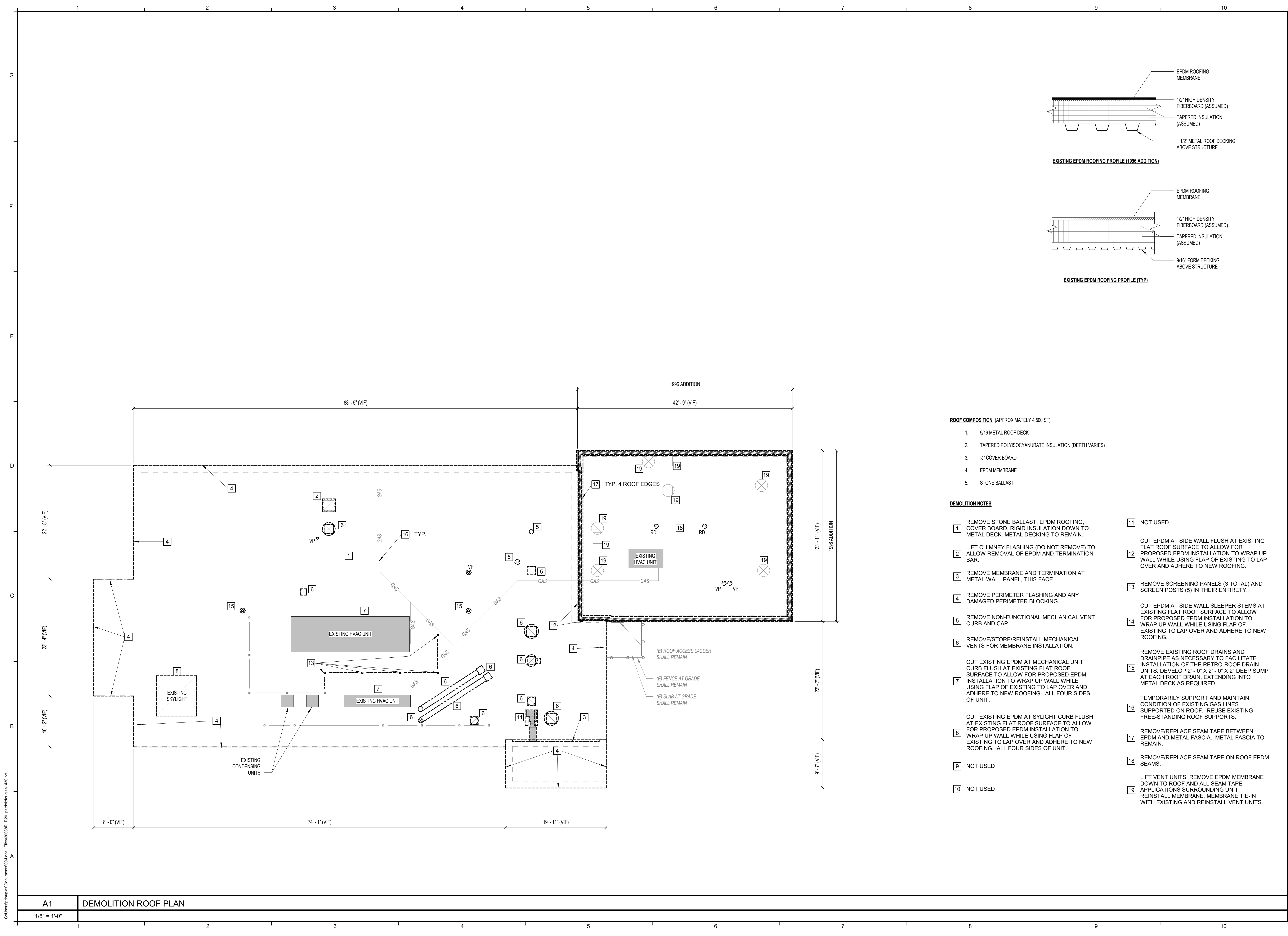

ROOF COMPOSITION (APPROXIMATELY 4,500 SF)

1. 9/16 METAL ROOF DECK
2. TAPERED POLYISOCYANURATE INSULATION (DEPTH VARIES)
3. 1/2" COVER BOARD
4. EPDM MEMBRANE
5. STONE BALLAST

DEMOLITION NOTES

- | | |
|--|--|
| <ol style="list-style-type: none"> 1 REMOVE STONE BALLAST, EPDM ROOFING, COVER BOARD, RIGID INSULATION DOWN TO METAL DECK. METAL DECKING TO REMAIN. 2 LIFT CHIMNEY FLASHING (DO NOT REMOVE) TO ALLOW REMOVAL OF EPDM AND TERMINATION BAR. 3 REMOVE MEMBRANE AND TERMINATION AT METAL WALL PANEL, THIS FACE. 4 REMOVE PERIMETER FLASHING AND ANY DAMAGED PERIMETER BLOCKING. 5 REMOVE NON-FUNCTIONAL MECHANICAL VENT CURB AND CAP. 6 REMOVE/STORE/REINSTALL MECHANICAL VENTS FOR MEMBRANE INSTALLATION. 7 CUT EXISTING EPDM AT MECHANICAL UNIT CURB FLUSH AT EXISTING FLAT ROOF SURFACE TO ALLOW FOR PROPOSED EPDM INSTALLATION TO WRAP UP WALL WHILE USING FLAP OF EXISTING TO LAP OVER AND ADHERE TO NEW ROOFING. ALL FOUR SIDES OF UNIT. 8 CUT EXISTING EPDM AT SYLHIGHT CURB FLUSH AT EXISTING FLAT ROOF SURFACE TO ALLOW FOR PROPOSED EPDM INSTALLATION TO WRAP UP WALL WHILE USING FLAP OF EXISTING TO LAP OVER AND ADHERE TO NEW ROOFING. ALL FOUR SIDES OF UNIT. 9 NOT USED 10 NOT USED | <ol style="list-style-type: none"> 11 NOT USED 12 CUT EPDM AT SIDE WALL FLUSH AT EXISTING FLAT ROOF SURFACE TO ALLOW FOR PROPOSED EPDM INSTALLATION TO WRAP UP WALL WHILE USING FLAP OF EXISTING TO LAP OVER AND ADHERE TO NEW ROOFING. 13 REMOVE SCREENING PANELS (3 TOTAL) AND SCREEN POSTS (5) IN THEIR ENTIRETY. 14 CUT EPDM AT SIDE WALL SLEEPER STEMS AT EXISTING FLAT ROOF SURFACE TO ALLOW FOR PROPOSED EPDM INSTALLATION TO WRAP UP WALL WHILE USING FLAP OF EXISTING TO LAP OVER AND ADHERE TO NEW ROOFING. 15 REMOVE EXISTING ROOF DRAINS AND DRAINPIPE AS NECESSARY TO FACILITATE INSTALLATION OF THE RETRO-ROOF DRAIN UNITS. DEVELOP 2'-0" X 2'-0" X 2'-0" DEEP SUMP AT EACH ROOF DRAIN, EXTENDING INTO METAL DECK AS REQUIRED. 16 TEMPORARILY SUPPORT AND MAINTAIN CONDITION OF EXISTING GAS LINES SUPPORTED ON ROOF. REUSE EXISTING FREE-STANDING ROOF SUPPORTS. 17 REMOVE/REPLACE SEAM TAPE BETWEEN EPDM AND METAL FASCIA. METAL FASCIA TO REMAIN. 18 REMOVE/REPLACE SEAM TAPE ON ROOF EPDM SEAMS. 19 LIFT VENT UNITS. REMOVE EPDM MEMBRANE DOWN TO ROOF AND ALL SEAM TAPE APPLICATIONS SURROUNDING UNIT. REINSTALL MEMBRANE, MEMBRANE TIE-IN WITH EXISTING AND REINSTALL VENT UNITS. |
|--|--|

160 Veranda Street
 Portland, Maine 04103
 P: 207.221.2260
 F: 207.221.2266
 Web: www.allied-eng.com

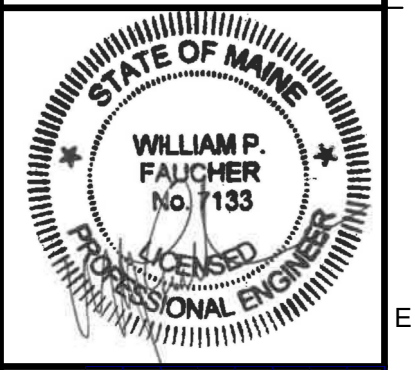

NO.	DATE	BY	DESCRIPTION

Date: 08/17/20
 Drawn By: PED
 Checked By: JAB
 Project Mgr: WFF
 Project No: 20-038
 Cad File: 20038R_R20.rvt
 Graphic Scale: 0" = 1'-0"

ROOF DEMOLITION PLAN
CRIME LABORATORY REROOFING
 26 HOSPITAL STREET, AUGUSTA, MAINE
 (C) COPYRIGHT 2020 ALLIED ENGINEERING, INC.

RD-100

ISSUED FOR BID ~ 17 AUGUST 2020

C:\Users\ped\Documents\00-Local_Files\20038R_R20_demolitionplan.rvt

A1 DEMOLITION ROOF PLAN
 1/8" = 1'-0"

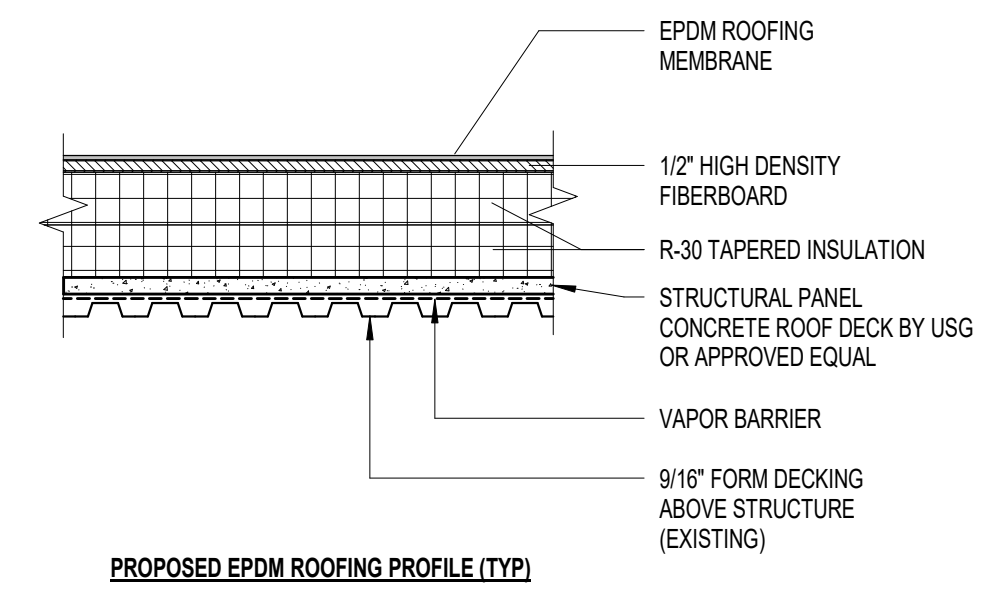
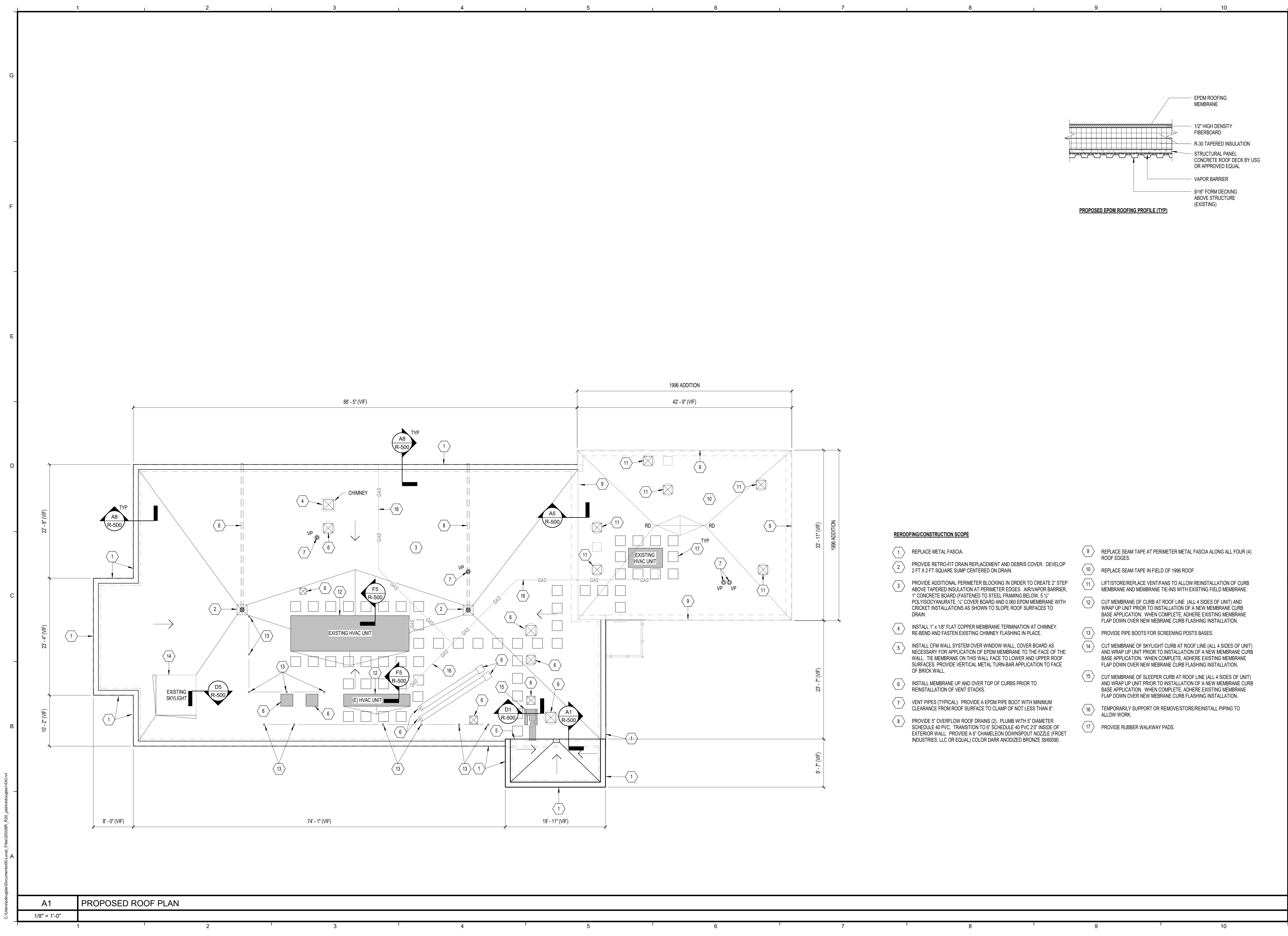

REROOFING/CONSTRUCTION SCOPE

- 1 REPLACE METAL FASCIA.
- 2 PROVIDE RETRO-FIT DRAIN REPLACEMENT AND DEBRIS COVER. DEVELOP 2 FT X 2 FT SQUARE SUMP CENTERED ON DRAIN.
- 3 PROVIDE ADDITIONAL PERIMETER BLOCKING IN ORDER TO CREATE 2\"/>
- 4 INSTALL 1\"/>
- 5 INSTALL CFM WALL SYSTEM OVER WINDOW WALL. COVER BOARD AS NECESSARY FOR APPLICATION OF EPDM MEMBRANE TO THE FACE OF THE WALL. THE MEMBRANE ON THIS WALL FACE TO LOWER AND UPPER ROOF SURFACES. PROVIDE VERTICAL METAL TURN-BAR APPLICATION TO FACE OF BRICK WALL.
- 6 INSTALL MEMBRANE UP AND OVER TOP OF CURBS PRIOR TO REINSTALLATION OF VENT STACKS.
- 7 VENT PIPES (TYPICAL): PROVIDE A EPDM PIPE BOOT WITH MINIMUM CLEARANCE FROM ROOF SURFACE TO CLAMP OF NOT LESS THAN 8\"/>
- 8 PROVIDE 5\"/>
- 9 REPLACE SEAM TAPE AT PERIMETER METAL FASCIA ALONG ALL FOUR (4) ROOF EDGES.
- 10 REPLACE SEAM TAPE IN FIELD OF 1996 ROOF.
- 11 LIFT/STORE/REPLACE VENT/FANS TO ALLOW REINSTALLATION OF CURB MEMBRANE AND MEMBRANE TIE-INS WITH EXISTING FIELD MEMBRANE.
- 12 CUT MEMBRANE OF CURB AT ROOF LINE (ALL 4 SIDES OF UNIT) AND WRAP UP UNIT PRIOR TO INSTALLATION OF A NEW MEMBRANE CURB BASE APPLICATION. WHEN COMPLETE, ADHERE EXISTING MEMBRANE FLAP DOWN OVER NEW MEMBRANE CURB FLASHING INSTALLATION.
- 13 PROVIDE PIPE BOOTS FOR SCREENING POSTS BASES.
- 14 CUT MEMBRANE OF SKYLIGHT CURB AT ROOF LINE (ALL 4 SIDES OF UNIT) AND WRAP UP UNIT PRIOR TO INSTALLATION OF A NEW MEMBRANE CURB BASE APPLICATION. WHEN COMPLETE, ADHERE EXISTING MEMBRANE FLAP DOWN OVER NEW MEMBRANE CURB FLASHING INSTALLATION.
- 15 CUT MEMBRANE OF SLEEPER CURB AT ROOF LINE (ALL 4 SIDES OF UNIT) AND WRAP UP UNIT PRIOR TO INSTALLATION OF A NEW MEMBRANE CURB BASE APPLICATION. WHEN COMPLETE, ADHERE EXISTING MEMBRANE FLAP DOWN OVER NEW MEMBRANE CURB FLASHING INSTALLATION.
- 16 TEMPORARILY SUPPORT OR REMOVE/STORE/REINSTALL PIPING TO ALLOW WORK.
- 17 PROVIDE RUBBER WALKWAY PADS.

160 Veranda Street
 Portland, Maine 04103
 P: 207.221.2260
 F: 207.221.2266
 Web: www.allied-eng.com

Allied Engineering
 Structural Mechanical Electrical Plumbing

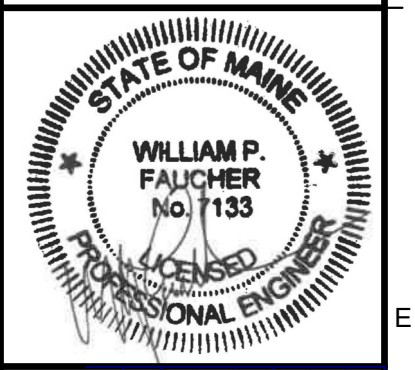

NO.	DATE	BY	DESCRIPTION

Date: 08/17/20
 Drawn By: PED
 Checked By: JAB
 Project Mgr: WFF
 Project No: 20-038
 Cad File: 20038R_R20.rvt
 Graphic Scale: 1\"/>

PROPOSED ROOF PLAN

CRIME LABORATORY REROOFING

26 HOSPITAL STREET, AUGUSTA, MAINE
 (C) COPYRIGHT 2020 ALLIED ENGINEERING, INC.

R-100

ISSUED FOR BID ~ 17 AUGUST 2020

C:\Users\ped\Documents\00-Local_Files\20038R_R20_paviddoglas140.rvt

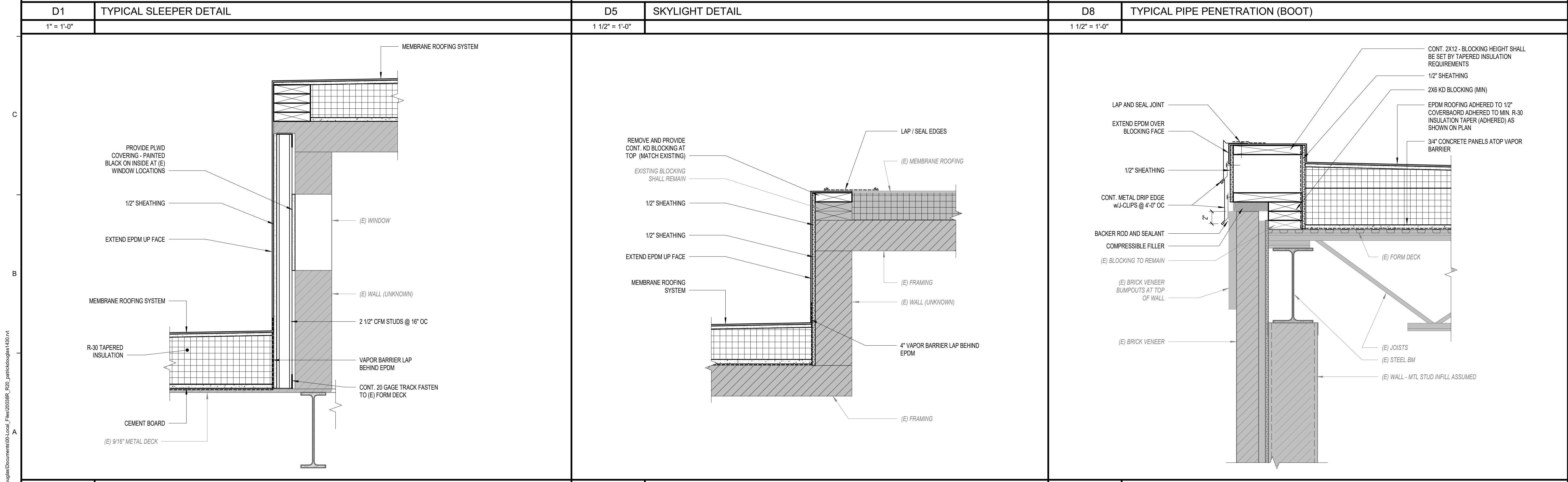
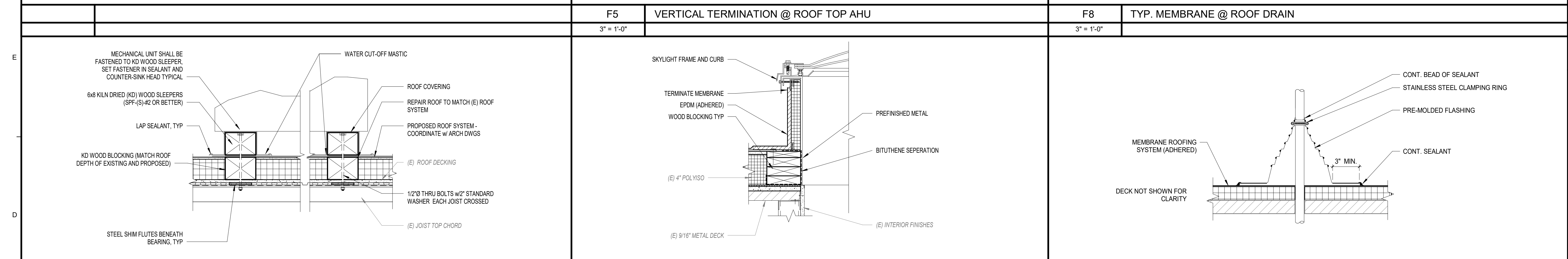
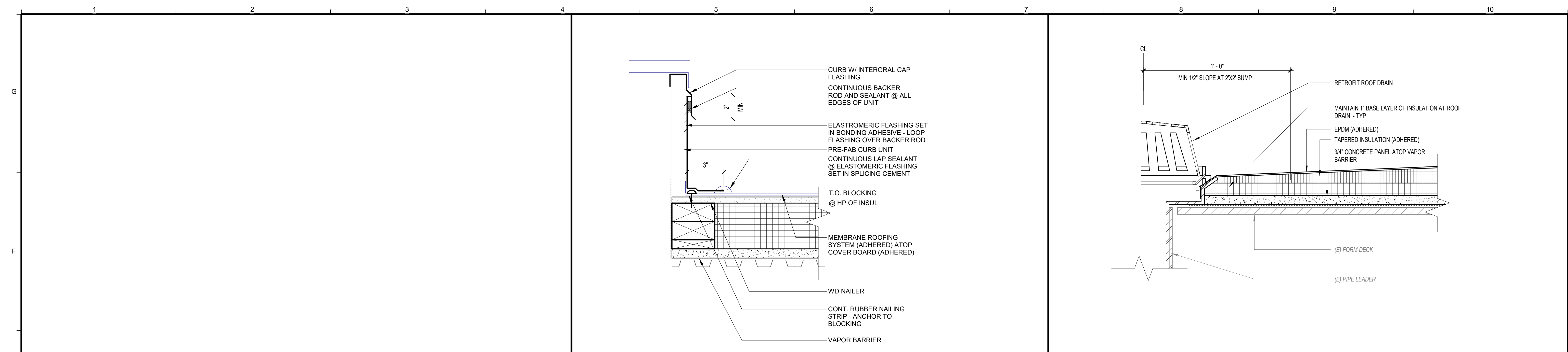

A1 SECTION AT INFILL WALL
1 1/2" = 1'-0"

A5 SECTION AT MAIN ROOF TO 1996 ADDITION
1 1/2" = 1'-0"

A8 TYPICAL ROOF EDGE DETAIL
1 1/2" = 1'-0"

160 Veranda Street
Portland, Maine 04103
P: 207.221.2260
F: 207.221.2266
Web: www.allied-eng.com

Allied Engineering
Structural Mechanical Electrical Plumbing

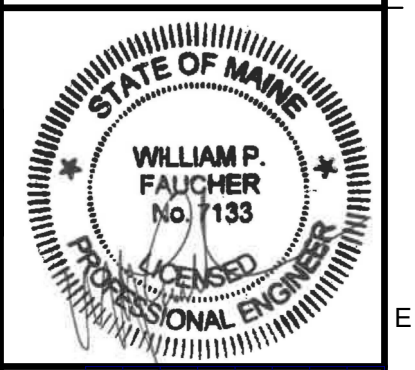

NO.	DATE	BY	DESCRIPTION

Date: 08/17/20
Drawn By: PED
Checked By: JAB
Project Mgr: WFF
Project No: 20-038
Cad File: 20038R_R20.rvt
Graphic Scale: 1" = 0'

ROOF DETAILS

CRIME LABORATORY REROOFING
26 HOSPITAL STREET, AUGUSTA, MAINE
(C) COPYRIGHT 2020 ALLIED ENGINEERING, INC.

R-500

ISSUED FOR BID ~ 17 AUGUST 2020

C:\Users\ped\Documents\00-Local_Files\20038R_R20_rvt\ped\ped.rvt