

Abbreviations

A/C	AIR CONDITIONING	LF	LINEAR FEET
AB	ANCHOR BOLT, AIR BARRIER	LH	LEFT HAND
ABM	AIR BARRIER MEMBRANE	LIB	LIBRARY
ABV	ABOVE	LIN	LINEAR
ACST	ACOUSTIC	LINO	LINOLEUM
ACT	ACOUSTICAL CEILING TILE	LKR	LOCKER
ADA	AMERICANS WITH DISABILITIES ACT	LL	LEAD LINED
ADJ	ADJUSTABLE, ADJACENT	LLH	LONG LEG HORIZONTAL
AF	ABOVE FINISHED FLOOR	LLV	LONG LEG VERTICAL
AFG	ABOVE FINISHED GRADE	LP	LOW POINT
AFS	ABOVE FINISHED SLAB	LPL	LOW PRESSURE LAMINATE
AGG	AGGREGATE	LR	LIVING ROOM
AHU	AIR HANDLING UNIT	LT	LIGHT
ALT	ALTERNATE	LTG	LIGHTING
ALUM	ALUMINUM	LWC	LIGHT WEIGHT CONCRETE
AMT	AMOUNT	LWIC	LIGHT WEIGHT INS CONCRETE
AP	ACCESS PANEL	MACH	MACHINE
APPD	APPROVED	MAS	MASQUIN
ARCH	ARCHITECTURAL	MAT	MATERIAL
ASPH	ASPHALT, ASPHALTIC	MAX	MAXIMUM
AV	AUDIO VISUAL	MB	MACHINE BOLT
AVBM	AIR + VAPOR BARRIER MEMBRANE	MDF	MEDIUM DENSITY FIBERBOARD
AVG	AVERAGE	MDO	MEDIUM DENSITY OVERLAY
@	AT	MCH	MECHANICAL
B	BASEMENT, BASE	MED	MEDIUM, MEDICAL
BB	BULLETIN BOARD	MF	MINERAL FIBER
BD	BOARD	MFR	MANUFACTURER
BET	BETWEEN	MFR REC	MFR'S RECOMMENDATION
BEV	BEVELED	MH	MAN HOLE
BIT	BITUMINOUS	MIN	MINIMUM
BLDG	BUILDING	MIR	MIRROR
BLKG	BLOCKING	MISC	MISCELLANEOUS
BM	BENCH MARK, BEAM	ML	METAL LATH
BOT	BOTTOM	MOLD	MOLDING
BRG	BEARING	MLWK	MILLWORK
BRK	BRICK	MO	MOISTURE RESISTENT
C	COURSE	MS	MACHINE SCREW
CAB	CABINET	MTG	MOUNTED, MOUNTING
CAP	CAPACITY	MTL	METAL
CB	CHALK BOARD, CATCH BASIN, CHR BEAD	MW	MICROWAVE
CBB	CEMENTITIOUS BACKER BOARD	NAT	NATURAL
CER	CERAMIC	NIC	NOT IN CONTRACT
CEM	CEMENT	NFPA	NATL FIRE PROTECTION ASSN
CHFR	CHAMFER	NO	NUMBER
CI	CAST IRON	NOM	NOMINAL
CJ	CONTROL JOINT	NTS	NOT TO SCALE
CL	CENTER LINE	OA	OVERALL
CLDG	CLADDING	OC	ON CENTER
CLG	CEILING	OD	OUTSIDE DIAMETER
CLO	CLOSET	OF/CI	OWNER FURNISHED / CONTRACTOR INSTALLED
CLR	CLEAR	OH	OVERHEAD
CM	CONSTRUCTION MANAGEMENT	OPNG	OPENING
CMH	COLD FORMED METAL FRAMING	OPP	OPPOSITE
CMT	CERAMIC MOSAIC TILE	OPR	OPERABLE
CMU	CONCRETE MASONRY UNIT	OS	OUTSIDE
CNR	CORNER	PAR	PARALLEL, PARAPET
CNTR	COUNTER	PART	PARTIAL
COL	COLUMN	PARTN	PARTITION
COMP	COMPRESSIBLE	PBD	PARTICLE BOARD
CONC	CONCRETE	PCC	PRECAST CONCRETE
CONST	CONSTRUCTION	PERF	PERFORATED
CONT	CONTINUOUS	PERIM	PERIMETER
COORD	COORDINATE	PERP	PERPENDICULAR
CP	CAST IN PLACE	PHS	PHILLIPS HEAD SCREW
CPT	CAPET	PL	PLATE, PROPERTY LINE
CT	CERAMIC TILE	PLAM	PLASTIC LAMINATE
CTK	COUNTERSUNK	PLAS	PLASTIC, PLASTER
CTR	CENTER	PLYWD	PLYWOOD
CJ	COPPER, CUBIC	PNL	PANEL
CUH	CABINET UNIT HEATER	POLY	POLYETHYLENE, POLYURETHANE
D	DRIVER	POLYISO	POLYISOCYANURATE INS BOARD
DBL	DOUBLE	PREFIN	PREFINISHED PARTICLE BOARD
DF	DRINKING FOUNTAIN	PREFIN	PREFINISHED
DH	DOUBLE HUNG	PT	PAINT, PRESSURE TREATED
DIA	DIAMETER	PTD	PAINTED
DIM	DIMENSION	QT	QUARRY TILE
DISP	DISPENSER, DISPOSAL	R	RADIUS, RISER
DPM	DAMP PROOF MEMBRANE	RB	RUBBER BASE
DRW	DRAWER	RBR	RUBBER
DS	DOWNSPOUT	RAD	RADIATOR
DTL	DETAIL	RC	RESILIENT CHANNEL
DW	DISHWASHER	RD	ROOF DRAIN
DWG	DRAWING	REC	RECESSED
EA	EACH	RECEPT	RECEPTACLE
EFPS	EXTERIOR INS + FINISH SYSTEM	REF	REFERENCE
EL	ELEVATION	REFR	REFRIGERATOR
ELEC	ELECTRICAL	REINF	REINFORCE, REINFORCING
ELEV	ELEVATOR, ELEVATION	REP	REPAIR
EPDM	ETHYLENE PROPYLENE DIENE MONOMER	REPL	REPLACE
EQ	EQUAL	REOD	REORDER
EQ SP	EQUALLY SPACED	RESIL	RESILIENT
EPS	EXPANDED POLYSTYRENE INS BOARD	RFS	RESISTOUS FLOORING SYSTEM
EW	EACH WAY	RH	RIGHT HAND
EW	ELECTRIC WATER COOLER	RL	RAIN LEADER
EX	EXISTING	RM	ROOM
EXH	EXHAUST	RD	ROUGH OPENING
EXP	EXPANSION, EXPOSED	SAT	SUSPENDED ACOUSTICAL TILE
EXT	EXTERIOR	SC	SOLID CORE
FA	FIRE ALARM	SD	SMOKE DETECTOR
FAS	FASCIA	SECT	SECTION
FC	FIRE CODE	SF	SQUARE FEET
FCH	FURRING CHANNEL	SHF	SHELF
FD	FLOOR DRAIN	SHR	SHOWER
FDN	FOUNDATION	SHRD	SHOWER DRAIN
FE	FIRE EXTINGUISHER	SHT	SHEET
FE EL	FINISH FLOOR ELEVATION	SHTV	SHEET VINYL
FG	FIBERGLASS	SI	SIMILAR
FH	FLAT HEAD, FIRE HOSE	SI	SCORED JOINT
FIN	FINISH, FINISHED	SKLT	SKYLIGHT
FIXT	FIXTURE	SPCF	SPRAYED CELLULOSIC FIBER
FL	FLUSH	SPECS	SPECIFICATIONS
FLDG	FOLDING	SPPP	SPRAYED FIREPROOFING
FLR	FLOOR	SPKR	SPRINKLER
FLSHG	FLASHING	SPUF	SPRAYED POLYURETHANE FOAM
FLUOR	FLUORESCENT	SQ	SQUARE
FOF	FACE OF FINISH	SS	SOLID SURFACING
FOM	FACE OF MASONRY	SST	STAINLESS STEEL
FOS	FACE OF STUD OR SLAB	STD	STANDARD
FOW	FACE OF WALL	STL	STEEL
FP	FIREPROOF, FIREPROOFING	STO	STORAGE
FR	FIRE RATED, FIRE RESISTANT, FRAME	STRUCT	STRUCTURE, STRUCTURAL
FRMG	FRAMING	SUP	SUPPORT
FRT	FLOCKED RESILIENT TILE	SUSP	SUSPENDED
FSR	FLEXIBLE SHEET ROOFING	SYM	SYMMETRICAL
FTG	FOOTING	T	TREAD
FURG	FURRING	TB	THROUGH BOLT, TOWEL BAR
FURN	FURNISH, FURNITURE	TEMP	TEMPERED
FWC	FABRIC WALL COVERING	TER	TERRAZZO
GA	GAUGE	TFM	THERMALLY FUSED MELAMINE
GALV	GALVANIZED	THK	THICK
GB	GRAB BAR	THR	THRESHOLD
GC	GENERAL CONTRACTOR	THRU	THROUGH
GDR	GUARD RAIL	TKBD	TACKBOARD
GFRG	GLASS FIBER REINFORCED CONCRETE	TOB	TOP OF BEAM
GFRG	GLASS FIBER REINFORCED GYPSUM	TOC	TOP OF CONCRETE
GFRP	GLASS FIBER REINFORCED PLASTIC	TOS	TOP OF STEEL
GL	GLASS	TOW	TOP OF WALL
GSB	GYPSUM SHEATHING BOARD	TP	TOILET PAPER
GT	GROUT	TR	TACK RAIL
GWB	GYPSUM WALL BOARD	TSTAT	THERMOSTAT
GYP	GYPSUM	TR	TYPICAL
GYP BD	GYPSUM BOARD	T&B	TOP AND BOTTOM
GYP PL	GYPSUM PLASTER	T&G	TONGUE AND GROOVE
HB	HOSE BIBB	T-Z CU	TIN ZINC COATED COPPER
HC	HANDICAPPED, HOLLOW CORE	UC	UNDERCUT
HD	HEAD	UN	UNLESS OTHERWISE NOTED
HDBD	HARDBOARD	UPS	UNINTERRUPTIBLE POWER SUPPLY
HDR	HEADER	UR	URINAL
HDW	HARDWARE	V	VINYL, VENT
HDWD	HARDWOOD	VCT	VINYL COMPOSITION TILE
HGR	HANGER	VERT	VERTICAL, VERTICALLY
HM	HOLLOW METAL	VEST	VESTIBULE
HNDRL	HANDRAIL	VIF	VARIETY IN FIELD
HORIZ	HORIZONTAL	VNR	VENER
HP	HIGH POINT	VP	VENER PLASTER
HPDL	HIGH PRESSURE DECORATIVE LAMINATE	VR	VAPOR RETARDER
HR	HOUR	VWC	VINYL WALL COVERING
HRSKRG	HOUSEKEEPING	VWF	VINYL WALL FABRIC
HT	HEIGHT	W	WASHING MACHINE, WIDE
HTG	HEATING	WB	WHITE BOARD
HW	HOT WATER	WC	WATER CLOSET
IBC	INTERNATIONAL BUILDING CODE	WD	WOOD
ID	INSIDE DIAMETER	WDW	WINDOW
INCL	INCLUSIVE	WH	WATER HEATER
INS	INSULATION	WM	WIRE MESH
INT	INTERIOR	WP	WATERPROOFING
INV	INVERT	WPM	WATERPROOF MEMBRANE
IS	INSIDE	WPO	WALL PROTECTION OVERLAY
IWH	INSTANTANEOUS WATER HEATER	WS	WOOD SCREEN, WEATHERSTRIP
JC	JANITORS CLOSET	WSCT	WAINSCOT
JBOX	JUNCTION BOX	WWF	WELDED WIRE MESH
JST	JOIST	W	WITH
JT	JOINT	W/O	WITHOUT
KC	KILN DRIED, KNOCKED DOWN	XPS	EXTRUDED POLYSTYRENE INS BD
KIT	KITCHEN		
L	ANGLE		
LAM	LAMINATED		
LAV	LAVATORY		
LBR	LUMBER		

Materials

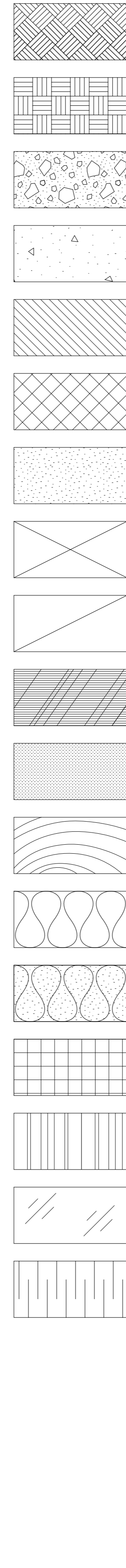

UNDISTURBED EARTH

COMPACTED FILL

POROUS FILL

CONCRETE

FACE BRICK

CONCRETE BLOCK CMU

MORTAR / GROUT / DRYWALL

WOOD FRAMING - CONTINUOUS

WOOD BLOCKING OR SHIM

PLYWOOD

PARTICLE BOARD / MDF

FINISH WOOD

BATT OR LOOSE FILL INSULATION

BLOWN INSULATION

RIGID INSULATION

SHEET METAL

GLASS ELEVATION

ACOUSTICAL TILE

Courtroom 12

Acoustics Improvements

Cumberland County Superior Court

Administrative Office of the Courts
Portland, Maine

For Construction
March 30, 2021

Architect

Winton Scott Architects
5 Milk Street
Portland, Maine 04101
207-774-4811

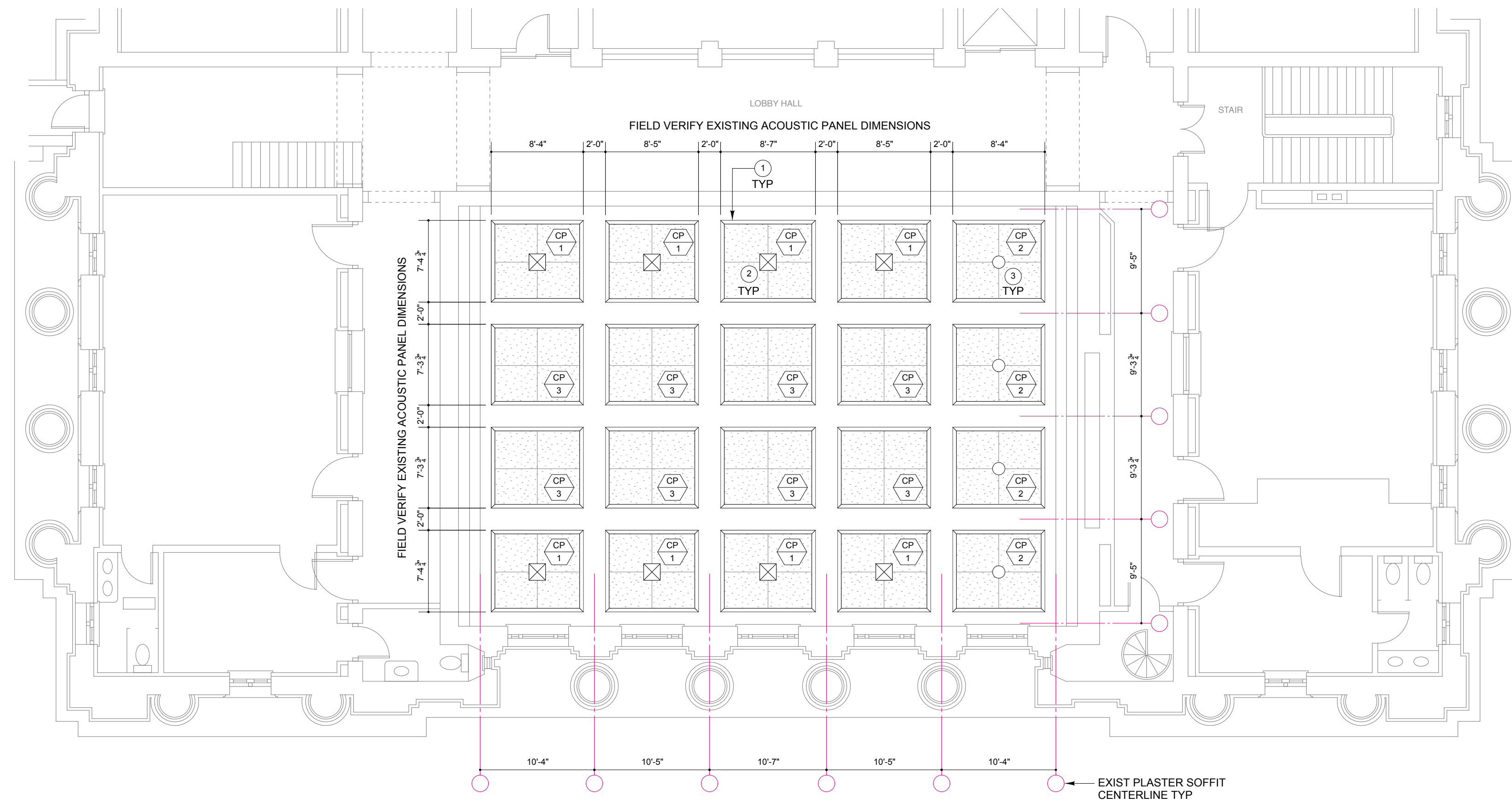

SECOND FLOOR CEILING PLAN PROJECT PHASE 2

1/8" = 1' - 0"

CEILING HEIGHT = +/- 25' - 6" AFF

LEGEND

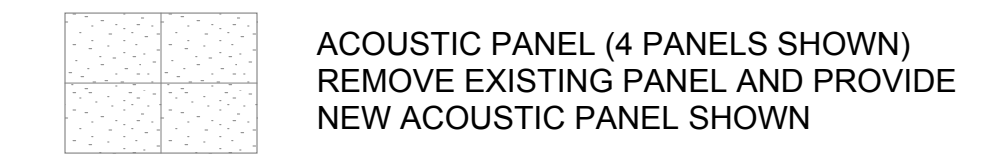

KEYED NOTES

- ① REMOVE EXISTING WOOD TRIM. REMOVE EXISTING CANVAS AND ACOUSTIC PANEL. INSTALL NEW ACOUSTIC PANEL. SHIM AS REQD AND RE-INSTALL WOOD TRIM. PATCH AND PAINT AS REQD.
- ② REMOVE AND REINSTALL EXISTING AIR SUPPLY OR AIR RETURN GRILLE AT EIGHT (8) CEILING PANELS.
- ③ REMOVE AND REINSTALL EXISTING DOWNLIGHT AT FOUR (4) CEILING PANELS.

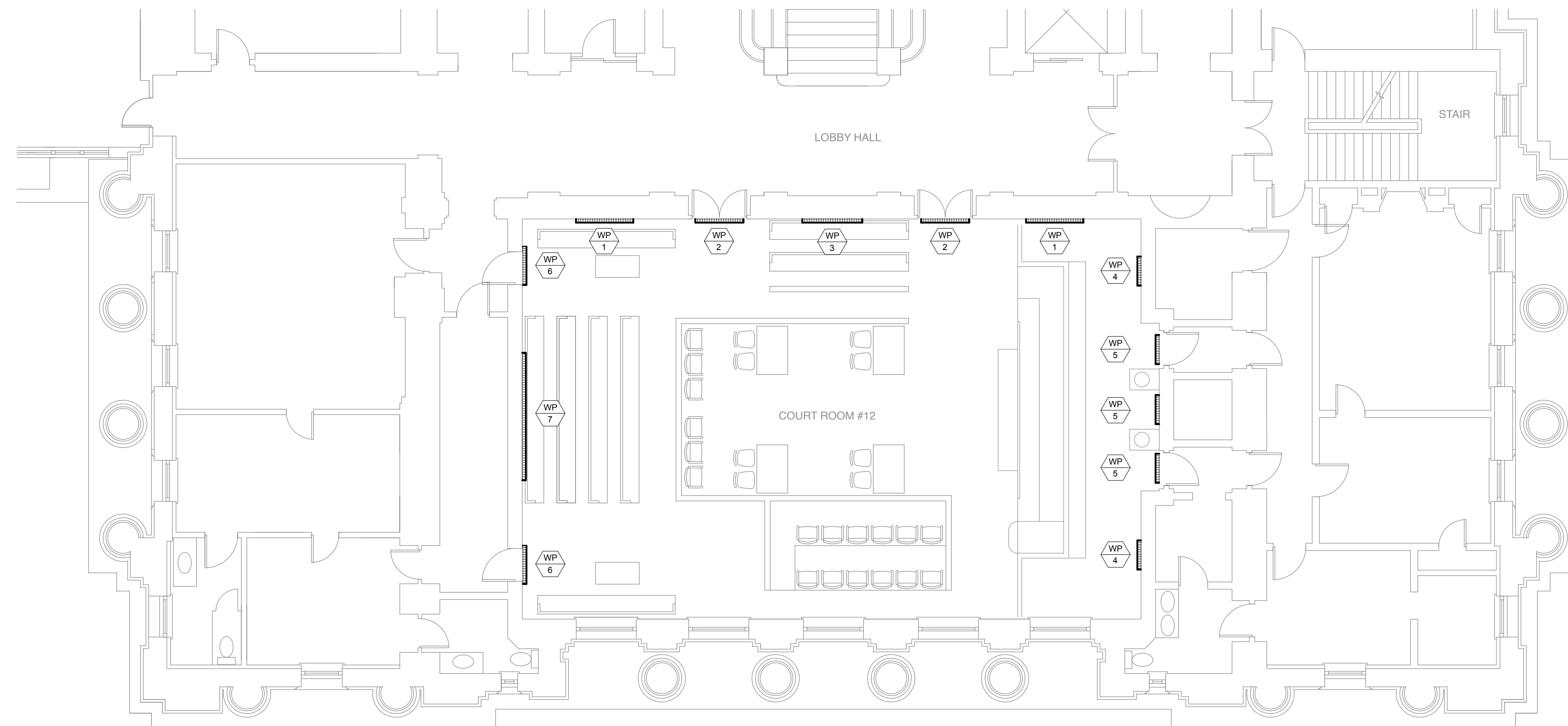

SECOND FLOOR PLAN PROJECT PHASE 1

1/8" = 1' - 0"

State of Maine
 Superior Court
 Portland, Maine

Courtroom 12

Acoustics Improvements

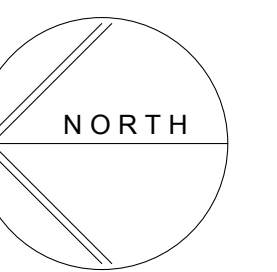

PROJECT PHASING NOTES

PHASE 1

1. BEGIN WORK ON JUNE 1, 2021
2. THE COURTROOM SHALL REMAIN IN USE DURING THE DAYTIME. WORK SHALL BE LIMITED TO NIGHTS AND WEEKENDS. NO STAGING OR LADDERS SHALL REMAIN IN THE ROOM DURING NORMAL WORK HOURS.

PHASE 2

1. BEGIN WORK ON OCTOBER 1, 2021 FOLLOWING A NOTICE TO PROCEED ISSUED BY THE OWNER.
2. THE COURTROOM SHALL BE FULLY UNDER CONTROL OF THE GENERAL CONTRACTOR.
3. COMPLETE THE WORK WITHIN 30 DAYS OF THE NOTICE TO PROCEED.

Second Floor Plans

Scale: 1/8" = 1' - 0"

A 1

March 30, 2021



- PAINT EXIST PLASTER MOLD AND SURROUNDING PLASTER 4 SIDES AT EACH PANEL TYPICAL
- EXIST LIMESTONE WALL UNITS PROTEC FROM DAMAGE / NO PAINT
- EXIST PLASTER
- EXIST PLASTER MOLDING TO REMAIN
- NEW ACOUSTIC PANEL

EAST ELEVATION
 1/4" = 1' - 0"

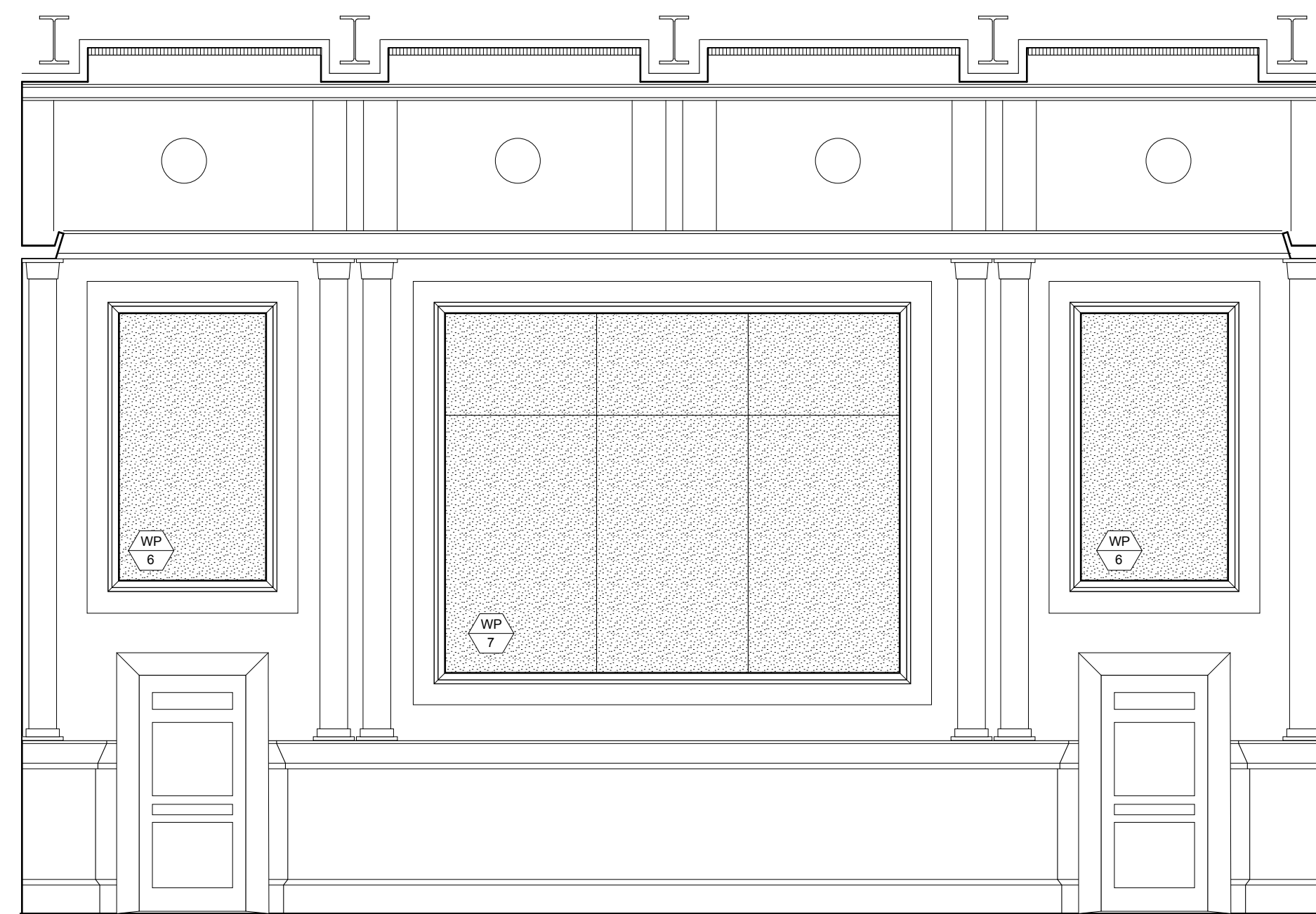

NORTH ELEVATION
 1/4" = 1' - 0"



SOUTH ELEVATION
 1/4" = 1' - 0"

State of Maine
 Superior Court
 Portland, Maine

Courtroom 12

Acoustics
 Improvements

interior
 Elevations

Scale: 1/8" = 1' - 0"

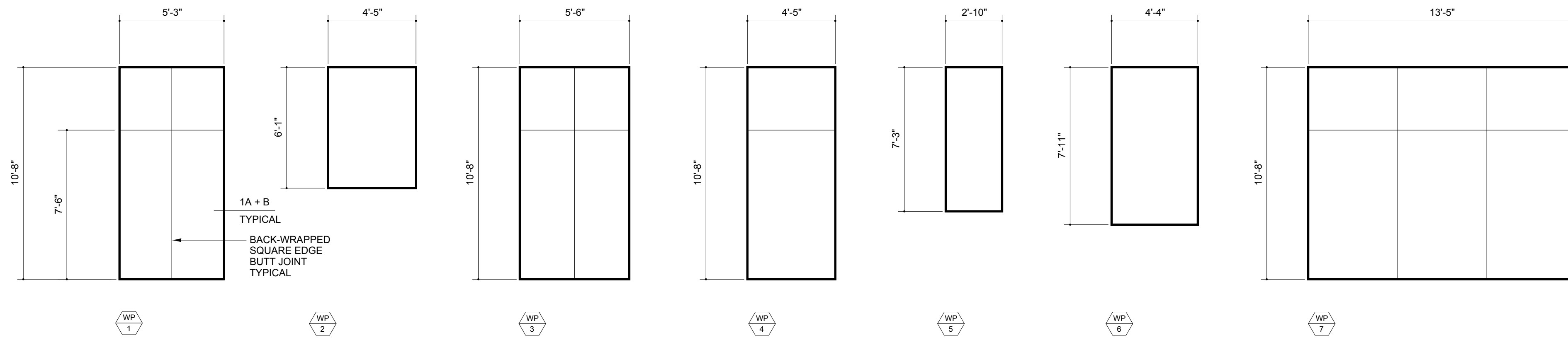

ACOUSTIC WALL PANEL TYPES
1/4" = 1'-0"
PANEL THICKNESS 1" TYPICAL
ALL TO BE INSTALLED IN PHASE 1

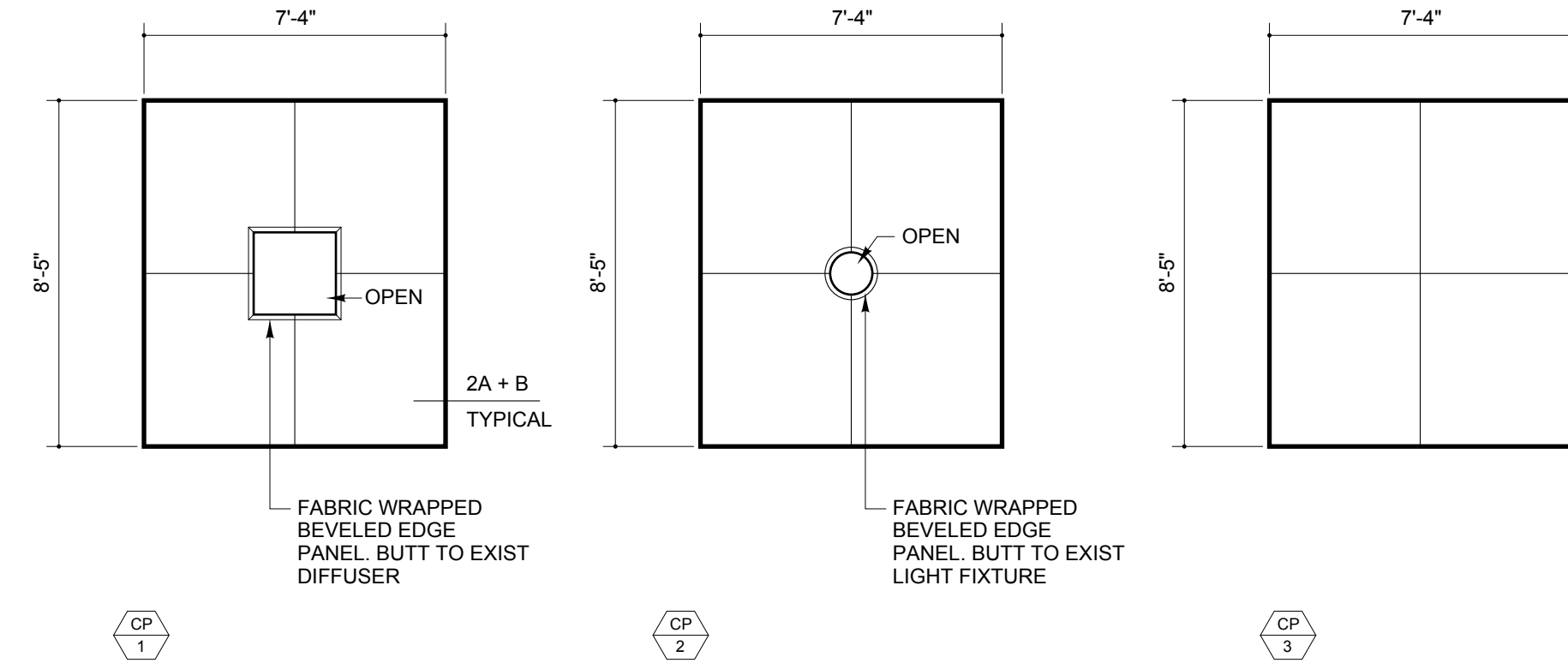

ACOUSTIC CEILING PANEL TYPES
1/4" = 1'-0"
PANEL THICKNESS 2" TYPICAL
ALL TO BE INSTALLED IN PHASE 2

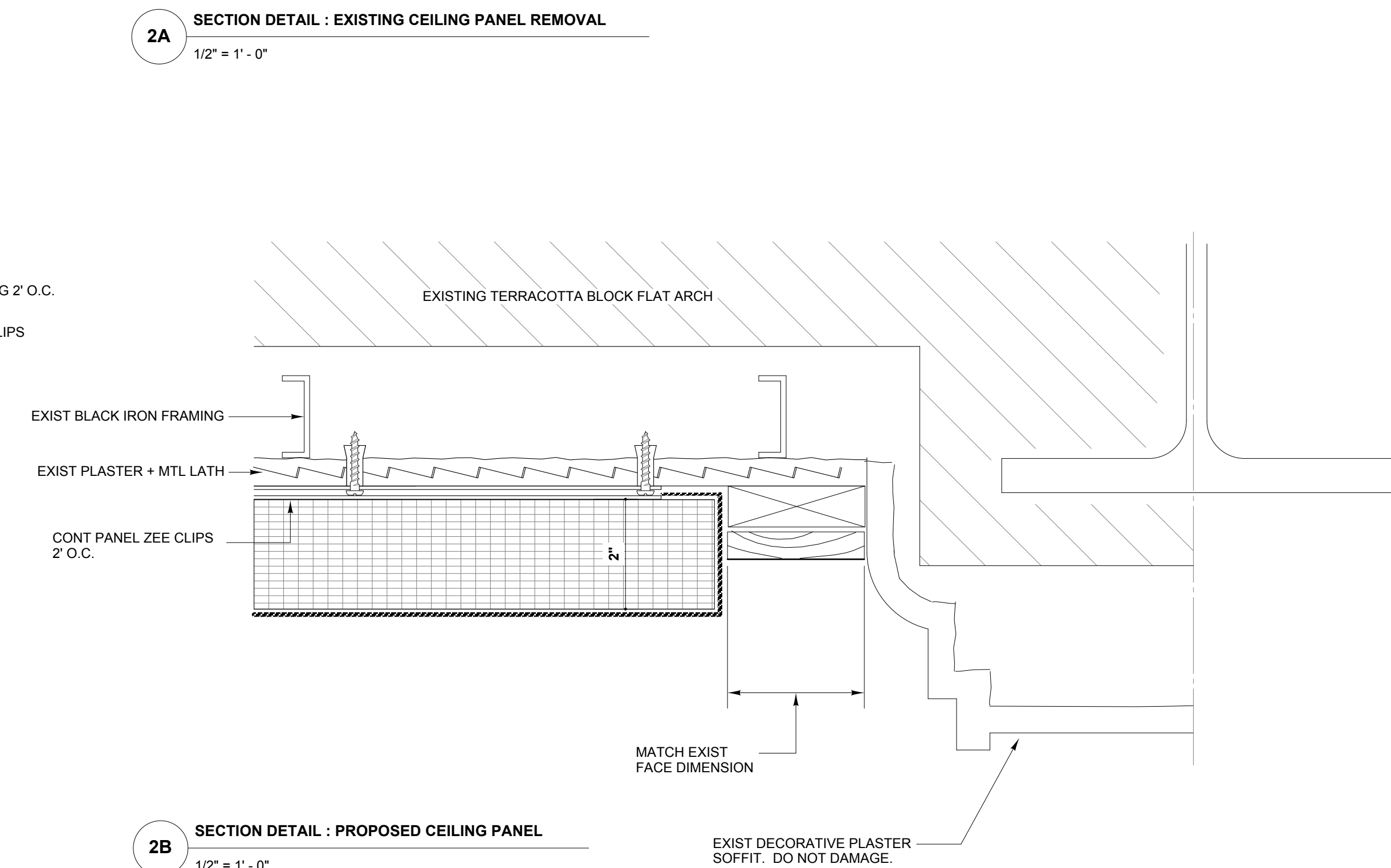
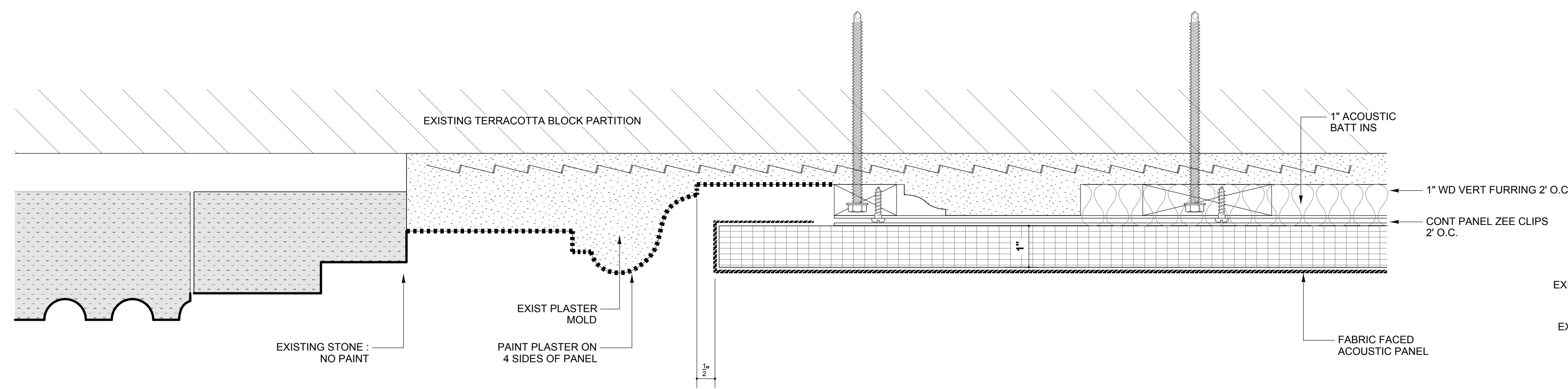
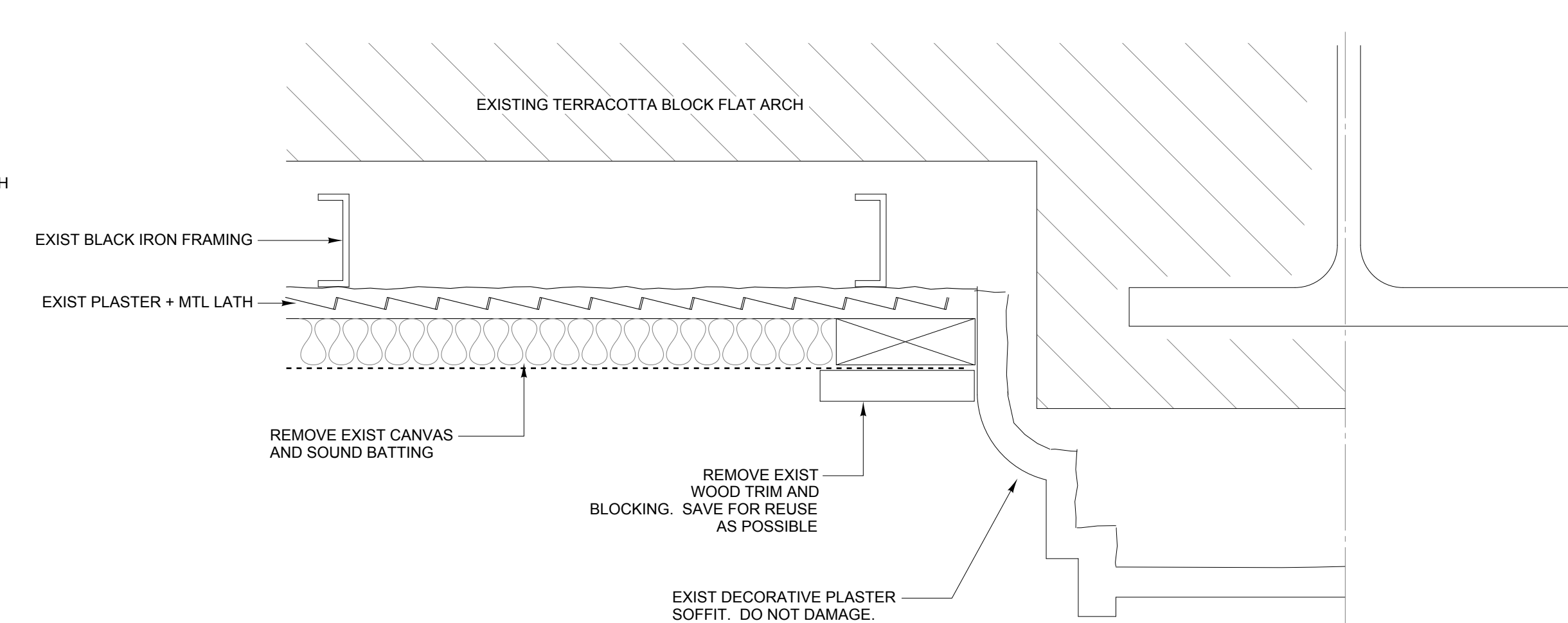
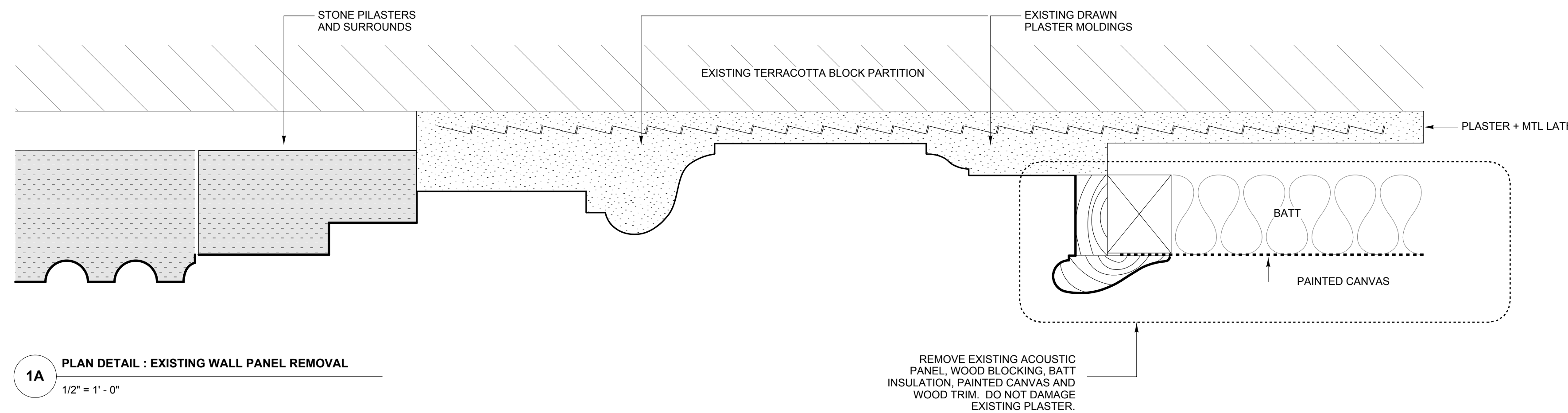

1B PLAN DETAIL : PROPOSED WALL PANEL
1/2" = 1'-0"

2B SECTION DETAIL : PROPOSED CEILING PANEL
1/2" = 1'-0"