

# Highland Pt.



T2 R2 BKP WKR  
Somerset County



Land Use Guidance Map  
Department of Agriculture, Conservation and Forestry  
Maine Land Use Planning Commission

- Legend**
- DEVELOPMENT SUBDISTRICTS**
- D-CI: Commercial Industrial
  - D-GN: General
  - D-RS: Residential
- PROTECTION SUBDISTRICTS**
- P-FP: Flood Prone
  - P-GP: Great Pond
  - P-SG: Soils and Geology
  - P-SL2: Shoreland - 75'
  - P-WL1: Wetlands of Special Significance
  - P-WL2: Scrub-shrub Wetlands
  - P-WL3: Forested Wetlands

This map does not show all designated P-WL Subdistricts, such as non-tidal water bodies and freshwater wetlands within 25 feet of flowing waters.

This map is a reduced-size version and should not be considered definitive. Full sized, official Land Use Guidance Maps are available on the LUPC website or by request.

Amendments			
Location #	Zoning Permit	Effective Date	Remarks
	ZP804	08/18/2005 02/27/2026	Adoption of digital NWI wetlands Reintegration of Highland Plantation

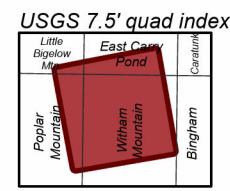
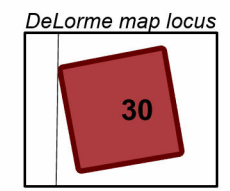
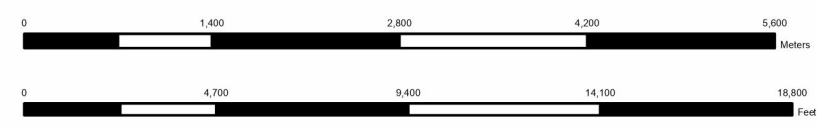

- Map amendment location
- Point at which a river drains 25 square miles - symbol points upstream (12 M.R.S. Sec. 682-B(4))
- 9999 MIDAS number: Unique number assigned to each standing body of water in Maine.
- WQLL Water Quality Limiting Lake - Refer to Section 10.23,E,3,g of the Commission's Land Use Districts and Standards.
- MC# Lake Management Classes - Refer to Section 10.02 (Definitions) of the Commission's Land Use Districts and Standards.