

SILT FENCE AND EROSION CONTROL BERMS ARE SHOWN WITH STANDARD SYMBOLS. WHERE SYMBOLS CROSS CONTOURS, EROSION CONTROL BARRIER SHALL BE ADJUSTED FOR ACTUAL FIELD CONDITIONS SUCH THAT THE BARRIER IS INSTALLED PARALLEL WITH THE CONTOUR (TYP.)

LAYDOWN AREAS TO BE UTILIZED BY THE CONTRACTOR FOR THE FOLLOWING: LANDING YARD, TOPSOIL STOCKPILE, AND COMPONENT STORAGE AS NEEDED.

EXISTING 24" CULVERT TO BE LENGTHENED AS NEEDED

EXISTING 24" CULVERT TO BE LENGTHENED AND REALIGNED

GRAPHIC SCALE

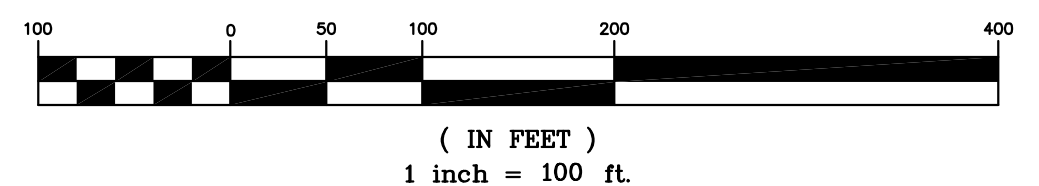

GRAPHIC SCALE

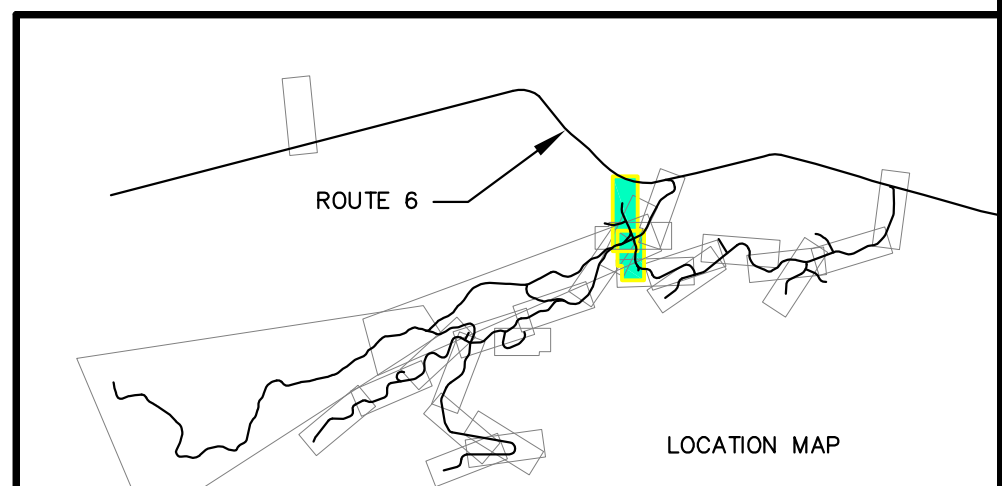
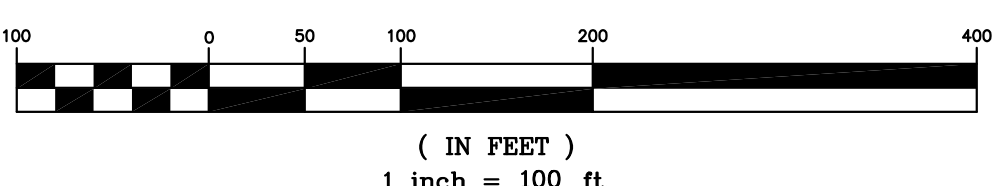

PRELIMINARY NOT FOR CONSTRUCTION

Rev. No.	Drawn By	Description	Date
1	JAO	ISSUED FOR AGENCY REVIEW	3/7/2011
2	JCH, JLD	REVISED PER AGENCY COMMENTS	5/12/11

Developed By	Drawn By	Checked By
JAO	JAO	JAO
Date	Date	Date
05/23/2011	05/23/2011	05/23/2011
Scale	Scale	Scale
1"=100'	1"=100'	1"=100'
Approval	Approval	Approval
Checked	Checked	Checked

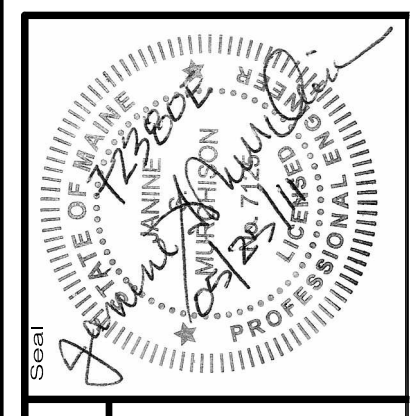

**72380E**

an integrated team of geospatial, engineering, surveying and NATURAL RESOURCE consultants

**SEWALL**  
JAMES W. SEWALL COMPANY Since 1880  
800.648.4202  
SEWALL.COM

Project No. **72380E**

Phase **PERMIT**

Sheet No. **500**

**BOWERS WIND PROJECT**

Project Location  
**CARROLL PLANTATION & KOSSUTH TOWNSHIP, MAINE**

UNIVERSITY OF MAINE  
233PM  
**DIPPER POND ROAD  
EROSION CONTROL PLAN**



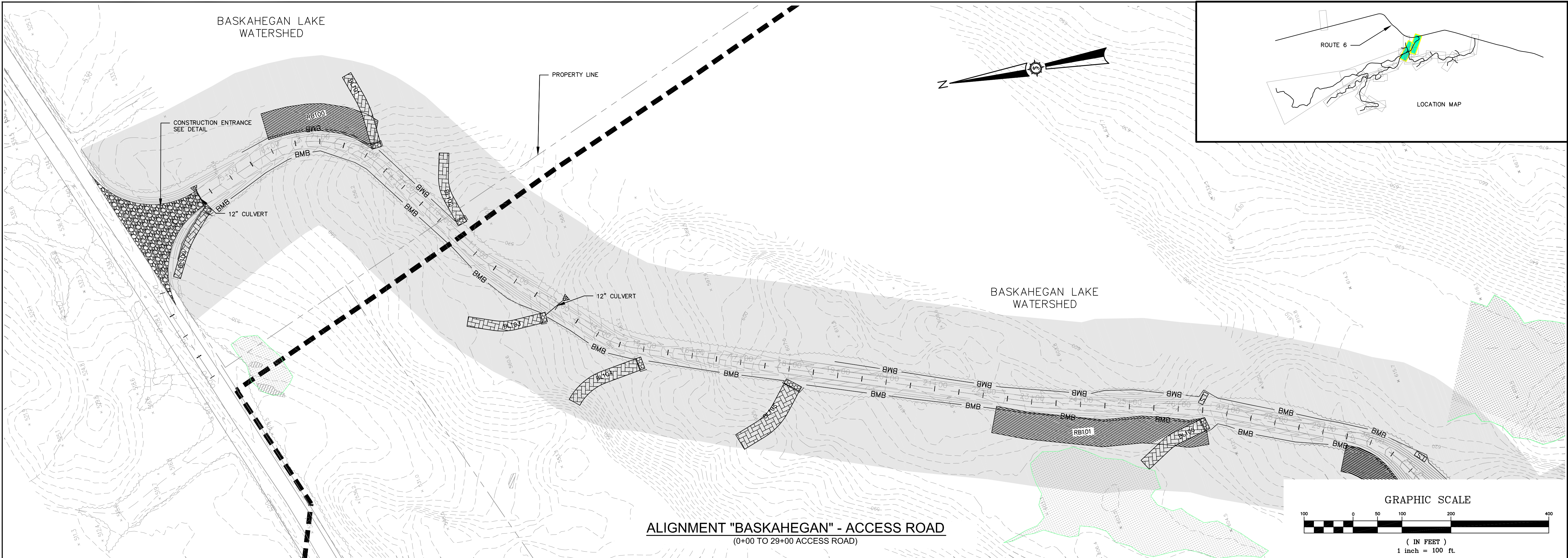

**ALIGNMENT "BASKAHEGAN" - ACCESS ROAD**  
(0+00 TO 29+00 ACCESS ROAD)

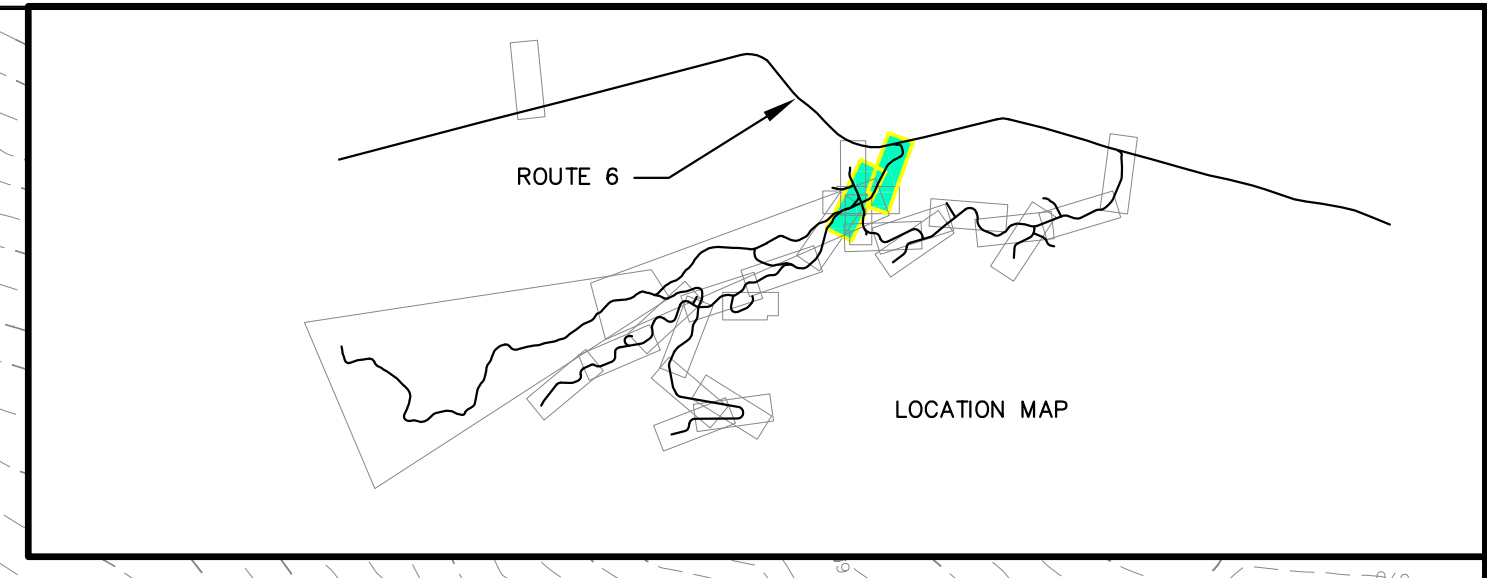
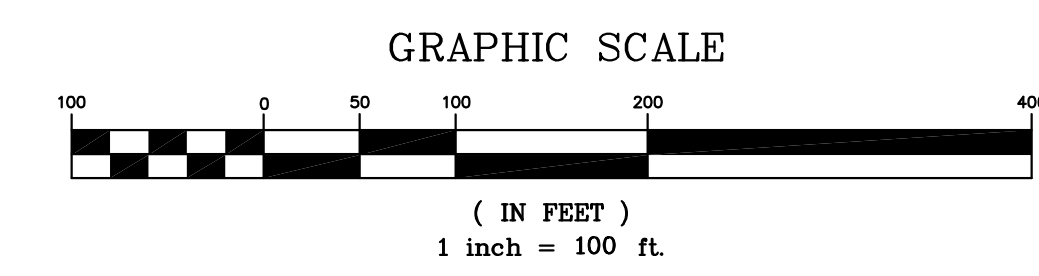

**ALIGNMENT "BASKAHEGAN" - ACCESS ROAD**  
(29+00 TO 41+80 ACCESS ROAD)

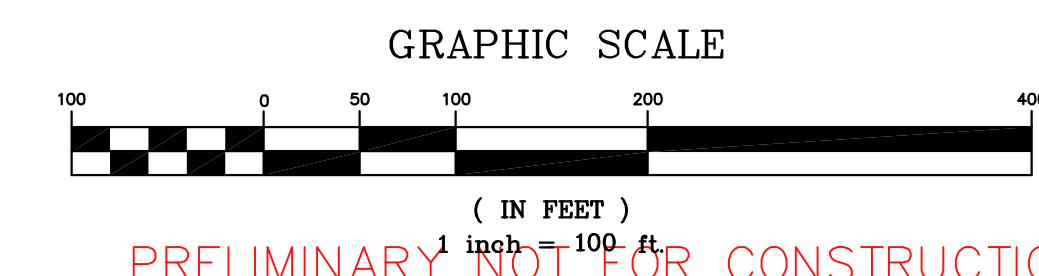

PRELIMINARY NOT FOR CONSTRUCTION

Drawn By	JAO	Checked	JSM
Issued For Agency Review	3/7/2011	Revised Per Agency Comments	5/12/11
Drawn By	JAO	Checked	JSM
Issued For Agency Review	3/7/2011	Revised Per Agency Comments	5/12/11

**BOWERS WIND PROJECT**

Developed By: JAO  
 Date: 05/23/2011  
 Scale: 1"=100'  
 Approved: [Signature]

Project Location: CARROLL PLANTATION & KOSSUTH TOWNSHIP, MAINE  
 University of Maine  
 2385M

**BASKAHEGAN ACCESS EROSION CONTROL PLAN**

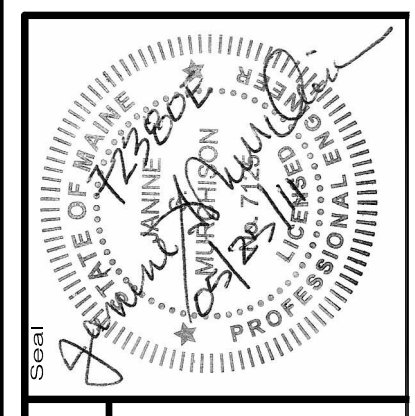

**72380E**

an integrated team of geospatial, engineering, surveying and NATURAL RESOURCE consultants

**SEWALL**  
 JAMES W. SEWALL COMPANY Since 1880  
 SEWALL.COM 800.648.4202

Project No. 72380E  
 Permit No. **PERMIT**  
 Sheet No. **501**



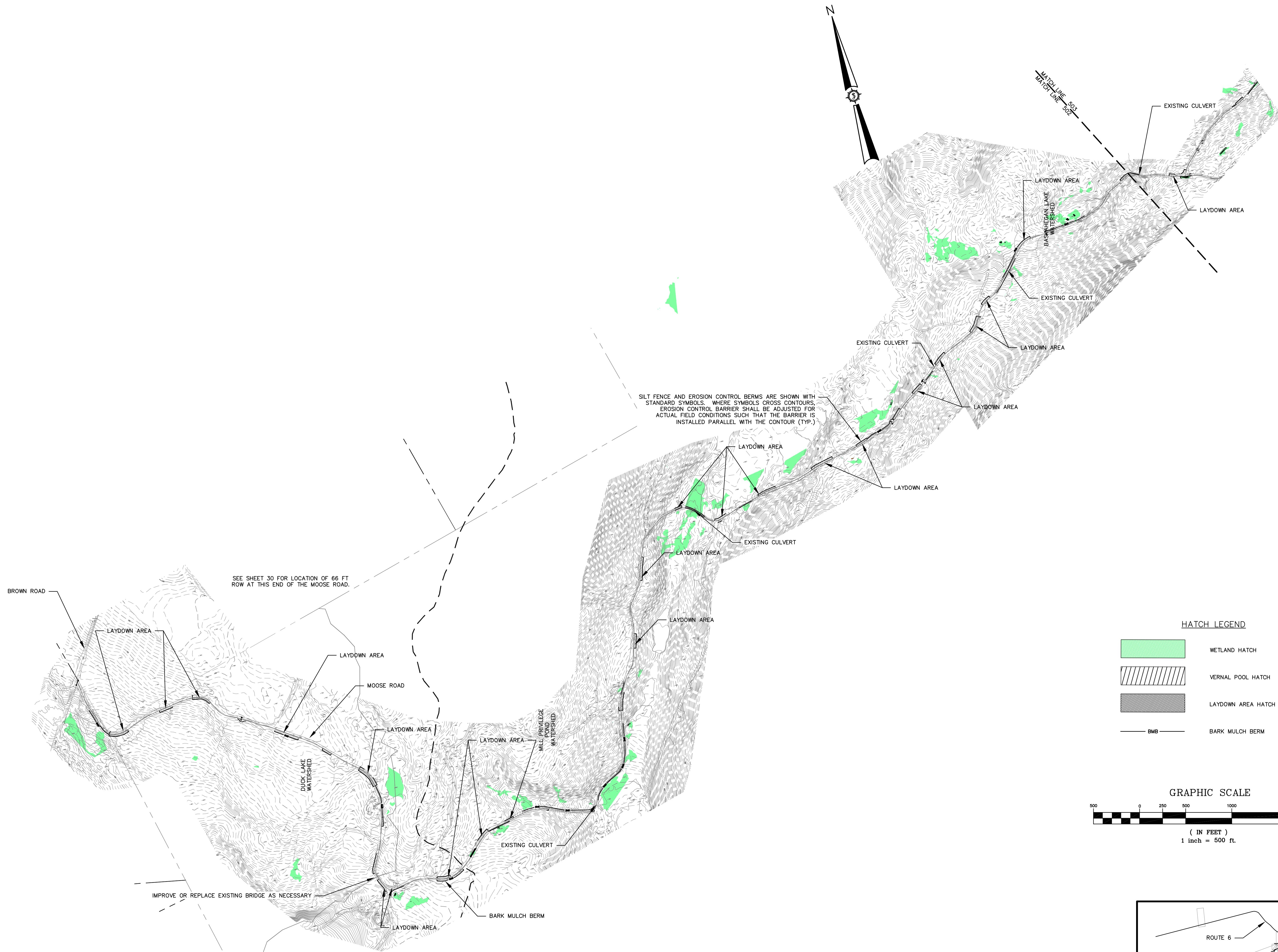



SEE SHEET 30 FOR LOCATION OF 66 FT ROW AT THIS END OF THE MOOSE ROAD.

SILT FENCE AND EROSION CONTROL BERMS ARE SHOWN WITH STANDARD SYMBOLS. WHERE SYMBOLS CROSS CONTOURS, EROSION CONTROL BARRIER SHALL BE ADJUSTED FOR ACTUAL FIELD CONDITIONS SUCH THAT THE BARRIER IS INSTALLED PARALLEL WITH THE CONTOUR (TYP.)

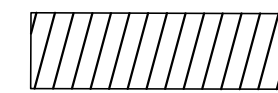
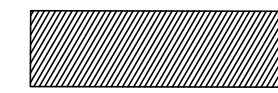
HATCH LEGEND

-  WETLAND HATCH
-  VERNAL POOL HATCH
-  LAYDOWN AREA HATCH
-  BMB BARK MULCH BERM

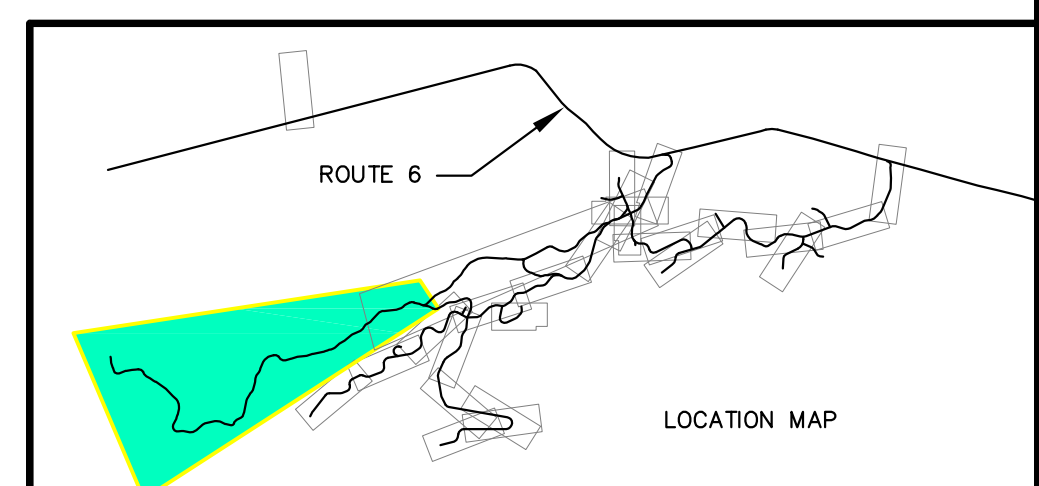
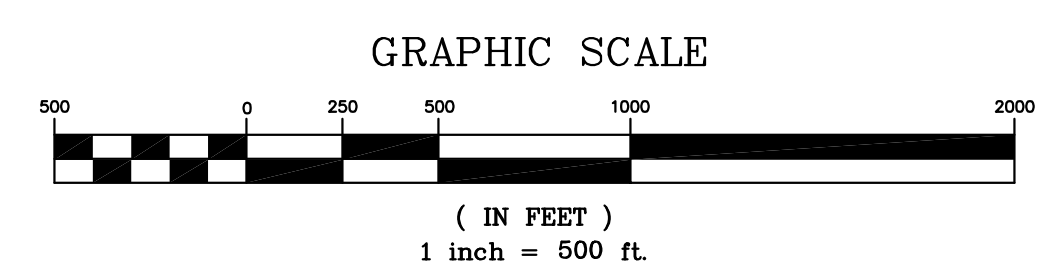

PRELIMINARY NOT FOR CONSTRUCTION

Drawn By	Checked By	Date
MT	JSM	3/7/2011
JCH, JLD		5/12/11

**BOWERS WIND PROJECT**

Drawn By: JSM, M/T  
 Date: 05/23/2011  
 Scale: 1"=500'

Project Location: CARROLL PLANTATION & KOSSUTH TOWNSHIP, MAINE  
 Drawing Description: MOOSE ROAD ACCESS ROAD

Approved: [Signature]  
 Checked: [Signature]

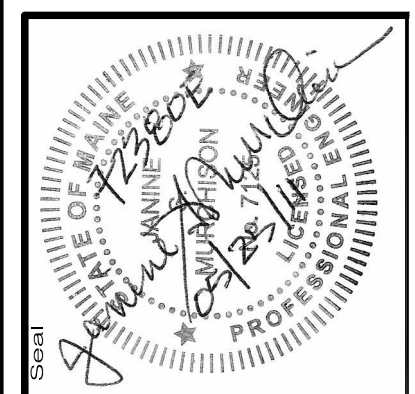

72380E

an integrated team of geospatial, engineering, surveying and NATURAL RESOURCE consultants

**SEWALL**  
 JAMES W. SEWALL COMPANY Since 1880  
 SEWALL.COM 800.648.4202

PERMIT

Sheet No. **502**



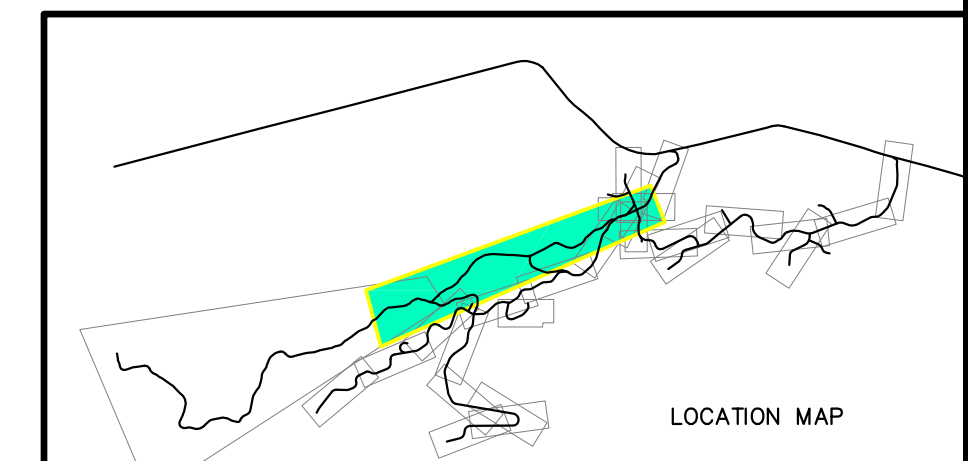
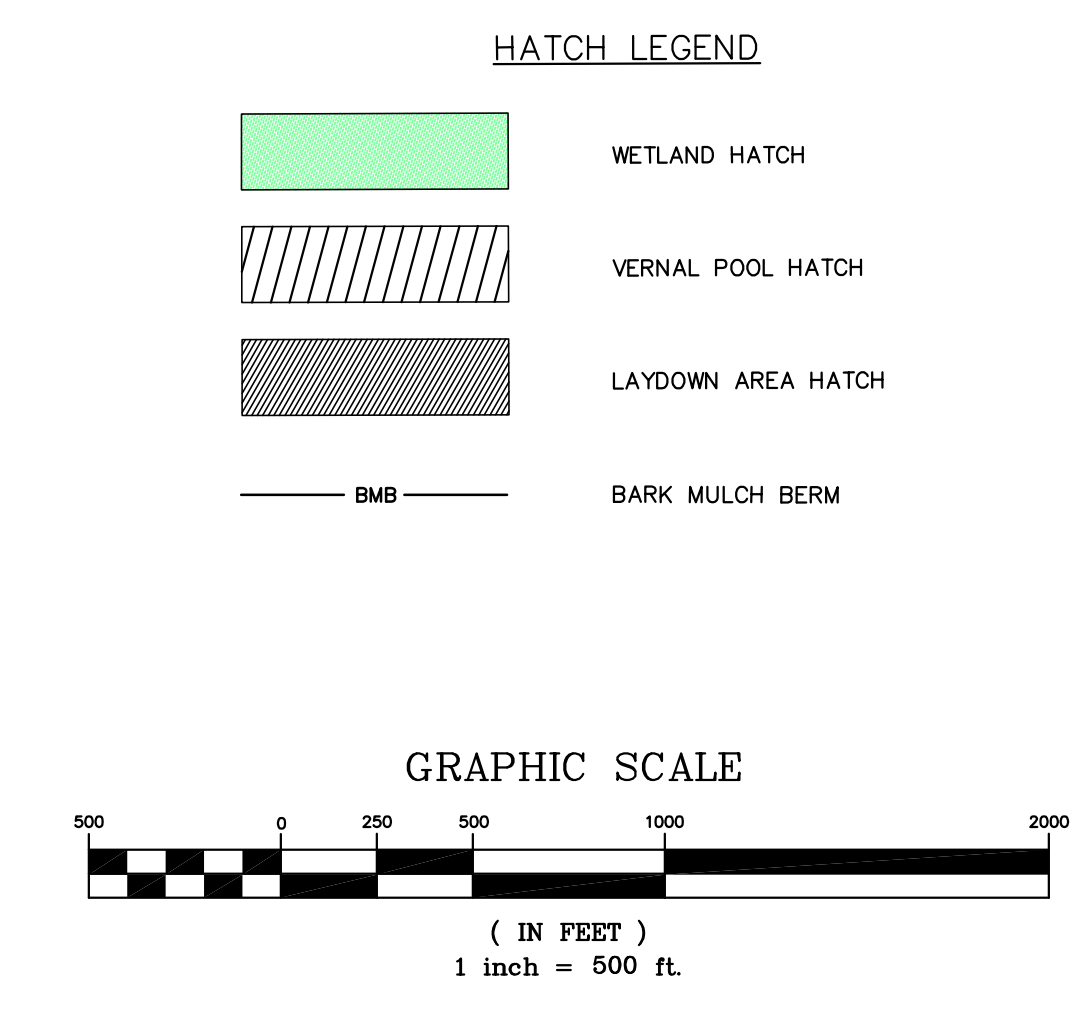
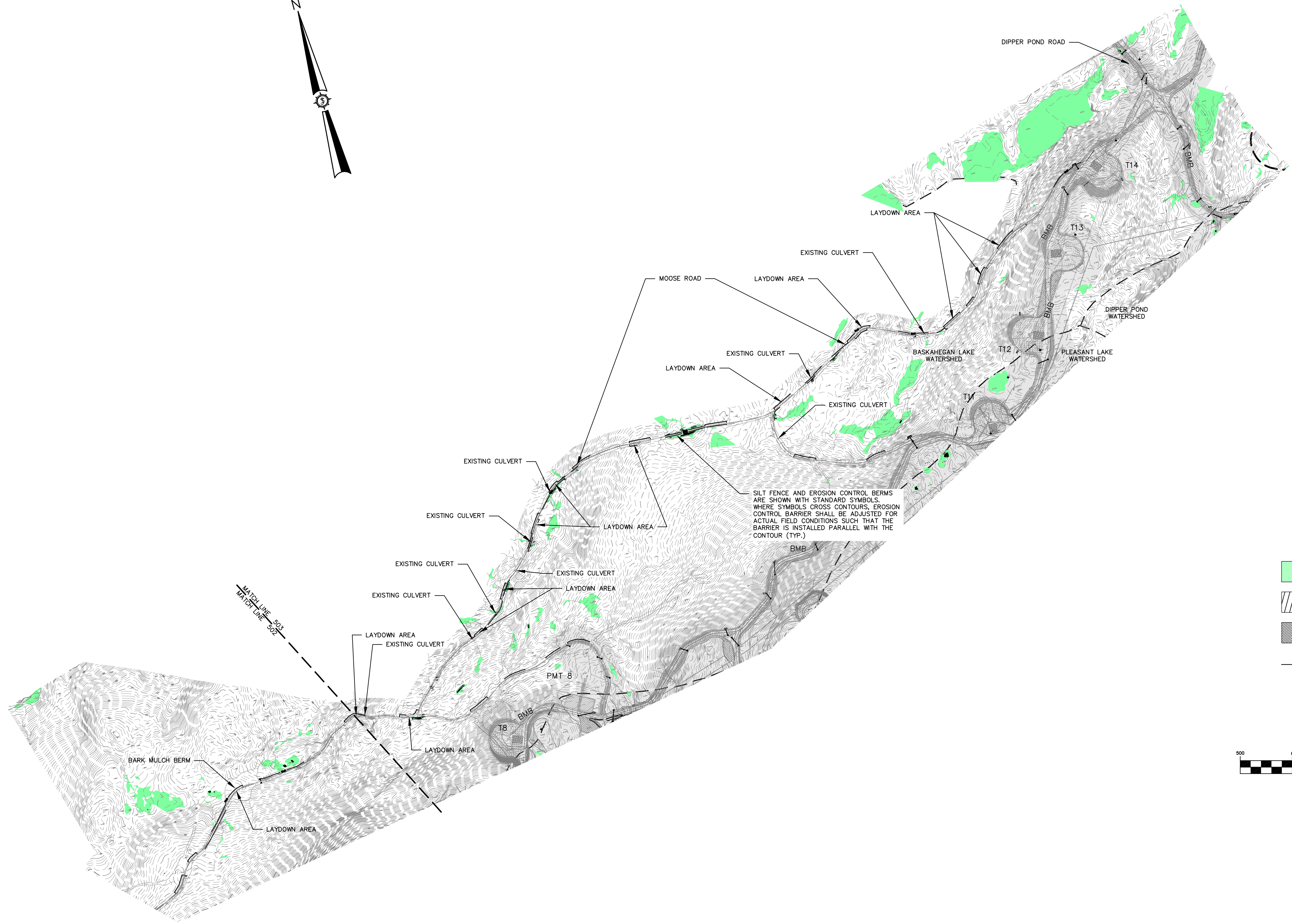
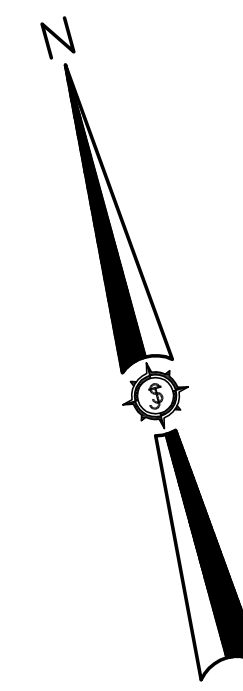

PRELIMINARY NOT FOR CONSTRUCTION

Drawn By	Description	Date
MT	ISSUED FOR AGENCY REVIEW	3/7/2011
JCH, JLD	REVISED PER AGENCY COMMENTS	5/12/11

Developed By	Drawn By
JSM	MT
Date: 05/23/2011	Scale: 1"=500'
Project Location: CARROLL PLANTATION & KOSSUTH TOWNSHIP, MAINE	Approved: [Signature]
Drawing Description: MOOSE ROAD ACCESS ROAD	Checked: [Signature]

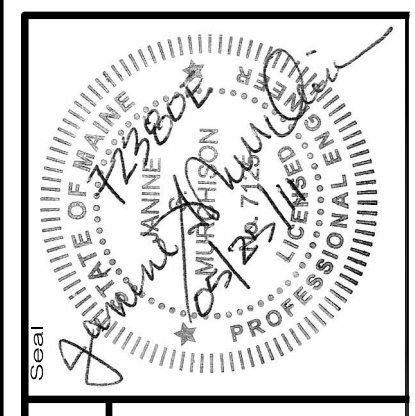

**72380E**

an integrated team of geospatial, engineering, surveying and NATURAL RESOURCE consultants

**SEWALL**  
JAMES W. SEWALL COMPANY Since 1880  
SEWALL.COM 800.648.4202

Project No. 72380E  
Phase: PERMIT

Sheet No. 503



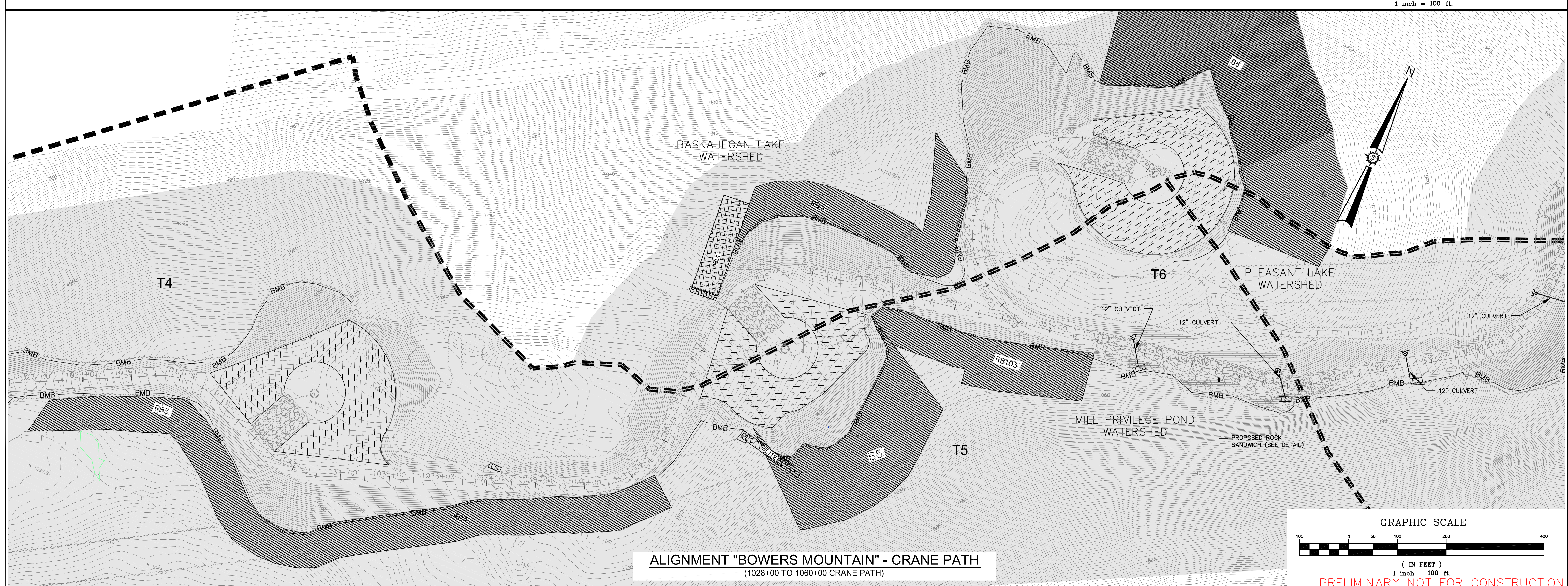
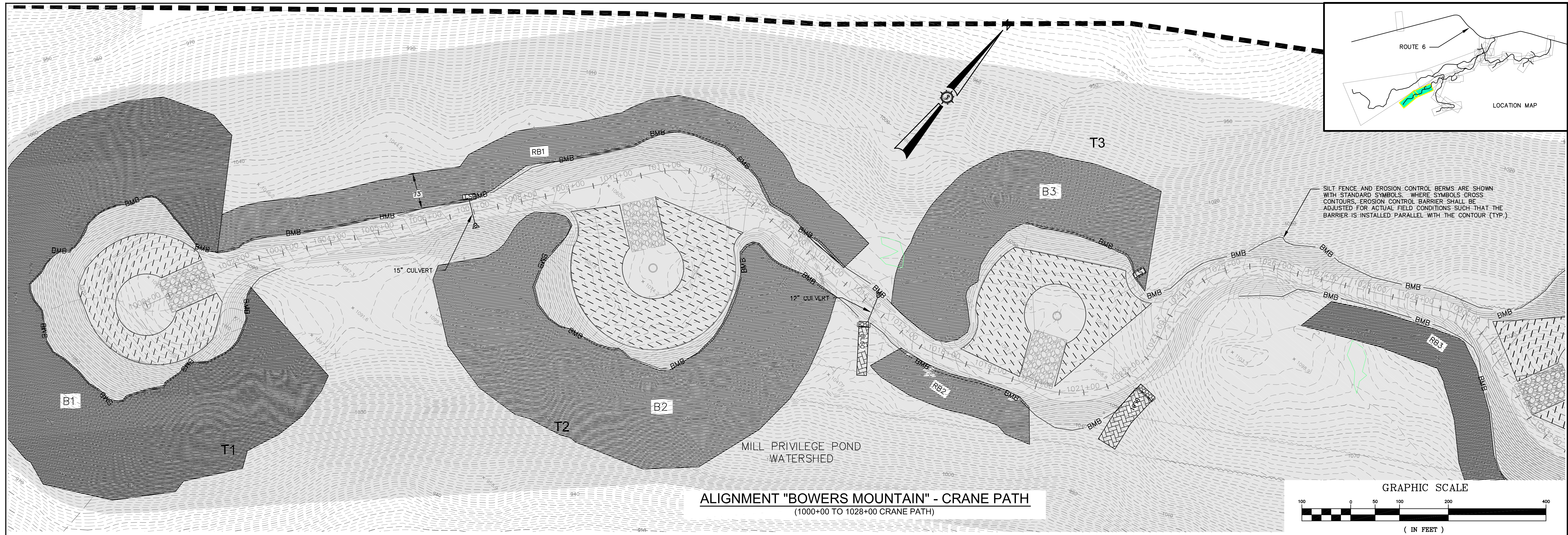

Date	Drawn By	Description
3/7/2011 <td>JSM <td>ISSUED FOR AGENCY REVIEW</td> </td>	JSM <td>ISSUED FOR AGENCY REVIEW</td>	ISSUED FOR AGENCY REVIEW
5/12/11 <td>JSM <td>REVISED PER AGENCY COMMENTS</td> </td>	JSM <td>REVISED PER AGENCY COMMENTS</td>	REVISED PER AGENCY COMMENTS

Drawn By	Project Location	Scale	Approved	Checked
JAO	CARROLL PLANTATION & KOSSUTH TOWNSHIP, MAINE	1"=100'	JSM	JSM

**BOWERS WIND PROJECT**

**BOWERS MOUNTAIN EROSION CONTROL PLAN**

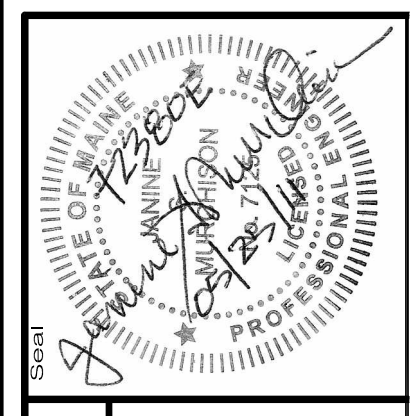

72380E

an integrated team of geospatial, engineering, surveying and NATURAL RESOURCE consultants

**SEWALL**  
JAMES W. SEWALL COMPANY / Since 1880  
SEWALL.COM 800.648.4202

PERMIT

600

PRELIMINARY NOT FOR CONSTRUCTION



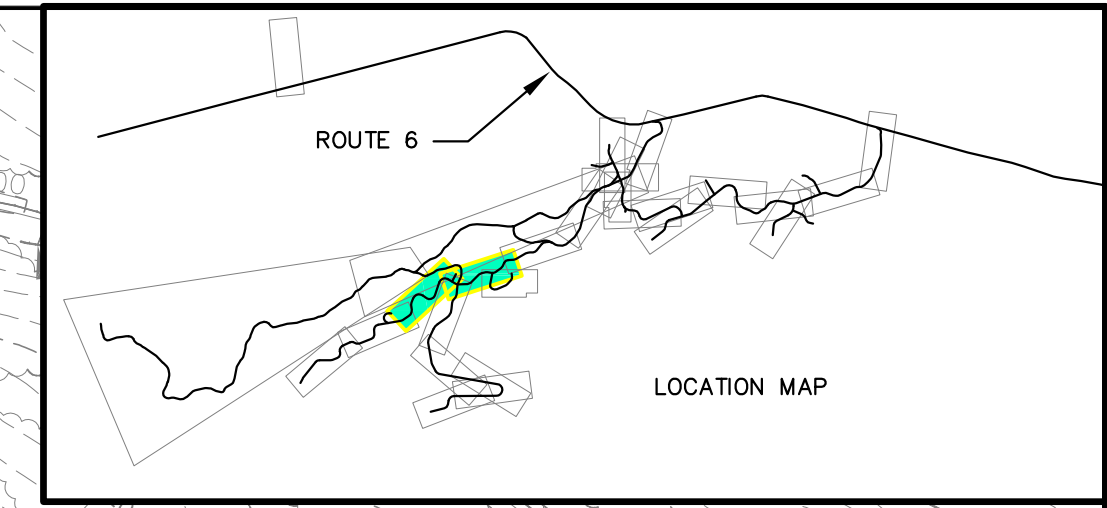
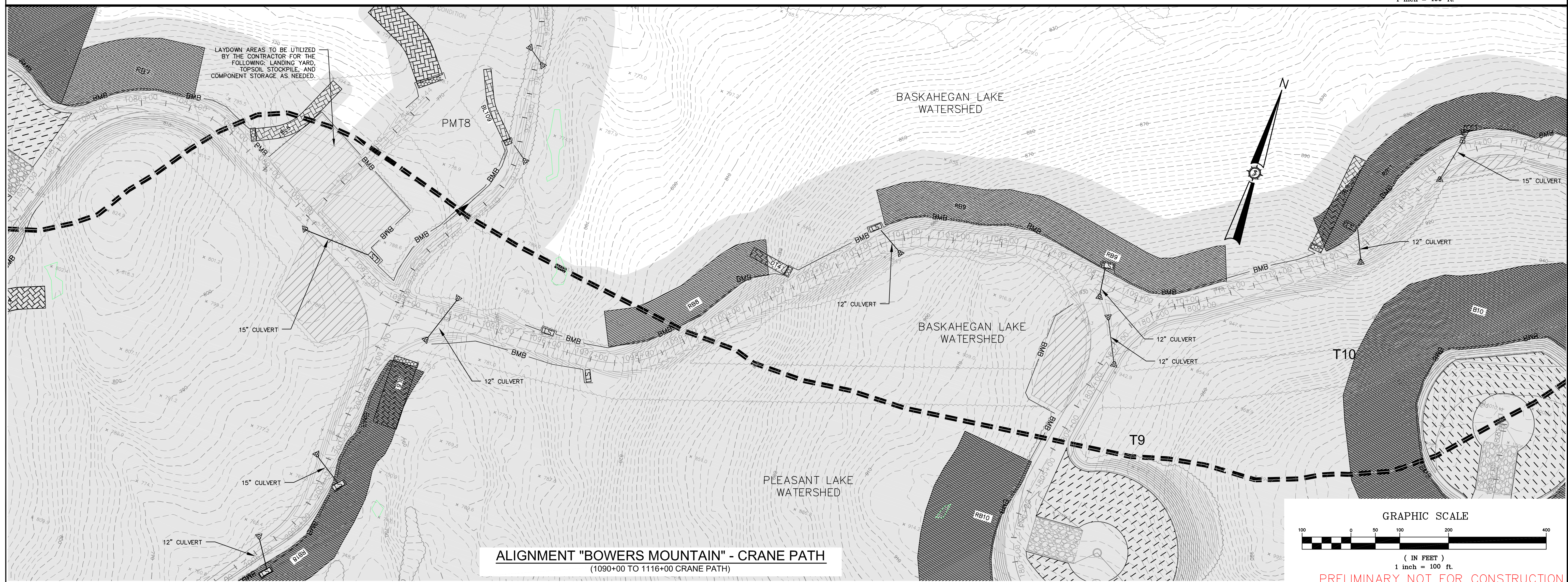
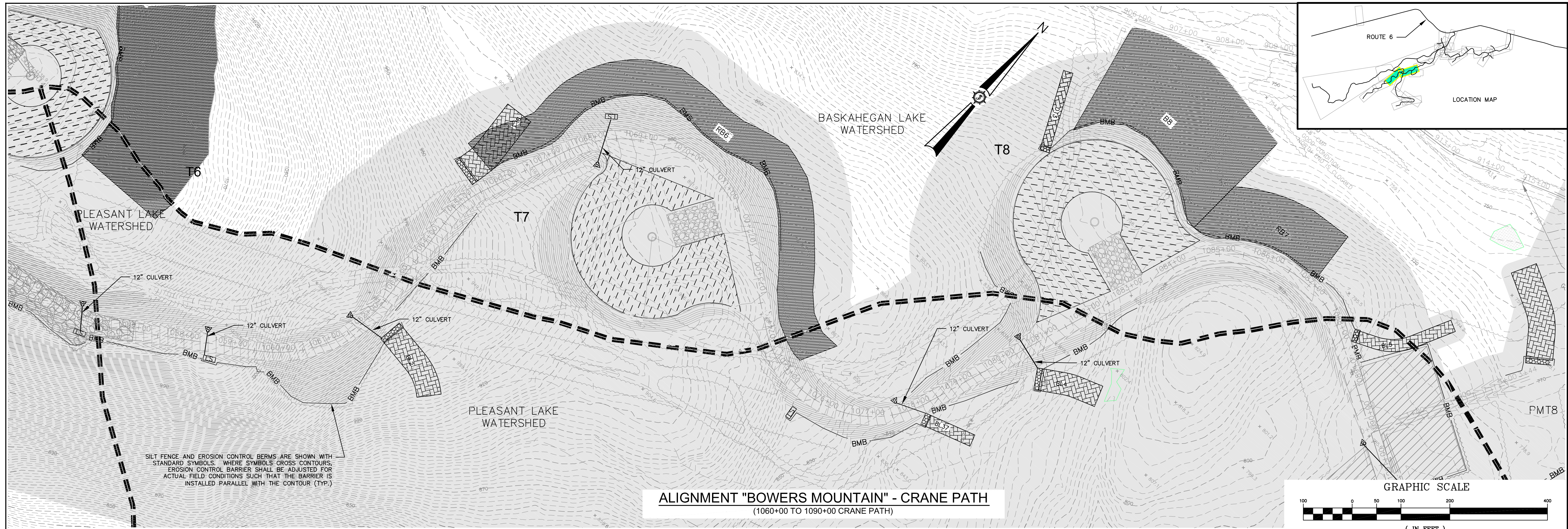

SILT FENCE AND EROSION CONTROL BERMS ARE SHOWN WITH STANDARD SYMBOLS. WHERE SYMBOLS CROSS CONTOURS, EROSION CONTROL BARRIER SHALL BE ADJUSTED FOR ACTUAL FIELD CONDITIONS SUCH THAT THE BARRIER IS INSTALLED PARALLEL WITH THE CONTOUR (TYP.)

LAYDOWN AREAS TO BE UTILIZED BY THE CONTRACTOR FOR THE FOLLOWING: LANDING YARD, TOPSOIL STOCKPILE, AND COMPONENT STORAGE AS NEEDED.

Date	3/7/2011
ISSUED FOR AGENCY REVIEW	JSM
REVISED PER AGENCY COMMENTS	5/12/11
Drawn By	JAO
Checked By	JAO
Scale	1"=100'
Project Location	CARROLL PLANTATION & KOSSUTH TOWNSHIP, MAINE
Project No.	72380E
Sheet No.	601

**BOWERS WIND PROJECT**

Project Location: CARROLL PLANTATION & KOSSUTH TOWNSHIP, MAINE

Project No.: 72380E

Sheet No.: 601

Scale: 1"=100'

Drawn By: JAO

Checked By: JAO

Approved By: [Signature]

Professional Seal: [Seal]

**BOWERS MOUNTAIN EROSION CONTROL PLAN**

72380E

on an integrated team of geospatial, engineering, surveying and NATURAL RESOURCE consultants

**SEWALL**

JAMES W. SEWALL COMPANY / Since 1880

SEWALL.COM 800.648.4202

PERMIT

601

PRELIMINARY NOT FOR CONSTRUCTION



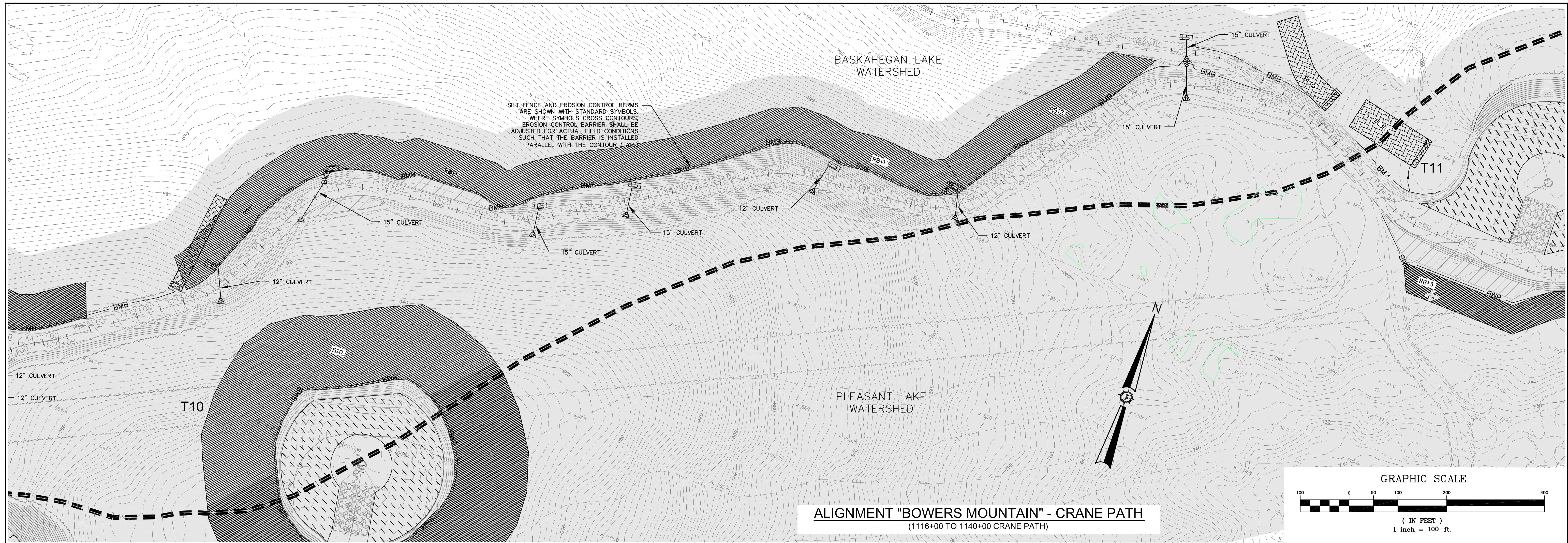

**ALIGNMENT "BOWERS MOUNTAIN" - CRANE PATH**  
(1116+00 TO 1140+00 CRANE PATH)

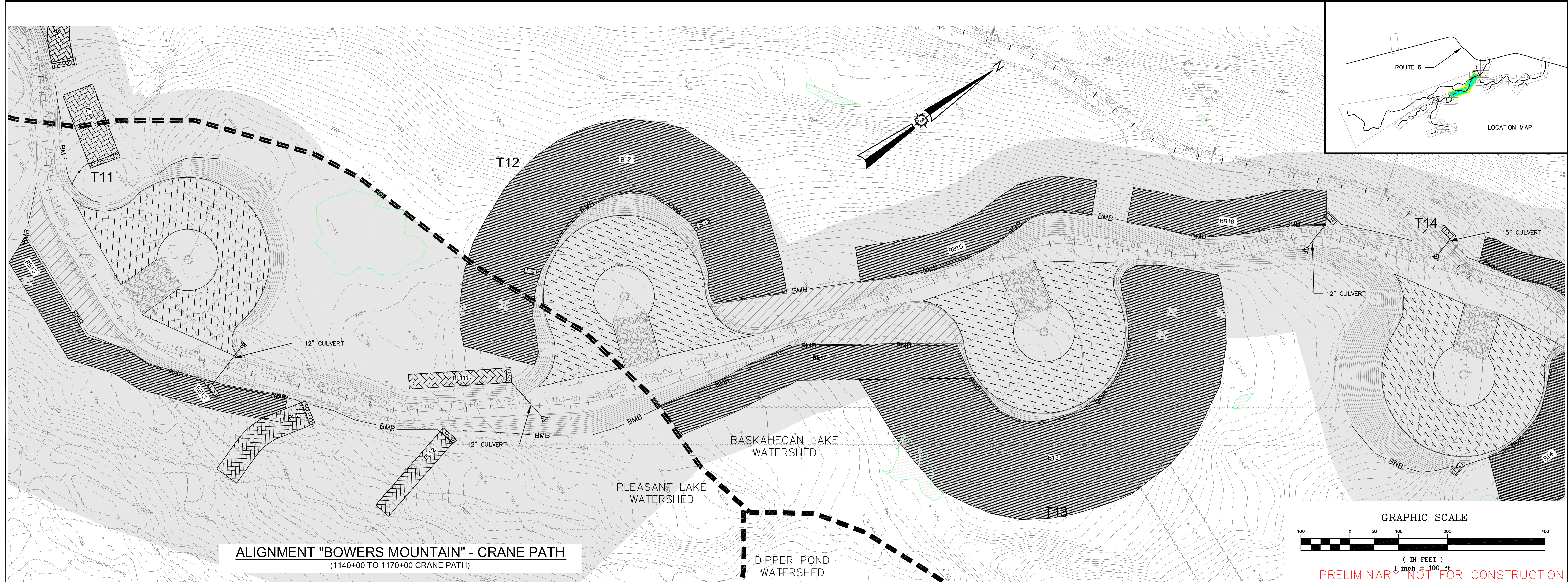
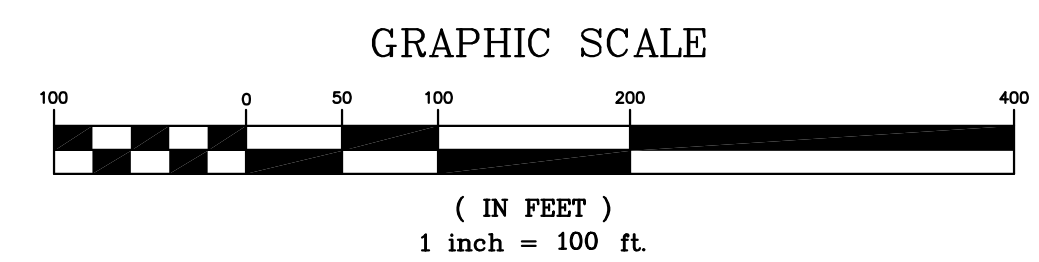

**ALIGNMENT "BOWERS MOUNTAIN" - CRANE PATH**  
(1140+00 TO 1170+00 CRANE PATH)

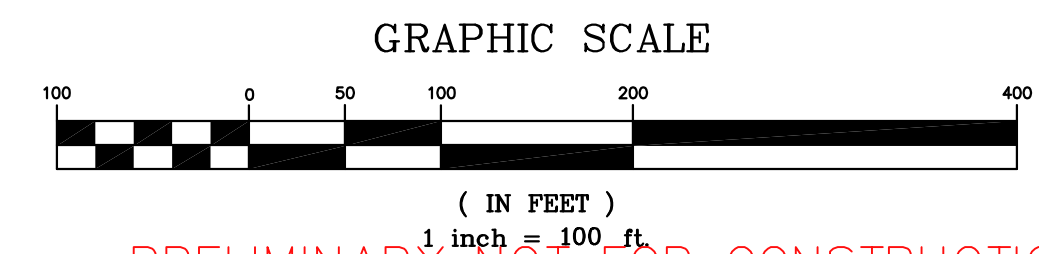

PRELIMINARY NOT FOR CONSTRUCTION

Drawn By	JAO
Checked	JAO
Issue Date	5/17/2011
Revision	5/12/11
Revised By	JAO
Revised Date	5/12/11

**BOWERS WIND PROJECT**

Developed By: JAO  
 Date: 05/23/2011  
 Scale: 1"=100'

Project Location: CARROLL PLANTATION & KOSSUTH TOWNSHIP, MAINE  
 Drawing Description: BOWERS MOUNTAIN EROSION CONTROL PLAN

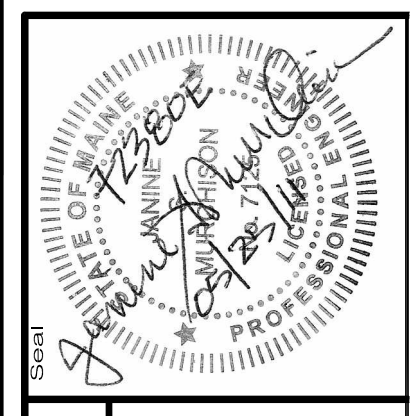

**72380E**

an integrated team of geospatial, engineering, surveying and NATURAL RESOURCE consultants

**SEWALL**  
 JAMES W. SEWALL COMPANY / Since 1880  
 SEWALL.COM 800.648.4202

Project No. 72380E  
 Permit No. 602  
 Sheet No. 602



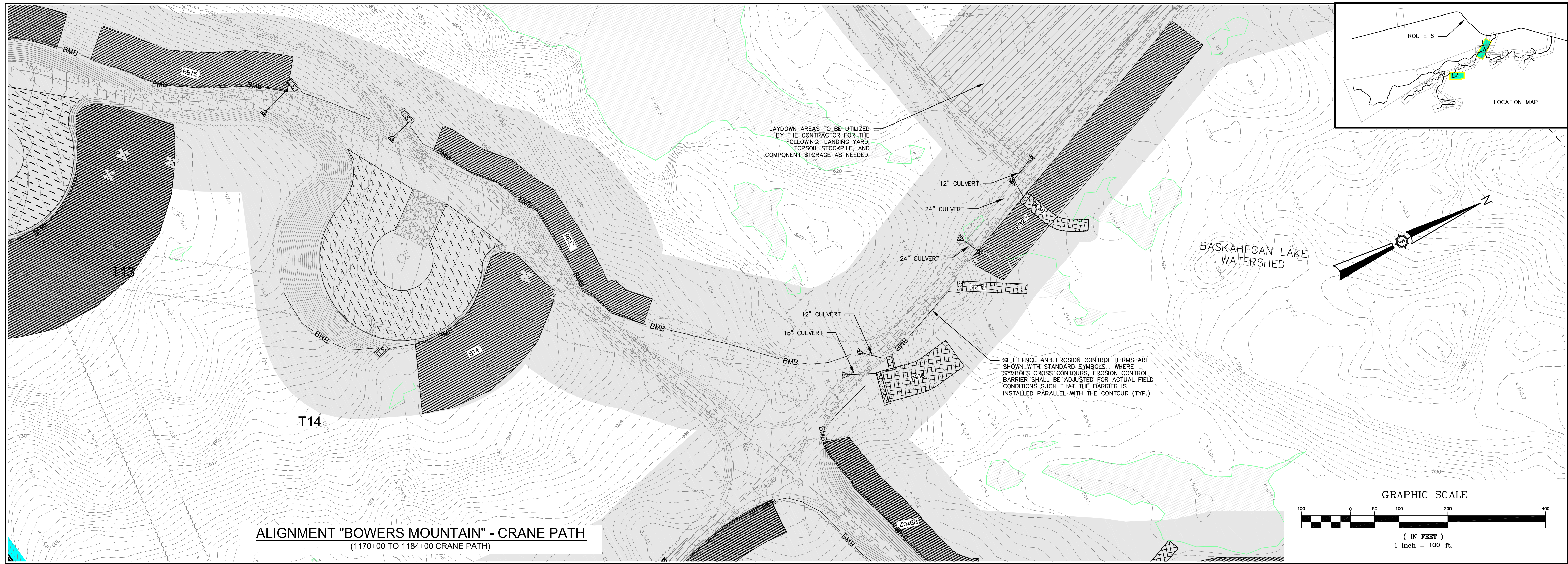

**ALIGNMENT "BOWERS MOUNTAIN" - CRANE PATH**  
 (1170+00 TO 1184+00 CRANE PATH)

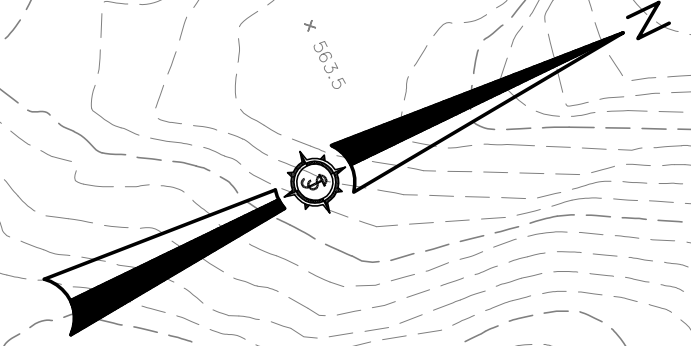
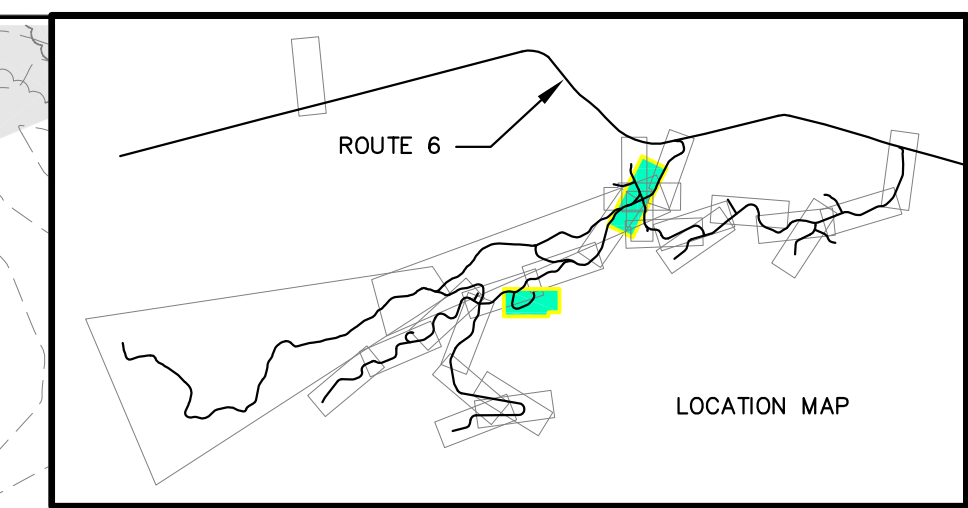
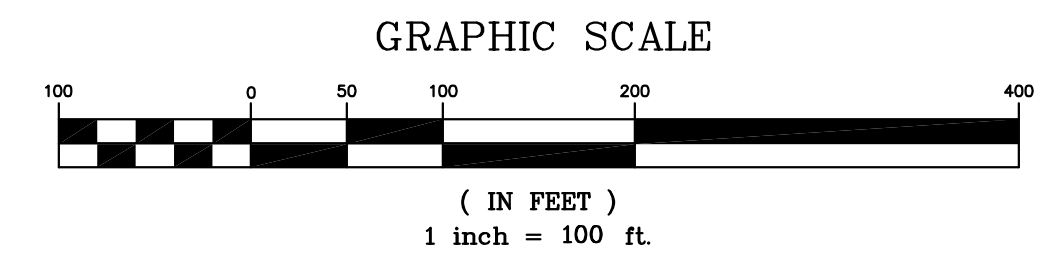

LAYDOWN AREAS TO BE UTILIZED BY THE CONTRACTOR FOR THE FOLLOWING: LANDING YARD, TOPSOIL STOCKPILE, AND COMPONENT STORAGE AS NEEDED.

SILT FENCE AND EROSION CONTROL BERMS ARE SHOWN WITH STANDARD SYMBOLS. WHERE SYMBOLS CROSS CONTOURS, EROSION CONTROL BARRIER SHALL BE ADJUSTED FOR ACTUAL FIELD CONDITIONS SUCH THAT THE BARRIER IS INSTALLED PARALLEL WITH THE CONTOUR (TYP.)

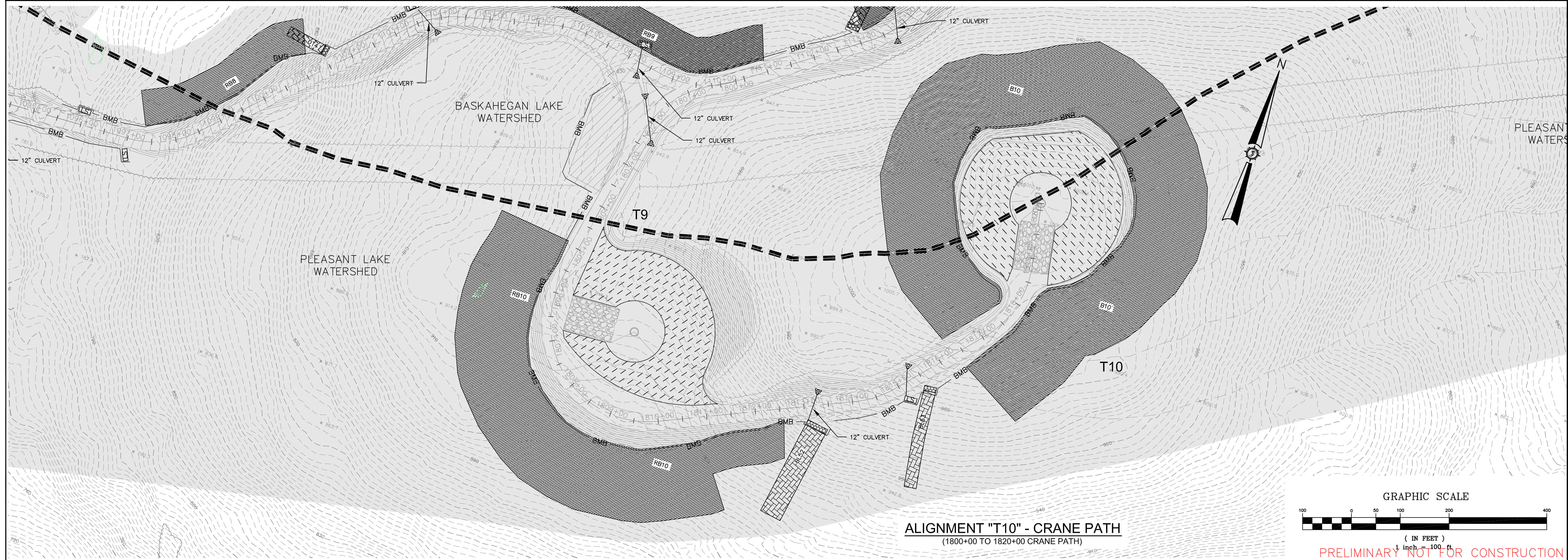

**ALIGNMENT "T10" - CRANE PATH**  
 (1800+00 TO 1820+00 CRANE PATH)

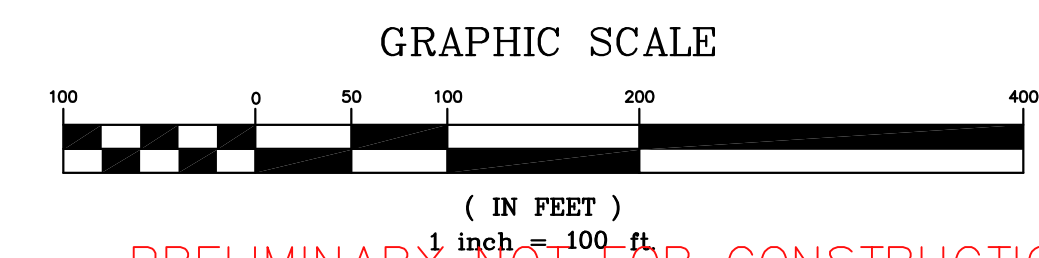

PRELIMINARY NOT FOR CONSTRUCTION

Drawn By	JAO
Checked For Agency Review	JSM
Issued	3/7/2011
Revised	5/12/11
Drawn By	
Checked For Agency Review	
Issued	
Revised	

Drawn By	JAO
Checked For Agency Review	JSM
Issued	05/23/2011
Revised	
Drawn By	
Checked For Agency Review	
Issued	
Revised	

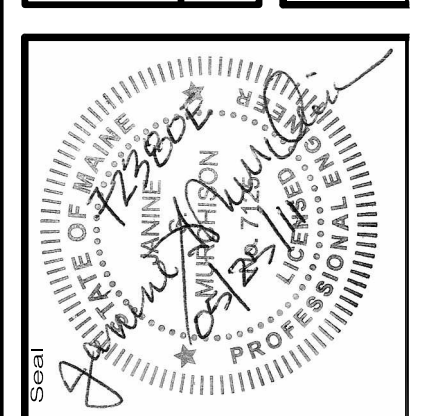

**72380E**

an integrated team of geospatial, engineering, surveying and NATURAL RESOURCE consultants

**SEWALL**  
 JAMES W. SEWALL COMPANY Since 1880  
 SEWALL.COM 800.648.4202

Project No. 72380E  
 Drawing Description: BOWERS MOUNTAIN EROSION CONTROL PLAN

Phase: PERMIT

Sheet No. **603**