

# STATE OF MAINE DEPARTMENT OF TRANSPORTATION

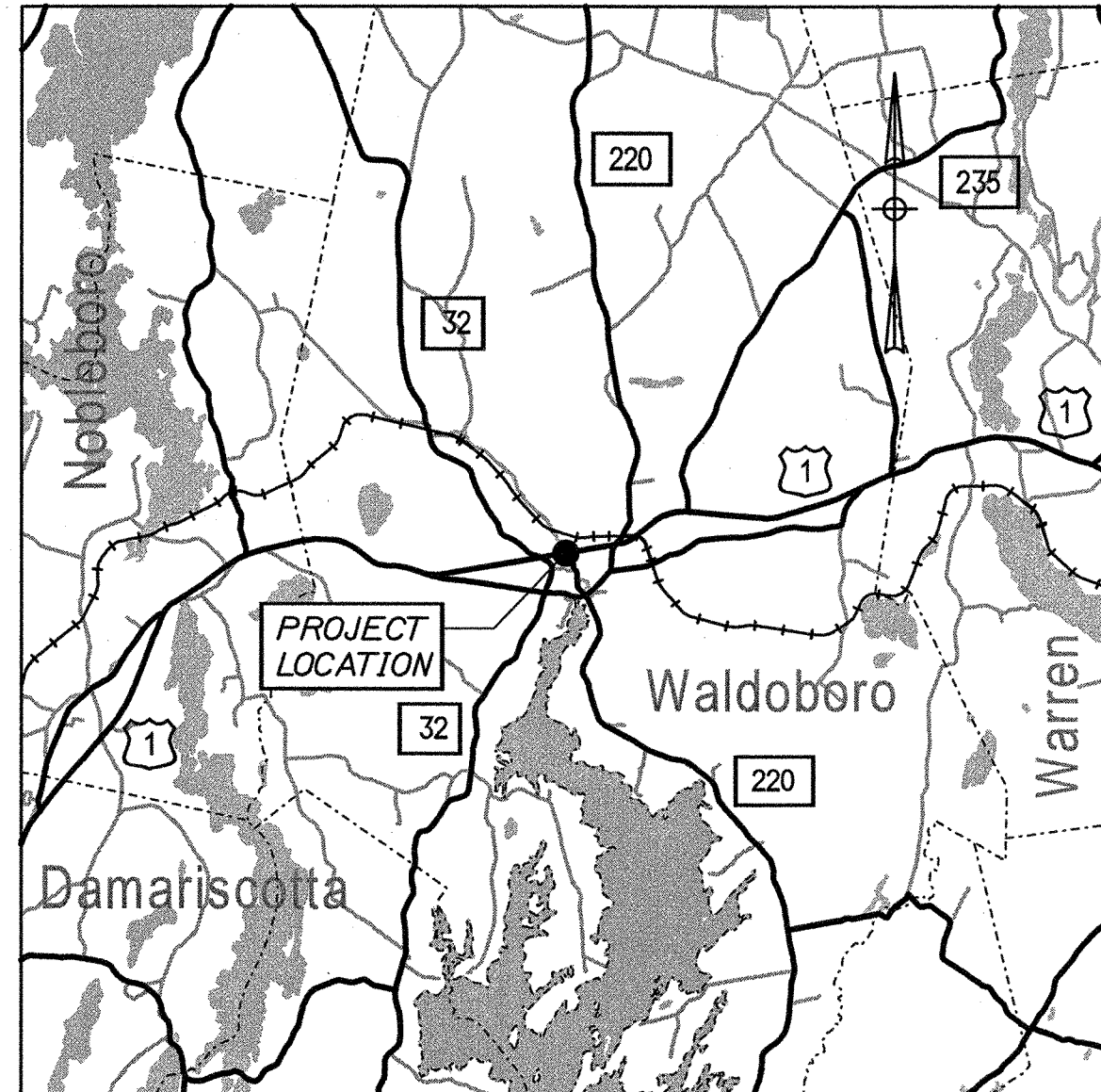

## WALDOBORO LINCOLN COUNTY US ROUTE 1 STP-1725(200)X

PROJECT LENGTH : 0.210 mi.  
A PAVEMENT, DRAINAGE, CURBING,  
STRIPING AND SIGNING PROJECT



**LOCATION MAP**  
"A PORTION OF LINCOLN COUNTY"  
Scale in Miles

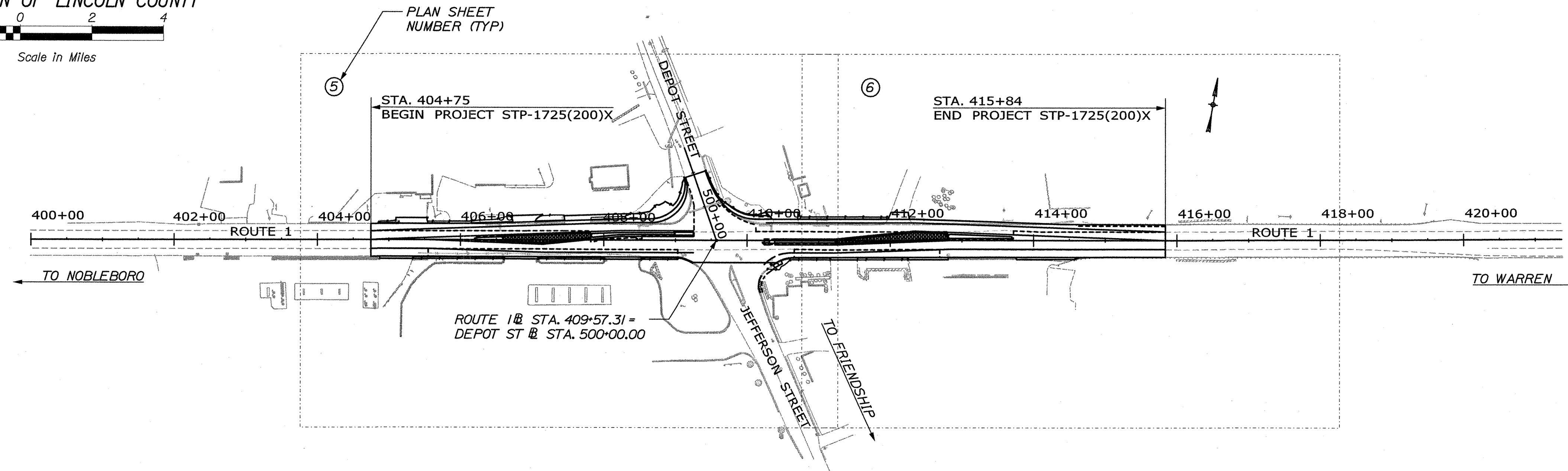
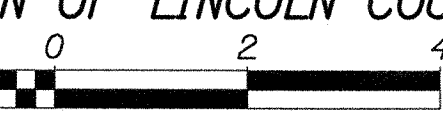

**LAYOUT SCALE**  
Scale in Feet

### INDEX OF SHEETS

Description	Sheet No.
Title Sheet.....	1
General Notes & Special Details.....	2
Typical Sections.....	3
General Plans.....	4-5
Striping & Signing Plans.....	6-7
Geometric Layout & Curbing Quantity Notes.....	8-9

### TRAFFIC DATA

	US ROUTE 1 WEST OF DEPOT ST/ JEFFERSON ST	US ROUTE 1 EAST OF DEPOT ST/ JEFFERSON ST
Current (2010) AADT	13250	12550
Future (2020) AADT	15240	14690
DHV - % of AADT	11%	11%
Design Hour Volume	1676	1616
% Heavy Trucks (AADT)	8%	8%
% Heavy Trucks (DHV)	7%	7%
Directional Distribution (DHV)	52%	51%
18 kip Equivalent P 2.0	642	629
18 kip Equivalent P 2.5	612	599
Design Speed (mph)	40	40

STATE OF MAINE  
DEPARTMENT OF TRANSPORTATION

APPROVED: *[Signature]* DATE: 7/1/10  
COMMISSIONER: *[Signature]*  
CHIEF ENGINEER: *[Signature]* 4/28/10

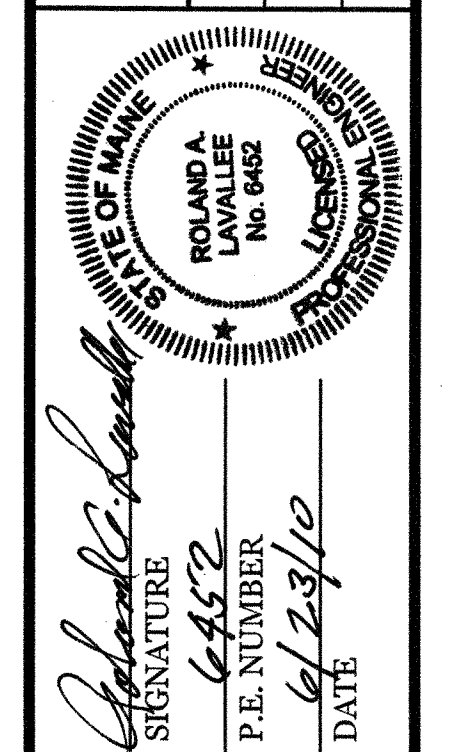

PROJECT INFORMATION	
PROGRAM	TRAFFIC ENGINEERING
PROJECT MANAGER	JIM MANGIR
DESIGNER	BRUCE WINGER
CONSULTANT	HNTB
PROJECT RESIDENT	
CONTRACTOR	
PROJECT COMPLETION DATE	

WALDOBORO  
US ROUTE 1  
TITLE SHEET

SHEET NUMBER  
**1**  
OF 9

Date: 6/22/2010

Username: mcundiff

Division: HIGHWAY

Filename: 001\_Title.dgn

STP-1725(200)X PIN 17252.00

GENERAL

1. A COPY OF THE SUBSURFACE DATA REPORT FOR THIS PROJECT IS AVAILABLE BY CONTACTING THE PROJECT MANAGER, JAMES MANSIR AT 207-624-3612.
2. THE CONTRACTOR WILL BE RESPONSIBLE FOR MAINTAINING ALL EXISTING MAILBOXES TO ENSURE THAT THE MAIL WILL BE DELIVERABLE. NO SEPARATE PAYMENT WILL BE MADE FOR THIS WORK; IT SHALL BE CONSIDERED INCIDENTAL TO THE CONTRACT.
3. ACRYLIC LATEX COLOR FINISH GREEN (ITEM 658.20) SHALL BE PLACED ON ALL PAVED ISLANDS.
4. ALL CLEARING SHALL BE CONSIDERED INCIDENTAL TO THE CONTRACT AND NO SEPARATE PAYMENT WILL BE MADE. THE ACTUAL LINES FOR CLEARING SHALL BE ESTABLISHED IN THE FIELD BY THE RESIDENT.
5. NO SEPARATE PAYMENT FOR SUPERINTENDENT OR FOREMAN SHALL BE MADE FOR THE SUPERVISION OF EQUIPMENT BEING PAID FOR UNDER THE EQUIPMENT RENTAL ITEMS.

UTILITY

1. THE UTILITIES INVOLVED IN THIS CONTRACT ARE:  
 CENTRAL MAINE POWER CO.  
 AQUA MAINE  
 FAIRPOINT COMMUNICATIONS  
 TIME WARNER CABLE  
 WALDOBORO UTILITY DISTRICT
2. ALL UTILITY FACILITIES SHALL BE ADJUSTED THE RESPECTIVE UTILITIES UNLESS OTHERWISE NOTED OR PLANNED.

EARTHWORK AND PAVEMENT

1. WHERE OVERLAY PAVEMENT MATCHES EXISTING ROADWAY PAVEMENT, A PAVEMENT BUTT JOINT SHALL BE USED. PAYMENT SHALL BE MADE UNDER ITEM 202.203 PAVEMENT BUTT JOINT.
2. DRIVEWAY FILL SIDE SLOPES SHALL BE THE SAME AS THE NON-GUARDRAIL FILL SLOPES UNLESS OTHERWISE NOTED ON THE PLANS
3. CONSTRUCT BUTT JOINTS AT ALL PAVED DRIVES AND ENTRANCES.
4. ALL WASTE MATERIAL NOT USED ON THE PROJECT SHALL BE DISPOSED OF OFF THE PROJECT IN WASTE AREAS APPROVED BY THE RESIDENT.
5. BACKING UP BITUMINOUS CURB IS INCIDENTAL TO THE CURB ITEMS. IN AREAS WHERE NEW BITUMINOUS CURB IS DESIGNATED TO REPLACE EXISTING, THE REMOVAL OF THE OLD BITUMINOUS CURB SHALL BE INCIDENTAL TO THE NEW CURB.
6. A 3' PAVED LIP SHALL BE PLACED AT ALL GRAVEL ENTRANCES UNLESS OTHERWISE NOTED IN THE PLANS OR DIRECTED BY THE RESIDENT.
7. ENTRANCES SHALL BE CONSTRUCTED WITH:  
 RESIDENTIAL PAVED:  
 2" HOT MIX ASPHALT, GRADING 9.5 MM  
 12" AGGREGATE SUBBASE COURSE - GRAVEL  
 COMMERCIAL PAVED:  
 3" HOT MIX ASPHALT, GRADING 9.5 MM  
 1" AGGREGATE SUBBASE COURSE - GRAVEL  
 GRAVEL:  
 1 1/2" AGGREGATE SUBBASE COURSE - GRAVEL
8. ANY NECESSARY CLEANING OF EXISTING PAVEMENT PRIOR TO PAVING SHALL BE INCIDENTAL TO THE RELATED PAVING ITEMS.
9. WHERE PROPOSED PAVEMENT JOINS EXISTING PAVEMENT, THE EXISTING PAVEMENT SHALL BE SAW CUT ALONG A SMOOTH LINE TO A NEAT, EVEN, VERTICAL JOINT, AS DIRECTED BY THE RESIDENT. BROKEN OR RAVELLED EDGES SHALL NOT BE PERMITTED. ALL WORK NECESSARY FOR THE PREPARATION OF THE JOINT SHALL BE CONSIDERED INCIDENTAL TO THE RELATED CONTRACT ITEMS.
10. THE CONTRACTOR SHALL INSTALL CURB RAMP DETECTABLE WARNING FIELDS ON THE PROPOSED PEDESTRIAN RAMPS FOR THE CROSS WALK IN ACCORDANCE WITH THE SPECIAL PROVISION 608 DETECTABLE WARNINGS. COORDINATE WORK WITH RESIDENT.

EROSION CONTROL

1. ALL WORK SHALL BE DONE IN ACCORDANCE WITH THE MAINE DEPARTMENT OF TRANSPORTATION'S BEST MANAGEMENT PRACTICES FOR EROSION CONTROL & SEDIMENT CONTROL, FEBRUARY, 2008.
2. LOAM SHALL BE PLACED TO A NOMINAL DEPTH OF 4 INCHES IN LAWN AREAS AND 2 INCHES IN ALL OTHER AREAS UNLESS OTHERWISE NOTED OR DIRECTED.
3. LOAM HAS BEEN ESTIMATED FOR 100% OF THE DISTURBED SLOPE AREAS. ACTUAL PLACEMENT OF THE LOAM SHALL BE AS DESIGNATED BY THE RESIDENT.
4. UNLESS OTHERWISE NOTED SEEDING METHOD NO. 1 SHALL BE UTILIZED ON ALL LAWNS AND DEVELOPED AREAS.

DRAINAGE

1. IF FOUNDATION MATERIAL IS REQUIRED UNDER CULVERTS, IT SHALL MEET THE REQUIREMENTS FOR GRANULAR BORROW - UNDERWATER BACKFILL AND WILL PAID FOR AS GRANULAR BORROW.
2. THE CULVERT SIZES SHOWN ON THE PLANS ARE FOR SMOOTH LINED PIPES.
3. ANY NECESSARY CUTTING OF EXISTING PIPES TO FIT IN AREAS OF PROPOSED CATCH BASINS WILL NOT BE PAID FOR SEPARATELY AND WILL BE CONSIDERED INCIDENTAL TO ITEM 604.
4. ANY NECESSARY CUTTING OF EXISTING CATCH BASINS TO ALLOW FOR PROPOSED PIPE CONNECTIONS WILL NOT BE PAID FOR SEPARATELY AND WILL BE CONSIDERED INCIDENTAL TO ITEM 603.
5. ALL WORK NECESSARY TO CONNECT TO EXISTING PIPES AND DRAINAGE STRUCTURES SHALL BE INCIDENTAL TO THE 603 ITEM(S)
6. CATCH BASIN AND RIM ELEVATIONS NOTED ON THE PLANS ARE THE TOP OF GRATE ELEVATIONS AT THE CENTER OF GRATE. CATCH BASIN OFFSET LOCATIONS ARE MEASURED TO THE CENTER OF THE GRATE.
7. EXISTING CULVERTS TO REMAIN SHALL BE CLEANED AS DIRECTED BY THE RESIDENT. PAYMENT WILL BE MADE UNDER ITEM 631.32 CULVERT CLEANER (INCLUDING OPERATOR).
8. NO EXISTING DRAINAGE SHALL BE ABANDONED, REMOVED OR PLUGGED WITHOUT PRIOR APPROVAL OF THE RESIDENT.
9. INLETS AND OUTLETS OF ALL CULVERTS SHALL BE REPRAPPED UNLESS OTHERWISE NOTED ON THE PLANS OR DIRECTED BY THE RESIDENT.
10. PAYMENT FOR FLAT TOP DRAINAGE STRUCTURES SHALL BE INCIDENTAL TO ITEM 604.09 CATCH BASINS TYPE BI-C AND ITEM 604.16 ALTERING CATCH BASIN TO MANHOLE.

STATE OF MAINE  
 DEPARTMENT OF TRANSPORTATION  
 STP-1725(200)X  
 PIN 17252.00  
 HIGHWAY PLANS

DATE	BY	PROJ. MANAGER	JIM MANSIR	DATE	SIGNATURE
06/10	LEM	DESIGN-DETAILED		06/10	
06/10		CHECKED-REVIEWED			
		DESIGN-DETAILED			
		DESIGN-DETAILED			
		REVISIONS 1			
		REVISIONS 2			
		REVISIONS 3			
		FIELD CHANGES			

WALDOBORO  
 US ROUTE 1  
 GENERAL NOTES



Date: 6/24/2010

Username: lmeek

Filename: ...622-WALDOBORO\CAD\003\_TYP.dgn Division: HIGHWAY

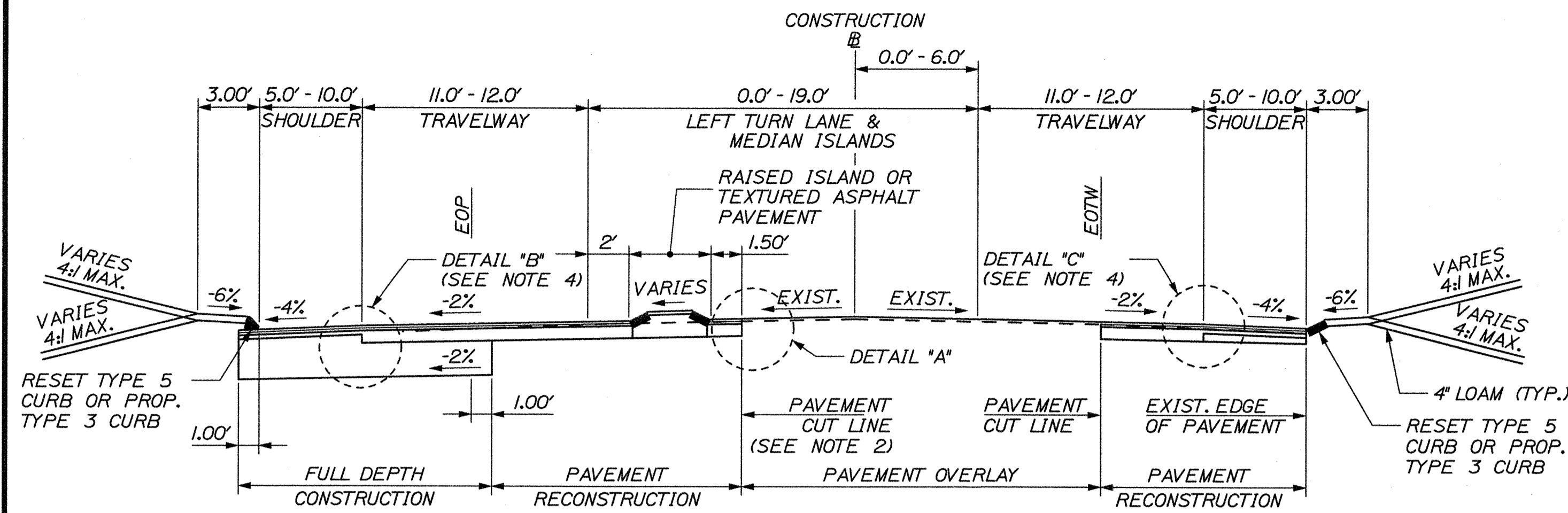

**WIDEN TRAVELWAY & SHOULDER**

STA. 406+30.8 TO 414+39.9 LT

**ROUTE 1 TYPICAL SECTION**

**RECONSTRUCT SHOULDER**

STA 404+75.0 TO 406+30.8 LT  
 STA 414+39.9 TO 414+60.0 LT  
 STA 405+55.0 TO 409+03.5 RT  
 STA 410+66.0 TO 412+69.2 RT

SEE DETAILS & GEOMETRIC PLANS FOR LIMITS OF RAISED AND CONCRETE MEDIAN ISLANDS

EOTW = EDGE OF EXISTING TRAVELWAY  
 EOP = EDGE OF EXISTING PAVEMENT

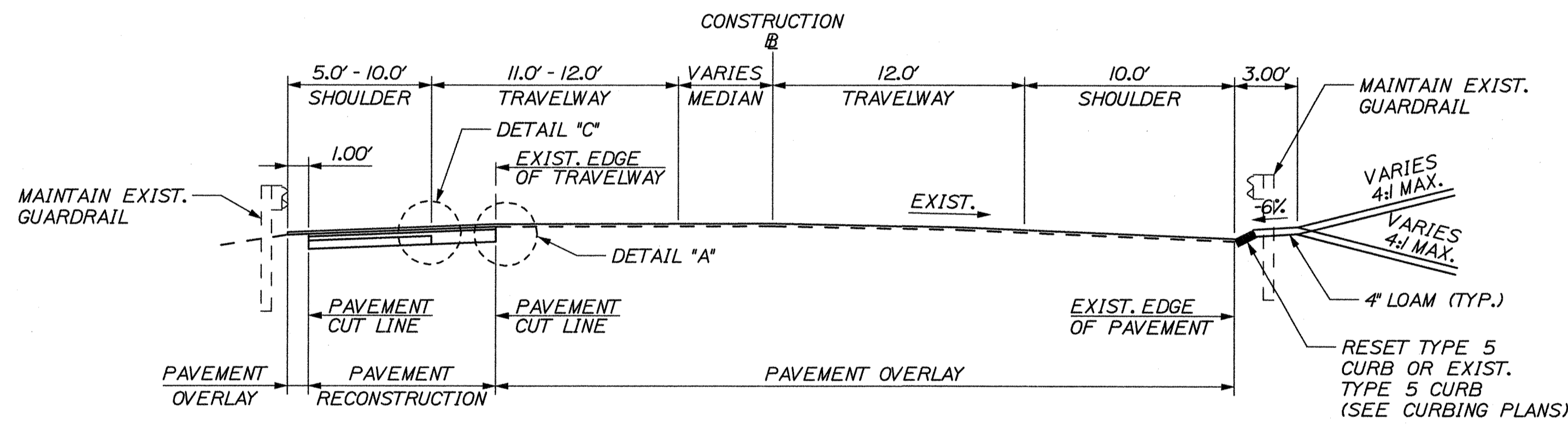
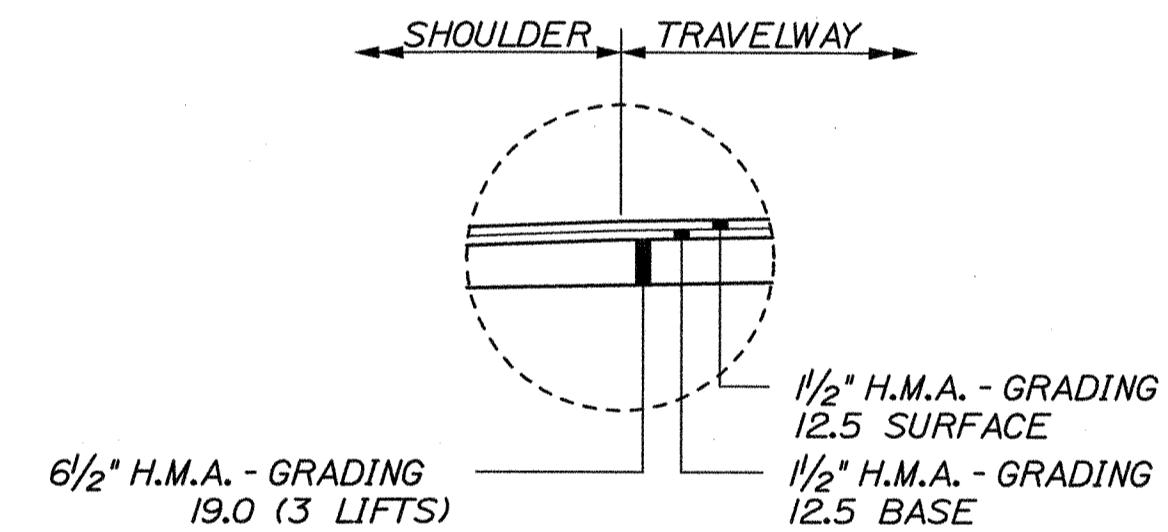
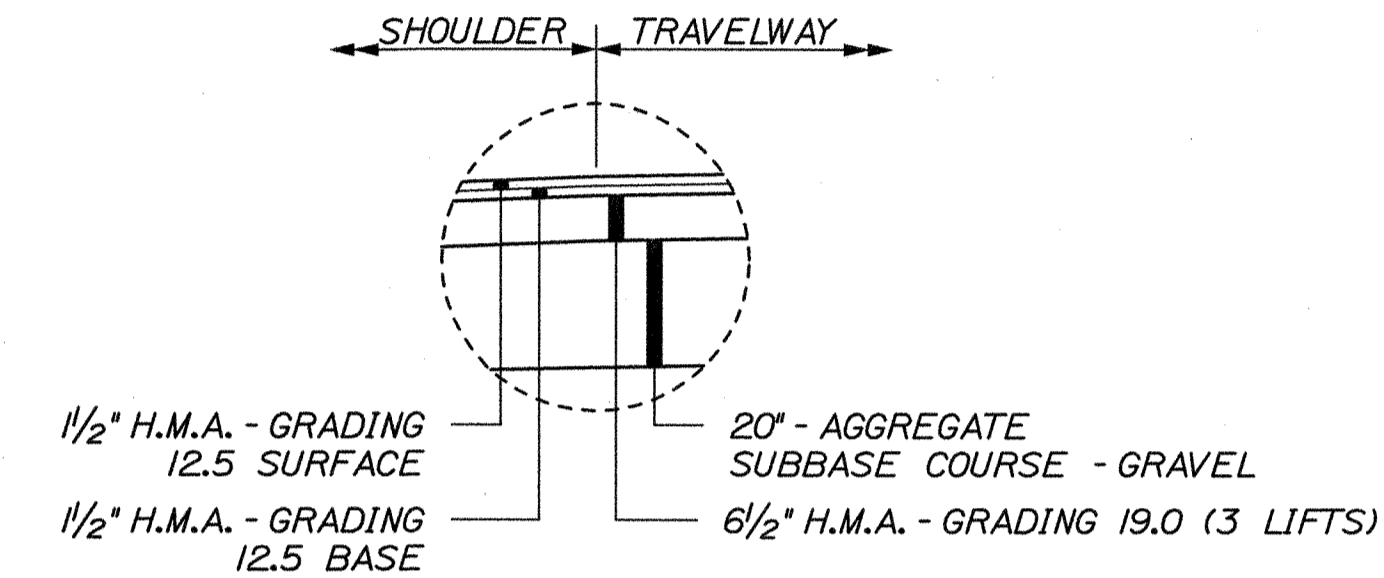
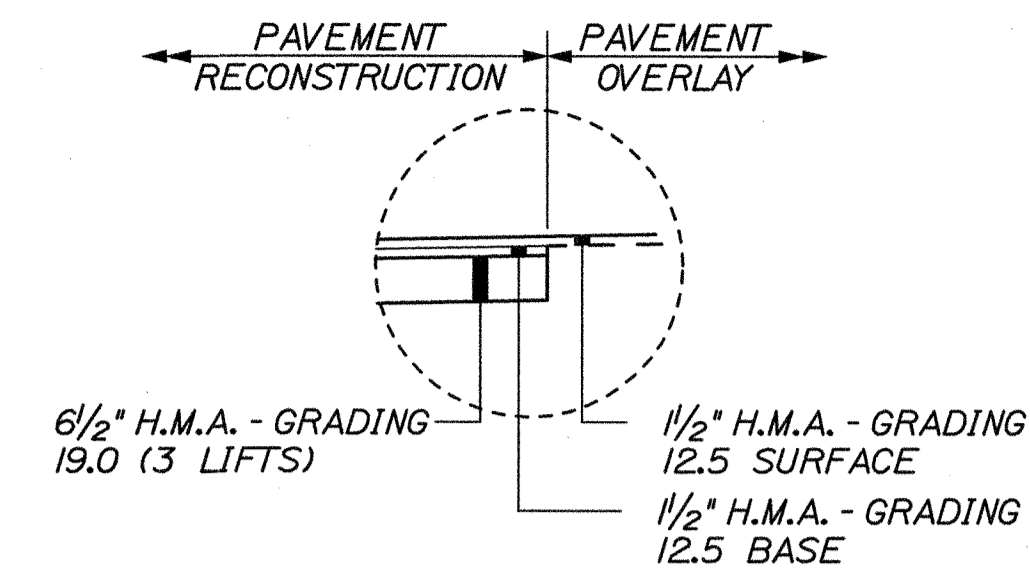

**RECONSTRUCT SHOULDER WITH GUARDRAIL**

STA 414+60.0 TO 415+84.0 LT

**ROUTE 1 TYPICAL SECTION**

**OVERLAY SHOULDER**

STA 404+75.0 TO 405+55.0 RT  
 STA 409+03.5 TO 410+66.0 RT  
 STA 412+69.23 TO 415+84.0 RT

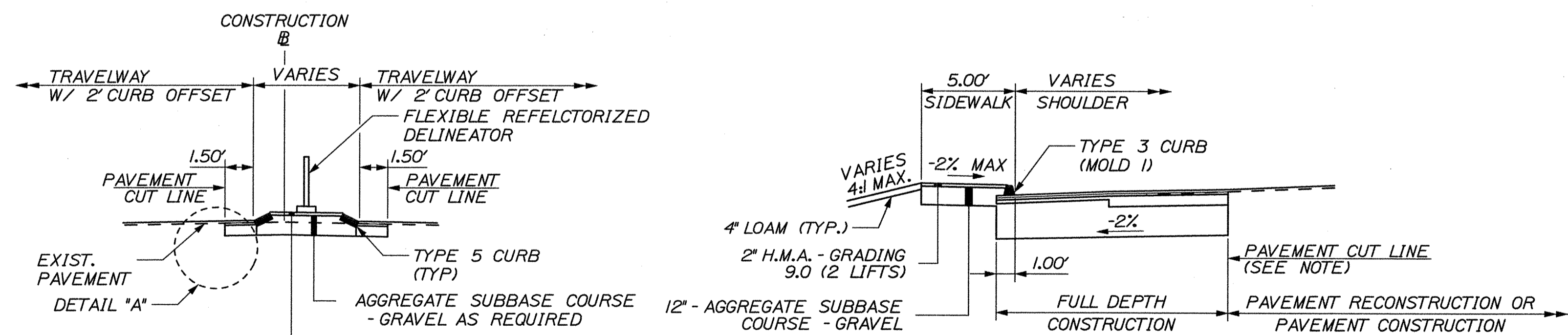

**NOTES:**

1. THE PAVEMENT DEPTHS AS SHOWN ON THE TYPICAL SECTIONS ARE INTENDED TO BE NOMINAL.
2. FOR PAVEMENT RECONSTRUCTION, PAVEMENT CUT LINE WILL BE EITHER AT THE EXISTING EDGE OF TRAVELWAY OR 1.5' FROM EDGE OF RAISED OR CONCRETE MEDIAN ISLAND.
3. THE LEFT SHOULDER FROM DEPOT ST. INTERSECTION TO STA. 410+75 SHALL BE 2% AND TRANSITION TO 4% AT STA. 411+25.

NOTE: THE PAVEMENT CUT LINE SHALL BE AT THE EXISTING EDGE OF TRAVELWAY OR AT A 1' OFFSET FROM EDGE OF PAVEMENT. SEE GENERAL PLANS FOR LAYOUT.

NOT TO SCALE

WALDOBORO  
 US ROUTE 1

TYPICAL SECTIONS

SHEET NUMBER

3

OF 9

STATE OF MAINE  
 DEPARTMENT OF TRANSPORTATION  
 STP-1725(200)X

SIGNATURE  
 P.E. NUMBER  
 DATE

PROJ. MANAGER	JIM MANSIR	DATE
DESIGN-DETAILED	RBM	06/10
CHECKED-REVIEWED	DMC	-
DESIGN-DETAILED2	-	-
DESIGN-DETAILED3	-	-
REVISIONS 1	-	-
REVISIONS 2	-	-
REVISIONS 3	-	-
REVISIONS 4	-	-
FIELD CHANGES	-	-

HIGHWAY PLANS  
 PIN  
 17252.00

Date: 7/13/2010

Username: chavu

Division: HIGHWAY

Filename: 004\_HDPLAN.dgn

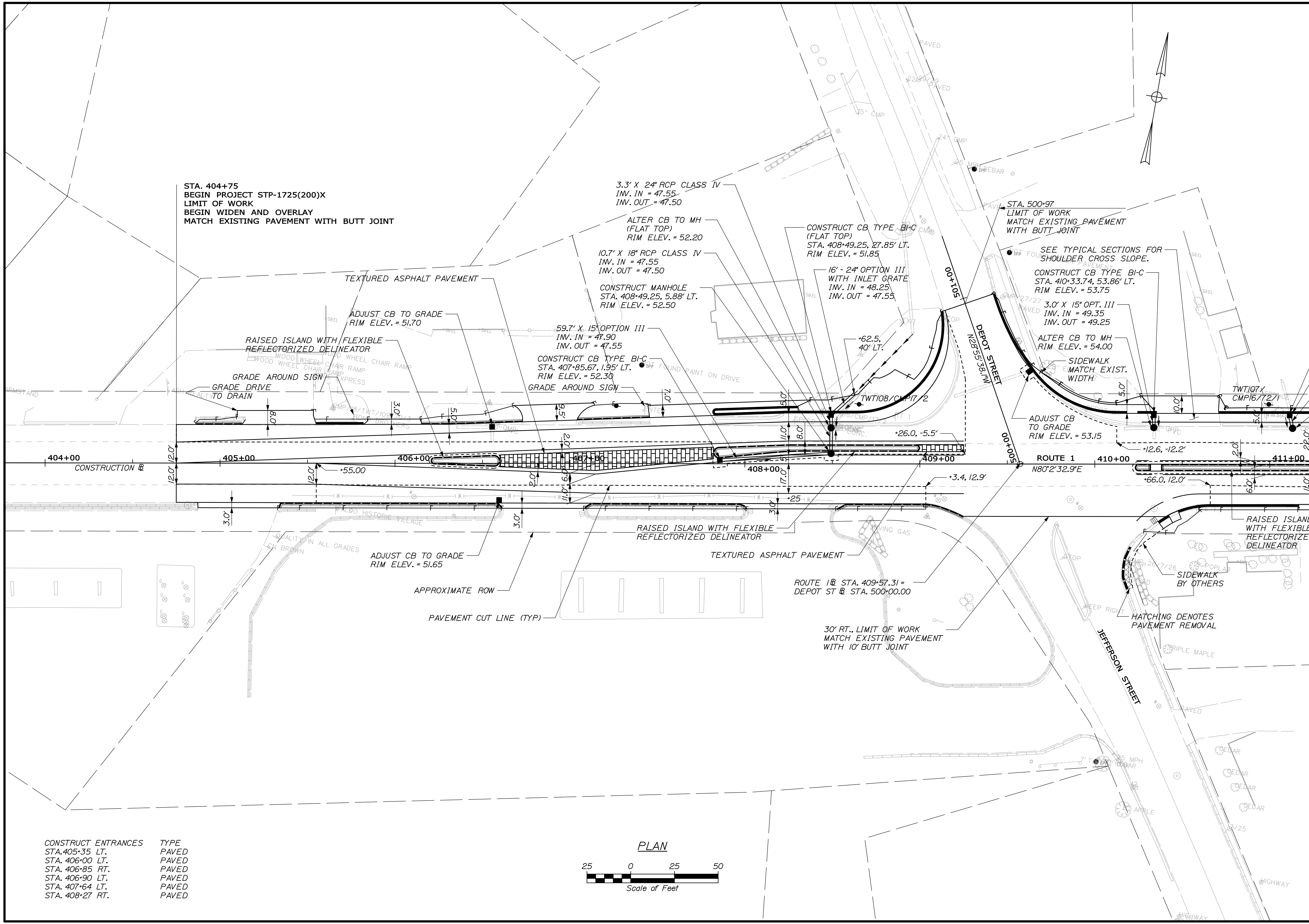

CONSTRUCT ENTRANCES	TYPE
STA. 405+35 LT.	PAVED
STA. 406+00 LT.	PAVED
STA. 406+85 RT.	PAVED
STA. 406+90 LT.	PAVED
STA. 407+64 LT.	PAVED
STA. 408+27 RT.	PAVED

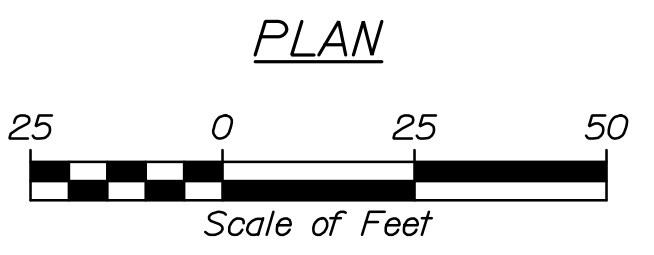

<b>STATE OF MAINE</b>	
<b>DEPARTMENT OF TRANSPORTATION</b>	
<b>STP-1725(200)X</b>	
PIN 17252.00 HIGHWAY PLANS	
<b>WALDOBORO US ROUTE 1</b>	<b>GENERAL PLAN</b>
SHEET NUMBER	
<b>4</b>	
OF 9	

Date: 7/13/2010

Username: chavu

Division: HIGHWAY

Filename: 005\_HDPLAN.dgn

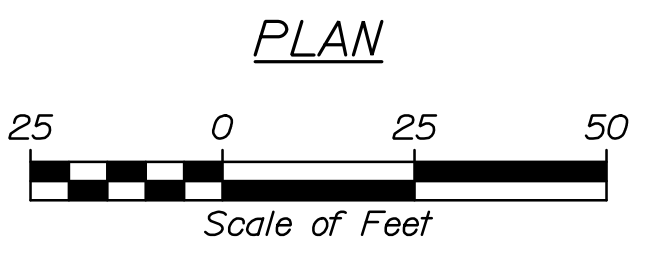
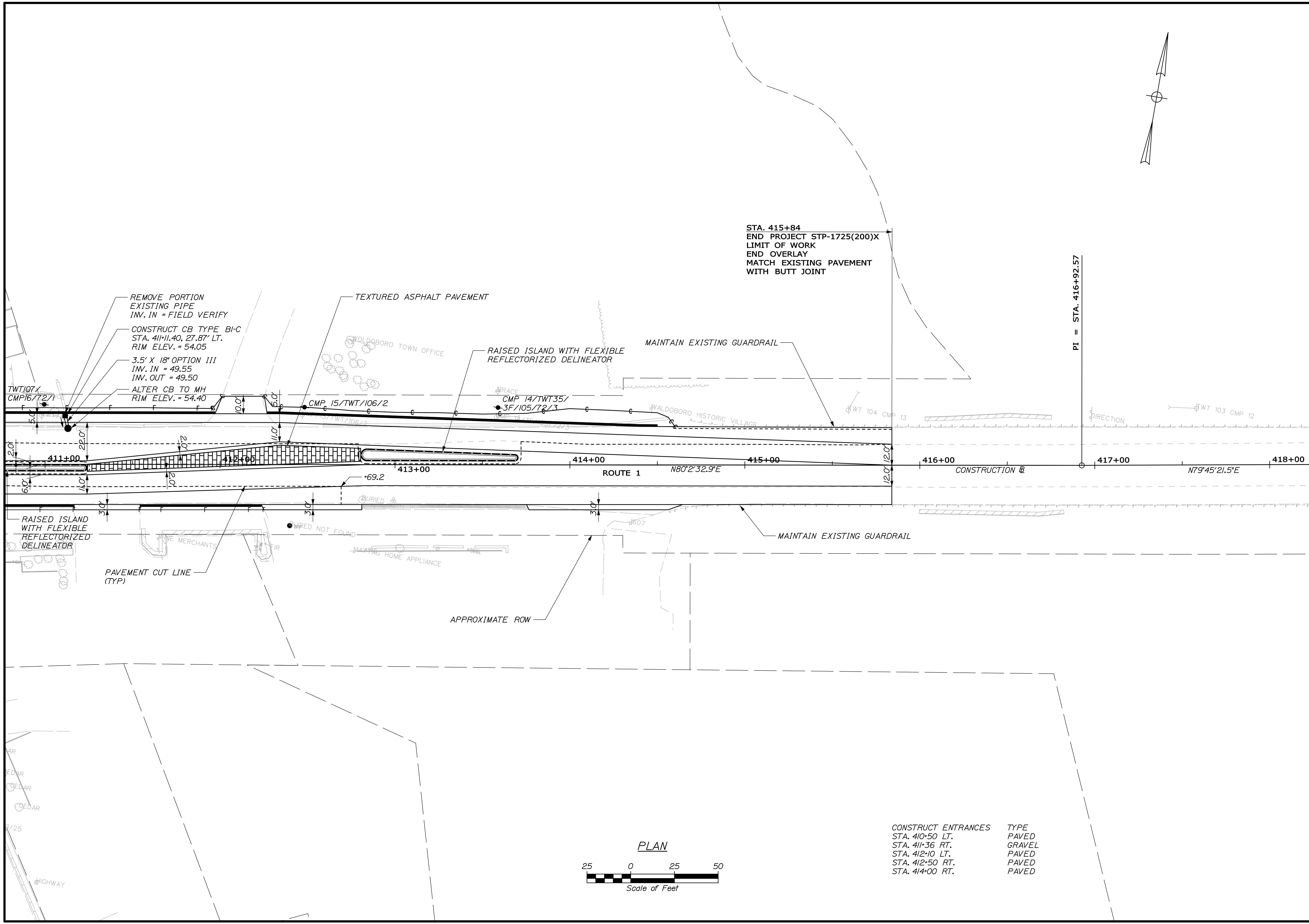

CONSTRUCT ENTRANCES

STA. 410+50 LT. TYPE PAVED

STA. 411+36 RT. GRAVEL

STA. 412+10 LT. PAVED

STA. 412+50 RT. PAVED

STA. 414+00 RT. PAVED

STATE OF MAINE		DEPARTMENT OF TRANSPORTATION	
STP-1725(200)X		PIN 17252.00	
HIGHWAY PLANS			
PROJ. MANAGER	JIM MANSIR	BY	LEM
DESIGN-DETAILED	IRB	DATE	06/10
CHECKED-REVIEWED	DJE	DATE	06/10
DESIGN-DETAILED	-	SIGNATURE	-
REVISIONS 1	-	P.E. NUMBER	-
REVISIONS 2	-	DATE	-
REVISIONS 3	-		
REVISIONS 4	-		
FIELD CHANGES	-		

WALDOBORO  
US ROUTE 1  
GENERAL PLAN

SHEET NUMBER

5

OF 9



Date: 6/24/2010

Username: imeek

Division: HIGHWAY

Filename: ...CAD\006\_SSPLAN.dgn

**NOTES:**

1. ALL WORK TO CONFORM TO MAINE DEPARTMENT OF TRANSPORTATION STANDARD SPECIFICATIONS FOR HIGHWAYS AND BRIDGES
2. ALL PROPOSED WORK SHALL BE IN ACCORDANCE WITH THE "MANUAL ON UNIFORM TRAFFIC CONTROL DEVICES FOR STREETS AND HIGHWAYS". U.S.D.O.T., F.H.W.A. 2003 EDITION.
3. EXACT LOCATIONS OF PROPOSED AND RESET SIGNS SHALL BE DETERMINED BY THE RESIDENT.
4. SIGN R2-1 (35 MPH) SHALL BE PLACED 1300' IN ADVANCE OF THE INTERSECTION FOR BOTH NB & SB ROUTE 1 APPROACHES. ALL CONFLICTING SPEED SIGNS SHALL BE REMOVED. SIGN R2-1 (40 MPH) SHALL BE INSTALLED FOR OPPOSING TRAFFIC OPPOSITE THE 35 MPH SIGNS.
5. FLEXIBLE REFLECTORIZED DELINEATORS SHALL BE INSTALLED AT 10' SPACING ALONG CENTER OF RAISED ISLANDS.

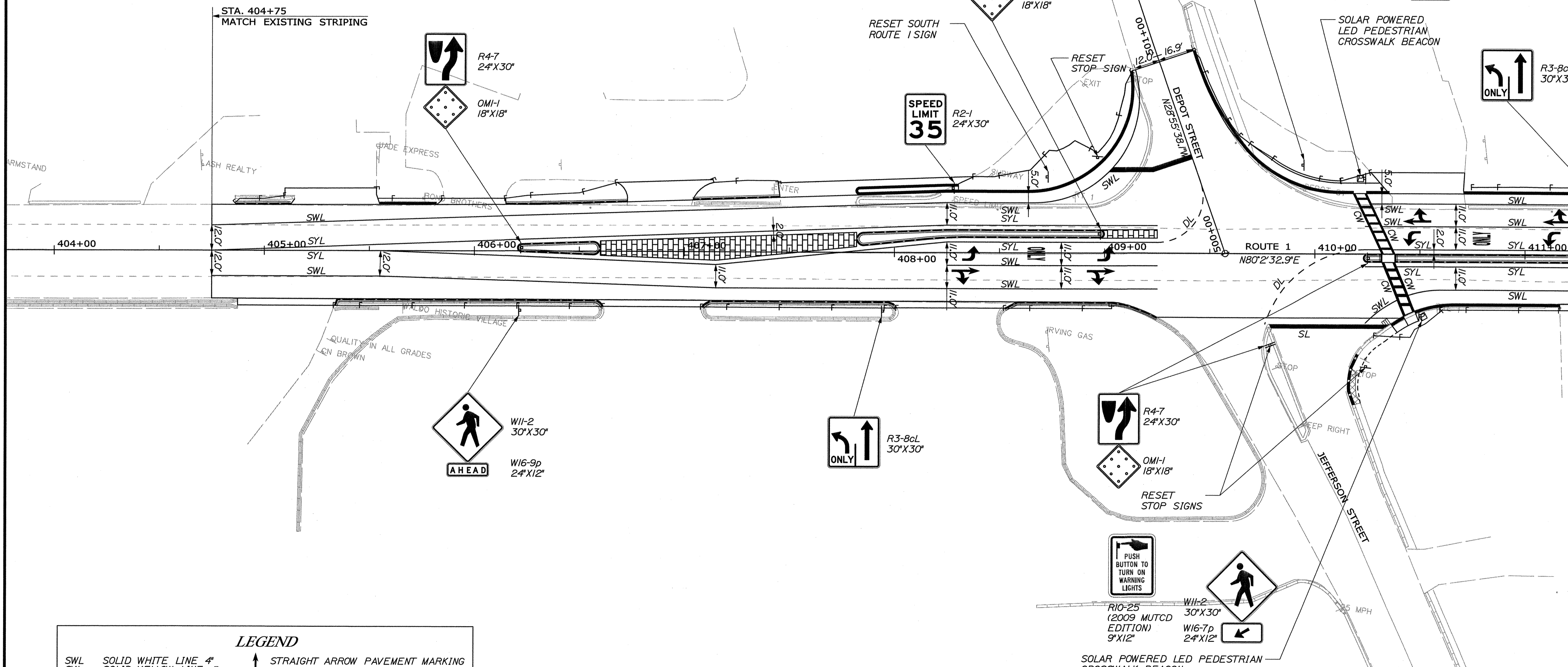

**LEGEND**

SWL	SOLID WHITE LINE 4"	↑	STRAIGHT ARROW PAVEMENT MARKING
SYL	SOLID YELLOW LINE 4"	↶	LEFT ARROW PAVEMENT MARKING
BWL	BROKEN WHITE LINE 4"	↷	RIGHT ARROW PAVEMENT MARKING
BYL	BROKEN YELLOW LINE 4"	ONLY	"ONLY" PAVEMENT MARKING
DYL	DOUBLE YELLOW LINE 4"		
CW	CROSS WALK STRIPE 12"		
SL	STOP LINE 24"		
DL	DOTTED YELLOW LINE 4" (2' LINE & 6' GAP)		

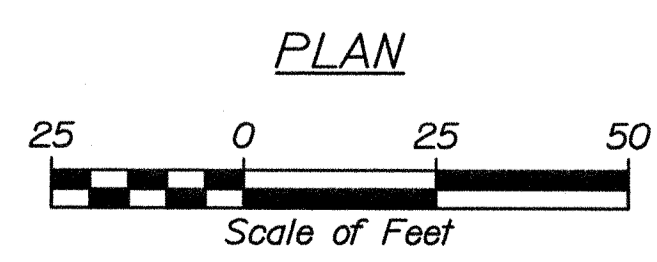

STATE OF MAINE DEPARTMENT OF TRANSPORTATION		STP-1725(200)X		HIGHWAY PLANS PIN 17252.00
<b>WALDOBORO US ROUTE 1 SIGNING AND STRIPING PLAN</b>				
DATE	BY	SIGNATURE	P.E. NUMBER	DATE
06/10	LEM			
DESIGN-DETAILED	REV			
CHECKED-REVIEWED	DOE			
DESIGN-DETAILED				
REVISIONS 1				
REVISIONS 2				
REVISIONS 3				
REVISIONS 4				
FIELD CHANGES				
SHEET NUMBER		<b>6</b>		
		OF 9		

Date: 6/24/2010

Username: imeek

Division: HIGHWAY

Filename: ... \CAD\007\_SSPLAN.dgn

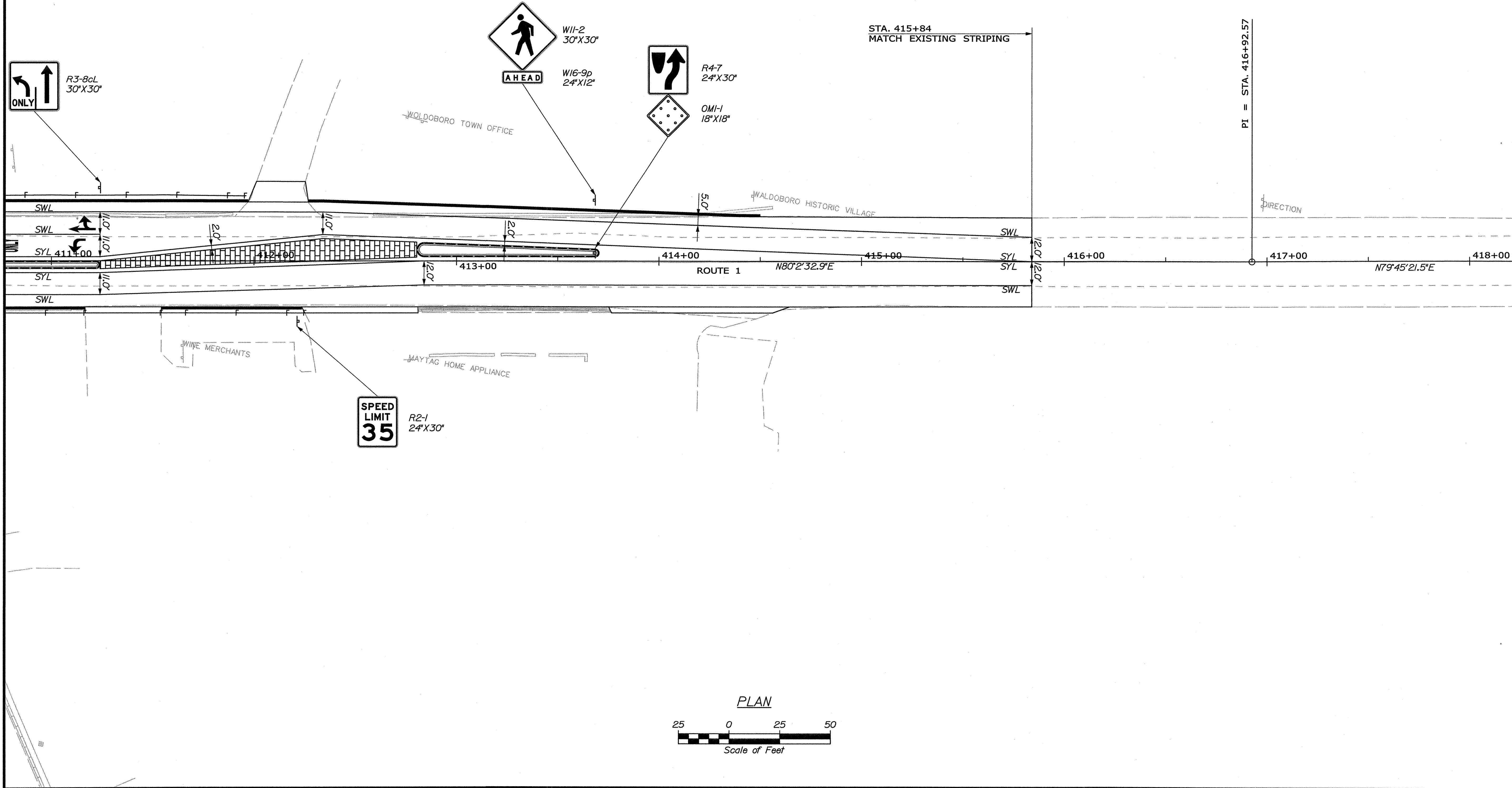

STATE OF MAINE  
DEPARTMENT OF TRANSPORTATION  
STP-1725(200)X  
PIN 17252.00  
HIGHWAY PLANS

PROJ. MANAGER	JUN. MANAGER	BY	DATE
DESIGN-DETAILED	RBM	LEM	06/10
CHECKED-REVIEWED	DSE	-	06/10
DESIGN-DETAILED2	-	-	-
DESIGN-DETAILED3	-	-	-
REVISIONS 1	-	-	-
REVISIONS 2	-	-	-
REVISIONS 3	-	-	-
REVISIONS 4	-	-	-
FIELD CHANGES	-	-	-

WALDOBORO  
US ROUTE 1  
SIGNING AND STRIPING PLAN

SHEET NUMBER  
7  
OF 9



Date: 6/24/2010

Username: imeek

Division: HIGHWAY

Filename: ... \CAD\008\_GEOMPLAN.dgn

POINT	STATION	OFFSET	POINT	STATION	OFFSET	POINT	STATION	OFFSET			
001	404+86.38	22.04'	LT	081	407+85.56	3.07'	LT	121	408+52.53	25.83'	RT
002	405+12.48	22.10'	LT	082	408+14.97	6.01'	LT	122	408+58.60	22.83'	RT
011	405+55.03	22.19'	LT	083	408+34.88	7.00'	LT	123	409+03.45	22.87'	RT
012	405+81.95	22.25'	LT	084	408+98.00	7.00'	LT	124	409+24.98	30.00'	RT
021	406+15.16	22.26'	LT	087	408+98.00	11.00'	LT	131	410+18.01	71.70'	RT
022	406+30.82	22.35'	LT	088	408+25.04	11.00'	LT	132	410+15.65	65.12'	RT
023	406+72.83	23.79'	LT	089	407+85.11	9.52'	LT	133	410+16.76	53.46'	RT
031	407+04.04	24.86'	LT	091	410+25.00	0.00'	CL	134	410+19.75	47.13'	RT
032	407+45.51	26.28'	LT	092	410+32.00	0.00'	CL	135	410+36.31	32.90'	RT
041	408+30.40	33.00'	LT	093	410+32.00	4.00'	RT	136	410+42.21	29.14'	RT
042	408+24.64	33.00'	LT	094	410+25.00	4.00'	RT	137	410+47.64	26.60'	RT
043	407+83.35	34.58'	LT	095	410+38.00	0.00'	CL	138	410+66.03	23.08'	RT
044	407+83.49	27.59'	LT	096	410+38.00	4.00'	RT	139	411+16.61	23.02'	RT
045	408+24.71	29.00'	LT	097	411+22.03	0.00'	CL				
046	408+63.72	29.00'	LT	098	411+22.03	4.00'	RT				
047	409+13.03	87.27'	LT	101	405+33.47	25.52'	RT				
051	409+41.81	97.17'	LT	102	405+34.60	22.52'	RT				
052	409+63.08	55.06'	LT	103	406+57.47	22.64'	RT				
053	410+12.56	29.00'	LT	104	406+61.45	25.64'	RT				
054	410+18.38	29.00'	LT	111	407+08.32	25.69'	RT				
061	410+24.38	29.00'	LT	112	407+12.62	22.69'	RT				
062	410+35.38	29.00'	LT	113	407+96.94	22.88'	RT				
071	406+22.41	0.52'	RT	114	408+01.23	25.78'	RT				
072	406+56.60	1.80'	RT								
073	406+56.60	4.74'	LT								
074	406+22.41	3.47'	LT								

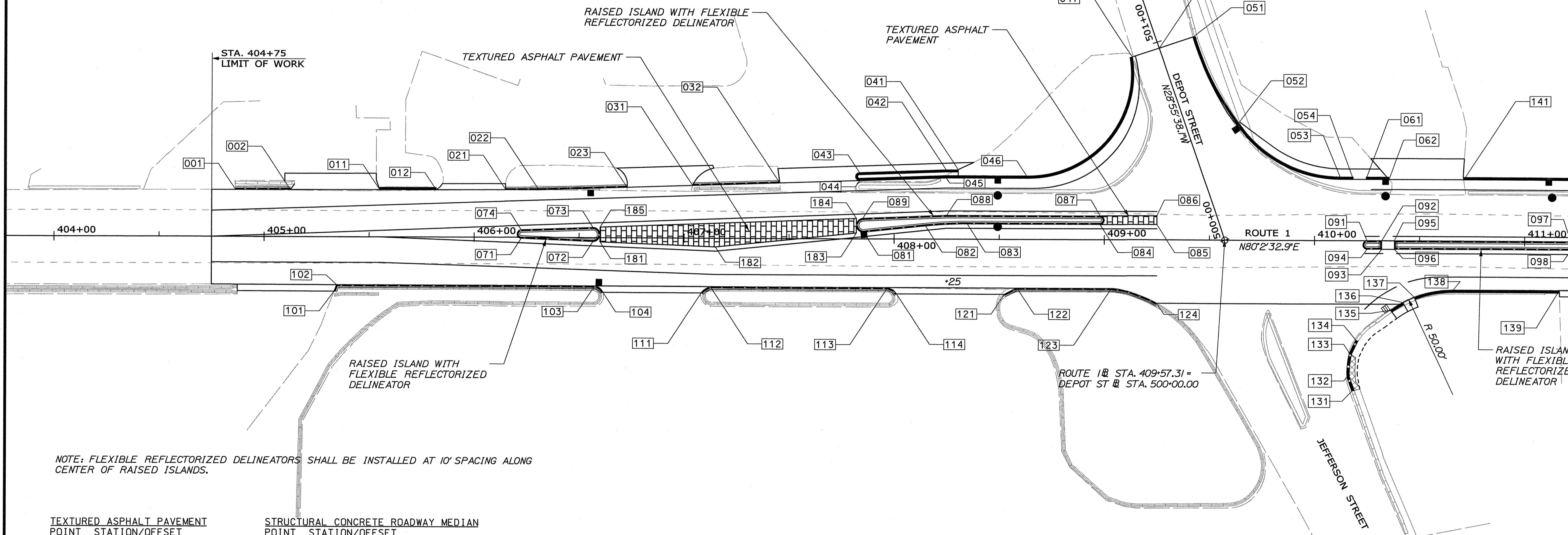

NOTE: FLEXIBLE REFLECTORIZED DELINEATORS SHALL BE INSTALLED AT 10' SPACING ALONG CENTER OF RAISED ISLANDS.

TEXTURED ASPHALT PAVEMENT		
POINT	STATION/OFFSET	
181	406+60.00,	1.93' RT
182	407+14.94,	4.00' RT
183	407+82.00,	2.71' LT
184	407+82.00,	9.40' LT
185	406+60.00,	4.87' LT

STRUCTURAL CONCRETE ROADWAY MEDIAN		
POINT	STATION/OFFSET	
084	408+98.00,	7.00' LT
085	409+25.00,	7.00' LT
086	409+25.00,	11.00' LT
087	408+98.00,	11.00' LT

RESET CURB TYPE 1	
POINT TO POINT	LENGTH
131 TO 132	7.00'
133 TO 134	7.00'

CURB TYPE 5	
POINT TO POINT	LENGTH
074 TO 073	34.22'
071 TO 072	34.22'
081 TO 084	112.62'
089 TO 087	112.91'
091 TO 092	7.00'
092 TO 093	4.00'
093 TO 094	7.00'
095 TO 096	4.00'
095 TO 097	84.03'
096 TO 098	84.03'

CURB TYPE 1	
POINT TO POINT	LENGTH
132 TO 133	11.76'

CURB TYPE 5 - CIRCULAR		
POINT TO POINT	LENGTH	CIRCULAR
071 TO 074	6.13'	2.00'
072 TO 073	10.54'	3.28'
081 TO 089	10.37'	3.24'
084 TO 087	6.28'	2.00'
091 TO 094	6.28'	2.00'
097 TO 098	6.28'	2.00'

CURB TYPE 3 (MOLD 1)		
POINT TO POINT	LENGTH	CIRCULAR
011 TO 012	26.92'	-
041 TO 043	47.08'	-
043 TO 044	6.28'	2.00'
044 TO 046	80.26'	-
052 TO 053	58.17'	60.00'
053 TO 054	5.82'	-
061 TO 062	11.00'	-
135 TO 136	7.00'	50.00'

CURB TYPE 3 (MOLD 2)		
POINT TO POINT	LENGTH	CIRCULAR
046 TO 047	86.85'	50.00'
051 TO 052	50.91'	130.00'
137 TO 138	18.83'	50.00'
138 TO 139	50.59'	-

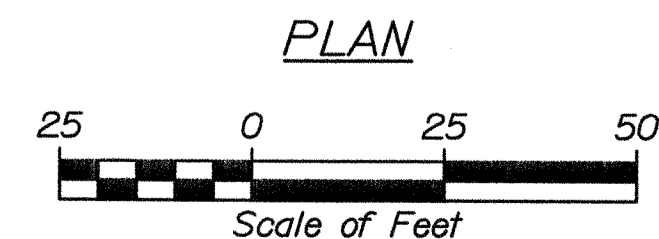

PLAN

STATE OF MAINE  
DEPARTMENT OF TRANSPORTATION  
STP-1725(200)X  
PIN 17252.00  
HIGHWAY PLANS

PROJ. MANAGER	JIM MANSER	BY	DATE	SIGNATURE
DESIGN-DETAILED	RFM	LEM	06/10	
CHECKED-REVIEWED	DCE			
DESIGN-DETAILED				
DESIGN-DETAILED				
REVISIONS 1				
REVISIONS 2				
REVISIONS 3				
REVISIONS 4				
FIELD CHANGES				

WALDOBORO  
US ROUTE 1  
GEOMETRIC LAYOUT AND  
CURBING QUANTITY NOTES

SHEET NUMBER  
**8**  
OF 9



Date: 6/24/2010

Username: lmeek

Division: HIGHWAY

Filename: ...CAD\009\_GEOMPLAN.dgn

POINT	STATION	OFFSET	
141	410+70.93	29.00'	LT
142	411+97.00	29.00'	LT
151	412+27.00	29.00'	LT
152	412+34.09	29.00'	LT
153	413+80.00	24.00'	LT
154	414+39.92	21.94'	LT
155	414+50.00	21.91'	LT
161	412+83.96	2.00'	LT
162	413+68.54	2.00'	LT
163	413+68.62	6.00'	LT
164	412+84.10	9.14'	LT
171	411+54.32	22.98'	RT
172	412+23.61	22.90'	RT

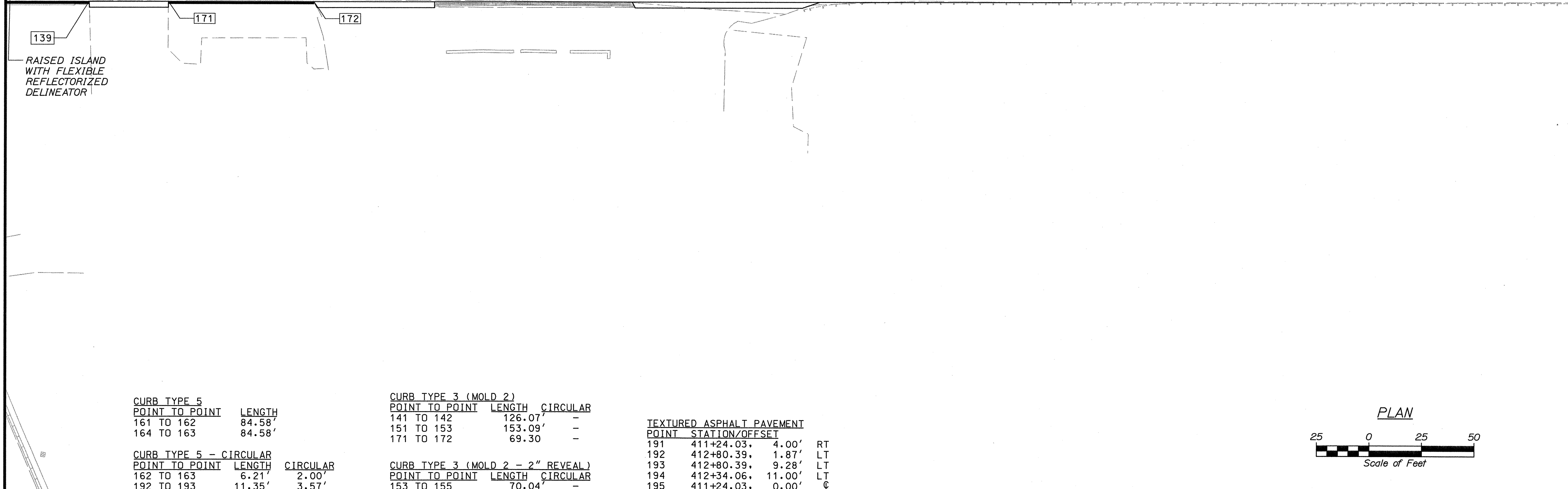
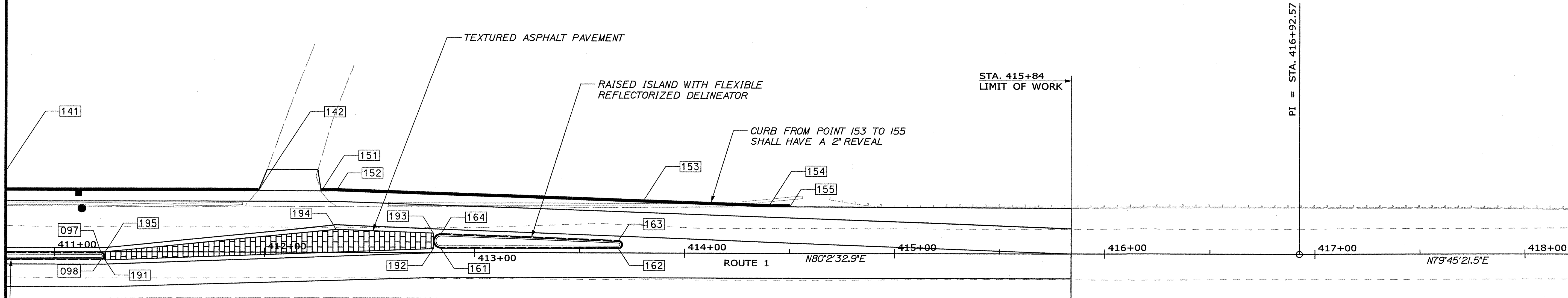
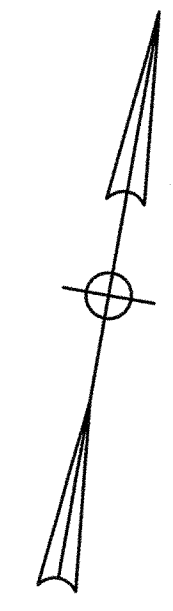

CURB TYPE 5		
POINT TO POINT	LENGTH	
161 TO 162	84.58'	
164 TO 163	84.58'	

CURB TYPE 5 - CIRCULAR		
POINT TO POINT	LENGTH	CIRCULAR
162 TO 163	6.21'	2.00'
192 TO 193	11.35'	3.57'

CURB TYPE 3 (MOLD 2)		
POINT TO POINT	LENGTH	CIRCULAR
141 TO 142	126.07'	-
151 TO 153	153.09'	-
171 TO 172	69.30'	-

CURB TYPE 3 (MOLD 2 - 2" REVEAL)		
POINT TO POINT	LENGTH	CIRCULAR
153 TO 155	70.04'	-

TEXTURED ASPHALT PAVEMENT			
POINT	STATION/OFFSET	LENGTH	
191	411+24.03,	4.00'	RT
192	412+80.39,	1.87'	LT
193	412+80.39,	9.28'	LT
194	412+34.06,	11.00'	LT
195	411+24.03,	0.00'	CL

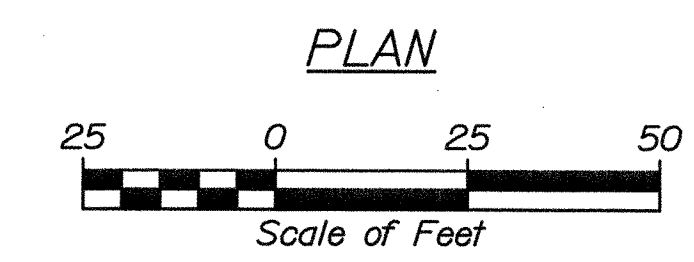

STATE OF MAINE  
DEPARTMENT OF TRANSPORTATION  
STP-1725(200)X  
PIN 17252.00  
HIGHWAY PLANS

PROJ. MANAGER	JIM MANIER	BY	DATE	SIGNATURE
DESIGN-DETAILED	ERM	LEM	06/10	
CHECKED-REVIEWED	DCE		06/10	
DESIGN-DETAILED	DCE			
DESIGN-DETAILED	DCE3			
REVISIONS 1				
REVISIONS 2				
REVISIONS 3				
REVISIONS 4				
FIELD CHANGES				

WALDOBORO  
US ROUTE 1  
GEOMETRIC LAYOUT AND  
CURBING QUANTITY NOTES

SHEET NUMBER  
**9**  
OF 9