



STATE OF MAINE  
DEPARTMENT OF TRANSPORTATION  
16 STATE HOUSE STATION  
AUGUSTA, MAINE  
04333-0016

JOHN ELIAS BALDACCI  
GOVERNOR

DAVID A. COLE  
COMMISSIONER

May 21, 2009  
Subject: **Enfield**  
Maine State Project No: 015644.00  
State Pin No: 015644.00  
**Amendment No. 1**

Dear Sir/Ms:

Please make the following changes to the Bid Documents:

In the Bid Book (pages 3 through 6), **REMOVE** the "SCHEDULE OF ITEMS" 4 pages dated 090505 and **INSERT** the attached new "SCHEDULE OF ITEMS" 4 pages dated 090521.

In the Plans, Sheet Number 3 of 10, "CONSTRUCTION NOTES" **ADD** the attached notes labeled "PIN 156644.00 – Enfield, Construction Notes Addendum" (2 pages dated Thursday, May 14, 2009) after item "631.18 CHAIN SAW RENTAL".

In the Plans, after Sheet Number 10 of 10, **ADD** the attached "DETOUR SIGNING PLAN", 1 page undated.

Consider these changes and information prior to submitting your bid on May 27, 2009.

Sincerely,

Scott Bickford  
Contracts & Specifications Engineer



PRINTED ON RECYCLED PAPER

SCHEDULE OF ITEMS

CONTRACT ID: 015644.00

PROJECT(S): 015644.00

CONTRACTOR : \_\_\_\_\_

LINE NO	ITEM DESCRIPTION	APPROX. QUANTITY AND UNITS	UNIT PRICE		BID AMOUNT	
			DOLLARS	CTS	DOLLARS	CTS
SECTION 0001 PROJECT ITEMS						
0010	202.20 REMOVING BITUMINOUS CONCRETE PAVEMENT	1760.000 SY				
0020	203.20 COMMON EXCAVATION	700.000 CY				
0030	203.242 DIRTY BORROW	60.000 CY				
0040	203.25 GRANULAR BORROW	470.000 CY				
0050	304.103 AGGREGATE SUBBASE - GRAVEL (TRUCK MEASURE)	600.000 CY				
0060	403.208 HOT MIX ASPHALT 12.5 MM HMA SURFACE	170.000 T				
0070	403.213 HOT MIX ASPHALT 12.5 MM BASE	170.000 T				
0080	409.15 BITUMINOUS TACK COAT - APPLIED	50.000 G				
0090	509.12 STEEL STRUCTURAL PLATE PIPE ARCH:	LUMP	LUMP			
0100	511.07 COFFERDAM: DOWNSTREAM	LUMP	LUMP			

SCHEDULE OF ITEMS

REVISED:

CONTRACT ID: 015644.00

PROJECT(S): 015644.00

CONTRACTOR : \_\_\_\_\_

LINE NO	ITEM DESCRIPTION	APPROX. QUANTITY AND UNITS	UNIT PRICE		BID AMOUNT	
			DOLLARS	CTS	DOLLARS	CTS
0110	511.07 COFFERDAM: UPSTREAM	LUMP	LUMP			
0120	527.303 ENERGY ABSORBING SYSTEM (ET-PLUS)	3.000 EA				
0130	606.23 GUARDRAIL TYPE 3C - SINGLE RAIL	662.500 LF				
0140	606.231 GUARDRAIL TYPE 3C - 15 FOOT RADIUS AND LESS	25.000 LF				
0150	606.265 TERMINAL END - SINGLE RAIL - GALVANIZED STEEL	1.000 EA				
0160	606.353 REFLECTORIZED FLEXIBLE GUARDRAIL MARKER	4.000 EA				
0170	610.08 PLAIN RIPRAP	40.000 CY				
0180	613.319 EROSION CONTROL BLANKET	100.000 SY				
0190	618.1401 SEEDING METHOD NUMBER 2 - PLAN QUANTITY	10.000 UN				
0200	619.1201 MULCH - PLAN QUANTITY	10.000 UN				
0210	620.58 NON WOVEN GEOTEXTILE	60.000 SY				

SCHEDULE OF ITEMS

REVISED:

CONTRACT ID: 015644.00

PROJECT(S): 015644.00

CONTRACTOR : \_\_\_\_\_

LINE NO	ITEM DESCRIPTION	APPROX. QUANTITY AND UNITS	UNIT PRICE		BID AMOUNT	
			DOLLARS	CTS	DOLLARS	CTS
0220	627.76 TEMPORARY PVMT. MARK LINE, W OR YELLOW	LUMP	LUMP			
0230	629.05 HAND LABOR, STRAIGHT TIME	10.000 HR				
0240	631.12 ALL PURPOSE EXCAVATOR (INCLUDING OPERATOR)	10.000 HR				
0250	631.172 TRUCK - LARGE (INCLUDING OPERATOR)	20.000 HR				
0260	631.18 CHAIN SAW RENTAL (INCLUDING OPERATOR)	10.000 HR				
0270	652.312 TYPE III BARRICADE	6.000 EA				
0280	652.33 DRUM	30.000 EA				
0290	652.34 CONE	30.000 EA				
0300	652.35 CONSTRUCTION SIGNS	609.000 SF				
0310	652.36 MAINTENANCE OF TRAFFIC CONTROL DEVICES	14.000 CD				
0320	652.38 FLAGGER	248.000 HR				

SCHEDULE OF ITEMS

REVISED:

CONTRACT ID: 015644.00

PROJECT(S): 015644.00

CONTRACTOR : \_\_\_\_\_

LINE NO	ITEM DESCRIPTION	APPROX. QUANTITY AND UNITS	UNIT PRICE		BID AMOUNT	
			DOLLARS	CTS	DOLLARS	CTS
0330	656.75 TEMPORARY SOIL EROSION AND WATER POLLUTION CONTROL	LUMP	LUMP			
0340	659.10 MOBILIZATION	LUMP	LUMP			
	TOTAL BID					

**PIN 15644.00 - Enfield**  
**Construction Notes Addendum**  
 Thursday, May 14, 2009

**652.312 TYPE III BARICADE**

Caribou Road near Southerly end of project:	2	Ea
Caribou Road near Northerly end of project:	2	Ea
Caribou Road at Passadumkeag end of road:	1	Ea
Caribou Road at Enfield end of road:	1	Ea

**Note: See attached Detour Signing Plan for location of Type III Baricades.**

**652.35 CONSTRUCTION SIGNS**

APPROACH SIGNS:	LENGTH (ft)	WIDTH (ft)	QUANTITY Each
ROAD WORK AHEAD	4	4	2
ROAD WORK 1000'	4	4	2
25 MPH	2	2	2
ROAD WORK 500'	4	4	2
25 MPH	2	2	2
ROAD WORK xx MILES	5	2	2
END CONSTRUCTION	5	2	2

TEMP. WORK ZONE ARRAY:	LENGTH (ft)	WIDTH (ft)	QUANTITY Each
WORK AREA AHEAD	4	4	2
ONE LANE ROAD AHEAD	4	4	2
25 MPH	2	2	2
FLAGGER	4	4	2

OTHER WORK ZONE SIGNS:	LENGTH (ft)	WIDTH (ft)	QUANTITY Each
BUMP	4	4	2
PAVEMENT ENDS	4	4	2
VERTICAL PANEL MARKERS	2	0.67	12
LOW SHOULDER	4	4	2

<b>DETOUR SIGNING:</b>	<b>LENGTH</b>	<b>WIDTH</b>	<b>QUANTITY</b>
	<b>(ft)</b>	<b>(ft)</b>	<b>Each</b>
DETOUR AHEAD	4	4	3
ROAD CLOSED 2 MILES AHEAD	4	4	1
ROAD CLOSED 1000 ft	4	4	2
ROAD CLOSED 500 ft	4	4	2
CARIBOU ROAD	3	1	7
DETOUR (w/left arrow) M4-9L	2.5	2	3
DETOUR (w/right arrow) M4-9R	2.5	2	4
DETOUR (w/left arrow) M4-10L	4	1.5	1
DETOUR (w/right arrow) M4-10R	4	1.5	1
ROAD CLOSED	4	2.5	2
ROAD CLOSED xx MILES AHEAD LOCAL TRAFFIC ONLY	5	2.5	2

**Note: See attached Detour Signing Plan for location of detour signing.**

# DETOUR SIGNING PLAN

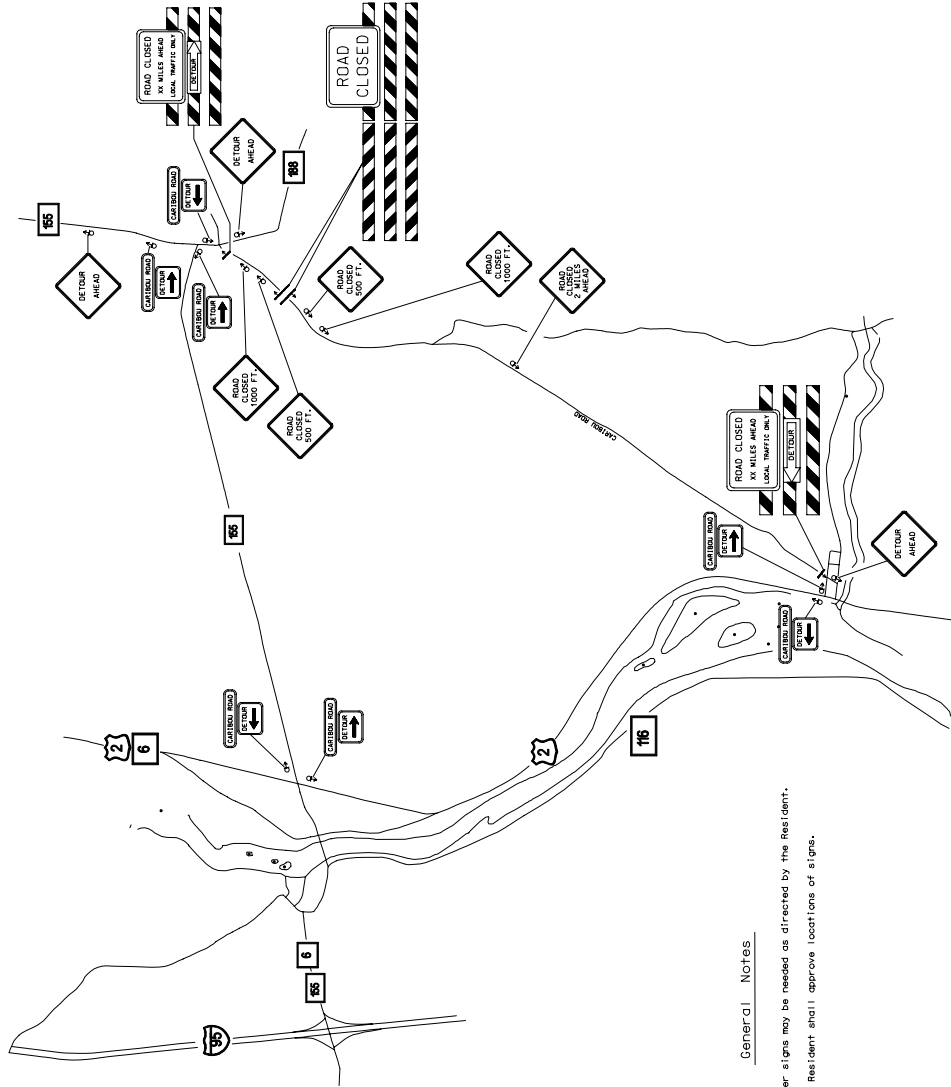

### General Notes

- 1) Other signs may be needed as directed by the Resident.
- 2) The Resident shall approve locations of signs.

NOT TO SCALE

DETOUR SIGN SUMMARY		
SIGN	SIZE	QTY. / COLOR
	48 x 48	3 Black on Orange
	48 x 48	2 Black on Orange
	48 x 48	2 Black on Orange
	48 x 48	1 Black on Orange
		7 Black on Orange
	30 X 24	4 Black on Orange
	30 X 24	3 Black on Orange
	48 X 18	1 Black on Orange
	48 X 18	1 Black on Orange
	60 X 30	2 Black on White
	48 x 30	2 Black on White