



STATE OF MAINE
 DEPARTMENT OF TRANSPORTATION
 16 STATE HOUSE STATION
 AUGUSTA, MAINE
 04333-0016

PAUL R. LEPAGE
 GOVERNOR

January 7, 2011

Subject: **Newport**
 State Pin No: 015625.00
Amendment No. 4

Dear Sir/Ms:

Make the following changes to the bid Documents:

In the bid book (pages 4 thru 13), **REMOVE** the “SCHEDULE OF ITEMS”, 10 pages dated 101208 and **REPLACE** with the attached new “SCHEDULE OF ITEMS”, 10 pages dated 110106.

In the Bid Book (page 79), **REMOVE** “SPECIAL PROVISION, SECTION 502, STRUCTURAL CONCRETE, (QC/QA Acceptance Methods), 1 page dated November 23, 2010 and **REPLACE** with the attached new “SPECIAL PROVISION, SECTION 502, STRUCTURAL CONCRETE, (QC/QA Acceptance Methods), 1 page dated January 6, 2011.

In the Plans, SHEET NUMBER 2 OF 41, ESTIMATED QUANTITIES, make the following quantity CHANGES in pen and ink;

ITEM	DESCRIPTION	QUANTITY
503.12	Reinforcing Steel, Fabricated and Delivered	from 85900 to read 33,200 LB
503.13	Reinforcing Steel, Placing	from 85900 to read 33,200 LB
609.13	Vertical Bridge Curb Type 1	from 246 to read 123 LF
652.35	Construction Signs	from 2200 to read 3228 SF

In the Plans, SHEET NUMBER 9 OF 41, CURB LAYOUT PLAN , CURB SUMMARY table (last line) – under “Item 606.13-Vertical Bridge Curb, Type 1”, **DELETE** in its entirety the curb between “**Point 32 to Point 33**”. Make this change in pen and ink.

In the Plans, **REMOVE** the below listed Plan Sheets and **REPLACE** with the attached new Plan Sheets;

- SHEET NUMBER 37 OF 41
- SHEET NUMBER 38 OF 41
- SHEET NUMBER 39 OF 41
- SHEET NUMBER 40 OF 41

In the Plans, **ADD** the attached SHEET NUMBER 40A OF 41 after SHEET NUMBER 40 OF 41.

NOTE: Plan sheets will be FedExed/Mailed to those who purchased plans in the quantity and size ordered.



PRINTED ON RECYCLED PAPER

The following questions have been received:

Question: We can only find 123 FT. of vertical bridge curb on the plans. The bid quantity for item 609.13 Vertical Bridge Curb is 246 LF. Is the bid quantity correct?

Response: The bid quantity is incorrect. Please refer to the new schedule of items.

Question: Bid Item 510.12 Special Detour is for vehicular traffic and pedestrian traffic separated. The third paragraph in Section 510 Special Detours states the Vehicular and Pedestrian Traffic NOT separated. Which one is correct?

Response: When Main Street Bridge/Route 2 is closed to traffic, traffic will be rerouted using the existing local streets (Elm Street, North Street and High Street). Vehicular traffic will use the existing streets and pedestrians will use the existing network of sidewalks. There is no need to install a barrier between the road and the sidewalk.

Question: It does not appear that the turning radius from High Street onto North Street, North Street onto Elm Street or Elm Street onto North Street will meet AASHTO tracking characteristics for a WB-62 vehicle. Does the State own the right of way to increase the tracking characteristics at these locations and how will the Contractor be paid if these locations need to be widened?

Response: The intent of the detour plan is to reroute all large trucks (i.e. tractor trailers) away from the detour on Elm Street, North Street and High Street. The State has no plans to revise the layout of Elm Street, North Street and High Street.

Question: How thick is the existing pavement and sub base along the detour route on High Street, North Street and Elm Street?

Response: Unknown.

Question: Does the State plan on paving, full width, the entire detour route prior to the Contractor opening the detour to traffic?

Response: No

Question: How will new bituminous pavement placed on the detour route be paid?

Response: Bituminous pavement is only needed to patch a few isolated locations as directed by the Resident. Payment for this bituminous pavement used for isolated patching shall be paid for under item 510.12.

Question: Special Provision Section 510 – Special Detours: Under Contractor’s Responsibility, is it the States intent to have the Contractor assume all the risk of replacing the bridge on North Street if destroyed by high water or any cause? If the Contractor is responsible; has the State performed a survey on the North Street Bridge and can the survey and plans be made available for the Contractor’s use?

Response: The Department does not intent for the Contractor to assume any of the risk for the Upper Bridge #2885 on North Street in Newport. The Department shall be responsible for any maintenance needed on Upper Bridge #2885 on North Street in Newport.

Question: On Sheet 29 of 41, Diaphragms are notes typical at each abutment, yet drawing indicates Type J, which is a crossframe. Please clarify.

Response: See the framing plan on sheet 29. All the diaphragms are type J which are shown on sheet 504(18) of MaineDOT standard details.

Question: The bid quantity for items 503.12 and 503.13, Reinforcing Steel Fabricated, Delivered and Placed includes the reinforcing steel quantity for the superstructure. Note 6 on plan sheet 31 states the reinforcing steel for the superstructure is incidental to section 502. I addition, Special Provision, Section 520, Precast Deck Panel, the reinforcing steel is incidental to section 502.26. Please clarify the discrepancy.

Response: The bid quantity for items 503.12 and 503.13 is incorrect. The quantities for items 503.12 and 503.13 have been updated and the revised quantities do not include any reinforcement needed for item 502.26. Payment for reinforcing steel fabricated, delivered and placed in the cast in place portion of the structural concrete slab will be considered incidental to item 502.26. Please refer to the new schedule of items.

Consider these changes and information prior to submitting your bid on January 12, 2011

Sincerely,



Scott Bickford

Contracts & Specifications Engineer



SCHEDULE OF ITEMS

REVISED:

CONTRACT ID: 015625.00

PROJECT(S): 015625.00

CONTRACTOR : _____

LINE NO	ITEM DESCRIPTION	APPROX. QUANTITY AND UNITS	UNIT PRICE		BID AMOUNT	
			DOLLARS	CTS	DOLLARS	CTS
SECTION 0001 PROJECT ITEMS						
0010	202.11 REMOVING PORTLAND CEMENT CONCRETE PAVEMENT	1170.000 SY				
0020	202.111 REMOVING OF CONCRETE SIDEWALK	215.000 SY				
0030	202.19 REMOVING EXISTING BRIDGE	LUMP	LUMP			
0040	203.20 COMMON EXCAVATION	1320.000 CY				
0050	203.24 COMMON BORROW	2970.000 CY				
0060	203.25 GRANULAR BORROW	1340.000 CY				
0070	203.35 CRUSHED STONE FILL	100.000 CY				
0080	206.082 STRUCTURAL EARTH EXCAVATION - MAJOR STRUCTURES	680.000 CY				
0090	304.10 AGGREGATE SUBBASE COURSE - GRAVEL	1415.000 CY				
0100	403.207 HOT MIX ASPHALT 19.0 MM HMA	320.000 T				

SCHEDULE OF ITEMS

REVISED:

CONTRACT ID: 015625.00

PROJECT(S): 015625.00

CONTRACTOR : _____

LINE NO	ITEM DESCRIPTION	APPROX. QUANTITY AND UNITS	UNIT PRICE		BID AMOUNT	
			DOLLARS	CTS	DOLLARS	CTS
0110	403.209 HOT MIX ASPHALT 9.5 MM (SIDEWALKS, DRIVES, INCIDENTALS)	70.000 T				
0120	403.210 HOT MIX ASPHALT 9.5 MM	400.000 T				
0130	403.211 HOT MIX ASPHALT (SHIMMING)	34.000 T				
0140	403.213 HOT MIX ASPHALT 12.5 MM BASE	200.000 T				
0150	409.15 BITUMINOUS TACK COAT - APPLIED	170.000 G				
0160	501.231 DYNAMIC LOADING TEST	2.000 EA				
0170	501.50 STEEL H-BEAM PILES 89 LBS/FT, DELIVERED	330.000 LF				
0180	501.501 STEEL H-BEAM PILES 89 LBS/FT, IN PLACE	330.000 LF				
0190	501.90 PILE TIPS	10.000 EA				
0200	501.91 PILE SPLICES	4.000 EA				
0210	501.92 PILE DRIVING EQUIPMENT MOBILIZATION	LUMP	LUMP			

SCHEDULE OF ITEMS

REVISED:

CONTRACT ID: 015625.00

PROJECT(S): 015625.00

CONTRACTOR : _____

LINE NO	ITEM DESCRIPTION	APPROX. QUANTITY AND UNITS	UNIT PRICE		BID AMOUNT	
			DOLLARS	CTS	DOLLARS	CTS
0220	502.219 STRUCTURAL CONCRETE, ABUTMENTS AND RETAINING WALLS	LUMP	LUMP			
0230	502.26 STRUCTURAL CONCRETE ROADWAY AND SIDEWALK SLABS ON STEEL BRIDGES	LUMP	LUMP			
0240	502.31 STRUCTURAL CONCRETE APPROACH SLABS	LUMP	LUMP			
0250	502.49 STRUCTURAL CONCRETE CURBS AND SIDEWALKS	LUMP	LUMP			
0260	503.12 REINFORCING STEEL, FABRICATED AND DELIVERED	33200.000 LB				
0270	503.13 REINFORCING STEEL, PLACING	33200.000 LB				
0280	504.702 STRUCTURAL STEEL FABRICATED AND DELIVERED, WELDED	LUMP	LUMP			
0290	504.709 BRIDGE HARDWARE	LUMP	LUMP			
0300	504.71 STRUCTURAL STEEL ERECTION	LUMP	LUMP			
0310	505.08 SHEAR CONNECTORS	LUMP	LUMP			
0320	508.14 HIGH PERFORMANCE WATERPROOFING MEMBRANE	LUMP	LUMP			

SCHEDULE OF ITEMS

REVISED:

CONTRACT ID: 015625.00

PROJECT(S): 015625.00

CONTRACTOR : _____

LINE NO	ITEM DESCRIPTION	APPROX. QUANTITY AND UNITS	UNIT PRICE		BID AMOUNT	
			DOLLARS	CTS	DOLLARS	CTS
0330	510.12 SPECIAL DETOUR FOOT ROADWAY WIDTH, VEHICULAR AND PEDESTRIAN TRAFFIC SEPARATED 26'	LUMP	LUMP			
0340	512.081 FRENCH DRAINS	LUMP	LUMP			
0350	514.06 CURING BOX FOR CONCRETE CYLINDERS	1.000 EA				
0360	515.20 PROTECTIVE COATING FOR CONCRETE SURFACES	440.000 SY				
0370	520.232 EXPANSION DEVICE - ASPHALTIC PLUG JOINT	72.000 LF				
0380	525.33 STONE MASONRY WALL - REMOVE AND RESET	LUMP	LUMP			
0390	526.30 TEMPORARY CONCRETE BARRIER - TYPE 1	100.000 LF				
0400	526.323 TEXAS CLASSIC RAIL	LUMP	LUMP			
0410	527.303 ENERGY ABSORBING SYSTEM (ET-PLUS)	2.000 EA				
0420	603.179 18 INCH CULVERT PIPE OPTION III	134.000 LF				

SCHEDULE OF ITEMS

REVISED:

CONTRACT ID: 015625.00

PROJECT(S): 015625.00

CONTRACTOR : _____

LINE NO	ITEM DESCRIPTION	APPROX. QUANTITY AND UNITS	UNIT PRICE		BID AMOUNT	
			DOLLARS	CTS	DOLLARS	CTS
0430	604.072 CATCH BASIN TYPE A1-C	3.000 EA				
0440	605.09 6 INCH UNDERDRAIN TYPE B	384.000 LF				
0450	606.1721 BRIDGE TRANSITION - TYPE 1	6.000 EA				
0460	606.1722 BRIDGE TRANSITION - TYPE 2	1.000 EA				
0470	606.23 GUARDRAIL TYPE 3C - SINGLE RAIL	244.000 LF				
0480	606.231 GUARDRAIL TYPE 3C - 15 FOOT RADIUS AND LESS	75.000 LF				
0490	606.265 TERMINAL END - SINGLE RAIL - GALVANIZED STEEL	3.000 EA				
0500	606.353 REFLECTORIZED FLEXIBLE GUARDRAIL MARKER	14.000 EA				
0510	606.79 GUARDRAIL 350 FLARED TERMINAL	2.000 EA				
0520	607.17 CHAIN LINK FENCE - 6 FOOT	40.000 LF				
0530	607.24 REMOVE AND RESET FENCE	46.000 LF				

SCHEDULE OF ITEMS

REVISED:

CONTRACT ID: 015625.00

PROJECT(S): 015625.00

CONTRACTOR : _____

LINE NO	ITEM DESCRIPTION	APPROX. QUANTITY AND UNITS	UNIT PRICE		BID AMOUNT	
			DOLLARS	CTS	DOLLARS	CTS
0540	608.26 CURB RAMP DETECTABLE WARNING FIELD	48.000 SF				
0550	609.11 VERTICAL CURB TYPE 1	604.000 LF				
0560	609.12 VERTICAL CURB TYPE 1 - CIRCULAR	63.000 LF				
0570	609.13 VERTICAL BRIDGE CURB TYPE 1	123.000 LF				
0580	609.234 TERMINAL CURB TYPE 1 - 4 FOOT	2.000 EA				
0590	609.237 TERMINAL CURB TYPE 1 - 7 FOOT	9.000 EA				
0600	609.2371 TERMINAL CURB TYPE 1- 7 FT - CIRCULAR	4.000 EA				
0610	610.08 PLAIN RIPRAP	385.000 CY				
0620	610.16 HEAVY RIPRAP	800.000 CY				
0630	610.18 STONE DITCH PROTECTION	30.000 CY				
0640	613.319 EROSION CONTROL BLANKET	150.000 SY				

SCHEDULE OF ITEMS

REVISED:

CONTRACT ID: 015625.00

PROJECT(S): 015625.00

CONTRACTOR : _____

LINE NO	ITEM DESCRIPTION	APPROX. QUANTITY AND UNITS	UNIT PRICE		BID AMOUNT	
			DOLLARS	CTS	DOLLARS	CTS
0650	615.07 LOAM	92.000 CY				
0660	618.1301 SEEDING METHOD NUMBER 1 - PLAN QUANTITY	2.000 UN				
0670	618.1401 SEEDING METHOD NUMBER 2 - PLAN QUANTITY	15.000 UN				
0680	619.1201 MULCH - PLAN QUANTITY	17.000 UN				
0690	619.1401 EROSION CONTROL MIX	185.000 CY				
0700	620.58 EROSION CONTROL GEOTEXTILE	4650.000 SY				
0710	626.221 NON-METALLIC CONDUIT CONCRETE ENCASED	114.000 LF				
0720	626.37 SPECIAL FOUNDATION	1.000 EA				
0730	627.733 4" WHITE OR YELLOW PAINTED PAVEMENT MARKING LINE	18350.000 LF				
0740	627.75 WHITE OR YELLOW PAVEMENT & CURB MARKING	1300.000 SF				
0750	627.77 REMOVING PAVEMENT MARKINGS	12.000 SF				

SCHEDULE OF ITEMS

REVISED:

CONTRACT ID: 015625.00

PROJECT(S): 015625.00

CONTRACTOR : _____

LINE NO	ITEM DESCRIPTION	APPROX. QUANTITY AND UNITS	UNIT PRICE		BID AMOUNT	
			DOLLARS	CTS	DOLLARS	CTS
0760	627.811 TEMPORARY BI-DIRECTIONAL YELLOW DELINEATORS	50.000 EA				
0770	627.812 TEMP. BI-DIRECTIONAL WHITE DELINEATORS	100.000 EA				
0780	629.05 HAND LABOR, STRAIGHT TIME	40.000 HR				
0790	631.12 ALL PURPOSE EXCAVATOR (INCLUDING OPERATOR)	20.000 HR				
0800	631.16 ROLLER, PAVEMENT (INCLUDING OPERATOR)	20.000 HR				
0810	631.172 TRUCK - LARGE (INCLUDING OPERATOR)	20.000 HR				
0820	631.18 CHAIN SAW RENTAL (INCLUDING OPERATOR)	10.000 HR				
0830	631.21 ROAD BROOM (INCLUDING OPERATORS AND HAULER)	10.000 HR				
0840	631.211 PAVEMENT SWEEPER (INCLUDING OPERATOR)	10.000 HR				
0850	631.212 SMALL PAVEMENT GRINDER (INCLUDING OPERATOR)	20.000 HR				
0860	631.32 CULVERT CLEANER (INCLUDING OPERATOR)	10.000 HR				

SCHEDULE OF ITEMS

REVISED:

CONTRACT ID: 015625.00

PROJECT(S): 015625.00

CONTRACTOR : _____

LINE NO	ITEM DESCRIPTION	APPROX. QUANTITY AND UNITS	UNIT PRICE		BID AMOUNT	
			DOLLARS	CTS	DOLLARS	CTS
0870	634.70 ORNAMENTAL LIGHTING	2.000 EA				
0880	637.071 DUST CONTROL	LUMP	LUMP			
0890	639.19 FIELD OFFICE TYPE B	1.000 EA				
0900	641.35 ALUMINUM FLAG POLE	1.000 EA				
0910	645.113 REINSTALL GUIDE SIGN	1.000 EA				
0920	645.271 REGULATORY, WARNING, CONFIRMATION AND ROUTE MARKER ASSEMBLY SIGNS, TYPE I	65.000 SF				
0930	645.51 SPECIAL SIGNING	LUMP	LUMP			
0940	652.31 TYPE I BARRICADE	8.000 EA				
0950	652.312 TYPE III BARRICADE	6.000 EA				
0960	652.33 DRUM	40.000 EA				
0970	652.34 CONE	40.000 EA				

SCHEDULE OF ITEMS

REVISED:

CONTRACT ID: 015625.00

PROJECT(S): 015625.00

CONTRACTOR : _____

LINE NO	ITEM DESCRIPTION	APPROX. QUANTITY AND UNITS	UNIT PRICE		BID AMOUNT	
			DOLLARS	CTS	DOLLARS	CTS
0980	652.35 CONSTRUCTION SIGNS	3228.000 SF				
0990	652.36 MAINTENANCE OF TRAFFIC CONTROL DEVICES	180.000 CD				
1000	652.38 FLAGGER	500.000 HR				
1010	656.75 TEMPORARY SOIL EROSION AND WATER POLLUTION CONTROL	LUMP	LUMP			
1020	659.10 MOBILIZATION	LUMP	LUMP			
	SECTION 0001 TOTAL					
	TOTAL BID					

SPECIAL PROVISION
SECTION 502
STRUCTURAL CONCRETE
(QC/QA Acceptance Methods)

CLASS OF CONCRETE	ITEM NUMBER	DESCRIPTION	P	METHOD
A	502.219	Structural Conc. Abut. and Retaining Walls	\$400	C
A	502.26	Structural Concrete Roadway and Sidewalk Slabs on Steel	\$400	A
A	502.31	Structural Concrete Approach Slab		C
LP	502.49	Structural Concrete Curbs and Sidewalk	\$450	A
LP	526.323	Texas Classic Rail	\$450	A

P values listed above reflect the price per cubic yard (yd³) for all pay adjustment purposes.

MAIN STREET BRIDGE
 EAST BRANCH SEBASTICOOK RIVER
 NEWPORT
 PENOBSCOT COUNTY
 MAIN ST. DETOUR PLANS

PROJ. MANAGER	S. Bodge	BY	DATE
CHECKED-REVIEWED	M. Wright	D. Sullivan	NOV 2010
DESIGN-DETAILED	R. Myers	R. Nimom	
DESIGN-DETAILED			
REVISIONS 1			
REVISIONS 2			
REVISIONS 3			
REVISIONS 4			
FIELD CHANGES			

STATE OF MAINE DEPARTMENT OF TRANSPORTATION	BR-1562(500)X PIN 15625.00	BRIDGE NO. 2501
SIGNATURE		DATE
P.E. NUMBER		

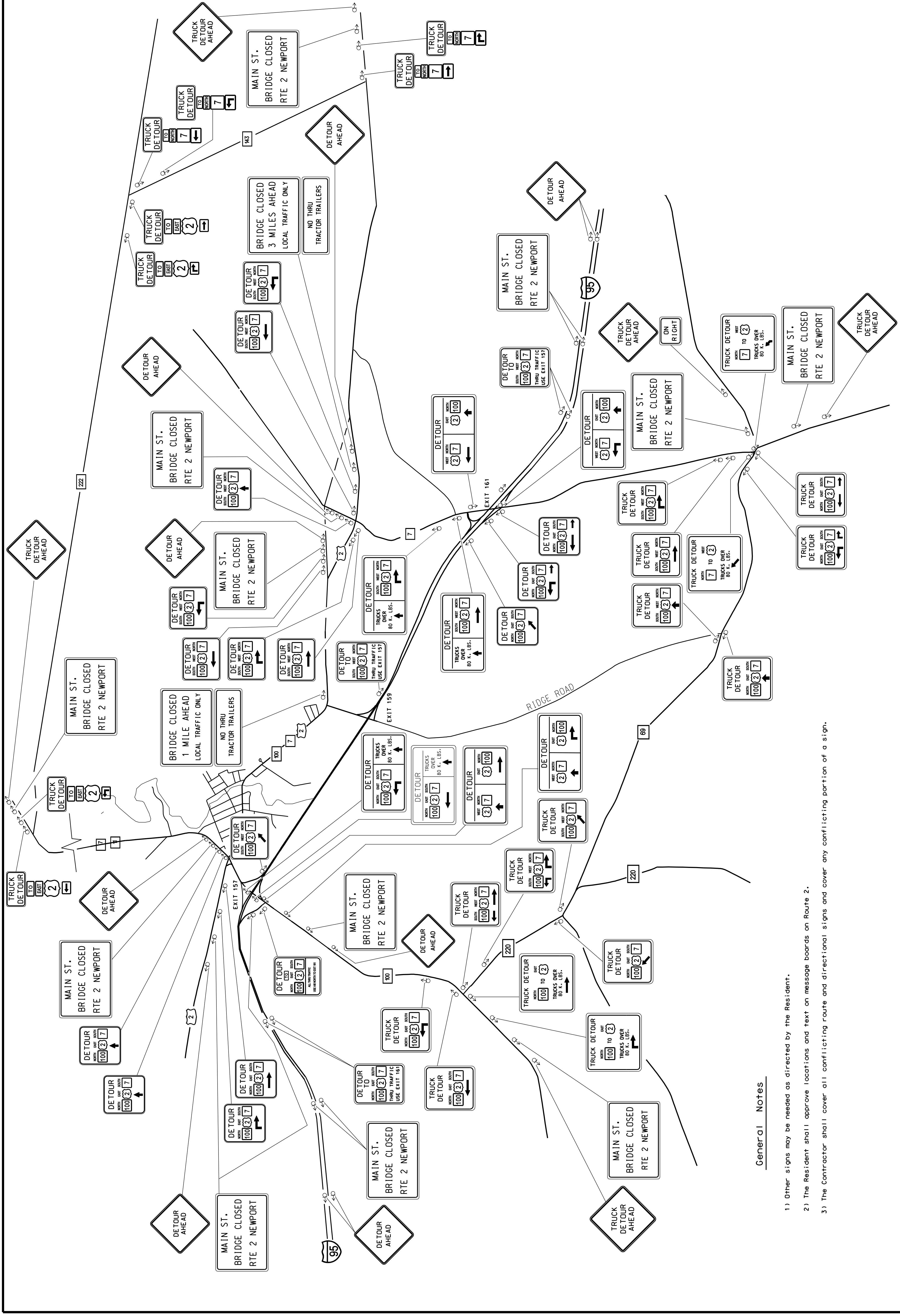

General Notes

- 1) Other signs may be needed as directed by the Resident.
- 2) The Resident shall approve locations and text on message boards on Route 2.
- 3) The Contractor shall cover all conflicting route and directional signs and cover any conflicting portion of a sign.

PROJ. MANAGER S. Bodge	BY	DATE
DESIGN-DETAILED M. Wright	D. Sullivan	DEC 2010
CHECKED-REVIEWED R. Myers	R. Nimon	NOV 2010
DESIGN-DETAILED R. Nimon		
DESIGN-DETAILED R. Nimon		
REVISIONS 1		
REVISIONS 2		
REVISIONS 3		
REVISIONS 4		
FIELD CHANGES		

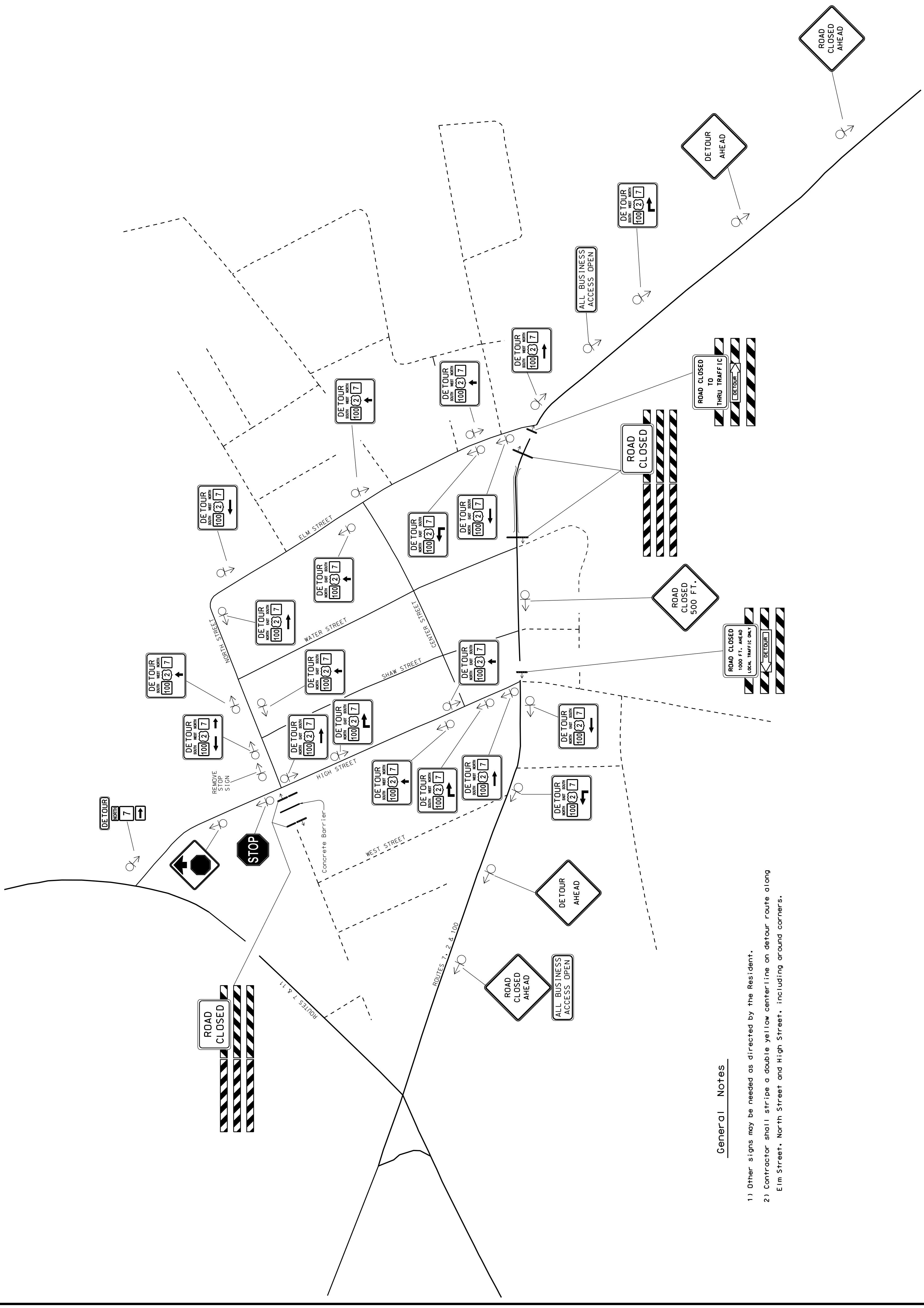

General Notes

- 1) Other signs may be needed as directed by the Resident.
- 2) Contractor shall stripe a double yellow centerline on detour route along Elm Street, North Street and High Street, including around corners.

SIGN SUMMARY		
SIGN	SIZE	QTY. / COLOR
	48 x 48	12 Black on Orange
	48 x 48	5 Black on Orange
	48 x 48	2 Black on Orange
	48 x 48	1 Black on Orange
	60 x 30 96 x 48 Interstate	11 Black on Orange 4
	60 x 30	1 Black on White
	72 x 60	5 Black on Orange
	72 x 60	2 Black on Orange
	72 x 60	3 Black on Orange
	72 x 60	2 Black on Orange

SIGN SUMMARY		
SIGN	SIZE	QTY. / COLOR
	48 x 48	1 Black / Red on Orange
	36 x 36	1 Red/White
	72 x 60	1 Black on Orange
	72 x 84	1 Black on Orange
	72 x 84	3 Black on Orange
	72 x 72	1 Black on Orange
	72 x 72	1 Black on Orange
	21 x 15	2 Black/White
	21 x 15	2 Black/White
	24 x 24	4 Black/White
	24 x 12	4 Black/White
	24 x 12	8 Black/White
	24 x 18	8 Black on Orange
	24 x 24	5 Black on White
	21 x 15	5 Black on White
	24 x 12	5 Black on White
	24 x 12	1 Black on Orange

STATE OF MAINE DEPARTMENT OF TRANSPORTATION BR-1562(500)X PIN 15625.00		BRIDGE NO. 2501		DATE		P.E. NUMBER		SIGNATURE		PROJ. MANAGER S. Bodge BY CHECKED-REVIEWED M. Wight R. Myers DESIGN-DETAILED D. Sullivan R. Nimmon DESIGN-DETAILED R. Nimmon REVISIONS 1 REVISIONS 2 REVISIONS 3 REVISIONS 4 FIELD CHANGES	
MAIN STREET BRIDGE EAST BRANCH SEBASTICOOK RIVER NEWPORT PENOBSCOT COUNTY										DETOUR SIGNS SHEET NUMBER 39 OF 41	

SIGN SUMMARY		
SIGN	SIZE	QTY. / COLOR
	48 x 30	4 Black on White
	60 x 30	1 Black on White
	60 x 30	1 Black on White
	96 x 60	1 Black on Orange
	96 x 60	1 Black on Orange
	96 x 60	1 Black on Orange
	96 x 60	1 Black on Orange
	96 x 60	1 Black on Orange
	96 x 60	1 Black on Orange
	96 x 60	1 Black on Orange
	96 x 60	1 Black on Orange
	96 x 60	1 Black on Orange
	96 x 60	1 Black on Orange
	72 x 72	1 Black on Orange
	24 x 18	1 Black on Orange

SIGN SUMMARY		
SIGN	SIZE	QTY. / COLOR
	72 x 60	2 Black on Orange
	84 x 72	1 Black on Orange
	72 x 60	1 Black on Orange
	72 x 60	1 Black on Orange
	72 x 84	1 Black on Orange
	72 x 60	2 Black on Orange
	72 x 60	3 Black on Orange
	72 x 60	3 Black on Orange
	72 x 60	3 Black on Orange
	84 x 72	1 Black on Orange
	72 x 60	5 Black on Orange
	48 x 18	1 Black on Orange
	48 x 18	1 Black on Orange
	60 x 24	2 Black on Orange

MAIN STREET BRIDGE EAST BRANCH SEBASTICOOK RIVER NEWPORT PENOBSCOT COUNTY	DETOUR SIGNS
PROJ. MANAGER: S. Bodge BY: M. Wright CHECKED-REVIEWED: R. Myers DESIGN-DETAILED: D. Sullivan NOV 2010 SIGNATURE: _____ P.E. NUMBER: _____ DATE: _____	REVISIONS 1 REVISIONS 2 REVISIONS 3 REVISIONS 4 FIELD CHANGES
STATE OF MAINE DEPARTMENT OF TRANSPORTATION BR-1562(500X) PIN 15625.00 BRIDGE NO. 2501	SHEET NUMBER 40 OF 41

