

ALTERNATE DESIGN

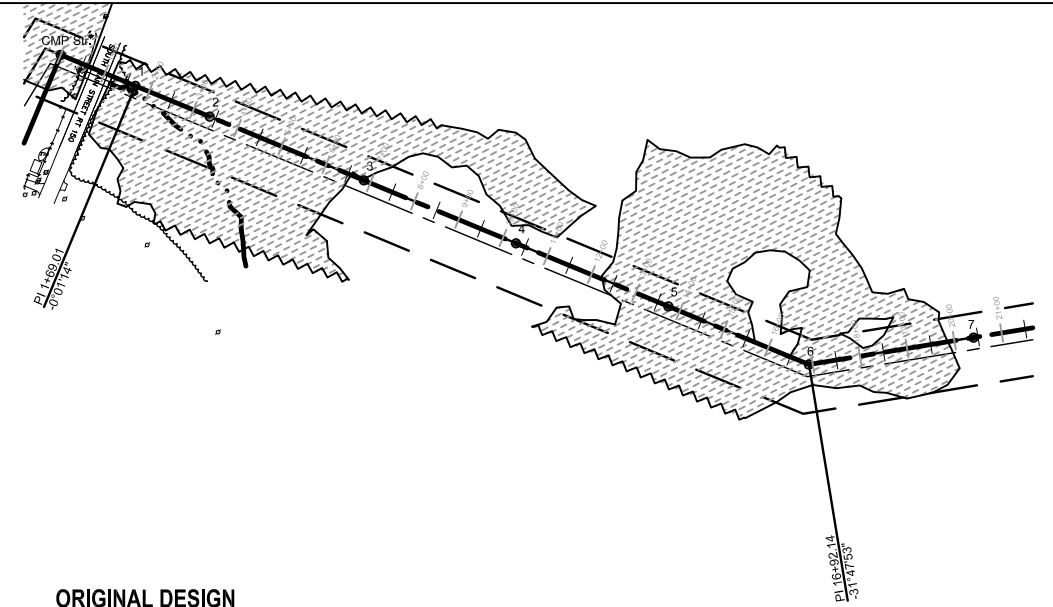

ORIGINAL DESIGN

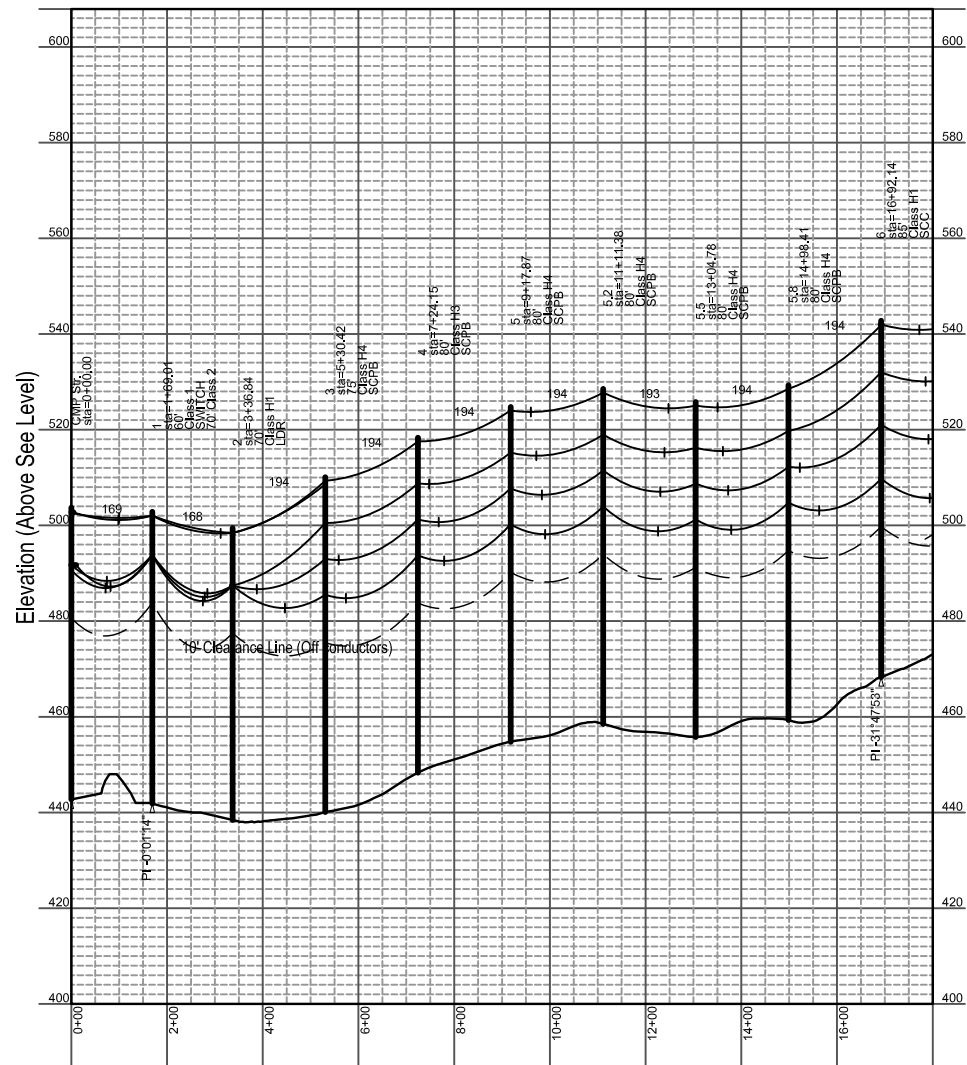
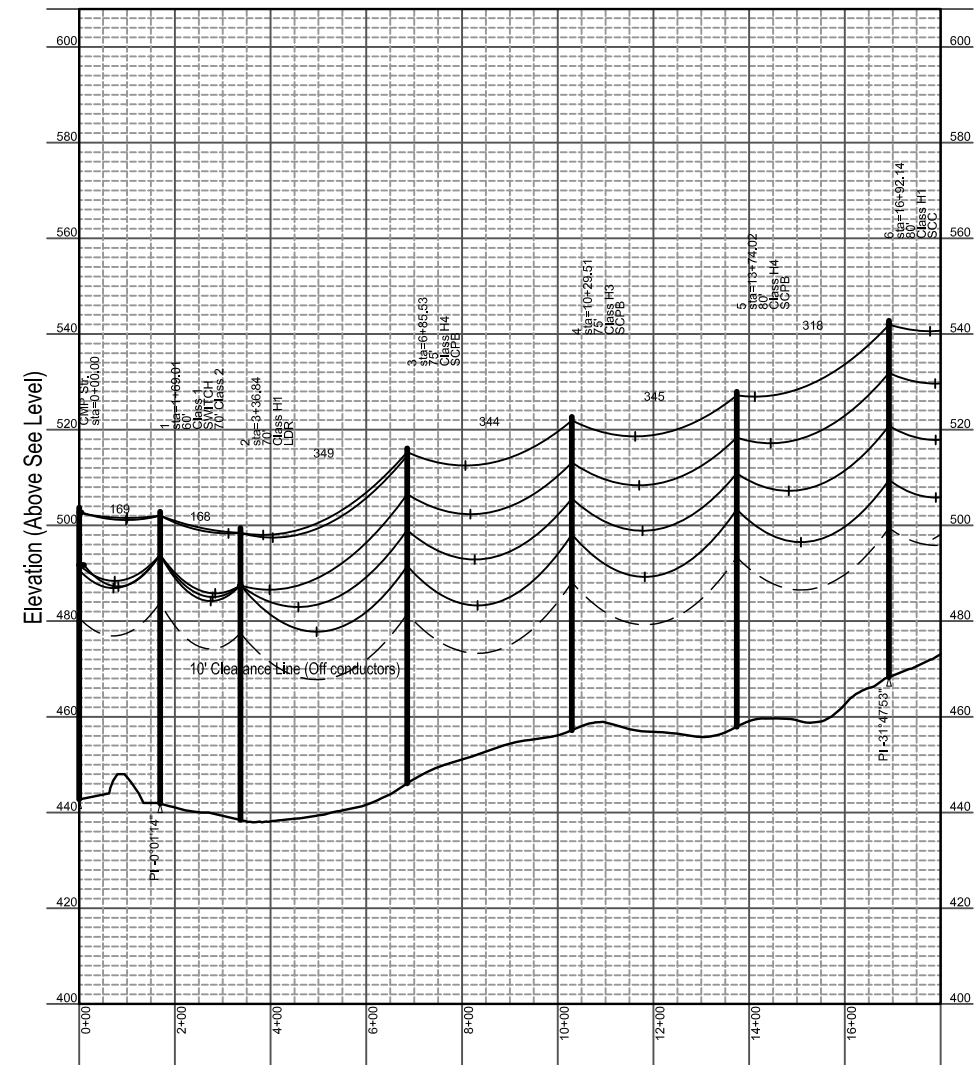

NOTES:

1. The Plans and Profiles shown are provided to present a comparison of the originally prepared permit design (on the right), which was based on typical 115kV transmission line construction, and an alternative approach (on the left) which was prepared to provide additional ground clearance, which includes shorter spans to reduce wire sag and slightly taller poles.
2. The alternative approach on the left, from substation to Structure 6 requires 3 additional poles of which 2 are in wetlands.
3. Pole heights in the alternative approach were raised by no more than 5-feet (poles come in height increments of 5-feet).



ISSUED FOR REVIEW

DATE: JULY 30, 2013 SCALE: N.T.S. DRAWN: MCL DESIGN: DLH APPD: TMH

NO.	REVISION	APPD:	DATE:
A	ISSUED FOR REVIEW	TMH	07/31/13

TITLE: **GENERATOR LEAD STRUCTURES #1 - #6 EXHIBIT**

PROJECT: **BINGHAM WIND PROJECT SOMERSET COUNTY, MAINE**

CLIENT: **BLUE SKY WEST II, LLC**
129 MIDDLE ST., 3RD FLOOR, PORTLAND, ME 04101

SGC PROJECT NUMBER 782001
DRAWING NUMBER 782-13-1300
REVISION A
SHEET NUMBER 1 OF 1