

EXPERIMENTAL LEASE APPLICATION

1. APPLICANT CONTACT INFORMATION

Applicant	Victor A. Sokoloski
Contact Person	Victor A. Sokoloski
Address	25 Martin Terrace
City	Milbridge, ME
State, Zip	ME, 04658
County	Washington
Telephone	207-598-8942
Email	mainekelp@gmail.com
Payment Type	<input checked="" type="checkbox"/> Check (included) <input type="checkbox"/> Credit Card

Note: The email address you list here will be the primary means by which we will contact you. Please provide an email address checked regularly. If you do not use email, please leave this blank.

2. PROPOSED LEASE SITE INFORMATION

Location of Proposed Lease Site	
Town	Steuben
Waterbody	Pigeon Hill Bay
General Description (e.g. south of B Island)	East of Chair Pond Head
Lease Information	
Total acreage (4-acre maximum) and lease term (3-year maximum) requested	3.99-acres, 3 years
Type of culture (check all that apply)	<input type="checkbox"/> Bottom (no gear) <input checked="" type="checkbox"/> Suspended (gear in the water and/or on the bottom) <input type="checkbox"/> Net Pen (finfish)
Is any portion of the proposed lease site above mean low water?	<input type="checkbox"/> Yes <input checked="" type="checkbox"/> No

Note: If you selected yes, you need to complete the steps outlined in the section titled: "17. Landowner/Municipal Permission Requirements".

3. GROWING AREA DESIGNATION

Directions: Information for growing area designations can be found here:

<https://www.maine.gov/dmr/shellfish-sanitation-management/closures/index.html>

Growing Area Designation (e.g. "WL"):	EL
Growing Area Section (e.g. "A1"):	A

Note: If you are proposing to grow molluscan shellfish in waters classified as anything other than open/approved, you will need to contact the Bureau of Public Health to discuss you plans at the following email: DMRPublicHealthDiv@maine.gov

4. GENERAL LEASE INFORMATION

A. Please complete the table below and add additional rows as needed.

Name of species to be cultivated (include both common and scientific names):	Name and address of the source of seed stock or juveniles	Maximum number (or biomass) of organisms you anticipate on the site at any given time
1. Sugar Kelp (<i>Saccharina latissima</i>)	Atlantic Sea Farms 20 Pomerleau Street Biddeford, Maine 04005	50,000 lbs
2. Skinny Kelp (<i>Saccharina angustissima</i>)	Atlantic Sea Farms 20 Pomerleau St. Biddeford, ME 04005	50,000 lbs
3. Winged Kelp (<i>Alaria esculenta</i>)	Atlantic Sea Farms 20 Pomerleau St. Biddeford, ME 04005	10,000 lbs
4. Horsetail / Fingered Kelp (<i>Laminaria digitata</i>)	Atlantic Sea Farms 20 Pomerleau St. Biddeford, ME 04005	10,000 lbs
5. Shotgun Kelp (<i>Agarum clathratum</i>)	Atlantic Sea Farms 20 Pomerleau St. Biddeford, ME 04005	10,000 lbs
6. Dulse (<i>Palmaria palmata</i>)	Atlantic Sea Farms 20 Pomerleau St. Biddeford, ME 04005	5,000 lbs
7. Irish Moss (<i>Chondrus crispus</i>)	Atlantic Sea Farms 20 Pomerleau St. Biddeford, ME 04005	5,000 lbs

8. Sea Lettuce (<i>Ulva lactuca</i>)	Atlantic Sea Farms 20 Pomerleau St. Biddeford, ME 04005	5,000 lbs
--	---	-----------

B. Do you intend to possess, transport, or sell whole or roe-on scallops? Yes No

If you answered “yes” please contact the Bureau of Public Health to discuss your plans at the following email: DMRPublicHealthDiv@maine.gov

Note: If you are proposing to grow molluscan shellfish, this application also serves as your written operational plan as required in the National Shellfish Sanitation Program (NSSP) Model Ordinance Chapter 2, and must be maintained in your files. If you wish to submit an operational plan separate from this application, please contact: DMRPublicHealthDiv@maine.gov

5. VICINITY MAP

Note: You may embed the maps within the document, or attach the maps to the end of your application. If you attach the maps, please label them according to the instructions provided below. If you attach the map, please label it: 'Vicinity Map'.

Directions: Using a NOAA Chart or USGS topographic map, show the area within a minimum of one-half mile of the proposed lease site.

The map needs to display the following:

- The waters, shore lands, and lines of mean high and mean low water within the general area of the lease
- An arrow indicating true north
- A scalebar
- The approximate lease boundaries

6. BOUNDARY DRAWING

Note: If you attach a drawing, please label it 'Boundary Drawing'.

Directions: Depict the boundaries of the proposed lease site. Provide a drawing with all corners, directions, and distances labeled. Provide coordinates for each corner as follows:

- Coordinate Description
Provide geographic coordinates for each corner of the lease site in latitude and longitude as accurately as possible (e.g., to the nearest second or fraction of a second). Identify the datum from the map, chart, or GPS unit used to develop these coordinates. The datum will be shown on the map or chart you are using. The Coordinate Description may be provided separately from the Boundary Drawing.

7. RESEARCH PROGRAM AND OPERATIONS

Directions: If you are cultivating more than one species, you will need to provide the below information for each species. Please attach a separate page if needed.

A. Type of study (**check one**): Scientific Research Commercial Research

Please note:

a) Product grown on experimental leases for scientific research cannot be sold. Results of scientific research are not kept confidential.

b) Experimental leases for commercial research are not renewable. Results of commercial research are kept confidential.

B. What is the purpose of the study? If scientific, please include a detailed study design.

The purpose of this study is to test the viability of a commercial seaweed farm at the proposed site.

C. Describe the general culture process for each species proposed.

Marine algae, based on demand, will be seeded onto 1,000 ft horizontal culture lines. Depending on availability and water temperatures, seeding will take place between mid-October and early December. The site will be regularly tended to ensure that gear is maintained and to monitor growth of seaweed. Timing of harvest will be dependent on water temperatures and growth rates, but will likely occur between late-April and mid-June. Marine algae will be hauled onto our lobster boat and cut from longlines, using a small knife, and collected in 1,000 lb salt bags on deck. At the time of harvest all longlines and depth control devices will be removed, cleaned, and stored on my personal private property until mid-October. All gear, except for mooring and required lease markers will be removed from the site from June 15th - October 15th.

D. What months will the proposed activities (i.e. seeding, tending, and harvesting) occur?

Seeding: mid-October to early December (depending on water temperature and seed availability)

Tending: roughly November - April (from seeding - harvest)

Harvest: late April and mid-June (depending on water temperature and observed growth)

E. How often will you be at the site during seeding and harvesting periods?

We will need to be onsite for 2-4 days during seeding and approximately 10 days during harvest. These days will not necessarily be consecutive.

F. How frequently will you visit/tend the site for routine maintenance (i.e. flipping cages, etc.)?

We plan to visit the site weekly (dependent on weather) to maintain gear, check for equipment issues, and monitor growth. At a minimum the site will be visited every other week and after any major storm event.

G. Describe the harvesting techniques you will use. If you plan on using a drag, please provide the dimensions.

Marine algae will be hauled onto my lobster boat using either a trap hauler or a mast and boom, cut from the long line using a small knife, and harvested into 1,000lb salt bags on the deck. As seaweed is harvested all longlines will be removed from the water, along with any associated depth control devices, and stored onshore until next season.

H. Describe any overwintering or "off season" plans for the site. For example, will you remove gear from the site and/or deploy gear in different areas within the proposed site? Please include where gear or product will be located if moved from the site.

During the offseason, June 16th - October 14th, all gear and equipment, except for moorings and required lease marker buoys, will be removed from the site, cleaned, and stored on my personal private property.

I. What type of machinery (e.g. generator, drag, grading equipment, etc.) will you be using on the site? When and how often will the machinery be used?

No machinery, other than a lobster boat and skiff, will be used at the site. During harvest season, a trap hauler or a mast and boom on the lobster boat will be used to haul longlines.

J. Please provide details on any predator control techniques you plan to employ.

N/A

K. Suspended culture gear can attract birds that roost on the gear and defecate, potentially creating a pollution source impacting shellfish held within the gear. In order to comply with the National Shellfish Sanitation Program (NSSP) Model Ordinance (MO), DMR is requiring that applications for the suspended culture of shellfish include a description of mitigation or deterrent measures to minimize the potential pollution impacts of birds at the proposed site. If appropriate, include sketches or photos that clearly depict those measures put into practice.

Examples may include:

- Submerging suspended gear and associated product at a depth sufficient to deter roosting for two weeks before harvest
- Attaching physical deterrents (i.e. zip ties) to gear
- The site is proposed for the culture of seed only
- The site is proposed for the culture of adductor-only scallops (i.e. no other shellfish species would be grown on the site)
- Proposed gear would always be suspended below the surface of the water at a depth sufficient to deter roosting (i.e. as is common for scallop lantern nets)

N/A

8. EXISTING USES

Directions: Describe the existing uses of the proposed area. Please include the amount of activity, the time of year the activity occurs, frequency, and proximity to the lease site.

<p>A. Describe the existing uses of the proposed area in questions A.1 through A.5 below. Please include the a) type b) time of year c) frequency, and d) proximity to the lease site for each existing use.</p>
<p>1. Commercial Fishing</p> <p>Lobster fishing is rare on the proposed site during the summer and does not occur during the time that the farm would be in the water (Oct.15 - Jun. 15).</p>
<p>2. Recreational Fishing</p> <p>None.</p>
<p>3. Boating Activities (please also include the distance to any navigable channel(s) from your proposed site at low water)</p> <p>Boating is uncommon in the proposed area other than for transit is rare during the summer and very rare during the time the farm would be in the water (Oct.15 - Jun. 15).</p>
<p>4. Ingress and egress (i.e. coming and going) of shorefront property owners within 1,000 feet of the proposal (e.g. docks, moorings, landing boats on shore, etc.)</p> <p>N/A</p>
<p>5. Other uses (kayaking, swimming, etc.)</p> <p>N/A</p>
<p>B. Are there private docks, moorings, or other access points within 1,000 feet of the proposed lease? If yes, please include approximate distance from proposed lease.</p> <p>No.</p>

C. Are there public beaches, parks, or docking facilities within 1,000 feet of the proposed lease site. If yes, please describe and include approximate distances from proposed lease.

The proposed site is located approximately 770 ft offshore from the Maine Coastal Islands National Wildlife Refuge.

D. Are there any Limited Purpose Aquaculture (LPA) licenses or aquaculture leases within 1,000 feet of your proposed lease site? If yes, please list their acronyms below.

Current and pending aquaculture leases and active LPA licenses may be found here: <https://www.maine.gov/dmr/aquaculture/leases/index.html>

No, there are currently no aquaculture leases within 1,000 feet of the proposed lease site. However, I am applying for a second experimental site that will be located 100 ft to the east of the proposed site. Additionally, applicant Randy Pinkham is submitting two concurrent applications for proposed experimental leases in the area. One of Randy's sites will be located 100 feet to the South of the proposed site and the other will be approximately 140ft to the southeast of the proposed site. The proposed lease sites will not interfere with each other.

9. CURRENT OPERATIONS

Directions: If a question does not pertain to your proposed operations, please write “not applicable” or “N/A.”

A. Describe your existing aquaculture operations, including the acronyms of all active leases and/or licenses.

N/A

B. What are your plans for any existing leases and/or Limited Purposed Aquaculture (LPA) licenses if the lease is granted? Will any existing leases and/or Limited Purpose Aquaculture (LPA) licenses be relinquished if the lease is granted? If so, please indicate which ones.

N/A

10. EXCLUSIVE USE

If your lease is granted, what activities would you request be excluded from occurring within the boundaries of the lease site? In your answer please address applicable commercial and recreational fishing, boating activities, and other activities you listed in the 'Existing Uses' section of this application.

If the proposed lease is granted, I'd request that when longlines are in place (generally, October 15th - June 15th) that fixed gear, dragging, and boating activity be excluded from the site to ensure navigational safety for all people on the water and to prevent gear from being damaged and becoming marine debris. For the remainder of the year (June 16th - October 14th) we'd welcome activity at the site that would not interfere with moorings.

11. ENVIRONMENTAL CHARACTERIZATION

Directions: Using your knowledge of the area, describe the environment of the proposed lease site. Be sure to include units of measurement in your answers (i.e. feet, cm/s).

A. What are the approximate depths at mean low water?

20-23 ft

B. What are the approximate depths at mean high water?

31-34 ft

C. Provide the approximate current speed and direction during the ebb and flow.

Current speed shouldn't exceed 1 knot and flows South on ebb and North on the flood.

D. The following questions (D.1 through D.6) may be answered in writing or by submitting a video. If you plan to submit a video, please contact the Department prior to video collection.

1. What are the bottom characteristics (mud, sand, gravel, rock, ledge or some mix, etc.)?

Mud

2. Describe the bottom topography (flat, steep rough, etc.).

Mostly flat with a slight incline from North to South.

3. Describe marine organisms by species or common names. Based on your personal observations or other sources of information, are these species abundant, common, or rare?

Lobster and crab are rare in the area of the proposed site.

4. Are there shellfish beds or fish migration routes in the surrounding area? If so, please describe.

No.

5. Describe the presence and extent of submerged aquatic vegetation, i.e. eelgrass, within the proposed lease area. Please include the date of this observation along with the method of observation. If submerged aquatic vegetation is observed, please also describe the abundance below and sketch the limits of the beds in the vicinity map.

Based on data collected in 2010, the proposed lease is outside of the eelgrass zone. The nearest beds mapped during this study are over 1,000 ft from the proposed site. Eelgrass beds are generally observed in shallow waters which allow for adequate light penetration to support photosynthesis. The proposed site is in a water depth between 20ft (MLW) and 31ft (MHW) which is not ideal habitat for eelgrass.

6. Describe the general shoreline and upland characteristics (rocky shoreline, forested, residential, etc.)

The nearest shoreline is rocky giving way to a forested preserve.

E. Is your proposed lease located within a Maine Department of Inland Fisheries and Wildlife designated Essential Habitat?

Yes No

Note: The location of Essential Habitats in the State of Maine, along with information on how projects within these areas are reviewed, can be found here: <https://www.maine.gov/ifw/fish-wildlife/wildlife/endangered-threatened-species/essential-wildlife-habitat/index.html>

If a project is located within an Essential Habitat, applicants are strongly encouraged to contact the MDIFW Environmental Review Coordinator (John.Perry@maine.gov, phone: 207-287-5254) prior to application submission.

F. Will your operations discharge anything into the water such as feed (pellets, kelp, etc.) or chemical additives (therapeutants, chemical treatments, etc.)?

Yes No

Note: If you answered yes, you must submit a video of the bottom using a method prescribed by the Department. **The video must be filmed between April 1 and November 15.** If a discharge is proposed you will also need to obtain a Maine Department of Environmental Protection (DEP) discharge permit. For information on this permit please contact DEP's Wastewater Licensing Program (Gregg.wood@maine.gov, 207-287-7693). Further sampling may be required by DMR, or DEP, depending on the characteristics of the site or the proposed activities.

12. STRUCTURES (if applicable)

If your operations require the use of cages, nets, ropes, trays, or any object (structure) other than the organism to be grown directly on the bottom or buoys to mark the corners of the lease site, you must submit an **Overhead View** and **Cross-Section View** of your gear plans. It is important to note that, unlike Limited Purpose Aquaculture (LPA) Licenses, experimental and standard leases require that all gear, including moorings, must be located within the proposed lease boundaries.

Note: You may embed the gear plans, or attach them to the end of your application. If you attach the plans, please label them according to the instructions provided below.

A) **Overhead View** (please label this "Overhead View"):

Directions: All dimensions need to be labeled with the appropriate units (i.e. 10ft, 10in)

- Show maximum layout of gear including moorings.
- Show dimensions of entire gear layout
- Show approximate spacing between gear.
- Show lease boundaries and the location of proposed markers on all drawings.

B) **Cross-Section View** (please label this "Cross Section View"):

Directions: The cross-section view must show the following:

- The sea bottom
- Profile of gear in cross-section as it will be deployed
- Label gear with dimensions and materials
- Show mooring gear with mooring type, scope, hardware, and line type and size
- Water depth at mean high and mean low water

Note: Please include an additional Cross Section View, depicting the elements listed above, if there will be seasonal changes to gear layout (i.e. over wintering).

C) Gear Description

Directions: List and describe each individual gear type that you will use in the table below.

Specific Gear Type <i>(e.g. soft mesh bag)</i>	Dimensions <i>(e.g. 16"x20"x2")</i>	Time of year gear will be deployed <i>(e.g. Spring, Winter, etc.)</i>	Maximum amount of this gear type that will be deployed on the site <i>(i.e. 200 cages, 100 lantern nets, etc.)</i>	Species that will be grown using this gear type
Poly Longlines	1,000' long, 5/8" diameter	Seasonal: Oct. 15 - Jun. 15	15	Marine Algae
Mooring Ball - A3 or A4 buoy	17"-21.5" diameter	Seasonal: Oct. 15 - Jun. 15	16	Marine Algae
Required Lease Marker - yellow low drag buoy	16" diameter	Year round	6	Marine Algae
Nylon Mooring Line	~40' long, 1" diameter	Seasonal: Oct. 15 - Jun. 15 (except for year round gear associated with required lease markers)	22	Marine Algae
Mooring Chain	2-5' long, 1/2" diameter	Seasonal: Oct. 15 - Jun. 15(except for year round gear associated with required lease markers)	22	Marine Algae
Mooring - Concrete Block	1,000-1,200 lbs, 3'x3'x1'	Year round	22	Marine Algae
Crosslines	140' long x 5/8" diameter	Seasonal: Oct. 15 - Jun. 15	5	Marine Algae
Foam buoy - traditional lobster buoy (for depth control line)	7"x14"	Seasonal: Oct. 15 - Jun. 15	135	Marine Algae
PVC Pipe (for depth control line)	7' long, 1/2" diameter	Seasonal: Oct. 15 - Jun. 15	135	Marine Algae

Counter weight (for depth control line)	~10 lbs	Seasonal: Oct. 15 - Jun. 15	135	Marine Algae
---	---------	--------------------------------	-----	--------------

D) Gear Drawing (please label this “Gear Drawing”).

Directions: Include a drawing of an individual piece of gear for each of the gear type(s) you plan to use. The drawing(s) needs to depict the length, width, and height of each gear type with appropriate units referenced (i.e. 10in, 10ft, etc.).

13. MARKING

Will you be able to mark your site in accordance with DMR regulations, Chapter 2.80? In part, this requires marker buoys which clearly display the lease ID and the words SEA FARM to be located at each corner of the lease. Effective January 1, 2023, marker buoys must be yellow and host reflective material.

Yes No

If you answered no, explain why and suggest alternate markings.

Note: If a lease is granted, you will also be required to mark the site in accordance with appropriate US Coast Guard Regulations. If you have questions about US Coast Guard regulations contact: 1st Coast Guard District, Aids to Navigation Office.

14. RIPARIAN LANDOWNERS AND SITE ACCESS

A. If your lease is within 1,000ft of shorefront land (**which extends to mean low water or 1,650 ft. from shore, whichever is less, according to NOAA charts**), the following supporting documents are required:

1. A labeled copy of a tax map(s) depicting the location of the proposed lease site and including the following elements:
 - Label the map “Tax Map: Town of (name of town).”
 - Legible scale
 - Tax lot numbers clearly displayed
 - The boundaries of the proposed lease

2. Please use the Riparian Landowner List (included on the next page) to list the name and address of every shorefront landowner within 1,000ft of the proposed lease site. Have the tax collector or clerk of the municipality certify the list. Refer to the riparian determination guidance document to ensure all riparian landowners are included:
<https://www.maine.gov/dmr/aquaculture/forms/documents/RiparianDetermination.pdf>

Note: When the application and riparian list are both ready to be submitted, you may choose to email a copy of the riparian list and proposed lease coordinates to DMRAquaculture@maine.gov for staff to verify that all required parcels are included on the list *before* having it certified by the municipality. DMR will not verify a riparian list multiple times, so please ensure there will be no additional changes to the application before emailing the riparian list for verification.

3.If any portion of the site is intertidal you need to complete the steps outlined in “17. Landowner/Municipal Permission Requirements”.

B. Will your access to the lease area be across riparian land?

Yes No

Note: If you selected yes, you will need to complete the landowner permission requirements included in “17. Landowner/Municipal Permission Requirements” of this application.

C. How will you access the proposed site?

The site will be accessed by a lobster boat or skiff from my private dock in Steuben, ME.

RIPARIAN LANDOWNER LIST

*THIS LIST MUST BE **CERTIFIED** BY THE TOWN CLERK*

On this list, please include the map number, lot number, and the current owners' names and mailing addresses for all shorefront parcels within 1,000 feet of the lease site. It is the applicant's responsibility to assemble the information for the Town Clerk to certify. The Town Clerk only certifies that the information is correct according to the Town's records. Once you have completed the form, ask the Town Clerk to complete the certification section below. If riparian parcels are located within more than one municipality, provide a separate, tax map and certified riparian list for each municipality.

TOWN OF: _____

MAP #	LOT #	Landowner name(s) and address(es)
003	N/A	Petit Manan National Wildlife Refuge % Maine Coastal Islands National Wildlife Refuge Complex Milbridge, ME 04658

Please use additional sheets if necessary and attach hereto.

CERTIFICATION

I, _____, Town Clerk for the Town of _____ certify that the names and addresses of the property owners listed above, as well as the map and lot numbers, are those listed in the records of this municipality and are current as of this date.

SIGNED: _____ **DATE:** _____

15. ESCROW ACCOUNT OR PERFORMANCE BOND

Check the category that describes your operation:

Check Here	Lease Category	Amount of Required Escrow or Performance Bond
<input type="checkbox"/>	No gear/structure, no discharge	None
<input type="checkbox"/>	No gear/structure, discharge	\$500.00
<input type="checkbox"/>	≤ 400 square feet of gear/structure, no discharge	\$1,500.00
<input checked="" type="checkbox"/>	>400 square feet of gear/structure, no discharge	\$5,000.00*
<input type="checkbox"/>	Gear/Structure, discharge	\$25,000.00

*DMR may increase the bond/escrow requirements for leases with more than 2,000 feet of structure.

I, (printed name of applicant) Victor A Schodoski have read DMR Aquaculture Regulations 2.64(12)(B)) and if this proposed lease is granted by DMR I will either open an escrow account or obtain a performance bond, depending on the category of lease.

Applicant Signature

1/15/23
Date

Note: Add title if signing on behalf of a corporate applicant.

ADDITIONAL APPLICANTS: Each applicant must sign this section indicating that they will open an escrow account or obtain a performance bond. Use the space below for additional persons listed on the application. You may attach additional pages, if necessary.

I, (printed name of applicant) _____ have read DMR Aquaculture Regulations 2.64(10)(D) and if this proposed lease is granted by DMR I will either open an escrow account or obtain a performance bond, depending on the category of lease.

Applicant Signature

Date

Note: Add title if signing on behalf of a corporate applicant.

16. APPLICANT SIGNATURE PAGE

I hereby state that the information included in this application is true and correct. I have also read and understand the requirements of the Department's rules governing aquaculture and the application instructions pertaining to the experimental lease process.

Printed name: Victor A Scholasti

Title (if corporate applicant): _____

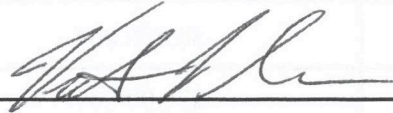
Signature:  Date: 11/15/23

18 U.S.C. Section 1001 provides that: Whoever, in any manner within the jurisdiction of any department or agency of the United States knowingly and willfully falsifies, conceals, or covers up any trick, scheme, or disguises a material fact or makes any false, fictitious or fraudulent statements or representations or makes or uses any false writing or document knowing same to contain any false, fictitious or fraudulent statements or entry, shall be fined not more than \$10,000 or imprisoned not more than five years or both.

Note:

- All applicants must sign and date this page. Please use the space below, if additional signatures are required.
- Corporate applicants, please be sure to include the title (i.e. President, Treasurer, etc.) of the individual(s) signing on the company's behalf.

17. LANDOWNER/MUNCIPAL PERMISSION REQUIREMENTS (if applicable)

PART I: The use of private property to access your site.

Pursuant to 2.64(C)(6) if you are using private property to access the proposed lease site, you need to submit written permission from the property owner with your application. It is your responsibility to obtain written permission. Please note that the Department does not provide forms for landowner or municipal permission. **If any portion of your site is also intertidal you will need to complete the steps outlined in Part II, below.**

PART II: If any portion of the site is intertidal you need to complete the following steps:

Step I: Obtain written permission from all intertidal landowners.

Pursuant to 2.64(C)(6) the Department requires *written permission of every owner of intertidal land in, on, or over which the experimental activity will occur.* It is your responsibility to obtain written permission and include it with your application materials. Please note that the Department does not provide forms for landowner permission.

Step II: Determine if the municipality where your site is located has a shellfish conservation program.

Pursuant to 12 MRSA §6072(3) *In any municipality with a shellfish conservation program under section 6671, the Commissioner may not lease areas in the intertidal zone within the municipality without the consent of the municipal officers.*

If the municipality where the proposed lease site is located has a shellfish conservation program, it is your responsibility to obtain consent for the proposed lease site from the municipal officers (i.e. the selectmen or councilors of the town, or the mayor and aldermen or councilors of a city.) Consent means a majority vote of the municipal officers as recorded in a public meeting.

It is your responsibility to contact the municipality and determine if they have a shellfish conservation program. Best practices would include discussing your plans with shellfish committee members, but only the consent of municipal officers is required.

1. Does the municipality, where the proposed site is located, have a shellfish conservation program? Yes No

If you answered yes, please attach documentation from a public meeting demonstrating that a majority of municipal officers have consented to your proposal.

Figure 1. Vicinity Map - Section 5

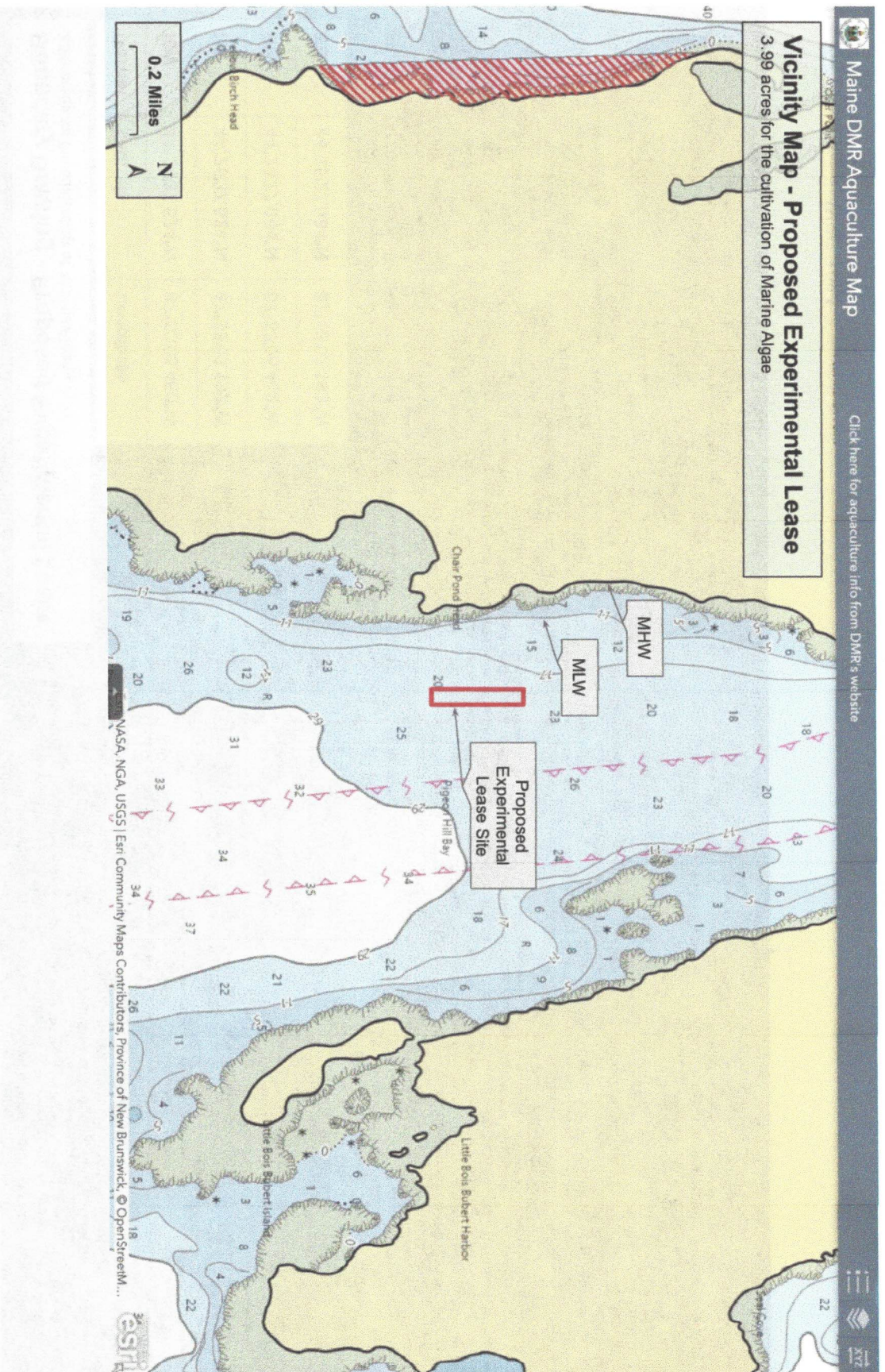
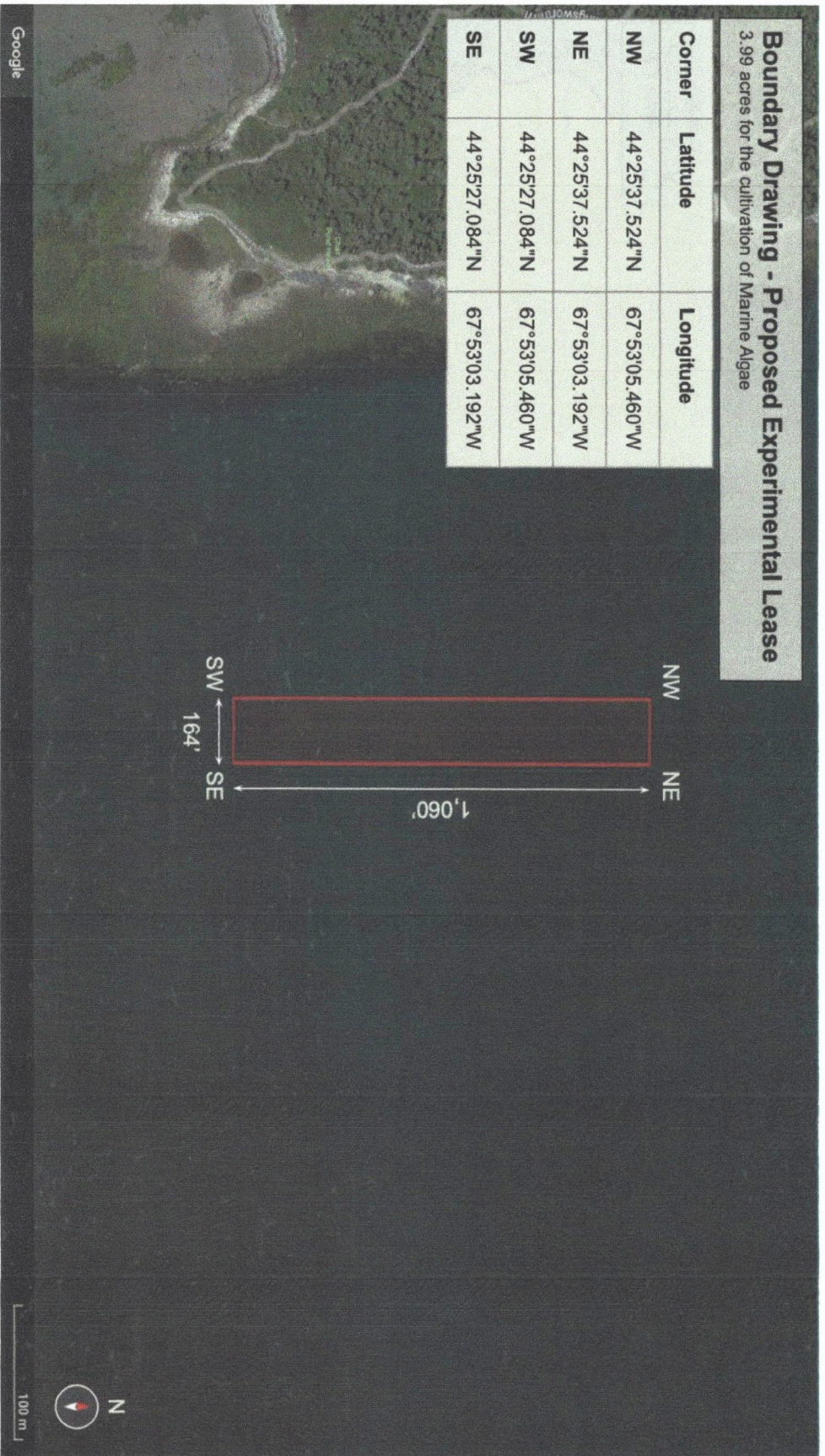

Figure 2. Boundary Drawing - Section 6



Datum Coordinates: WSG 1984

Figure 3. Overhead View, Growing Season (October 15th - June 15th) - Section 12A

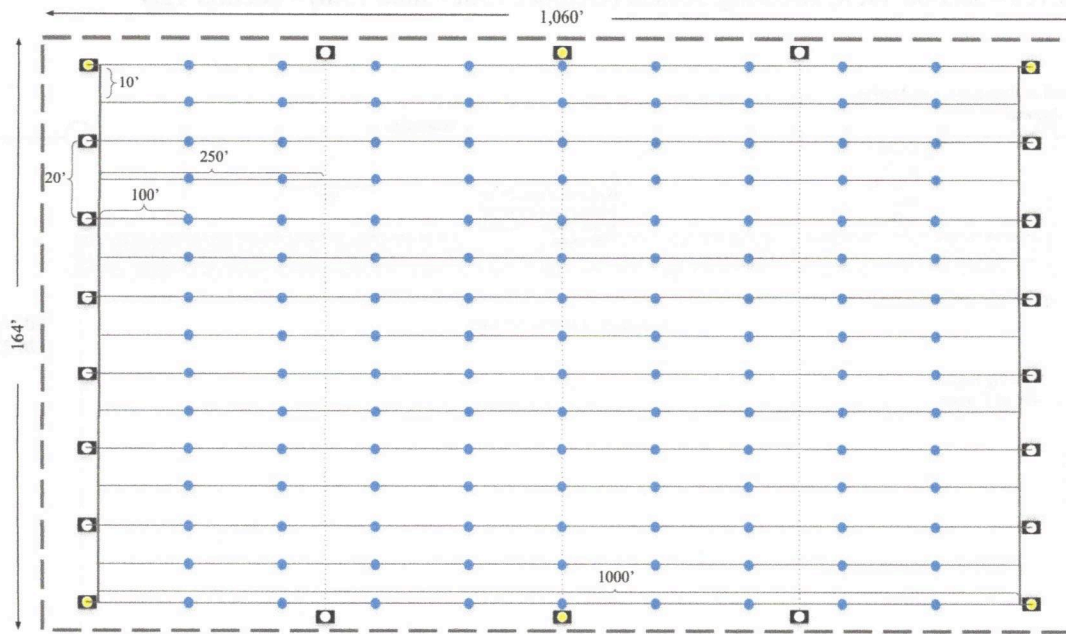

Figure 4. Overhead View, Off Season (June 16th - October 14th) - Section 12A



Legend:

Grey Dashed (---): Lease Boundary

Thin Black Line (—): Longline

Thin Black Dotted Line (.....): Internal Crosslines

Thick Black Line (———): Outer Crossline

Black Rectangles (■): Mooring

White Circles (○): Mooring Ball

Yellow Circles (●): Required Lease Marker

Blue Circles (●): Depth Control Line with buoy and weight

Figure 5. Cross-Section View, Growing Season (October 15th - June 15th) - Section 12B

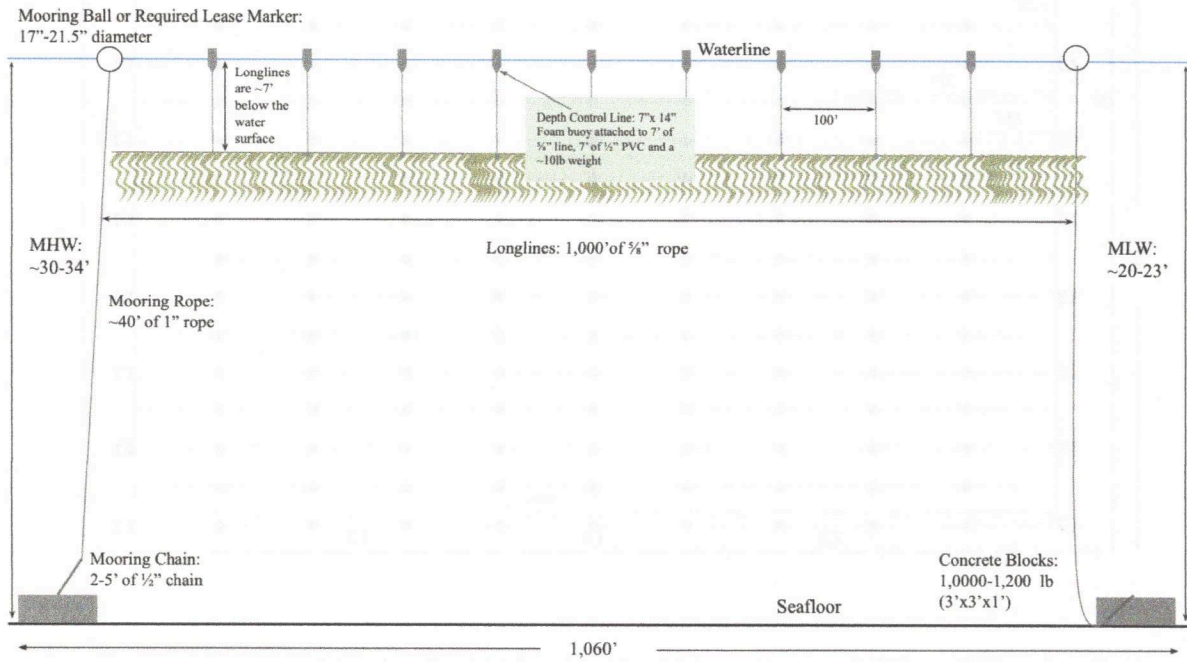

Figure 6. Cross-Section View, Off Season (June 16th - October 14th) - Section 12B

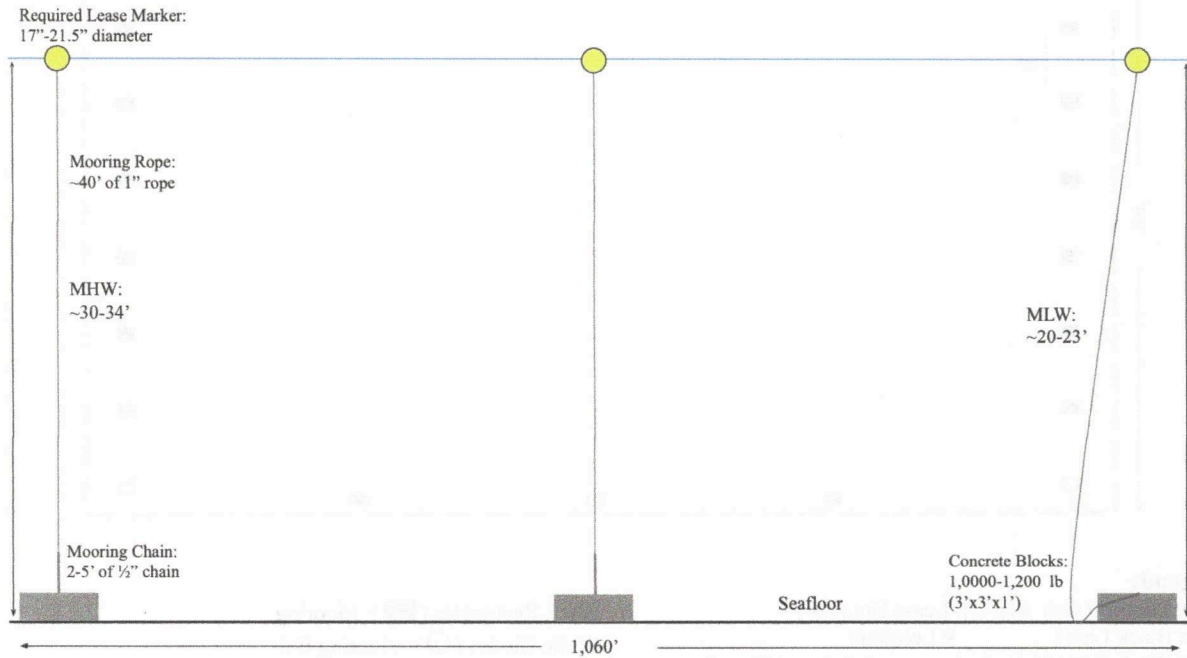

Figure 7. Gear Drawing - 12D



Longlines & Crosslines

Longlines: 1,000 ft long, 5/8-inch diameter
Crosslines: 140 ft long, 5/8-inch diameter



Mooring Ball - A3 or A4 buoy

17-inch (A3) or 21.5-inch (A4) diameter



Required Lease Marker - yellow low drag buoy

16-inch diameter



Mooring Line

~45 ft long, 1-in diameter



Mooring Chain

~2-5 ft long, 1/2-in diameter



Mooring - Concrete Block

1,000-1,200 lbs, 3ft wide x 3ft long x 1ft high



Foam buoy - traditional lobster buoy for depth control line
7" wide, 14" height



PVC Pipe - for depth control line
7' long, 1/2" diameter



Counter weight - for depth control line
~10 lbs

Figure 8. Tax Map: Town of Steuben - Section 14A

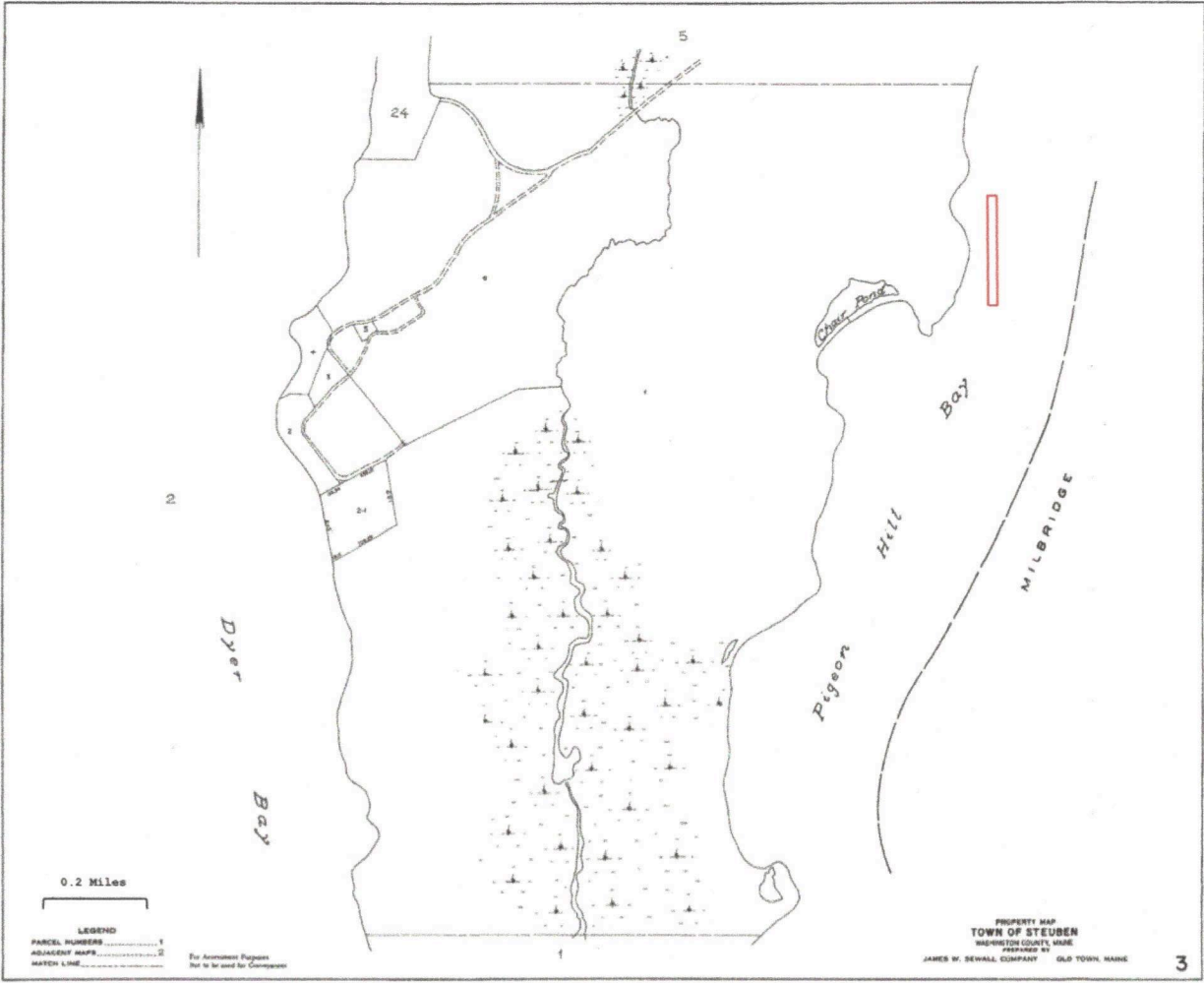

January 11, 2023

To Whom It May Concern:

I am the Harbor Master for Pigeon Hill Bay. I have looked over the area that Victor Sokoloski is proposing to grow and harvest seaweed and it will not interfere with lobstering or menhaden fishing in the bay.

A handwritten signature in blue ink that reads "Ronald Trundy Jr". The signature is written in a cursive style with a large initial "R".

Ronald Trundy Jr

11\2\22

Dear DMR Aquaculture,

I am writing to you in support of Victor Sokoloski's experimental lease application for kelp in Pigeon Hill Bay. I am a third generation lobstermen and resident. I have fished Pigeon Hill Bay for 40 years.

I recognize the importance in aquaculture for the future of costal Maine residents and as a diversification opportunity for fishing families. Kelp aquaculture is unique in that the growing When kelp lines and gear are deployed most of the lobstering gear in the area Victor is looking to use, has been moved to deeper water or taken up for the year.

Victor's proposed lease does not interfere with lobster fishing. The area that his lease is sited on is not an area that is productive to lobstering during the kelp grow out season. This area is really not used by lobster fisherman.

Victor has worked on the water all his life and is an avid diver. He has a great passion and understanding for the ocean and aquaculture. Victor has worked closely with myself and the other local lobstermen to locate his site in an area that does not interfere with lobstering in the timeframe that the area would be used for growing kelp. It is my hope that the season takes place during a time in which most of the inshore lobstering has come to an end.

Sincerely Yours,

Randy Pinkham

Randy Pinkham

11\2\22

Dear DMR Aquaculture,

I am writing to you in support of Victor Sokoloski's experimental lease application for kelp in Pigeon Hill Bay. I am a third generation lobstermen and resident. I have fished Pigeon Hill Bay all my life.

I recognize the importance in aquaculture for the future of costal Maine residents and as a diversification opportunity for fishing families. Kelp aquaculture is unique in that the growing When kelp lines and gear are deployed most of the lobstering gear in the area Victor is looking to use, has been moved to deeper water or taken up for the year.

Victor's proposed lease does not interfere with lobster fishing. The area that his lease is sited on is not an area that is productive to lobstering during the kelp grow out season. This area is really not used by lobster fisherman.

Victor has worked on the water all his life and is an avid diver. He has a great passion and understanding for the ocean and aquaculture. Victor has worked closely with myself and the other local lobstermen to locate his site in an area that does not interfere with lobstering in the timeframe that the area would be used for growing kelp. It is my hope that the season takes place during a time in which most of the inshore lobstering has come to an end.

Sincerely Yours,

A handwritten signature in black ink, appearing to read 'Todd Pinkham', with a long, sweeping flourish extending to the right.

Todd Pinkham