

AUGUSTA STATE AIRPORT

AIRPORT MASTER PLAN UPDATE

PROJECT # 38673

MARCH 2008

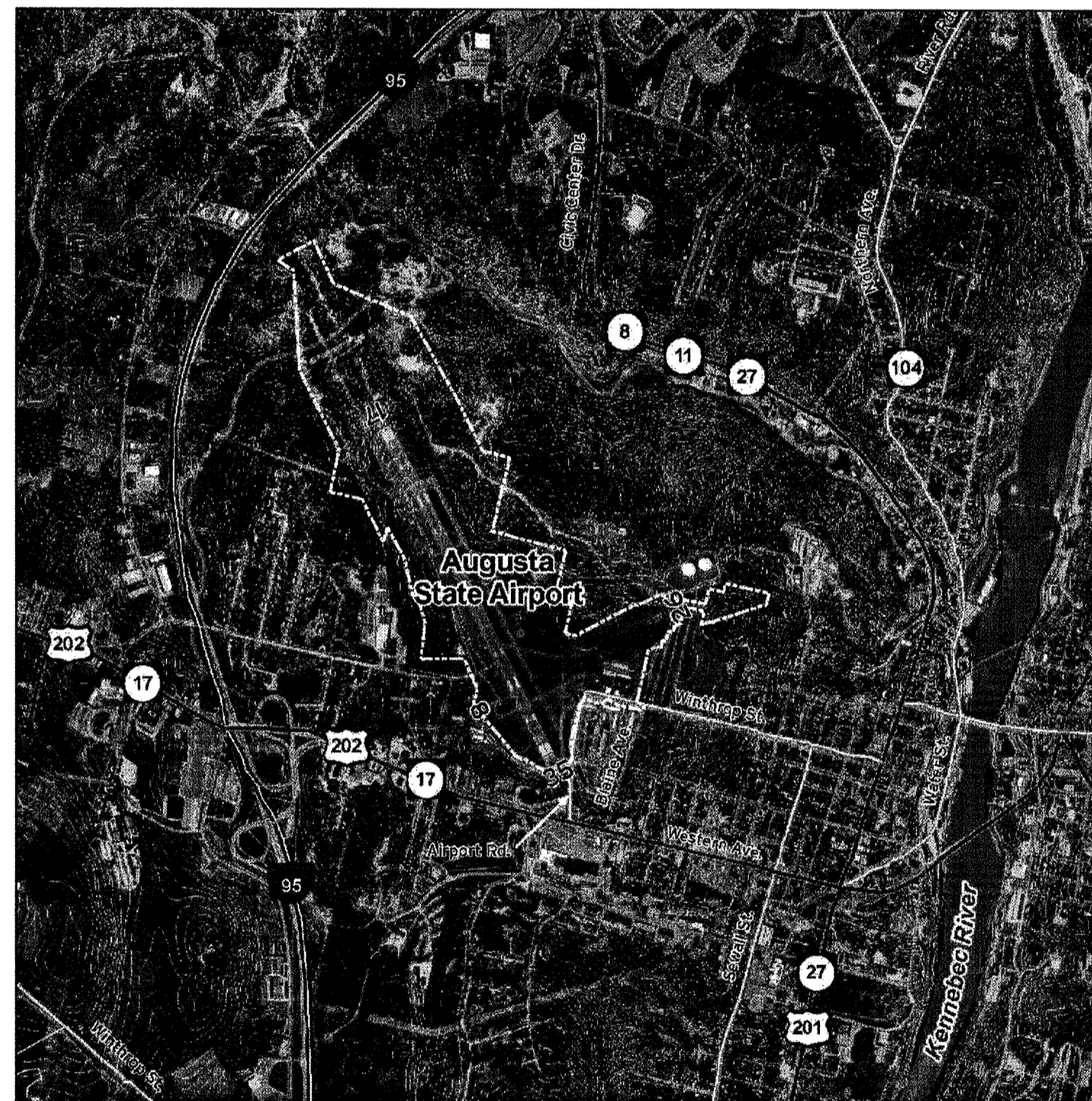

| Airport Layout Plan Sheet List | |
|--------------------------------|-------------------------------------|
| 1 | TITLE SHEET |
| 2 | EXISTING AIRPORT LAYOUT |
| 3 | 2025 AIRPORT LAYOUT PLAN |
| 4 | DATA SHEET |
| 5 | TERMINAL AREA DRAWING |
| 6 | PART 77 - FULL AIRSPACE DRAWING |
| 7 | PART 77 - CONICAL SURFACE DRAWING |
| 8 | RUNWAY 17-35 APPROACH AND PROFILES |
| 9 | RUNWAY 8-26 APPROACH AND PROFILES |
| 10 | 2025 NOISE CONTOUR/OFF-APT LAND USE |
| 11 | PAVEMENT HISTORY PLAN |

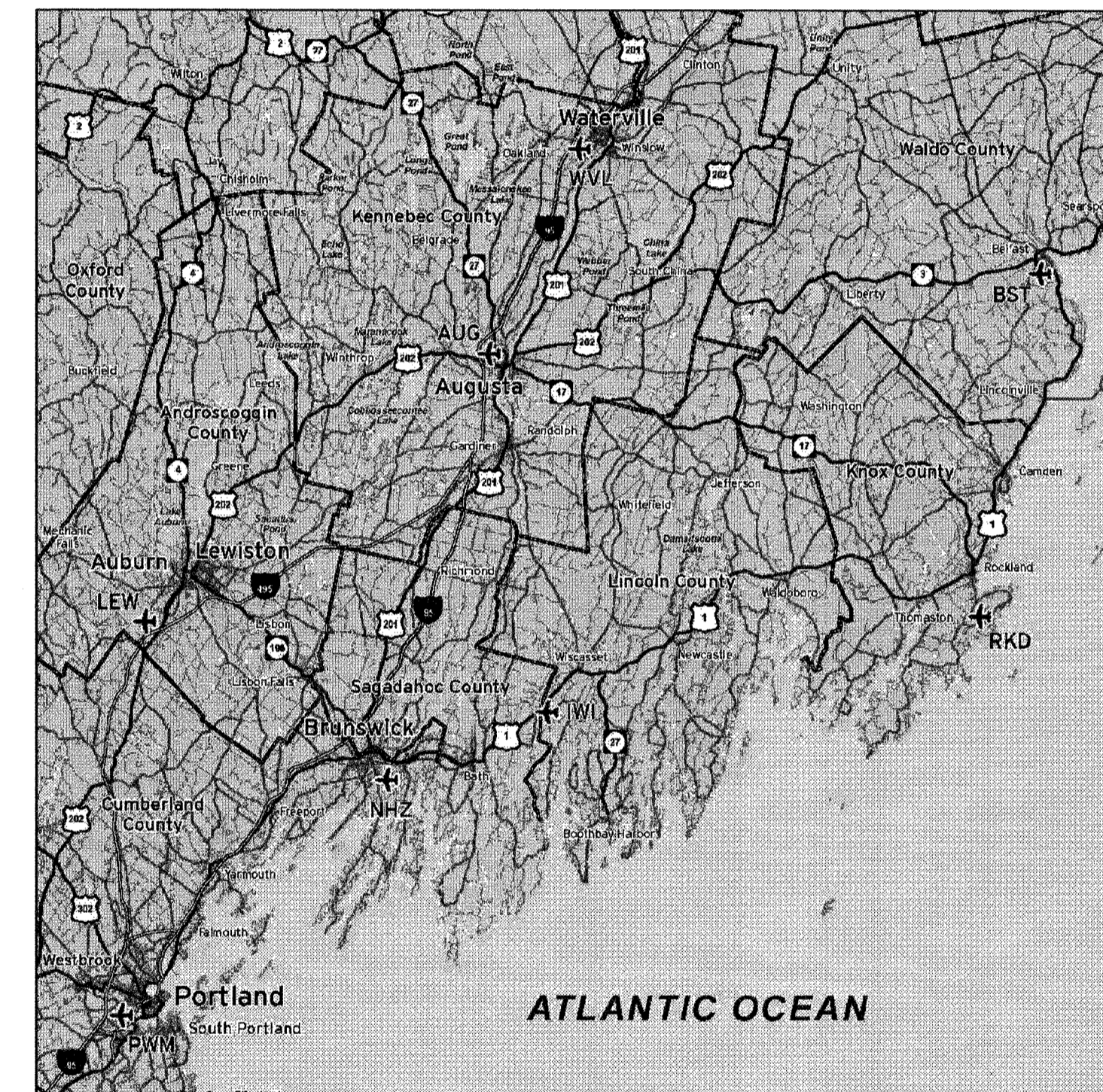

P:\Projects\38673 Augusta MP\plans\AUG ALP 2007\Sheet_01_Cover_Sheet.dwg SI Mar. 20, 2008 - 3:42pm

| | |
|------------------------------|--|
| AUGUSTA STATE AIRPORT | |
| APPROVED |  <small>MAINE DEPARTMENT OF TRANSPORTATION</small> |
| | DATE |
| APPROVED | <hr/> <small>AIRPORT MANAGER</small> |
| | DATE |

FAA'S APPROVAL OF THIS AIRPORT LAYOUT PLAN (ALP) REPRESENTS ACCEPTANCE OF THE GENERAL LOCATION OF FUTURE FACILITIES DEPICTED. IT DOES NOT REPRESENT A COMMITMENT BY FAA TO PROVIDE FINANCIAL ASSISTANCE TO IMPLEMENT THE PROPOSED PLAN. DURING THE PRELIMINARY DESIGN PHASE, THE AIRPORT OWNER IS REQUIRED TO RESUBMIT FOR APPROVAL OF THE FINAL LOCATIONS, HEIGHTS AND EXTERIOR FINISHES OF STRUCTURES. FAA'S CONCERNS ARE OBSTRUCTIONS, IMPACT ON ELECTRONIC AIDS AND ADVERSE EFFECTS OF CONTROLLER VIEW OF AIRCRAFT APPROACHES AND GROUND MOVEMENTS, WHICH COULD ADVERSELY AFFECT THE SAFETY, EFFICIENCY OR UTILITY OF THE AIRPORT.

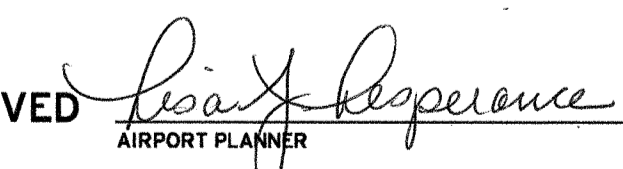
| | |
|--|---|
| FEDERAL AVIATION ADMINISTRATION | |
| APPROVED |  <small>AIRPORT PLANNER</small> |
| | 9/9/08 DATE |

AUGUSTA STATE AIRPORT MASTER PLAN UPDATE: GRANT#: 015 2005



| NO. | BY | DATE | REVISIONS |
|-----|----|------|-----------|
| | | | |
| | | | |
| | | | |
| | | | |

| APPROVED |
|----------|
| |



2900 SOUTH QUINCY STREET,
SUITE 200
ARLINGTON, VIRGINIA 22206
PH (703) 824-5100
FAX (703) 671-6210

| |
|---|
| TITLE SHEET |
| AUGUSTA STATE AIRPORT AUGUSTA, MAINE |

| |
|-----------------------|
| DATE: Mar 20, 2008 |
| FIGURE 1 |

| LEGEND | |
|--------------------------------|-------------|
| | EXISTING |
| Object Free Area | --- OFA --- |
| Runway Safety Area | --- RSA --- |
| Object Free Zone | --- OFZ --- |
| Roads/Landside Pavement | ===== |
| Airfield Pavement | ===== |
| Runway Protection Zone | ===== |
| On-Airport Property Buildings | □ |
| Buildings to be Demolished | □ N/A |
| Off-Airport Property Buildings | □ |
| Property Line | - - - - - |
| Fence Line | - x - - - |
| Wetlands | ▨ |

| NO. | ON-AIRPORT BUILDINGS |
|-----|--------------------------------------|
| 1 | TERMINAL |
| 2 | FBO/MAINE INSTRUMENT FLIGHT |
| 3 | FBO MAINTENANCE HANGAR |
| 4 | MAINTENANCE GARAGE / OFFICES - STATE |
| 5 | SAND STORAGE - STATE |
| 6 | CIVIL AIR PATROL |
| 7-9 | T-HANGARS - PUBLIC |
| 10 | VOR CONTROL BUILDING - FAA |
| 11 | SNOW REMOVAL EQUIPMENT STORAGE |

AIRPORT BOUNDARY IS FROM MOST RECENT EXHIBIT "A" AND DOES NOT MATCHUP WITH KNOWN AIRPORT INFRASTRUCTURE. AN AIRPORT BOUNDARY SURVEY AND EXHIBIT "A" UPDATE MAY BE REQUIRED.

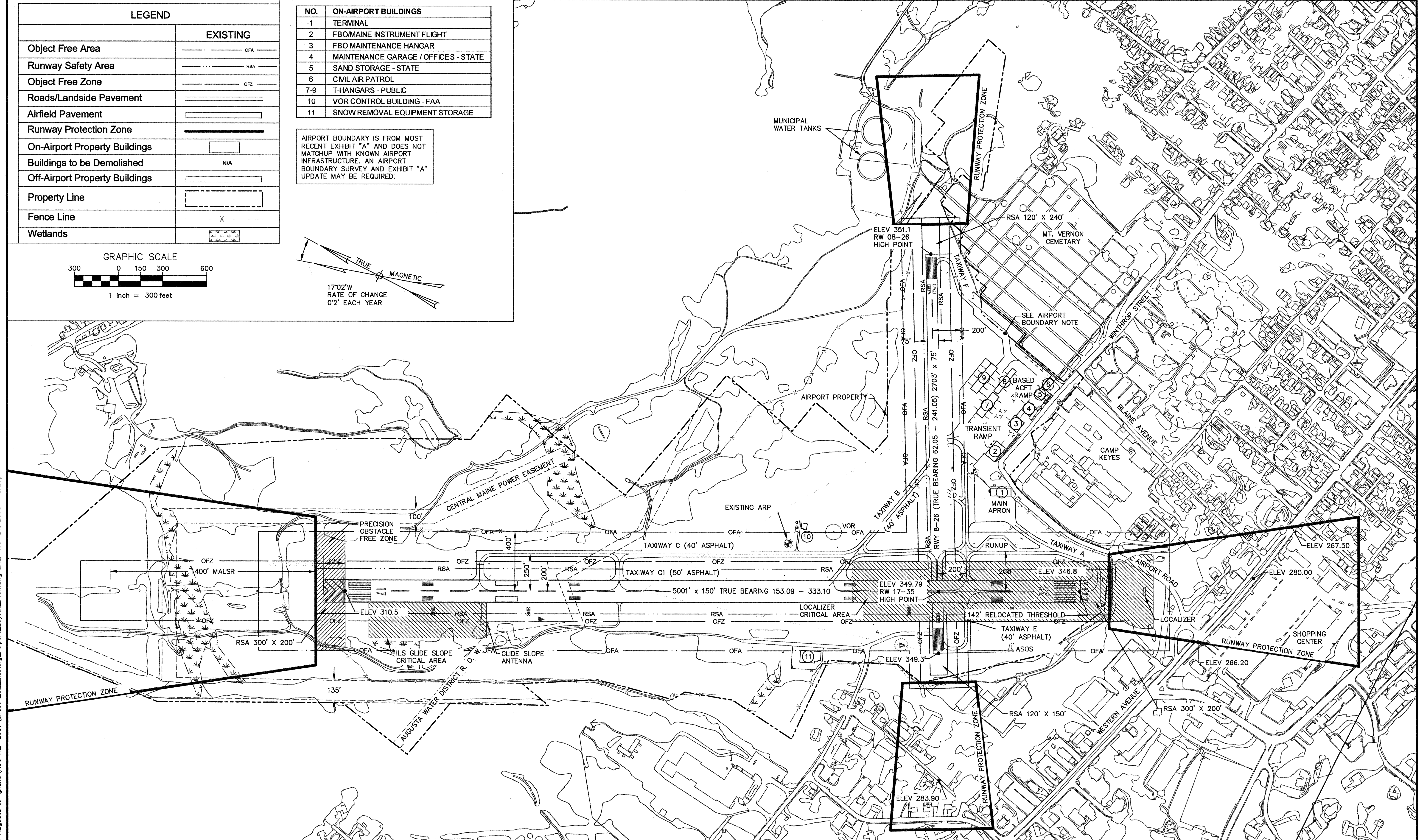
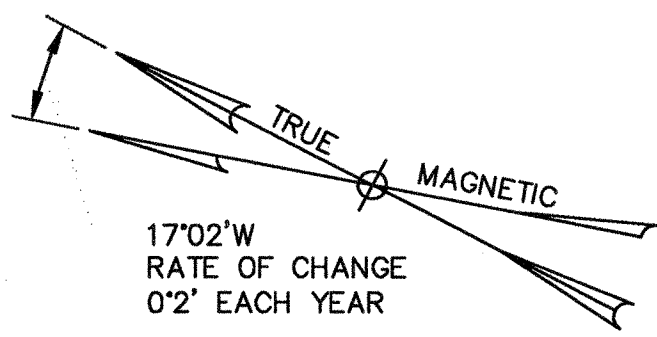
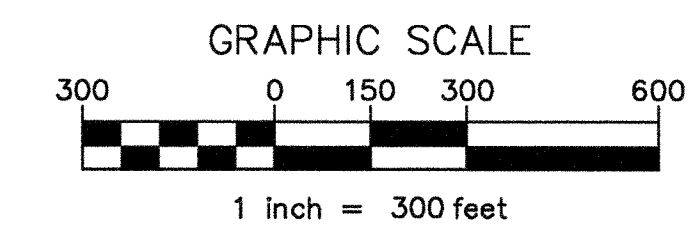

P:\Projects\38673 Augusta MP\Plans\AUG ALP 2007\Sheet_02_Existing_Airport_Layout_Plan.dwg EALP Mar 24, 2008 - 5:25pm



| NO. | BY | DATE | REVISIONS |
|-----|----|------|-----------|
| | | | |
| | | | |
| | | | |

| APPROVED |
|----------|
| |



2900 SOUTH QUINCY STREET,
SUITE 200
ARLINGTON, VIRGINIA 22206
PH (703) 824-5100
FAX (703) 671-6210

EXISTING AIRPORT LAYOUT
AUGUSTA STATE AIRPORT
AUGUSTA, MAINE

DATE:
Mar 24, 2008
FIGURE
2

| RUNWAY DATA | EXISTING | | | | PROPOSED | | | |
|-------------------------------------|-----------------------------|-----------------------------|-------------------------------|-------------------------------|-----------------------------|-----------------------------|------------------------------|-----------------------------|
| | 17 | 35 | 08 | 26 | 17 | 35 | 08 | 26 |
| LENGTH - WIDTH | 5001' x 150' | | 2703' x 75' | | 5001' x 180' | | 2613' x 75' | |
| STRENGTH (POUNDS) (a) | SW: 50,000, DW: 60,000 | | SW: 30,000 | | SW: 50,000, DW: 60,000 | | SW: 30,000 | |
| COMPOSITION | ASPHALT | | ASPHALT | | ASPHALT | | ASPHALT | |
| MARKINGS | PRECISION | | NONPRECISION | | PRECISION | | NONPRECISION | |
| LIGHTING | HIGH INTENSITY | | MEDIUM INTENSITY | | HIGH INTENSITY | | MEDIUM INTENSITY | |
| NAVAIDS | ILS, VASI, VOR, GPS | VASI, VOR, GPS | NONE | NONE | ILS, VASI, VOR, GPS | VASI, VOR, GPS | NONE | NONE |
| VISUAL AIDS | MALSR VASI (V4R) | REIL VASI (V4L) | NONE | NONE | MALSR PAPI | REIL PAPI (4PL) | PAPI (4PL) | PAPI (4PL) |
| EFFECTIVE GRADIENT | 0.73% | -0.73% | 0.08% | -0.08% | 0.73% | -0.73% | +0.09% | -0.09% |
| END ELEVATIONS | 310.5 | 346.8 | 349.3 | 351.5 | 310.5 | 346.8 | 349.7 | 351.5 |
| END COORDINATES | 44 19 39.6N 069 48 13.2W | 44 18 55.8N 069 47 42.0W | 44 19 02.13N 069 47 53.19W | 44 19 14.64N 069 47 20.35W | 44 19 39.6N 069 48 13.2W | 44 18 55.8N 069 47 42.0W | 44 19 2.54N 069 47 52.09W | 44 19 14.4N 069 47 20.4W |
| RUNWAY SAFETY AREA (WIDTH x LENGTH) | 300x200 | | 120x150/120x240 | | 300x200 w/ EMAS (b) | 300x200 w/ EMAS (b) | 120' x 240' | |
| OBJECT FREE AREA | 800' x 600' | | 400' x 240' | | 800' x 600' | | 400' x 240' | |
| DESIGN AIRCRAFT | BEECH 1900 | | BEECH KING AIR 200 | | BEECH 1900 | | PIPER NAVAJO | |
| REFERENCE CODE | B-II | | B-I | | B-II | | B-I | |
| APPROACH SURFACES | 50:1 | 34:1 | 20:1 | 20:1 | 50:1 | 34:1 | 20:1 | 20:1 |

SOURCES: FAA 5010 DATA, RUNWAY SAFETY AREA STUDY, AND VEGETATION MANAGEMENT PLAN.
 NOTES: (a) SW = SINGLE WHEEL, DW = DUAL WHEEL
 (b) STANDARD RSA OPTIONS WERE ANALYZED AND WERE NOT RECOMMENDED DUE TO HIGH COSTS AND COMMUNITY IMPACT.

| AIRPORT DATA | EXISTING | PROPOSED |
|-----------------------------|------------------------------------|------------------------------------|
| AIRPORT ELEVATION | 352' | 352' |
| AIRPORT REFERENCE POINT | 44 19 14.4N 069 47 50.4W | 44 19 14.4N 069 47 50.4W |
| DESIGN AIRCRAFT | BEECH 1900 | BEECH 1900 |
| AIRPORT REFERENCE CODE | B-II | B-II |
| MEAN MAX TEMPERATURE | 81°F | 81°F |
| TAXIWAY LIGHTING | MEDIUM INTENSITY | MEDIUM INTENSITY |
| TAXIWAY MARKINGS | CENTERLINE, EDGE | CENTERLINE, EDGE |
| TERMINAL NAVAIDS | ILS, VOR/DME | ILS, VOR/DME |
| VISUAL NAVAIDS | MALSR, REIL, VASI, ROTATING BEACON | MALSR, REIL, PAPI, ROTATING BEACON |
| ACREAGE OWNED IN FEE SIMPLE | 315.3 | 315.3 |
| FUEL AVAILABILITY | 100LL - JET A | 100LL - JET A |
| USE/OWNERSHIP | PUBLIC/PUBLIC | PUBLIC/PUBLIC |

| NO. | ON-AIRPORT BUILDINGS |
|-----|--------------------------------------|
| 1 | TERMINAL |
| 2 | FBO/MAINE INSTRUMENT FLIGHT |
| 3 | FBO MAINTENANCE HANGAR |
| 4 | MAINTENANCE GARAGE / OFFICES - STATE |
| 5 | SAND STORAGE - STATE |
| 6 | CIVIL AIR PATROL |
| 7-9 | T-HANGARS - PUBLIC |
| 10 | VOR CONTROL BUILDING - FAA |
| 11 | SNOW REMOVAL EQUIPMENT STORAGE |

EMAS SPECIFICATIONS

| RUNWAY END | PAD WIDTH | PAD LENGTH | PERFORMANCE ESTIMATE |
|------------|-----------|------------|--|
| 17 | 121.5 | 165 | BEECH 1900 (MTOW 16,600 LBS): 45 KNOTS, SAAB 340 (MTOW 30,000 LBS): 51 KNOTS |
| 35 | 121.5 | 165 | |

SOURCE: ESCO (ENGINEERED ARRESTING SYSTEMS CORPORATION)

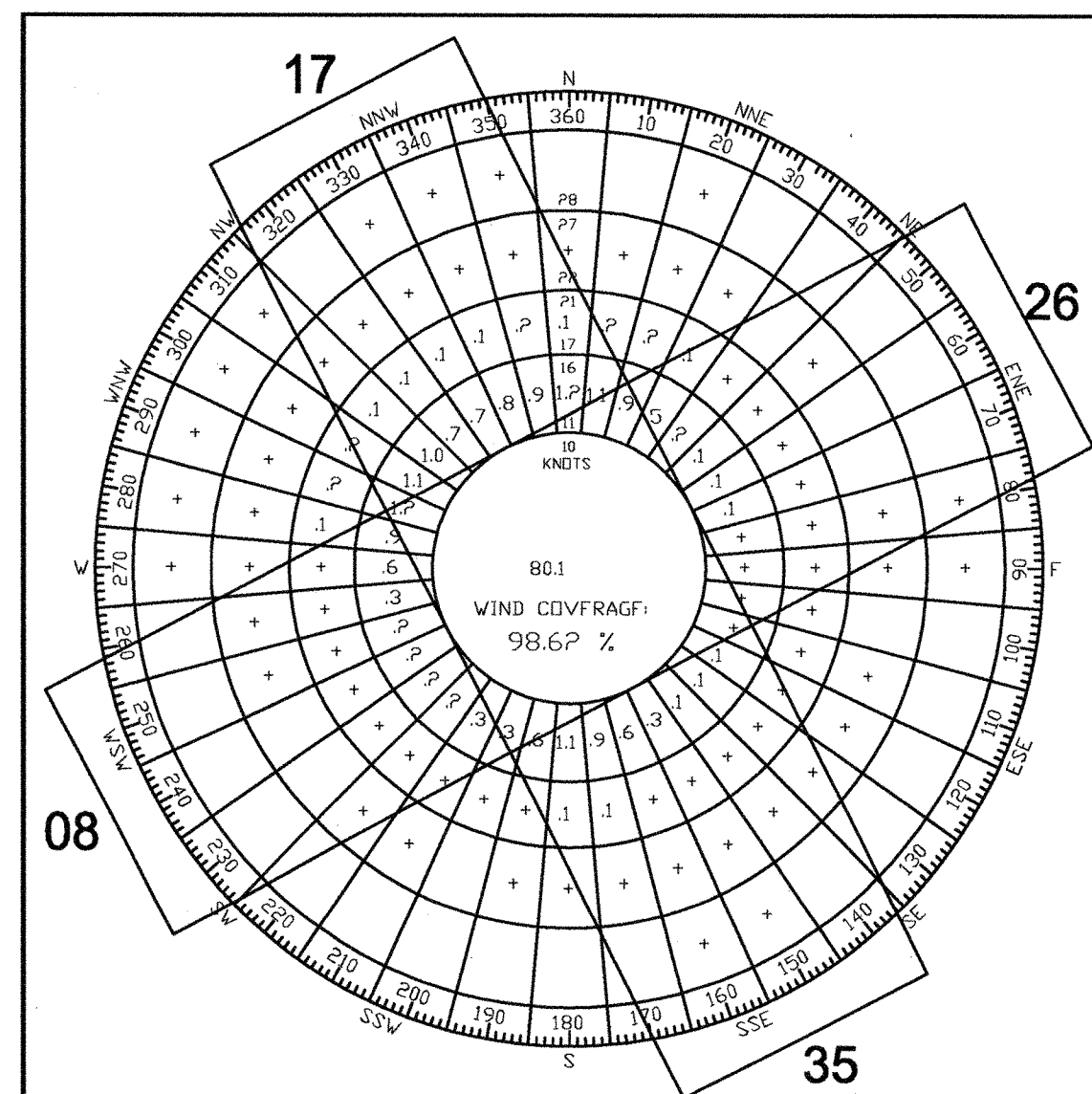

| | 17 | 35 | 8 | 26 |
|-----------------------------|-------|-------|-------|-------|
| 10.5-knot | 71.6% | 79.7% | 74.8% | 79.7% |
| 13.0-knot | 72.6% | 82.3% | 78.5% | 84.2% |
| 16.0-knot | 73.3% | 83.7% | 81.8% | 88.0% |
| 20.0-knot | 73.4% | 84.0% | 82.6% | 89.0% |
| Combined @ 10.5 knots | 95.1% | | 87.6% | |
| Combined @ 13 knots | 98.0% | | 93.6% | |
| Total Existing @ 10.5 knots | 98.6% | | | |

Station: KAUG
 Period: 1994 - 2006
 Observations: 116,142
 Tail Wind: 5 Knots
 Source: National Climatic Data Center, Asheville North Carolina

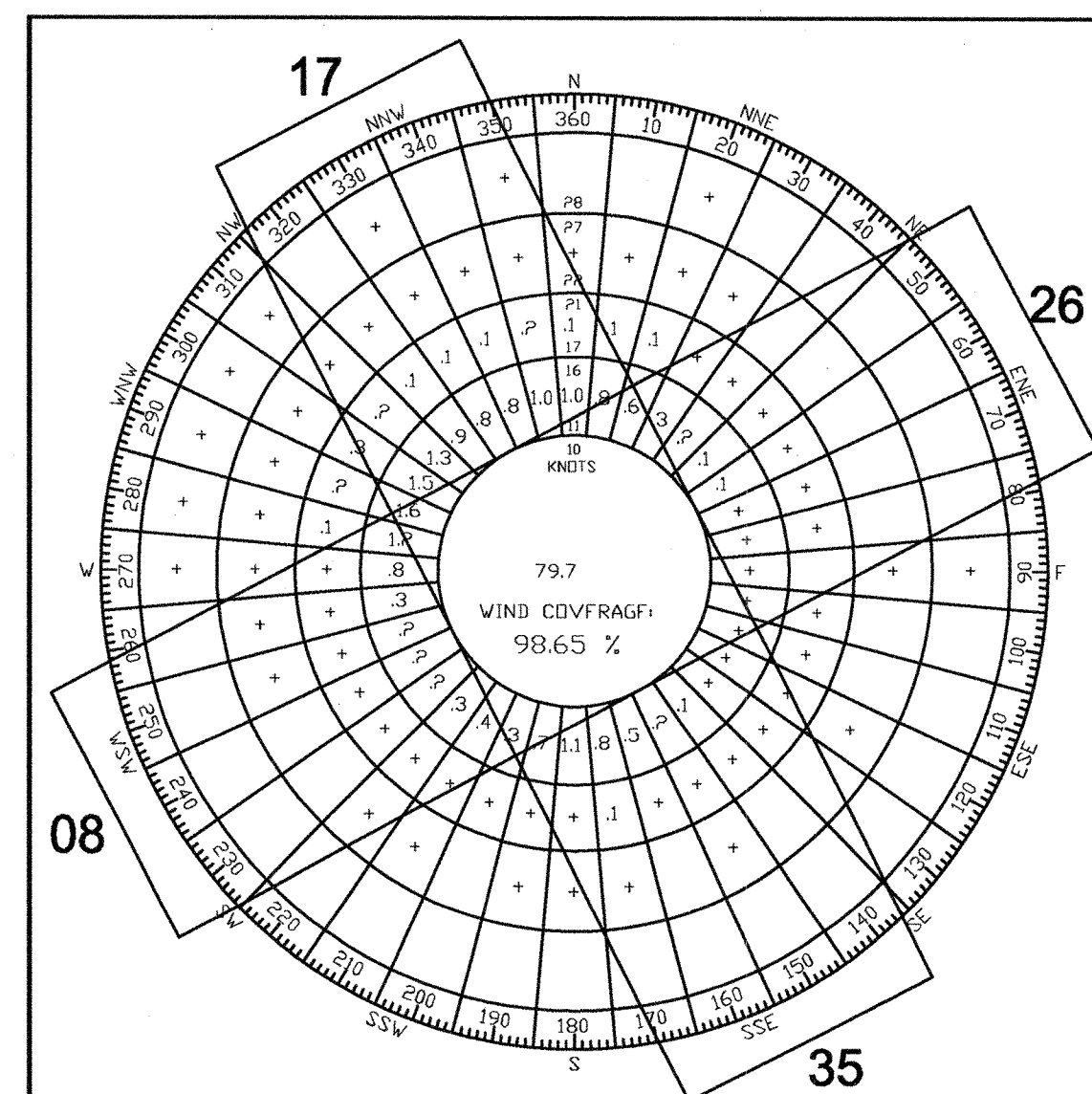

| | 17 | 35 | 8 | 26 |
|-----------------------------|-------|-------|-------|-------|
| 10.5-knot | 70.0% | 81.4% | 71.8% | 81.9% |
| 13.0-knot | 71.0% | 84.1% | 75.1% | 86.9% |
| 16.0-knot | 71.9% | 85.6% | 78.3% | 91.0% |
| 20.0-knot | 72.0% | 85.9% | 79.0% | 92.0% |
| Combined @ 10.5 knots | 94.8% | | 87.6% | |
| Combined @ 13 knots | 97.9% | | 93.7% | |
| Total Existing @ 10.5 knots | 98.7% | | | |

Station: KAUG
 Period: 1994 - 2006
 Observations: 86,443
 Tail Wind: 5 Knots
 Source: National Climatic Data Center, Asheville North Carolina

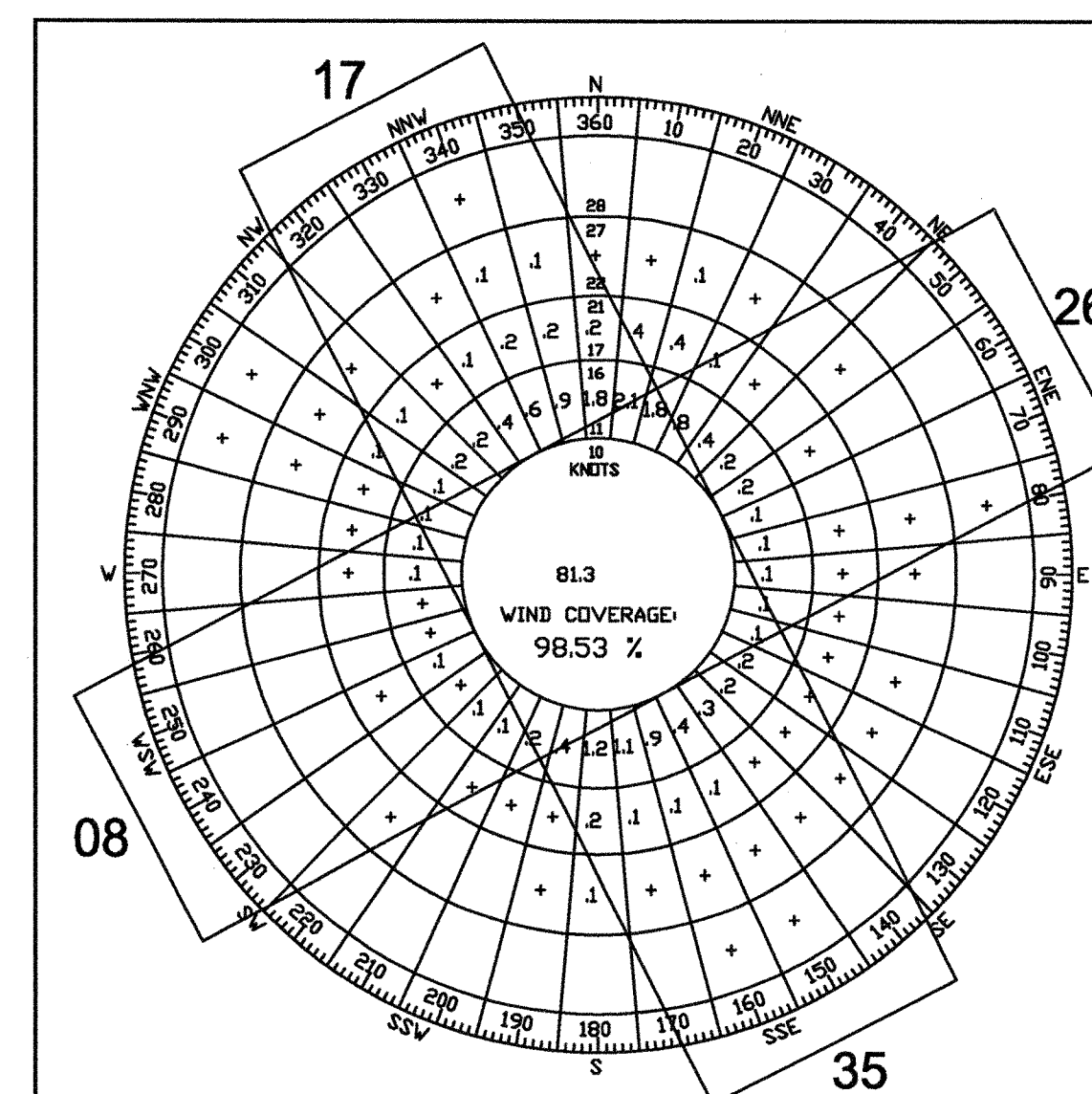

| | 17 | 35 | 8 | 26 |
|-----------------------------|-------|-------|-------|-------|
| 10.5-knot | 76.2% | 74.8% | 83.7% | 73.3% |
| 13.0-knot | 77.0% | 77.0% | 88.4% | 76.2% |
| 16.0-knot | 77.6% | 78.2% | 92.1% | 79.2% |
| 20.0-knot | 77.7% | 78.4% | 93.1% | 80.2% |
| Combined @ 10.5 knots | 95.8% | | 87.8% | |
| Combined @ 13 knots | 98.3% | | 93.4% | |
| Total Existing @ 10.5 knots | 98.6% | | | |

Station: KAUG
 Period: 1994 - 2006
 Observations: 29,699
 Tail Wind: 5 Knots
 Source: National Climatic Data Center, Asheville North Carolina

AUG MODIFICATION TO STANDARDS

| RECORD# | CONDITION | STATUS | DATE | ACTION |
|-----------------------|--|----------|-----------|--|
| MOS #19 | Penetration to primary surface and 20:1 approach surface R/W 8-26 | Approved | 1/14/1977 | No Action |
| MOS #21 | Violation of primary surface and clear zone Runway 35 | Approved | 2/9/1977 | No Action |
| MOS #22 | runway taxiway separation (400' precision runway) | Approved | 2/9/1977 | No Action |
| MOS #47 | line of sight approved | Approved | 8/18/1979 | Extend Taxiway C to full parallel |
| MOS #48 | 1. Safety area width; 2. parallel twy width; 3. twy safety area; 4. twy/rwy separation; 5. rwy long. grade; 6. bldg. restr. Line | Approved | 8/18/1979 | No Action |
| FAA RSR Determination | Deficient Runway Safety Areas on Runway 17-35 and Runway 8 | Approved | 9/15/08 | Install EMAS pads on 17 and 35, Shift Runway 8 threshold 90' |

Source: FAA Records

Airport Layout Plan Sheet List

| | |
|----|-------------------------------------|
| 1 | TITLE SHEET |
| 2 | EXISTING AIRPORT LAYOUT |
| 3 | 2025 AIRPORT LAYOUT PLAN |
| 4 | DATA SHEET |
| 5 | TERMINAL AREA DRAWING |
| 6 | PART 77 - FULL AIRSPACE DRAWING |
| 7 | PART 77 - CONICAL SURFACE DRAWING |
| 8 | RUNWAY 17-35 APPROACH AND PROFILES |
| 9 | RUNWAY 8-26 APPROACH AND PROFILES |
| 10 | 2025 NOISE CONTOUR/OFF-APT LAND USE |
| 11 | PAVEMENT HISTORY PLAN |

PA_Projects\38673 Augusta AP\plans\AUG ALP 2007\Sheet_04_DATA Sheet.dwg SI Aug 01, 2008 - 10:25am



| NO. | BY | DATE | REVISIONS | APPROVED |
|-----|----|------|-----------|----------|
| | | | | |
| | | | | |
| | | | | |



2900 SOUTH QUINCY STREET,
 SUITE 200
 ARLINGTON, VIRGINIA 22206
 PH (703) 824-5100
 FAX (703) 671-6210

DATE: Aug 01, 2008
DATA SHEET
AUGUSTA STATE AIRPORT
AUGUSTA, MAINE

FIGURE 4

P:\Projects\38673 Augusta MP\plans\AUG ALP 2007\Sheet_06_07_Far_Part77_Surfaces_Plan.dwg sheet 06 - full Mar 25, 2008 - 8:35am

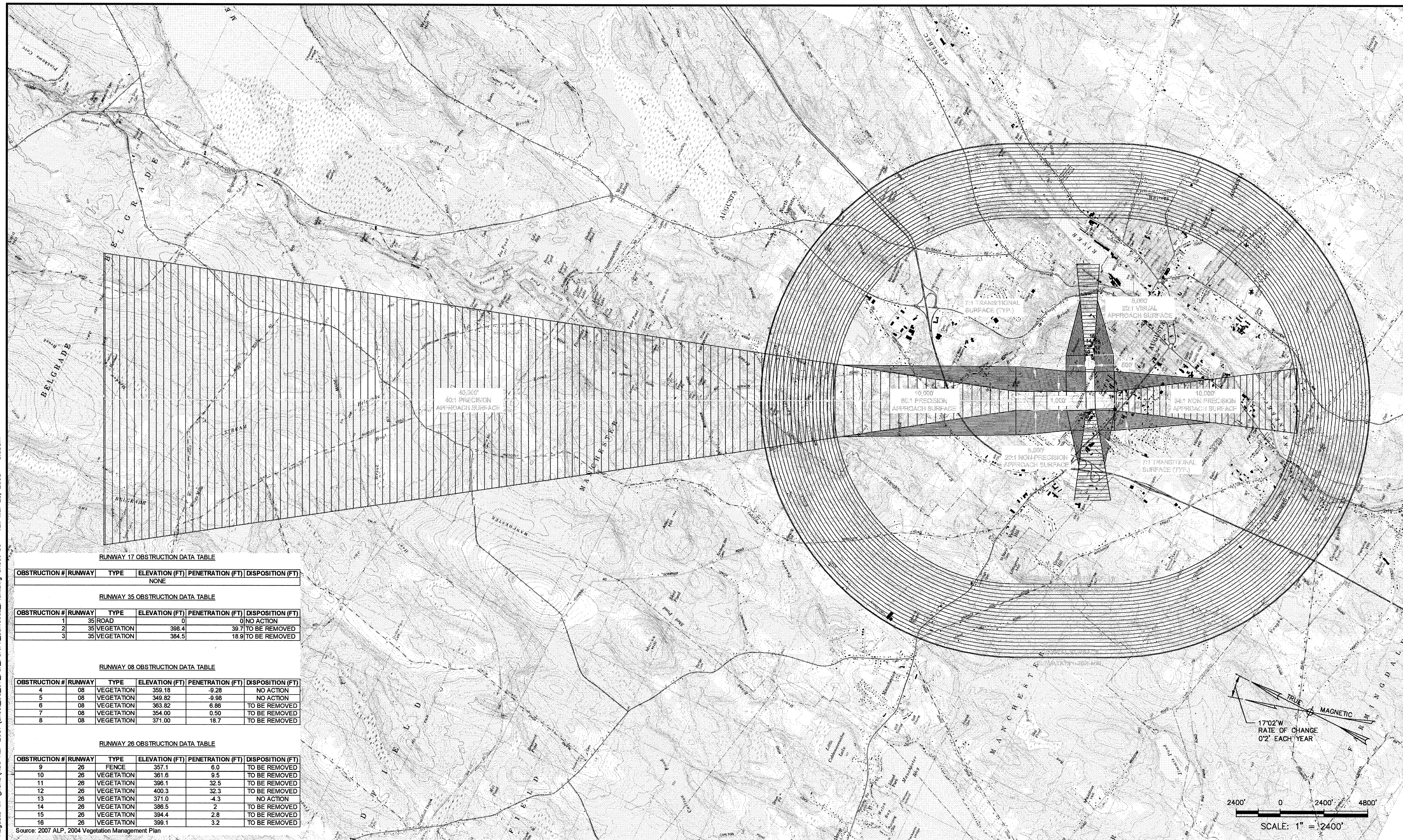

RUNWAY 17 OBSTRUCTION DATA TABLE

| OBSTRUCTION # | RUNWAY | TYPE | ELEVATION (FT) | PENETRATION (FT) | DISPOSITION (FT) |
|---------------|--------|------|----------------|------------------|------------------|
| | | | | | NONE |

RUNWAY 35 OBSTRUCTION DATA TABLE

| OBSTRUCTION # | RUNWAY | TYPE | ELEVATION (FT) | PENETRATION (FT) | DISPOSITION (FT) |
|---------------|--------|------------|----------------|------------------|--------------------|
| 1 | 35 | ROAD | | 0 | NO ACTION |
| 2 | 35 | VEGETATION | 398.4 | | 39.7 TO BE REMOVED |
| 3 | 35 | VEGETATION | 384.5 | | 18.9 TO BE REMOVED |

RUNWAY 08 OBSTRUCTION DATA TABLE

| OBSTRUCTION # | RUNWAY | TYPE | ELEVATION (FT) | PENETRATION (FT) | DISPOSITION (FT) |
|---------------|--------|------------|----------------|------------------|------------------|
| 4 | 08 | VEGETATION | 359.18 | -9.28 | NO ACTION |
| 5 | 08 | VEGETATION | 349.82 | -9.98 | NO ACTION |
| 6 | 08 | VEGETATION | 363.82 | 6.86 | TO BE REMOVED |
| 7 | 08 | VEGETATION | 354.00 | 0.50 | TO BE REMOVED |
| 8 | 08 | VEGETATION | 371.00 | 18.7 | TO BE REMOVED |

RUNWAY 26 OBSTRUCTION DATA TABLE

| OBSTRUCTION # | RUNWAY | TYPE | ELEVATION (FT) | PENETRATION (FT) | DISPOSITION (FT) |
|---------------|--------|------------|----------------|------------------|------------------|
| 9 | 26 | FENCE | 357.1 | 6.0 | TO BE REMOVED |
| 10 | 26 | VEGETATION | 361.6 | 9.5 | TO BE REMOVED |
| 11 | 26 | VEGETATION | 396.1 | 32.5 | TO BE REMOVED |
| 12 | 26 | VEGETATION | 400.3 | 32.3 | TO BE REMOVED |
| 13 | 26 | VEGETATION | 371.0 | -4.3 | NO ACTION |
| 14 | 26 | VEGETATION | 386.5 | 2 | TO BE REMOVED |
| 15 | 26 | VEGETATION | 394.4 | 2.8 | TO BE REMOVED |
| 16 | 26 | VEGETATION | 399.1 | 3.2 | TO BE REMOVED |

Source: 2007 ALP, 2004 Vegetation Management Plan

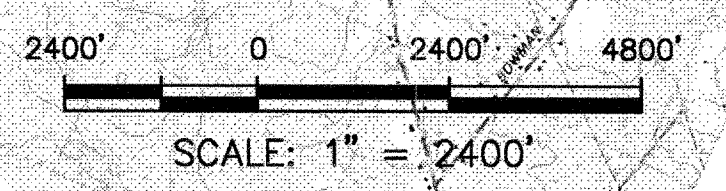
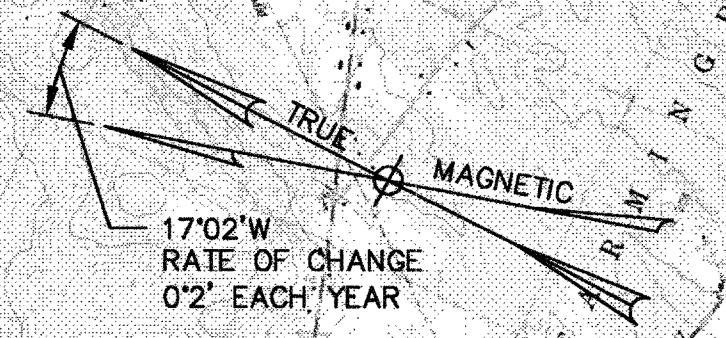

| NO. | BY | DATE | REVISIONS |
|-----|----|------|-----------|
| | | | |
| | | | |
| | | | |

| APPROVED |
|----------|
| |
| |
| |



2900 SOUTH QUINCY STREET,
SUITE 200
ARLINGTON, VIRGINIA 22206
PH (703) 824-5100
FAX (703) 671-6210

PART 77 - FULL AIRSPACE DRAWING

**AUGUSTA STATE AIRPORT
AUGUSTA, MAINE**

DATE:
Mar 25, 2008

FIGURE
6

P:\Projects\38673 Augusta MFL\plans\AUG ALP 2007\Sheet_06_07_For_Par77_Surfaces_Plan.dwg sheet 07 - conical Mar 25, 2008 - B43cm

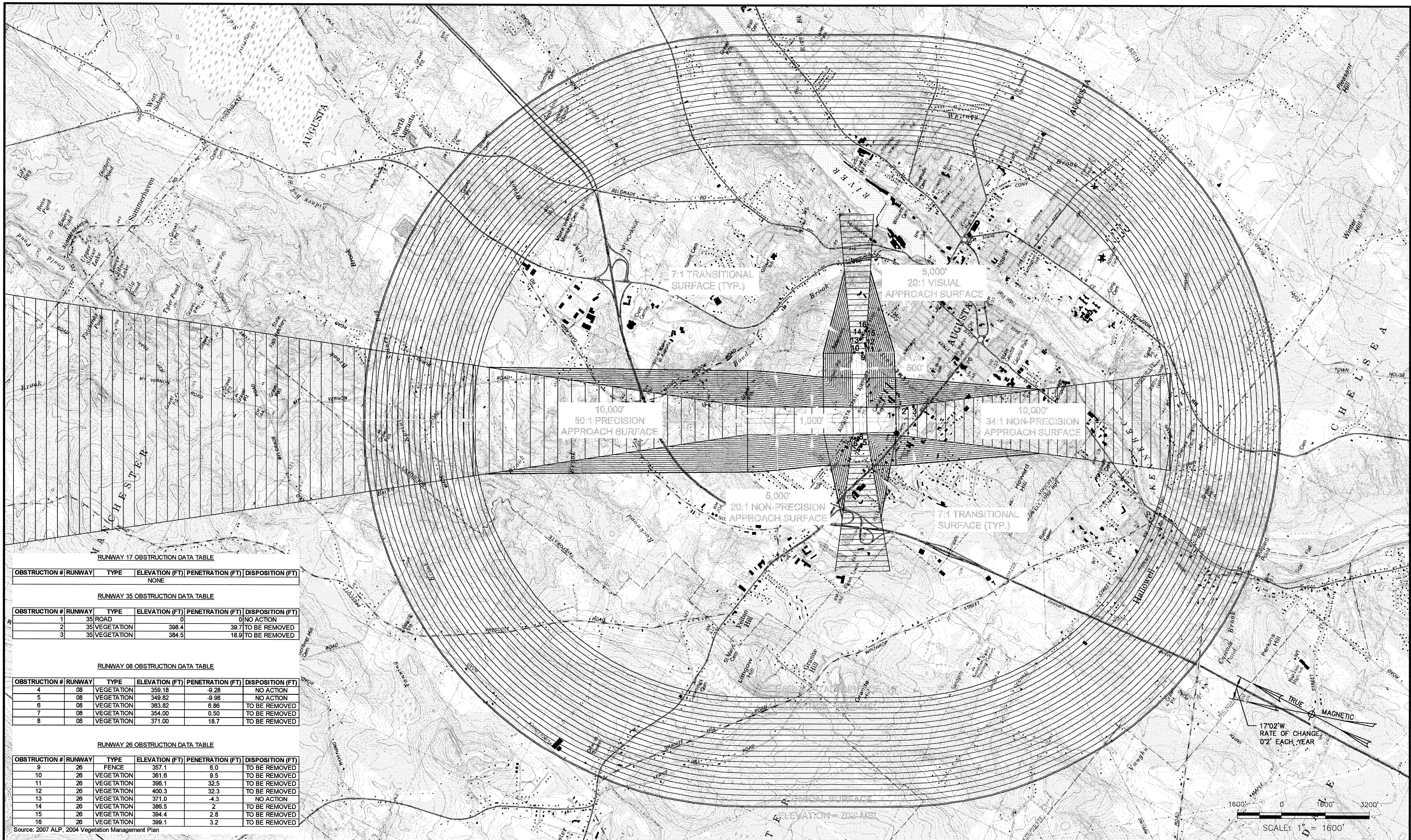

RUNWAY 17 OBSTRUCTION DATA TABLE

| OBSTRUCTION # | RUNWAY | TYPE | ELEVATION (FT) | PENETRATION (FT) | DISPOSITION (FT) |
|---------------|--------|------|----------------|------------------|------------------|
| NONE | | | | | |

RUNWAY 35 OBSTRUCTION DATA TABLE

| OBSTRUCTION # | RUNWAY | TYPE | ELEVATION (FT) | PENETRATION (FT) | DISPOSITION (FT) |
|---------------|--------|------------|----------------|------------------|------------------|
| 1 | 35 | ROAD | 0 | 0 | NO ACTION |
| 2 | 35 | VEGETATION | 398.4 | 39.7 | TO BE REMOVED |
| 3 | 35 | VEGETATION | 384.5 | 18.9 | TO BE REMOVED |

RUNWAY 08 OBSTRUCTION DATA TABLE

| OBSTRUCTION # | RUNWAY | TYPE | ELEVATION (FT) | PENETRATION (FT) | DISPOSITION (FT) |
|---------------|--------|------------|----------------|------------------|------------------|
| 4 | 08 | VEGETATION | 359.18 | -9.28 | NO ACTION |
| 5 | 08 | VEGETATION | 349.82 | -9.98 | NO ACTION |
| 6 | 08 | VEGETATION | 363.82 | 6.86 | TO BE REMOVED |
| 7 | 08 | VEGETATION | 354.00 | 0.50 | TO BE REMOVED |
| 8 | 08 | VEGETATION | 371.00 | 18.7 | TO BE REMOVED |

RUNWAY 26 OBSTRUCTION DATA TABLE

| OBSTRUCTION # | RUNWAY | TYPE | ELEVATION (FT) | PENETRATION (FT) | DISPOSITION (FT) |
|---------------|--------|------------|----------------|------------------|------------------|
| 9 | 26 | FENCE | 357.1 | 6.0 | TO BE REMOVED |
| 10 | 26 | VEGETATION | 361.6 | 9.5 | TO BE REMOVED |
| 11 | 26 | VEGETATION | 396.1 | 32.5 | TO BE REMOVED |
| 12 | 26 | VEGETATION | 400.3 | 32.3 | TO BE REMOVED |
| 13 | 26 | VEGETATION | 371.0 | -4.3 | NO ACTION |
| 14 | 26 | VEGETATION | 386.5 | 2 | TO BE REMOVED |
| 15 | 26 | VEGETATION | 394.4 | 2.8 | TO BE REMOVED |
| 16 | 26 | VEGETATION | 399.1 | 3.2 | TO BE REMOVED |

Source: 2007 ALP, 2004 Vegetation Management Plan



| NO. | BY | DATE | REVISIONS |
|-----|----|------|-----------|
| | | | |
| | | | |
| | | | |

| APPROVED |
|----------|
| |



2900 SOUTH QUINCY STREET,
SUITE 200
ARLINGTON, VIRGINIA 22206
PH (703) 824-5100
FAX (703) 671-6210

PART 77 - CONICAL SURFACE DRAWING

**AUGUSTA STATE AIRPORT
AUGUSTA, MAINE**

DATE:
Mar 25, 2008

FIGURE
7

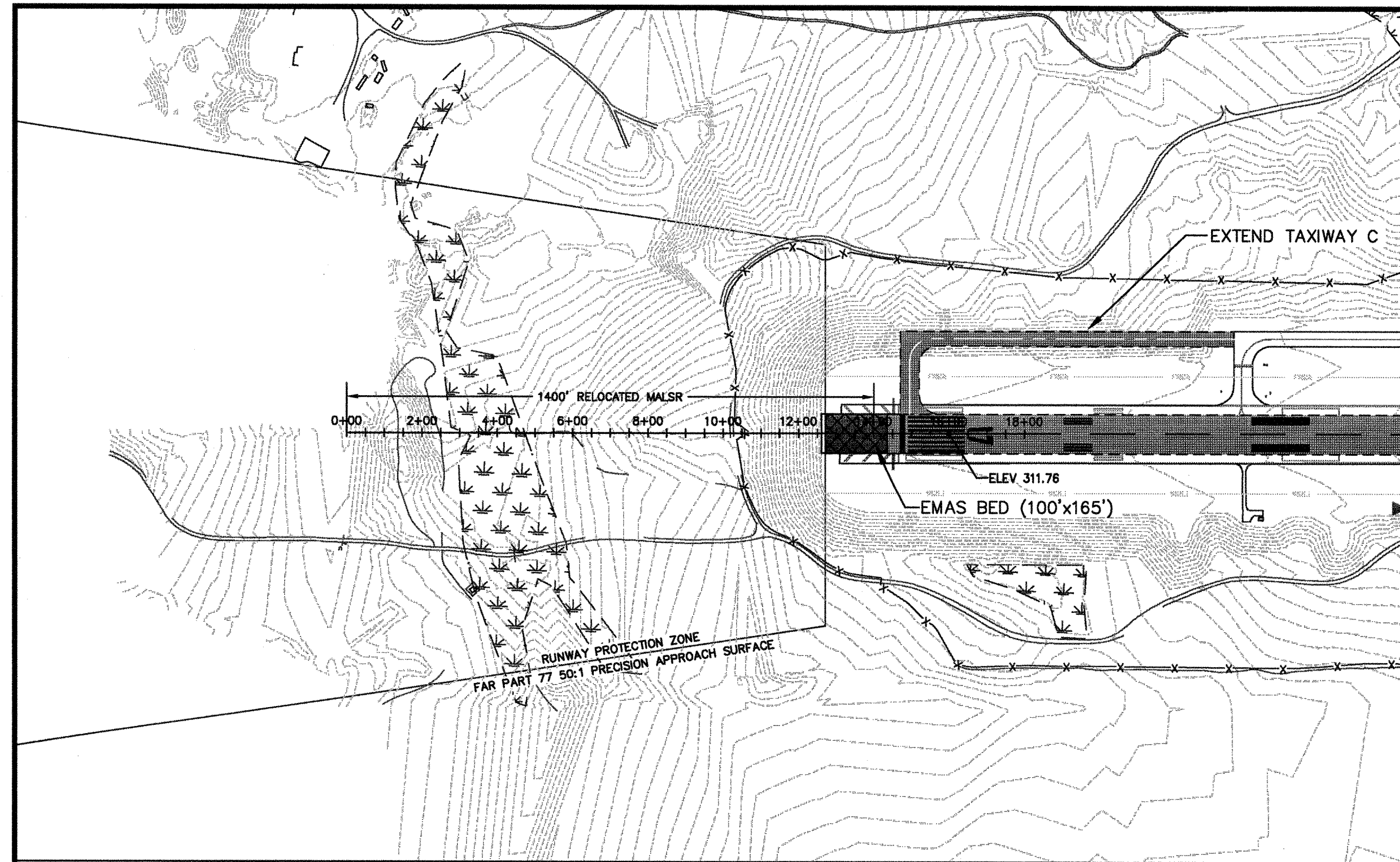

RUNWAY 17 END

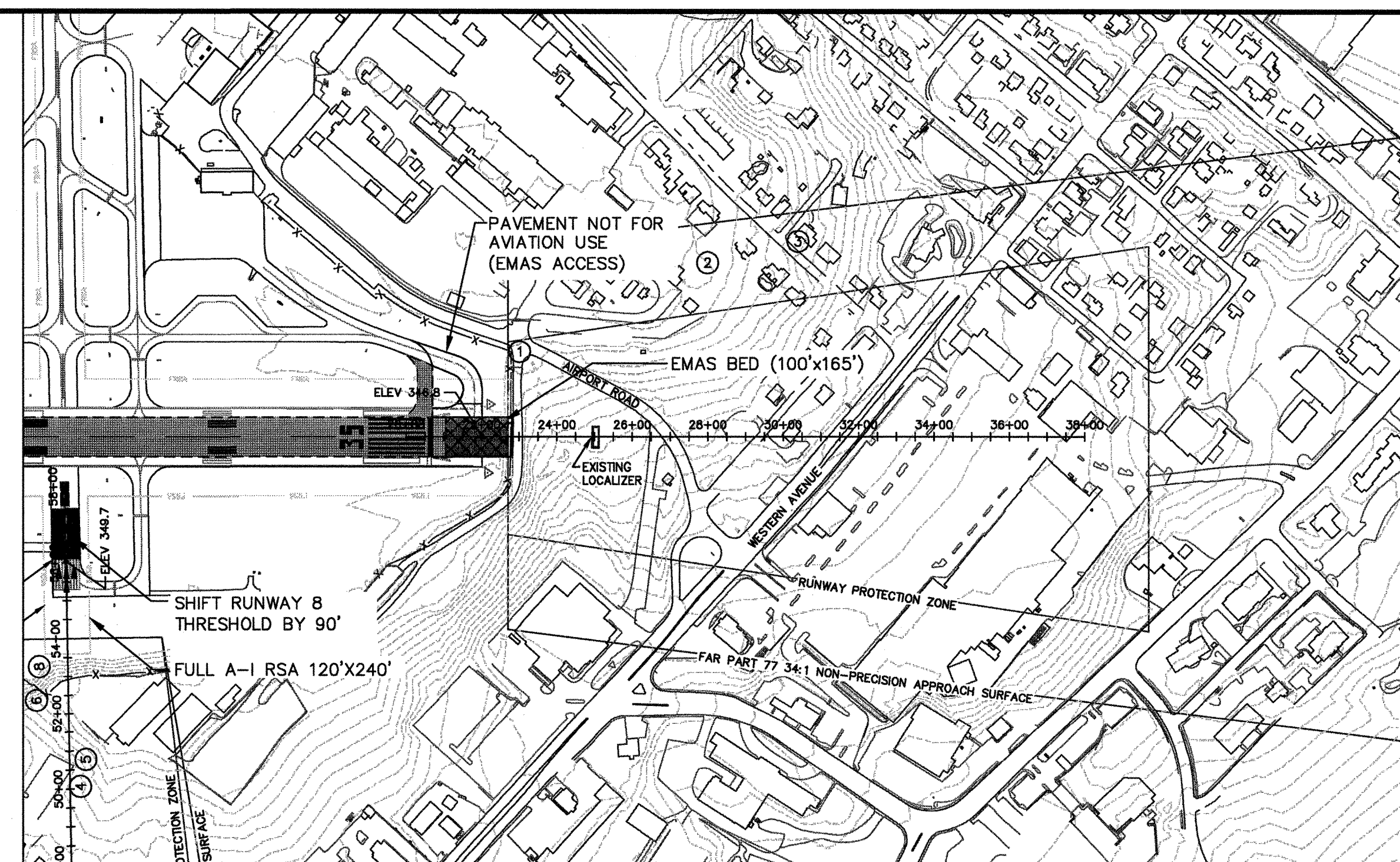
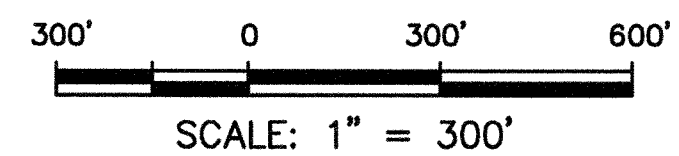
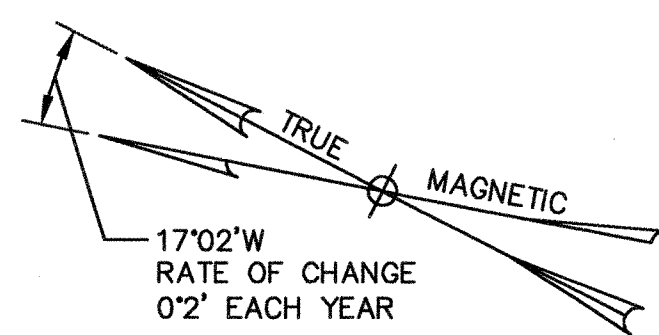

RUNWAY 35 END

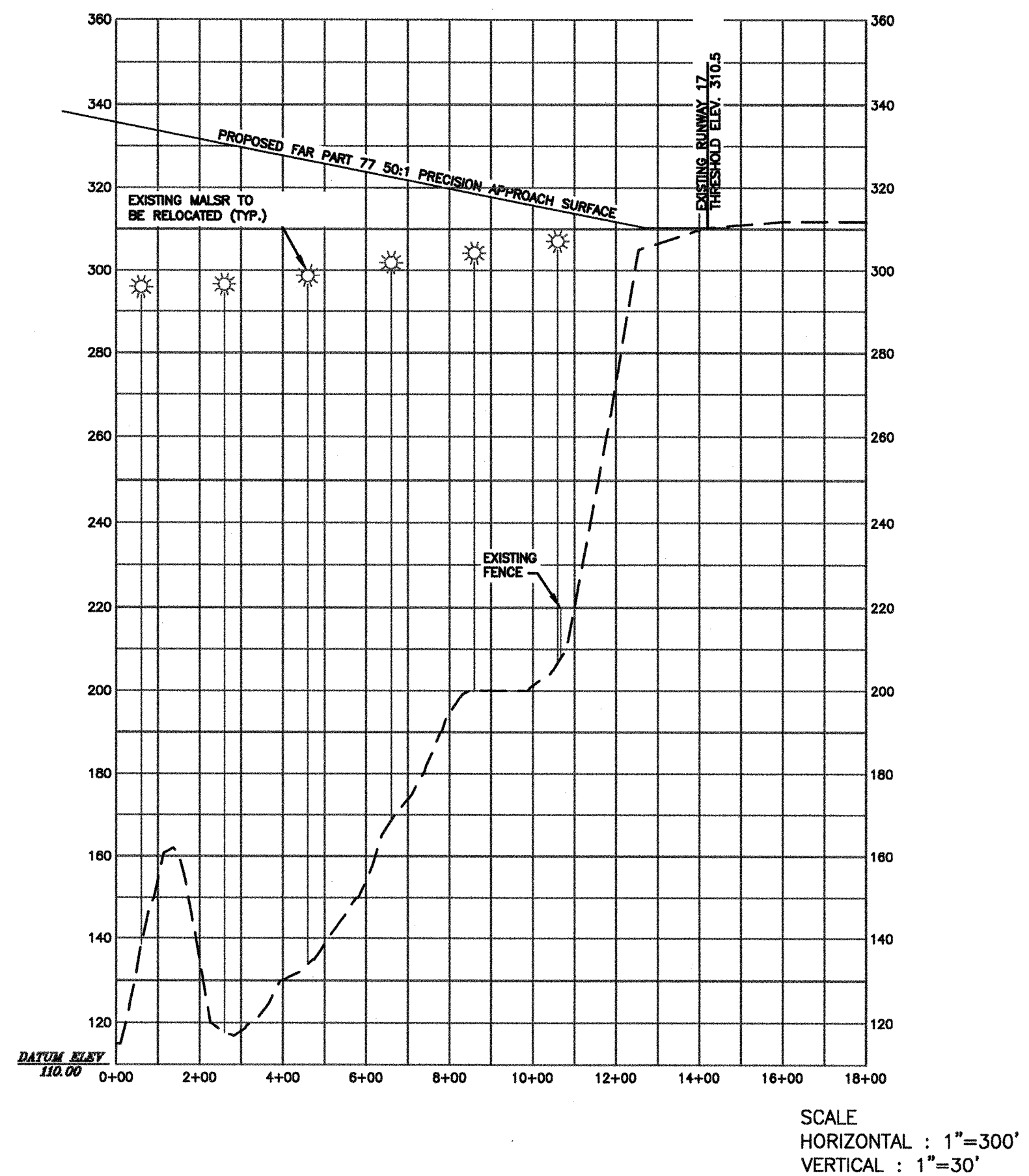

LEGEND

EXISTING GROUND (dashed line)

VEGETATION (wavy line)

RUNWAY 17 OBSTRUCTION DATA TABLE

| OBSTRUCTION # | RUNWAY | TYPE | ELEVATION (FT) | PENETRATION (FT) | DISPOSITION (FT) |
|---------------|--------|------|----------------|------------------|------------------|
| NONE | | | | | |

RUNWAY 35 OBSTRUCTION DATA TABLE

| OBSTRUCTION # | RUNWAY | TYPE | ELEVATION (FT) | PENETRATION (FT) | DISPOSITION (FT) |
|---------------|--------|------------|----------------|------------------|------------------|
| 1 | 35 | ROAD | 0 | 0 | NO ACTION |
| 2 | 35 | VEGETATION | 398.4 | 39.7 | TO BE REMOVED |
| 3 | 35 | VEGETATION | 384.5 | 18.9 | TO BE REMOVED |

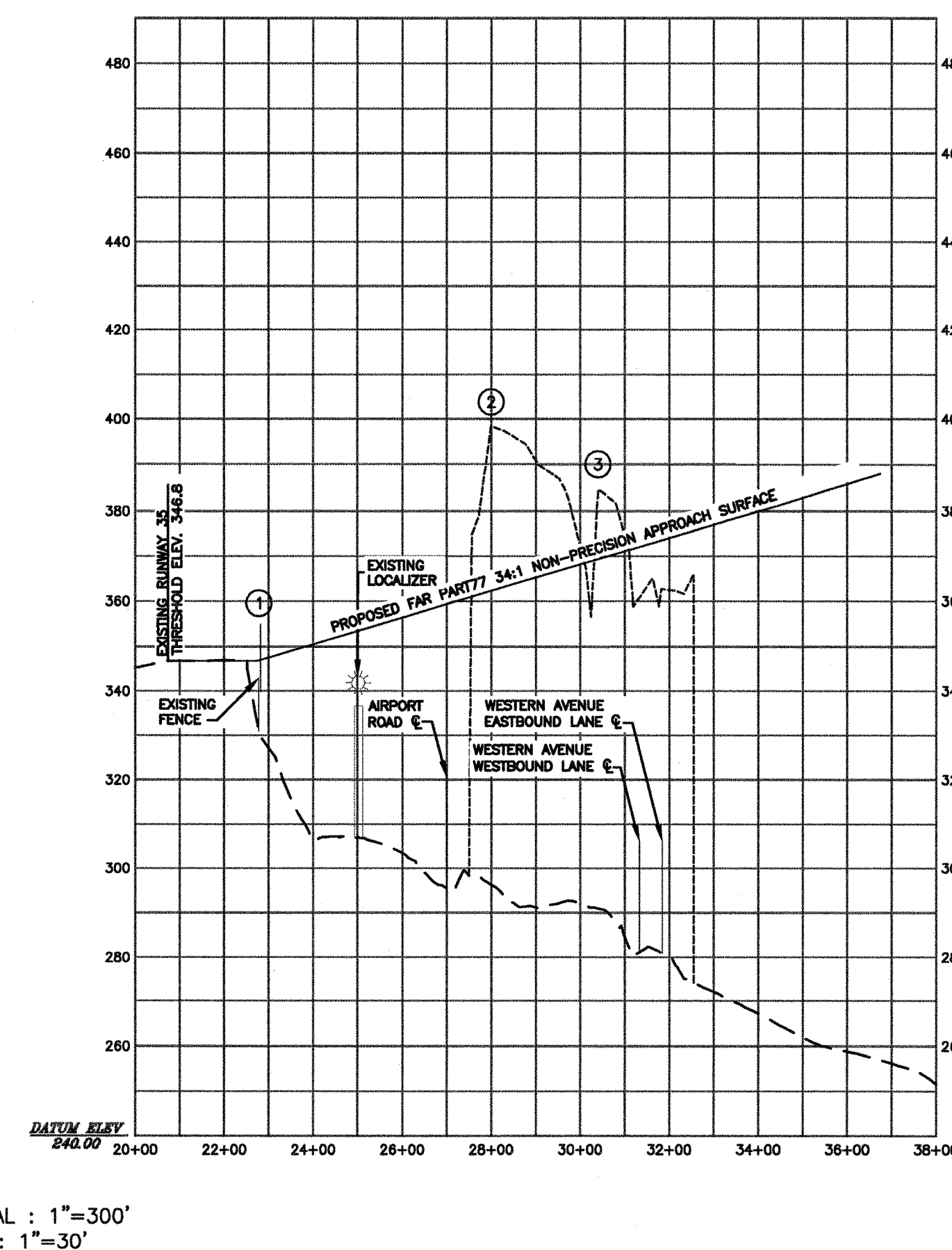

P:\Projects\36673 Augusta MP\plans\AUG_ALP_2007\Sheet_08_and_09_Plan_n_Profile.dwg sheet 08 - new 1-300 Mar 25, 2008 - 8:28am



| NO. | BY | DATE | REVISIONS |
|-----|----|------|-----------|
| | | | |
| | | | |
| | | | |

| APPROVED |
|----------|
| |



2900 SOUTH QUINCY STREET,
SUITE 200
ARLINGTON, VIRGINIA 22206
PH (703) 824-5100
FAX (703) 671-6210

RUNWAY 17-35 APPROACH AND PROFILES

AUGUSTA STATE AIRPORT
AUGUSTA, MAINE

DATE:
Mar 25, 2008

FIGURE
8

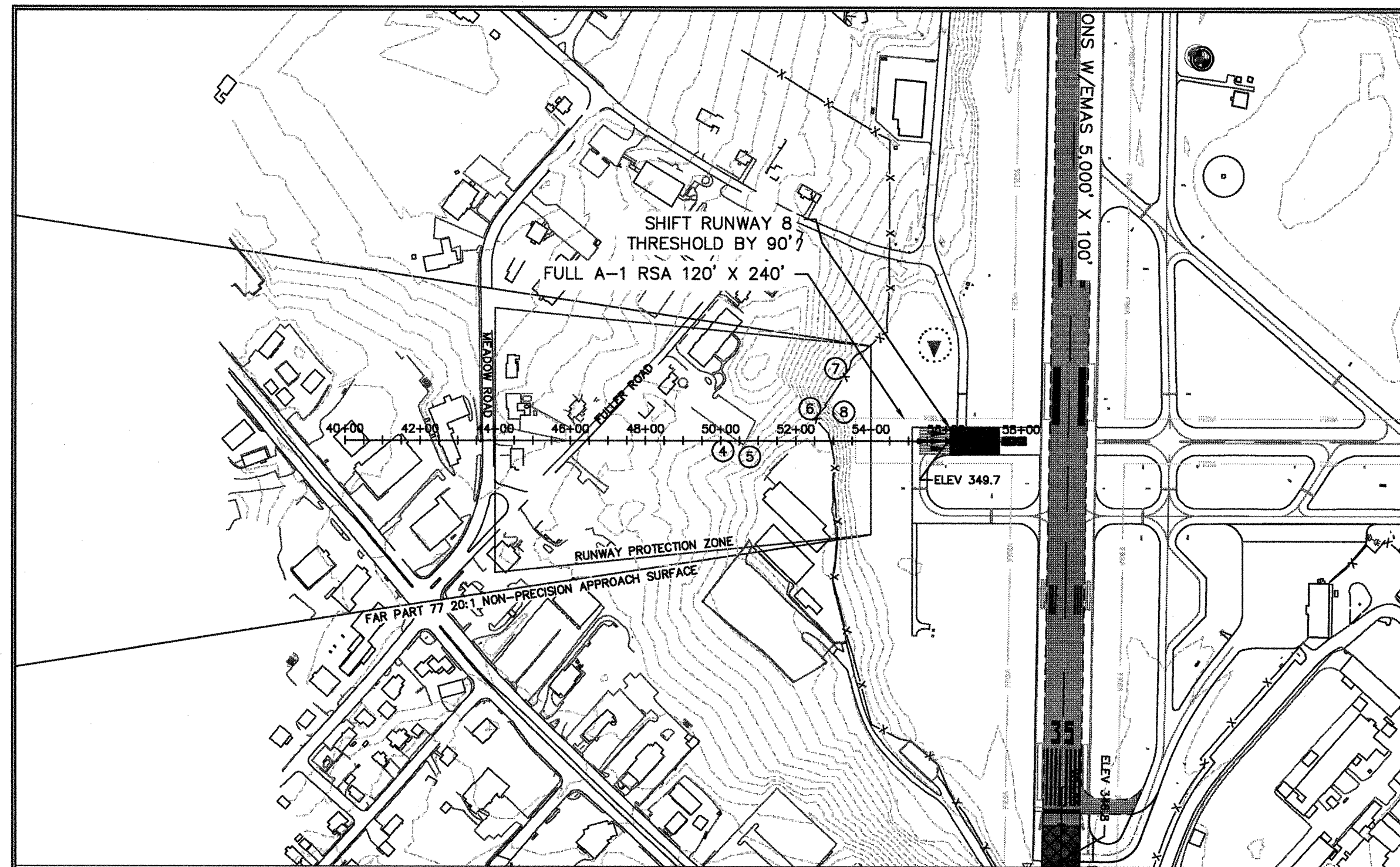

RUNWAY 08 END

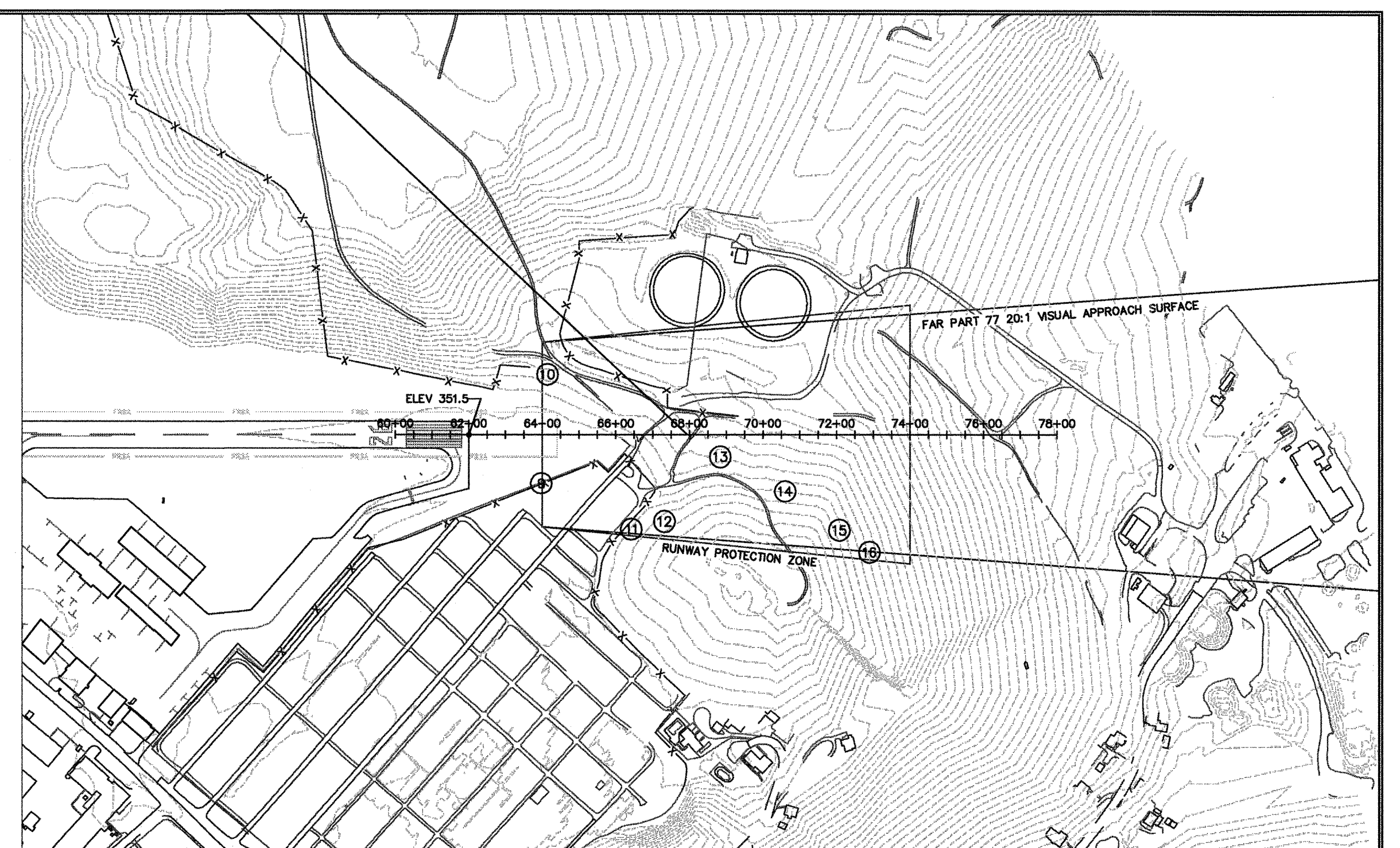
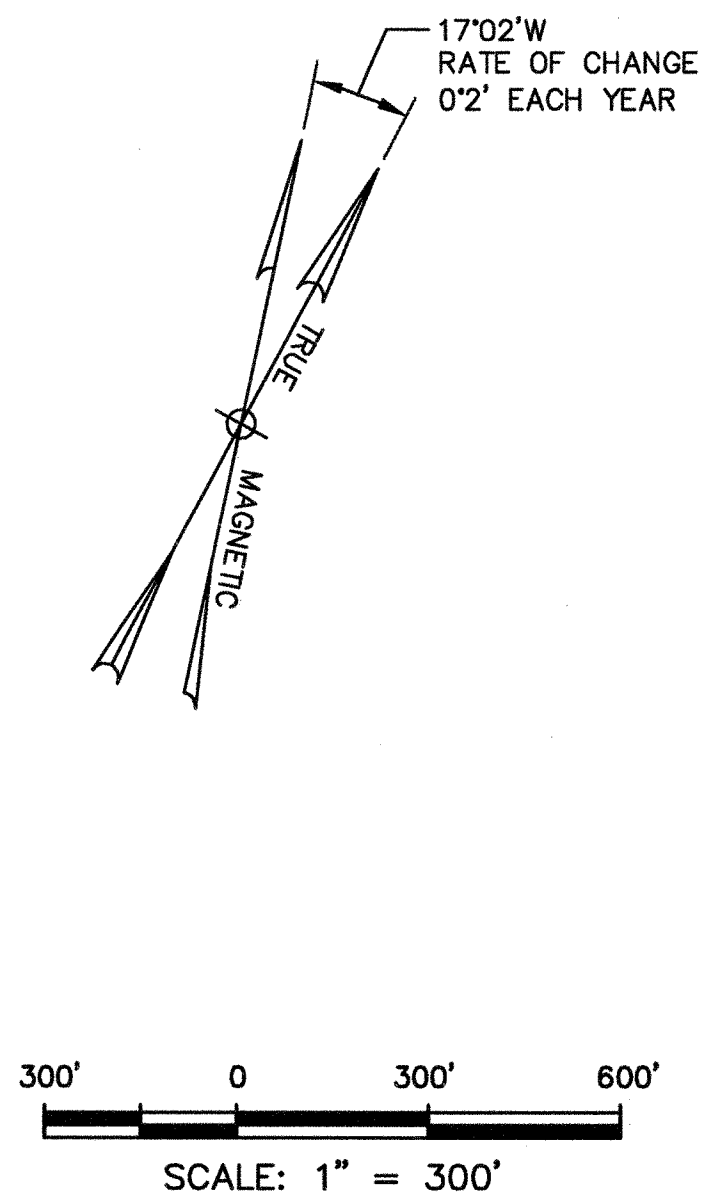

RUNWAY 26 END

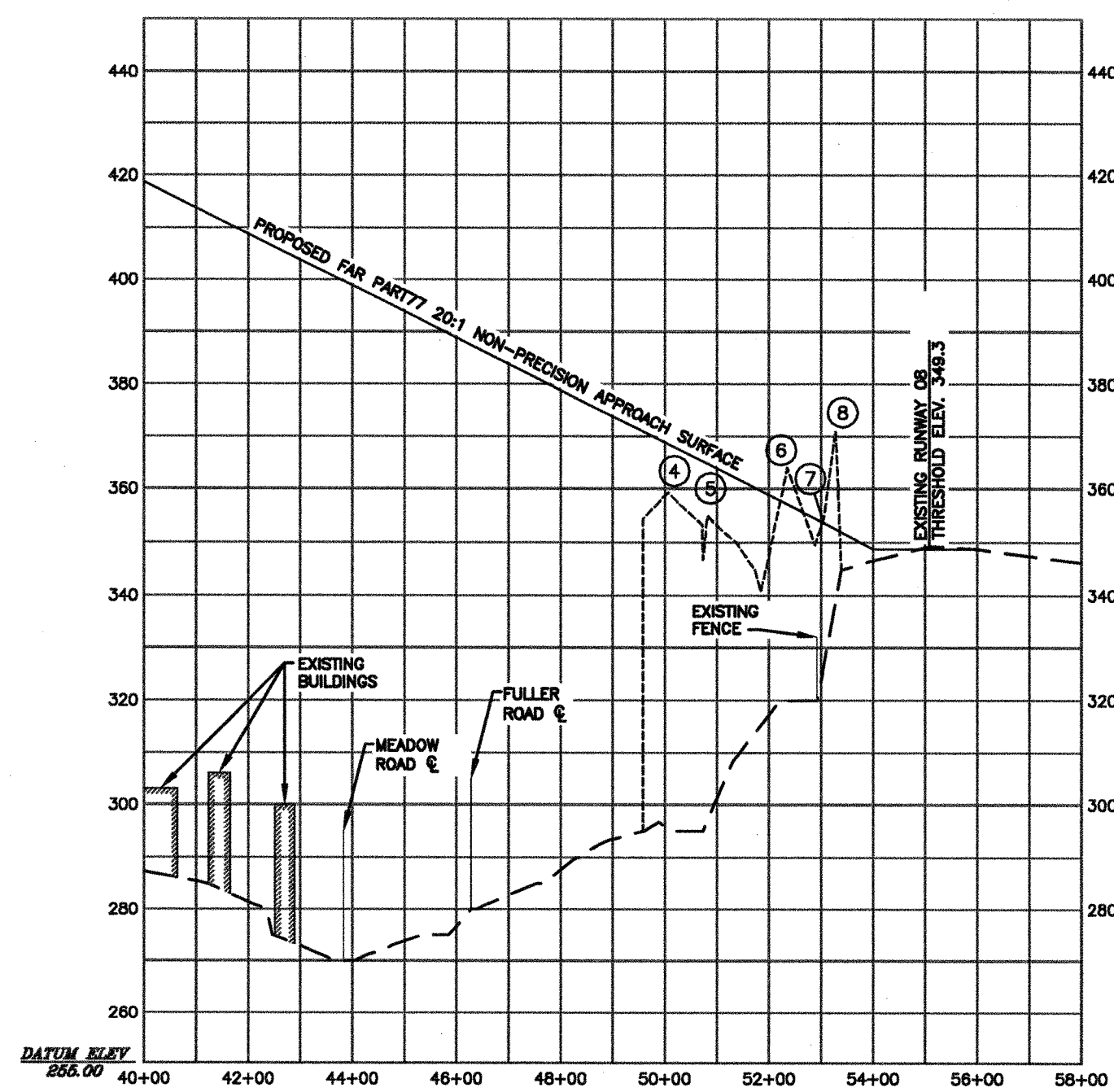

SCALE
HORIZONTAL : 1"=300'
VERTICAL : 1"=30'

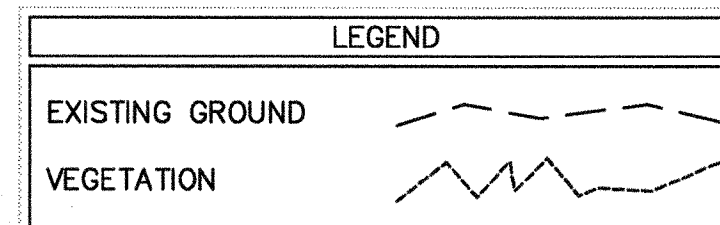

RUNWAY 08 OBSTRUCTION DATA TABLE

| OBSTRUCTION # | RUNWAY | TYPE | ELEVATION (FT) | PENETRATION (FT) | DISPOSITION (FT) |
|---------------|--------|------------|----------------|------------------|------------------|
| 4 | 08 | VEGETATION | 359.18 | 9.28 | NO ACTION |
| 5 | 08 | VEGETATION | 349.82 | 9.98 | NO ACTION |
| 6 | 08 | VEGETATION | 363.82 | 6.86 | TO BE REMOVED |
| 7 | 08 | VEGETATION | 354.00 | 0.50 | TO BE REMOVED |
| 8 | 08 | VEGETATION | 371.00 | 18.7 | TO BE REMOVED |

RUNWAY 26 OBSTRUCTION DATA TABLE

| OBSTRUCTION # | RUNWAY | TYPE | ELEVATION (FT) | PENETRATION (FT) | DISPOSITION (FT) |
|---------------|--------|------------|----------------|------------------|------------------|
| 9 | 26 | FENCE | 357.1 | 6.0 | TO BE REMOVED |
| 10 | 26 | VEGETATION | 361.6 | 9.5 | TO BE REMOVED |
| 11 | 26 | VEGETATION | 396.1 | 32.5 | TO BE REMOVED |
| 12 | 26 | VEGETATION | 400.3 | 32.3 | TO BE REMOVED |
| 13 | 26 | VEGETATION | 371.0 | -4.3 | NO ACTION |
| 14 | 26 | VEGETATION | 386.5 | 2 | TO BE REMOVED |
| 15 | 26 | VEGETATION | 394.4 | 2.8 | TO BE REMOVED |
| 16 | 26 | VEGETATION | 399.1 | 3.2 | TO BE REMOVED |

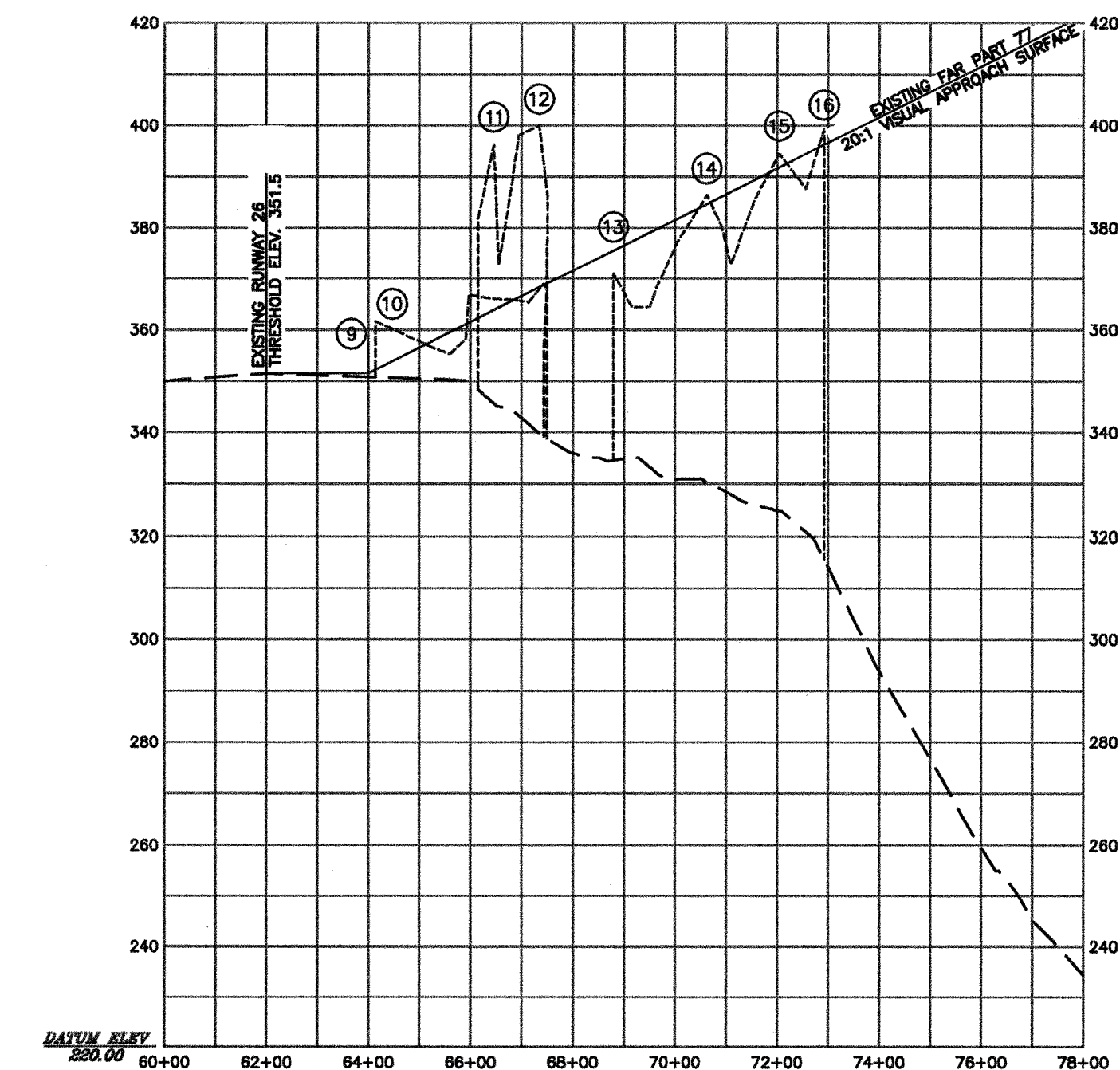

SCALE
HORIZONTAL : 1"=300'
VERTICAL : 1"=30'

P:\Projects\38673 Augusta MP\plans\AUG ALP 2007\Sheet_08_end_09_Plan_n_Profile.dwg sheet 09 - new 1-300 Mar 25, 2008 - 8:29am



| NO. | BY | DATE | REVISIONS |
|-----|----|------|-----------|
| | | | |
| | | | |
| | | | |

APPROVED



2900 SOUTH QUINCY STREET,
SUITE 200
ARLINGTON, VIRGINIA 22206
PH (703) 824-5100
FAX (703) 671-6210

RUNWAY 08-26 APPROACH AND PROFILES

AUGUSTA STATE AIRPORT
AUGUSTA, MAINE

DATE:
Mar 25, 2008

FIGURE
9

P:\Projects\39673 Augusta MP\plans\AUG ALP 2007\Sheet_10 2025 Noise Contour and Land Use.dwg SI Mar 25, 2008 - 9:18am

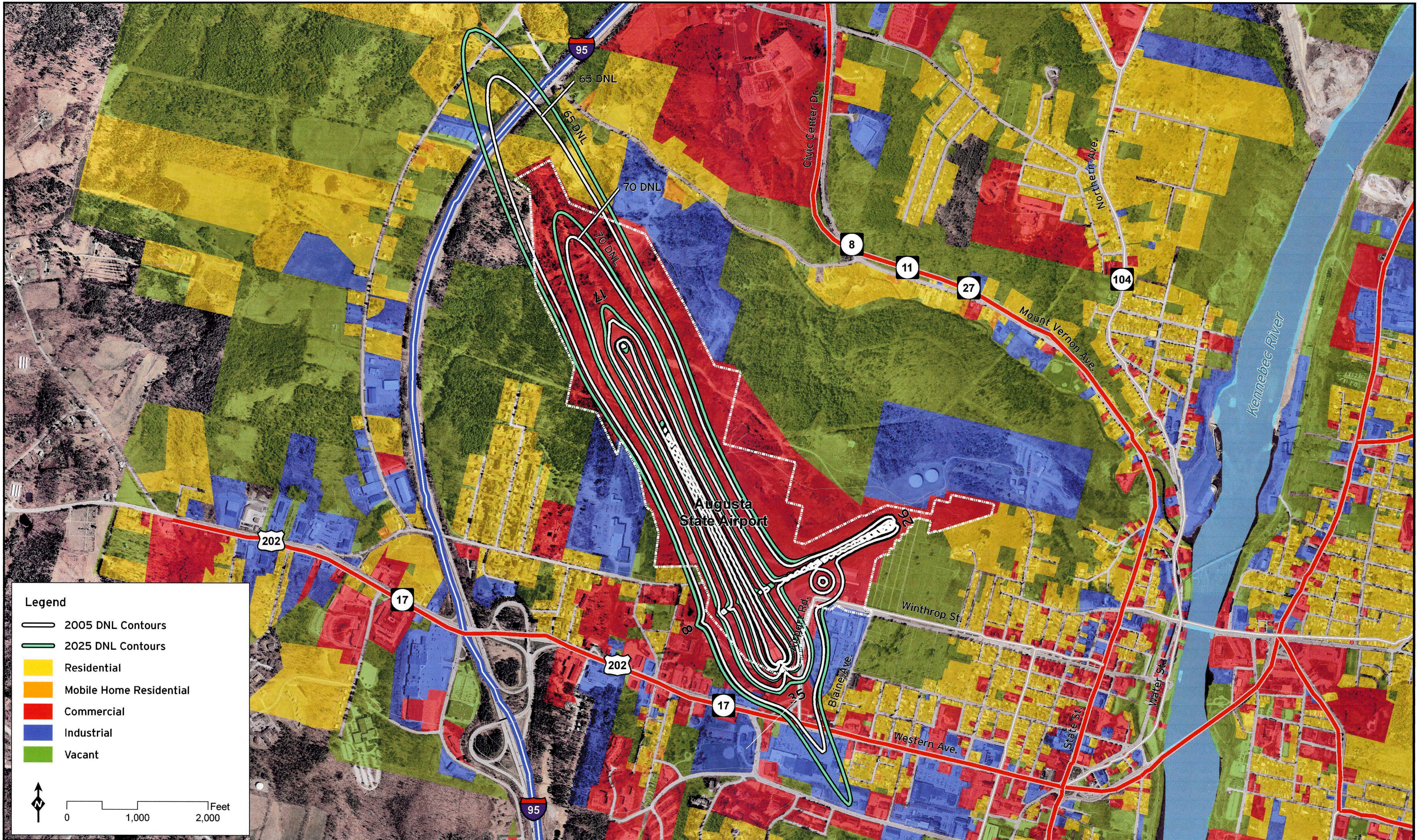

- Legend**
- 2005 DNL Contours
 - 2025 DNL Contours
 - Residential
 - Mobile Home Residential
 - Commercial
 - Industrial
 - Vacant

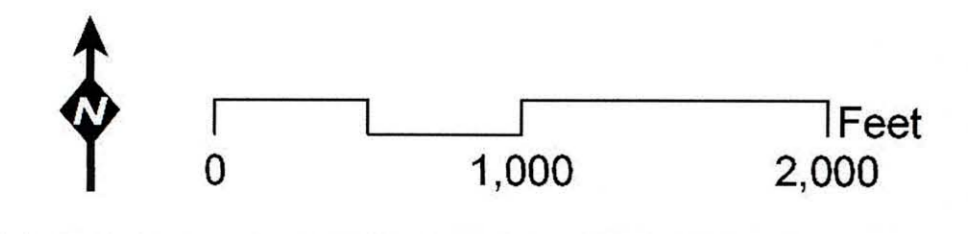

| NO. | BY | DATE | REVISIONS | APPROVED |
|-----|----|------|-----------|----------|
| | | | | |
| | | | | |
| | | | | |



2900 SOUTH QUINCY STREET,
 SUITE 200
 ARLINGTON, VIRGINIA 22206
 PH (703) 824-5100
 FAX (703) 671-6210

AIRPORT NOISE CONTOUR AND LAND-USE

**AUGUSTA STATE AIRPORT
 AUGUSTA, MAINE**

DATE:
 Mar 25, 2008

FIGURE
 10

| NO. | PROJECT YEAR | PROJECT DESCRIPTION | EXISTING CONDITION |
|-----|--------------|--|--------------------|
| 1 | 1981 | RECONSTRUCT RUNWAY 17-35 AND TAXWAYS | FAIR (TWY B, POOR) |
| 2 | 1991 | REHABILITATION OF GENERAL AVIATION TRANSIT/TIE-DOWN APRON | FAIR |
| 3 | 1992 | INSTALL POROUS FRICTION COURSE ON RUNWAY 17-35 | GOOD |
| 4 | 1993 | EXTEND TAXIWAY C TO RUNWAY 35 END AND EXTEND TAXIWAY 8 TO 08 END | GOOD |
| 5 | 1993 | EXPAND TERMINAL APRON | GOOD |
| 6 | 2002 | OVERLAY RUNWAY 8-26 | EXCELLENT |
| 7 | 2006 | REHABILITATION OF TAXIWAY C AND C1 | EXCELLENT |

Source: FAA Documentation, AUG Staff, and HNTB Field Inspection

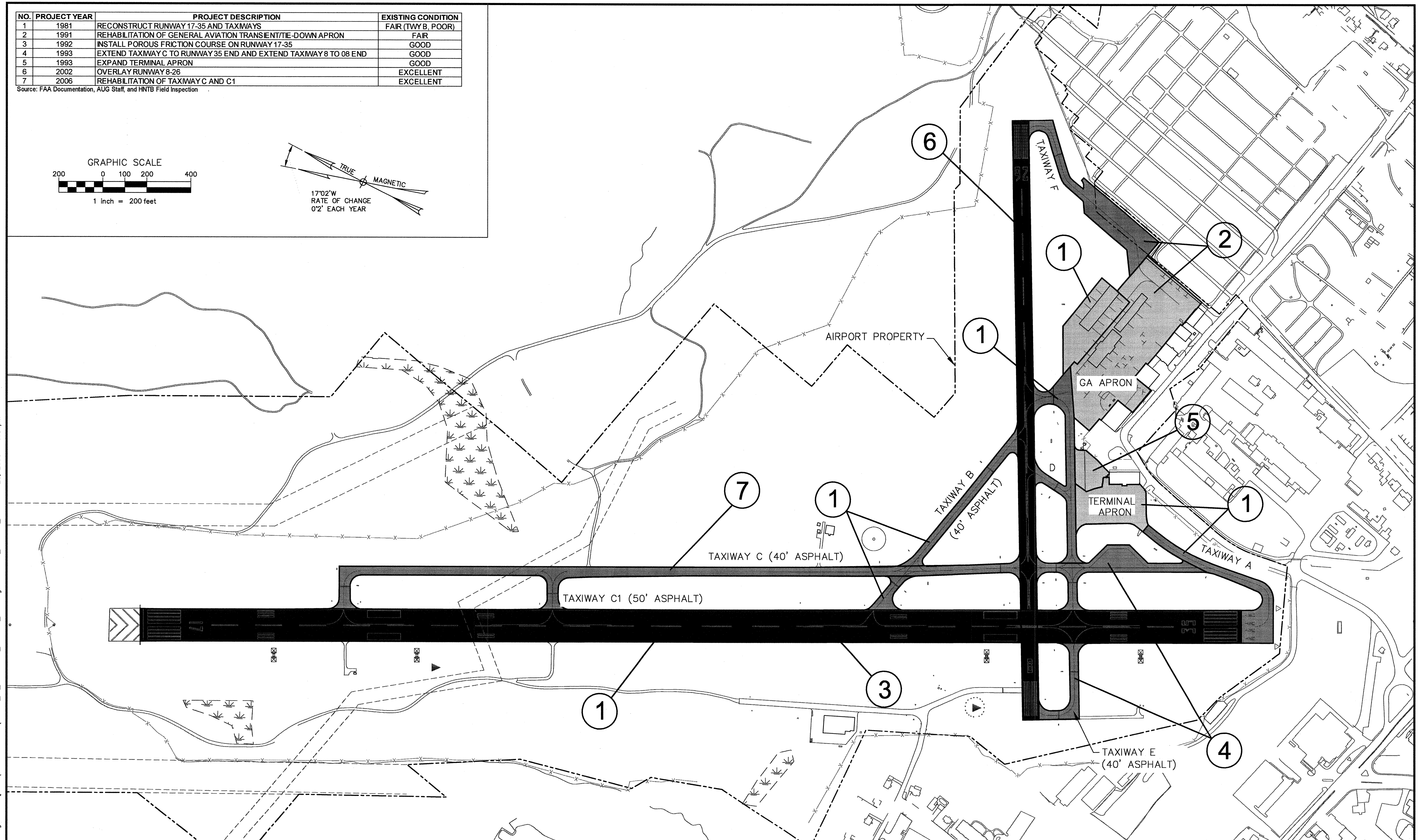
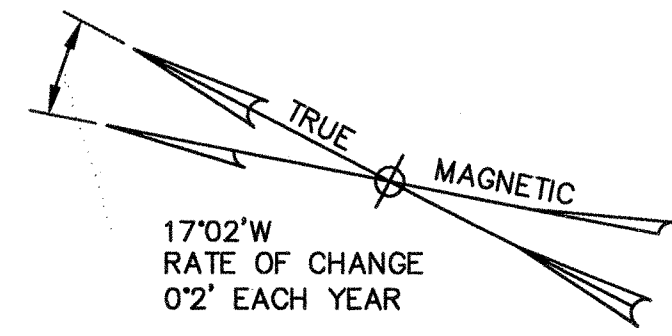
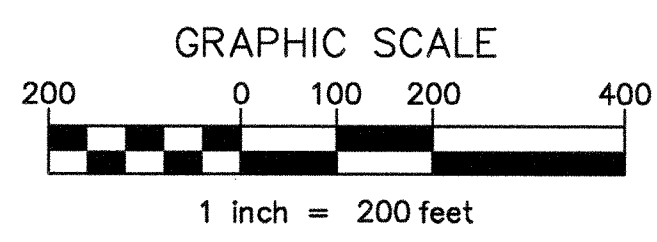

P:\Projects\38673 Augusta MP\plans\AUG ALP 2007\Sheet_11_PAVEMENT_HISTORY_Plan.dwg PAVEMENT_HISTORY_PLAN Mar 20, 2008 - 3:54pm



| NO. | BY | DATE | REVISIONS |
|-----|----|------|-----------|
| | | | |
| | | | |
| | | | |

| APPROVED |
|----------|
| |



2900 SOUTH QUINCY STREET,
SUITE 200
ARLINGTON, VIRGINIA 22206
PH (703) 824-5100
FAX (703) 671-6210

PAVEMENT HISTORY PLAN
AUGUSTA STATE AIRPORT
AUGUSTA, MAINE

DATE:
Mar 20, 2008

FIGURE
11